



RAILROAD COMMISSION OF TEXAS

Form W-2

1701 N. Congress  
P.O. Box 12967  
Austin, Texas 78701-2967

Status: Approved  
Date: 02/07/2023  
Tracking No.: 281414

OIL WELL POTENTIAL TEST, COMPLETION OR RECOMPLETION REPORT,

OPERATOR INFORMATION			
Operator	PERCUSSION PETROLEUM OPER II,LLC	Operator	653216
Operator	1001 FANNIN STREET STE 2200 HOUSTON, TX 77002-		

WELL INFORMATION			
API	42-495-34698	County:	WINKLER
Well No.:	8H	RRC District	08
Lease	UL YELLOWTAIL WEST H 21-29-17 WB	Field	PHANTOM (WOLFCAMP)
RRC Lease	58307	Field No.:	71052900
Location	Section: 29, Block: 21, Survey: UL, Abstract: U69		
Latitude	31.711084	Longitud	-103.243834
This well is 5.2 miles in a SW direction from WINK, which is the nearest town in the			

FILING INFORMATION			
Purpose of	Initial Potential		
Type of	New Well		
Well Type:	Producing	Completion or Recompletion	09/16/2022
Type of Permit	Date	Permit No.	
Permit to Drill, Plug Back, or Rule 37 Exception	03/28/2022	876973	
Fluid Injection			
O&G Waste Disposal			
Other:			

COMPLETION INFORMATION			
Spud	03/25/2022	Date of first production after rig	09/16/2022
Date plug back, deepening, drilling operation	03/25/2022	Date plug back, deepening, recompletion, drilling operation	06/19/2022
Number of producing wells on this lease this field (reservoir) including this	8	Distance to nearest well in lease & reservoir	400.0
Total number of acres in	1281.40	Elevation	2763 GL
Total depth TVD	12207	Total depth MD	20893
Plug back depth TVD		Plug back depth MD	
Was directional survey made other inclination (Form W-	Yes	Rotation time within surface casing Is Cementing Affidavit (Form W-15)	120.0 Yes
Recompletion or	No	Multiple	No
Type(s) of electric or other log(s)	Gamma Ray (MWD)		
Electric Log Other Description:			
Location of well, relative to nearest lease of lease on which this well is	590.0 Feet from the North Line and 1598.0 Feet from the West Line of the UL YELLOWTAIL WEST H 21-29-17 WB Lease.	Off Lease :	Yes

FORMER FIELD (WITH RESERVOIR) & GAS ID OR OIL LEASE NO.			
Field & Reservoir	Gas ID or Oil Lease	Well No.	Prior Service Type
PACKET:	N/A		

W2:	N/A		
FOR NEW DRILL OR RE-ENTRY, SURFACE CASING DEPTH DETERMINED BY:			
GAU Groundwater Protection Determination	Depth	650.0	Date 11/15/2021
SWR 13 Exception	Depth	5300.0	

INITIAL POTENTIAL TEST DATA FOR NEW COMPLETION OR RECOMPLETION			
Date of	10/11/2022	Production	Flowing
Number of hours	24	Choke	.5625
Was swab used during this	No	Oil produced prior to	8489.00
PRODUCTION DURING TEST PERIOD:			
Oil	739.00	Gas	902
Gas - Oil	1220	Flowing Tubing	1372.00
Water	6332		
CALCULATED 24-HOUR RATE			
Oil	739.0	Gas	902
Oil Gravity - API - 60.:	42.0	Casing	1373.00
Water	6332		

CASING RECORD											
Ro	Type of Casing	Casing	Hole	Setting	Multi -	Multi -	Cement	Cement	Slurry	Top of	TOC
		Size (in.)	Size	Depth	Stage Tool	Stage Shoe	Class	Amoun	Volume (cu.)	Cement (ft.)	Determined By
1	Surface	10 3/4	12 1/4	5210			C	3465	5279.0	0	Circulated to Surface
2	Intermediate	7 5/8	8 3/4	11530			H	645	1527.0	5058	Calculation
3	Intermediate	7 5/8	8 3/4	11530		5058	C	320	710.0	0	Circulated to Surface
4	Conventional Production	5 1/2	6 3/4	20873			H	1210	1564.0	4343	Calculation

LINER RECORD									
Ro	Liner Size	Hole Size	Liner Top	Liner Bottom	Cement Class	Cement Amoun	Slurry Volume (cu.)	Top of Cement (ft.)	TOC Determined
N/A									

TUBING RECORD			
<u>Ro</u>	<u>Size (in.)</u>	<u>Depth</u>	<u>Size (ft.)</u>
		<u>Packer Depth (ft.)/Type</u>	
/			
N/A			

PRODUCING/INJECTION/DISPOSAL INTERVAL			
Ro	Open hole?	From (ft.)	To (ft.)
1	No	L1 12481	20741.0

ACID, FRACTURE, CEMENT SQUEEZE, CAST IRON BRIDGE PLUG, RETAINER, ETC.					
Was hydraulic fracturing treatment		Yes			
Is well equipped with a downhole sleeve?		No			
		If yes, actuation pressure			
Production casing test pressure (PSIG)		Actual maximum pressure (PSIG) during			
hydraulic fracturing		13000	fracturin	11845	
Has the hydraulic fracturing fluid disclosure been		Yes			
Ro	Type of Operation	Amount and Kind of Material Used		Depth Interval (ft.)	
1	Fracture	SEE FRAC FOCUS		12481	20741

FORMATION RECORD					
Formations	Encountere	Depth TVD	Depth MD	Is formation	Remarks
RUSTLER - POSSIBLE FLOW; POSSIBLE USABLE QUALITY W	No			No	NOT IN THIS AREA
COLBY / QUEEN	No			No	NOT IN THIS AREA
YATES	No			No	NOT IN THIS AREA
SEVEN RIVERS / QUEEN	No			No	NOT IN THIS AREA
CAPITAN REEF - HIGH FLOWS	No			No	NOT IN THIS AREA
SAN ANDRES - HIGH FLOWS, H2S, CORROSIVE	No			No	NOT IN THIS AREA
DELAWARE	Yes	5111.0	5232.0	Yes	
GLORIETA	No			No	NOT IN THIS AREA
HOLT	No			No	NOT IN THIS AREA
CLEARFORK	No			No	NOT IN THIS AREA
CHERRY CANYON	Yes	6005.0	6142.0	Yes	
BRUSHY CANYON	No			No	NOT IN THIS AREA
BONE SPRING	Yes	8762.0	8924.0	Yes	
2ND BONE SPRING	Yes	10069.0	10230.0	Yes	
3RD BONE SPRING	Yes	10820.0	10983.0	Yes	
WICHITA ALBANY	No			No	NOT IN THIS AREA
WOLFCAMP	Yes	11725.0	11895.0	Yes	
PENNSYLVANIAN	No			No	BELOW TD
CANYON	No			No	BELOW TD
STRAWN	No			No	BELOW TD
ATOKA	No			No	BELOW TD
MISSISSIPPIAN	No			No	BELOW TD
DEVONIAN	No			No	BELOW TD
SILURIAN	No			No	BELOW TD
FUSSELMAN	No			No	BELOW TD
MONTOYA	No			No	BELOW TD
WADDELL	No			No	BELOW TD
ELLENBURGER	No			No	BELOW TD
PRECAMBRIAN (UNDIFFERENTIATED)	No			No	BELOW TD

Do the producing interval of this well produce H2S with a concentration in excess of 100 ppm	No
Is the completion being downhole commingled	No

REMARKS
KOP-11683

RRC REMARKS
<p><b>PUBLIC COMMENTS:</b></p> <p>[RRC Staff 2023-01-23 11:51:09.659] EDL=8250 feet, max acres=704, PHANTOM (WOLFCAMP) oil or gas well, take points: 12481-20741 feet MD, API No. 495-34698</p> <p><b>CASING RECORD :</b></p> <p><b>TUBING RECORD:</b></p> <p>WILL BE INSTALLED AT A LATER DATE</p> <p><b>PRODUCING/INJECTION/DISPOSAL INTERVAL :</b></p> <p><b>ACID, FRACTURE, CEMENT SQUEEZE, CAST IRON BRIDGE PLUG, RETAINER, ETC. :</b></p> <p><b>POTENTIAL TEST DATA:</b></p>

OPERATOR'S CERTIFICATION			
Printed	Karen Zornes	Title:	
Telephone	(281) 872-9300	Date	11/18/2022





# RAILROAD COMMISSION OF TEXAS

1701 N. Congress  
P.O. Box 12967  
Austin, Texas 78701-2967

Form W-15

Rev. 08/2014

## CEMENTING REPORT

Cementer: Fill in shaded areas.  
Operator: Fill in other items.

OPERATOR INFORMATION					
Operator Name: Percussion Petroleum OPER. II, LLC			Operator P-5 No.: 653216		
Cementer Name: West Texas Cementers			Cementer P-5 No.: 910261		
WELL INFORMATION					
District No.: 08		County: Winkler			
Well No.: 8H		API No.: 42-495-34698		Drilling Permit No.: 876973	
Lease Name: UL YELLOWTAIL WEST H 21-29-17 WB		Lease No.:			
Field Name: PHANTOM (WOLFCAMP)		Field No.: 71052900			
I. CASING CEMENTING DATA					
Type of Casing: <input type="checkbox"/> Conductor <input checked="" type="checkbox"/> Surface <input type="checkbox"/> Intermediate <input type="checkbox"/> Liner <input type="checkbox"/> Production					
Drilled hole size (in.): 12 1/4		Depth of drilled hole (ft.): 5225		Est. % wash-out or hole enlargement: 15%	
Size of casing in O.D. (in.): 10 3/4		Casing weight (lbs/ft) and grade: 45.5 J-55		No. of centralizers used: 35	
Was cement circulated to ground surface (or bottom of cellar) outside casing? <input checked="" type="checkbox"/> YES <input type="checkbox"/> NO If no for surface casing, explain in Remarks.				Setting depth shoe (ft.): 5210	
				Setting depth liner (ft.):	
Hrs. waiting on cement before drill-out: 24+		Calculated top of cement (ft.): 0		Cementing date: 3/27/2022	
SLURRY					
Slurry No.	No. of Sacks	Class	Additives	Volume (cu. ft.)	Height (ft.)
1	670	C	REMARK #1	1293	1692
2	2045	C	REMARK #2	3886	6222
3	750	C	REMARK #3	100	3189
Total	3465			5279	11103
II. CASING CEMENTING DATA					
Type of casing: <input type="checkbox"/> Surface <input type="checkbox"/> Intermediate <input type="checkbox"/> Production <input type="checkbox"/> Tapered production <input type="checkbox"/> Multi-stage cement shoe <input type="checkbox"/> Multiple parallel strings					
Drilled hole size (in.):		Depth of drilled hole (ft.):		Est. % wash-out or hole enlargement:	
Size of casing in O.D. (in.):		Casing weight (lbs/ft) and grade:		No. of centralizers used:	
Tapered string drilled hole size (in.)		Tapered string depth of drilled hole (ft.)			
Upper: Lower:		Upper: Lower:			
Tapered string size of casing in O.D. (in.)		Tapered string casing weight (lbs/ft) and grade		Tapered string no. of centralizers used	
Upper: Lower:		Upper: Lower:		Upper: Lower:	
Was cement circulated to ground surface (or bottom of cellar) outside casing? YES <input type="checkbox"/> NO <input type="checkbox"/>				Setting depth shoe (ft.):	
Hrs. waiting on cement before drill-out:		Calculated top of cement (ft.):		Cementing date:	
SLURRY					
Slurry No.	No. of Sacks	Class	Additives	Volume (cu. ft.)	Height (ft.)
1					
2					
3					
Total	0			0	0
III. CASING CEMENTING DATA					
Type of casing: <input type="checkbox"/> Surface <input type="checkbox"/> Intermediate <input type="checkbox"/> Production <input type="checkbox"/> Tapered production <input type="checkbox"/> Multi-stage cement/DV too <input type="checkbox"/> Multiple parallel strings					
Drilled hole size (in.):		Depth of drilled hole (ft.):		Est. % wash-out or hole enlargement:	
Size of casing in O.D. (in.):		Casing weight (lbs/ft) and grade:		No. of centralizers used:	
Tapered string drilled hole size (in.)		Tapered string depth of drilled hole (ft.)			
Upper: Lower:		Upper: Lower:			
Tapered string size of casing in O.D. (in.)		Tapered string casing weight (lbs/ft) and grade		Tapered string no. of centralizers used	
Upper: Lower:		Upper: Lower:		Upper: Lower:	
Was cement circulated to ground surface (or bottom of cellar) outside casing? YES <input type="checkbox"/> NO <input type="checkbox"/>				Setting depth shoe (ft.):	
Hrs. waiting on cement before drill-out:		Calculated top of cement (ft.):		Cementing date:	
SLURRY					
Slurry No.	No. of Sacks	Class	Additives	Volume (cu. ft.)	Height (ft.)
1					
2					
3					
Total	0			0	0



CEMENTING TO SQUEEZE, PLUG BACK OR PLUG AND ABANDON							
	PLUG #1	PLUG #2	PLUG #3	PLUG #4	PLUG #5	PLUG #6	PLUG #7
Cementing Date							
Size of hole or pipe (in.)							
Depth to bottom of tubing or drill pipe (ft.)							
Cement retainer setting depth (ft.)							
CIBP setting depth (ft.)							
Amount of cement on top of CIBP (ft.)							
Sacks of cement used							
Slurry volume pumped (cu. ft.)							
Calculated top of plug (ft.)							
Measured top of plug, if tagged (ft.)							
Slurry weight (lbs/gal)							
Class/type of cement							
Perforate and squeeze (YES/NO)							
REMARKS							
1. 35% B Poz+65% Class C+6% Gel+5% SALT+0.3% R-1300+3PPS Gilsonite+0.25PPS Web Seal+0.005GPS NoFoam V1A							
2. 35% B Poz+65% Class C+6% Gel+5% SALT+0.2% R-1300+0.25PPS Pol-E-Flake+0.005GPS NoFoam V1A							
3. 100% Class C+0.05% C-20+0.005GPS NoFoam V1A							

CEMENTER'S CERTIFICATE: I declare under penalties prescribed in Sec. 91.143, Texas Natural Resources Code, that I am authorized to make this certification, that the cementing of casing and/or the placing of cement plugs in this well as shown in the report was performed by me or under my supervision, and that the cementing data and facts presented on both sides of this form are true, correct, and complete, to the best of my knowledge. This certification covers cementing data only.

LUIS RIOS - SERVICE SUPERVISOR

Name and title of cementer's representative

West Texas Cementers

Cementing Company

*[Signature]*

Signature

1400 S JBS PARKWAY

Address

ODESSA, TX. 79766

City, State, Zip Code

432-227-0010

Tel: Area Code

Number

3/27/2022

Date: mo. day yr.

OPERATOR'S CERTIFICATE: I declare under penalties prescribed in Sec. 91.143, Texas Natural Resources Code, that I am authorized to make this certification, that I have knowledge of the well data and information presented in this report, and that data and facts presented on both sides of this form are true, correct, and complete, to the best of my knowledge. This certification covers all well data.

KAREN ZORNES

Typed or printed name of operator's representative

REGULATORY CONSULTANT

Title

*Karen Zornes*

Signature

911 REGIONAL PARK DR

Address

HOUSTON, TX 77060

City, State, Zip Code

281-872-9300

Tel: Area Code

Number

11/18/2022

Date: mo. day yr.

### Instructions for Form W-15, Cementing Report

NOTICE: The Form W-15 must be submitted as an attachment to a Form G-1 (Gas Well Back Pressure Test, Completion or Recompletion Report, and Log), Form W-2 (Oil Well Potential Test, Completion or Recompletion Report, and Log), Form W-3 (Plugging Record), or Form W-4 (Application for Multiple Completion), any time cement is pumped in a wellbore.

A. **What to file:** An operator should file an original and one copy of the completed Form W-15 for each cementing company used on a well. The cementing of different casing strings on a well by one cementing company may be reported on one form. The Form W-15 should be filed with the Form W-3, Plugging Record, unless the Form W-3 is signed by the cementing company representative. When reporting dry holes, operators must complete Form W-15, in addition to Form W-3, to show any casing cemented in the hole.

B. **How to file:** An oil and gas completion report and Form W-15 may be filed online using the Commission's Online System

(<https://webapps.rrc.state.tx.us/security/login.do>) or a paper copy of the form may be mailed to the Commission in Austin (P.O. Box 12967, Austin, Texas 787112967).

C. **Surface casing:** An operator must set and cement sufficient surface casing to protect all usable-quality water strata, as defined by the Groundwater Advisory Unit in Austin. Sufficient cement shall be used to fill the annular space outside the casing from the shoe to the ground surface or to the bottom of the cellar. Before drilling a well, an operator must obtain a letter from the Groundwater Advisory Unit stating the protection depth. Surface casing should not be set deeper than 200 feet below the specified depth without prior approval from the Commission.

To plug and abandon a well, operators must use only cementers approved by the Commission's Director of Field Operations in accordance with SWR 14 ([http://info.sos.state.tx.us/pls/pub/readtac\\$ext.TacPage?sl=R&app=9&p\\_dir=&p\\_rloc=&p\\_tloc=&p\\_ploc=&pg=1&p\\_tac=&ti=16&pt=1&ch=3&rl=14](http://info.sos.state.tx.us/pls/pub/readtac$ext.TacPage?sl=R&app=9&p_dir=&p_rloc=&p_tloc=&p_ploc=&pg=1&p_tac=&ti=16&pt=1&ch=3&rl=14)). Cementing companies, service companies, or operators can qualify as approved cementers by demonstrating that they are able to mix and pump cement in compliance with Commission rules and regulations.

D. **Estimated % wash-out:** If the estimated % wash-out is less than 20% (or 30% along the Gulf Coast), provide supporting documentation such as a caliper log to show how the estimated % wash-out was obtained.

E. **Multi-stage cement:** An operator must report the multi-stage cement shoe in II. Casing Cementing Data section by selecting the type of casing and Multi-stage cement shoe. The operator must report the multi-stage cement tool in III. Casing Cementing Data section by selecting the type of casing and Multi-stage cement/DV tool.

F. **Multiple parallel strings:** An operator should file the Form W-15 as an attachment to the Form W-4, Application for Multiple Completion. An operator may be required to submit multiple Form W-15s to show all data for multiple parallel strings.

G. **Slurry data:** If cement job exceeds three slurries, continue the list of slurries in the Slurry table in the subsequent Casing Cementing Data box.





# RAILROAD COMMISSION OF TEXAS

1701 N. Congress  
P.O. Box 12967  
Austin, Texas 78701-2967

Form W-15

Rev. 08/2014

## CEMENTING REPORT

Cementer: Fill in shaded areas.  
Operator: Fill in other items.

### OPERATOR INFORMATION

Operator Name: Percussion Petroleum OPER. II, LLC Operator P-5 No.: 653216  
Cementer Name: West Texas Cementers Cementer P-5 No.: 910261

### WELL INFORMATION

District No.: 08 County: Winkler  
Well No.: 8H API No.: 42-495-34698 Drilling Permit No.: 876973  
Lease Name: UL YELLOWTAIL WEST H 21-29-17 WB Lease No.:  
Field Name: PHANTOM (WOLFCAMP) Field No.: 71052900

### I. CASING CEMENTING DATA

Type of Casing: ☐ Conductor ☐ Surface ☐ Intermediate ☐ Liner ☐ Production  
Drilled hole size (in.): Depth of drilled hole (ft.): Est. % wash-out or hole enlargement:  
Size of casing in O.D. (in.): Casing weight (lbs/ft) and grade: No. of centralizers used:  
Was cement circulated to ground surface (or bottom of cellar) outside casing? ☐ YES ☐ NO If no for surface casing, explain in Remarks. Setting depth shoe (ft.): Top of liner (ft.):  
Setting depth liner (ft.):  
Hrs. waiting on cement before drill-out: Calculated top of cement (ft.): Cementing date:

#### SLURRY

Slurry No.	No. of Sacks	Class	Additives	Volume (cu. ft.)	Height (ft.)
1					
2					
3					
Total	0			0	0

### II. CASING CEMENTING DATA

Type of casing: ☐ Surface ☒ Intermediate ☐ Production ☐ Tapered production ☒ Multi-stage cement shoe ☐ Multiple parallel strings  
Drilled hole size (in.): 8 3/4 Depth of drilled hole (ft.): 11569 Est. % wash-out or hole enlargement: 0  
Size of casing in O.D. (in.): 7 5/8 Casing weight (lbs/ft) and grade: 29.7# L-80 No. of centralizers used: 36  
Tapered string drilled hole size (in.) Tapered string depth of drilled hole (ft.)  
Upper: Lower: Upper: Lower:  
Tapered string size of casing in O.D. (in.) Tapered string casing weight (lbs/ft) and grade Tapered string no. of centralizers used  
Upper: Lower: Upper: Lower:  
Was cement circulated to ground surface (or bottom of cellar) outside casing? YES ☐ NO ☒ Setting depth shoe (ft.): 11530  
Hrs. waiting on cement before drill-out: Calculated top of cement (ft.): 5058 Cementing date: 4/15/2022

#### SLURRY

Slurry No.	No. of Sacks	Class	Additives	Volume (cu. ft.)	Height (ft.)
1	580	50-50 CLASS H	REMARKS 1	1450	11050
2	65	CLASS H	REMARKS 2	77	502
3					
Total	645			1527	11552

### III. CASING CEMENTING DATA

Type of casing: ☐ Surface ☒ Intermediate ☐ Production ☐ Tapered production ☒ Multi-stage cement/DV tool ☐ Multiple parallel strings  
Drilled hole size (in.): 8 3/4 Depth of drilled hole (ft.): 11569 Est. % wash-out or hole enlargement: 0  
Size of casing in O.D. (in.): 7 5/8 Casing weight (lbs/ft) and grade: 29.7# L-80 No. of centralizers used: 36  
Tapered string drilled hole size (in.) Tapered string depth of drilled hole (ft.)  
Upper: Lower: Upper: Lower:  
Tapered string size of casing in O.D. (in.) Tapered string casing weight (lbs/ft) and grade Tapered string no. of centralizers used  
Upper: Lower: Upper: Lower:  
Was cement circulated to ground surface (or bottom of cellar) outside casing? YES ☐ NO ☒ Setting depth shoe (ft.): 5058  
Hrs. waiting on cement before drill-out: Calculated top of cement (ft.): 0 Cementing date: 4/15/2022

#### SLURRY

Slurry No.	No. of Sacks	Class	Additives	Volume (cu. ft.)	Height (ft.)
1	265	50-50 CLASS C	REMARKS 3	637	4391
2	55	CLASS C	REMARKS 4	73	673
3					
Total	320			710	5064



CEMENTING TO SQUEEZE, PLUG BACK OR PLUG AND ABANDON							
	PLUG #1	PLUG #2	PLUG #3	PLUG #4	PLUG #5	PLUG #6	PLUG #7
Cementing Date							
Size of hole or pipe (in.)							
Depth to bottom of tubing or drill pipe (ft.)							
Cement retainer setting depth (ft.)							
CIBP setting depth (ft.)							
Amount of cement on top of CIBP (ft.)							
Sacks of cement used							
Slurry volume pumped (cu. ft.)							
Calculated top of plug (ft.)							
Measured top of plug, if tagged (ft.)							
Slurry weight (lbs/gal)							
Class/type of cement							
Perforate and squeeze (YES/NO)							
REMARKS							
1) 50% B Poz+50% Class H+10% Gel+5% SALT+0.4% Suspended Cem 6302+0.6% FR-5+3PPS Gilsonite+0.25PPS Pol-E-Flake+0.005GPS NoFoam V1A							
2) 100% Class H+0.1% Suspended Cem 6302+0.2% C-20+0.2% C-47B+0.005GPS NoFoam V1A							
3) 50% B Poz+50% Class C+10% Gel+5% SALT+0.1% Suspended Cem 6302+0.2% C-20+3PPS Gilsonite+0.25PPS Pol-E-Flake+0.005GPS NoFoam V1A							
4) 100% Class C+0.005GPS NoFoam V1A							

CEMENTER'S CERTIFICATE: I declare under penalties prescribed in Sec. 91.143, Texas Natural Resources Code, that I am authorized to make this certification, that the cementing of casing and/or the placing of cement plugs in this well as shown in the report was performed by me or under my supervision, and that the cementing data and facts presented on both sides of this form are true, correct, and complete, to the best of my knowledge. This certification covers cementing data only.

JAMES RICHARDS SERVICE SUPERVISOR

Name and title of cementer's representative

West Texas Cementers

Cementing Company



Signature

1400 S JBS PKWY ODESSA TX 79766

Address City, State, Zip Code

432-227-0010

Tel: Area Code Number

4/15/2022

Date: mo. day yr.

OPERATOR'S CERTIFICATE: I declare under penalties prescribed in Sec. 91.143, Texas Natural Resources Code, that I am authorized to make this certification, that I have knowledge of the well data and information presented in this report, and that data and facts presented on both sides of this form are true, correct, and complete, to the best of my knowledge. This certification covers all well data.

KAREN ZORNES

Typed or printed name of operator's representative

REGULATORY CONSULTANT

Title



Signature

911 REGIONAL PARK DR HOUSTON, TX 77060

Address City, State, Zip Code

281-872-9300

Tel: Area Code Number

11/18/2022

Date: mo. day yr.

### Instructions for Form W-15, Cementing Report

NOTICE: The Form W-15 must be submitted as an attachment to a Form G-1 (Gas Well Back Pressure Test, Completion or Recompletion Report, and Log), Form W-2 (Oil Well Potential Test, Completion or Recompletion Report, and Log), Form W-3 (Plugging Record), or Form W-4 (Application for Multiple Completion), any time cement is pumped in a wellbore.

A. What to file: An operator should file an original and one copy of the completed Form W-15 for each cementing company used on a well. The cementing of different casing strings on a well by one cementing company may be reported on one form. The Form W-15 should be filed with the Form W-3, Plugging Record, unless the Form W-3 is signed by the cementing company representative. When reporting dry holes, operators must complete Form W-15, in addition to Form W-3, to show any casing cemented in the hole.

B. How to file: An oil and gas completion report and Form W-15 may be filed online using the Commission's Online System

(<https://webapps.rrc.state.tx.us/security/login.do>) or a paper copy of the form may be mailed to the Commission in Austin (P.O. Box 12967, Austin, Texas 787112967).

C. Surface casing: An operator must set and cement sufficient surface casing to protect all usable-quality water strata, as defined by the Groundwater Advisory Unit in Austin. Sufficient cement shall be used to fill the annular space outside the casing from the shoe to the ground surface or to the bottom of the cellar. Before drilling a well, an operator must obtain a letter from the Groundwater Advisory Unit stating the protection depth. Surface casing should not be set deeper than 200 feet below the specified depth without prior approval from the Commission.

To plug and abandon a well, operators must use only cementers approved by the Commission's Director of Field Operations in accordance with SWR 14 ([http://info.sos.state.tx.us/pls/pub/readtac\\$ext.TacPage?sl=R&app=9&p\\_dir=&p\\_rloc=&poloc=&p\\_loc=&pg=1&p\\_tac=&ti=16&pt=1&ch=3&rl=14](http://info.sos.state.tx.us/pls/pub/readtac$ext.TacPage?sl=R&app=9&p_dir=&p_rloc=&poloc=&p_loc=&pg=1&p_tac=&ti=16&pt=1&ch=3&rl=14)). Cementing companies, service companies, or operators can qualify as approved cementers by demonstrating that they are able to mix and pump cement in compliance with Commission rules and regulations.

D. Estimated % wash-out: If the estimated % wash-out is less than 20% (or 30% along the Gulf Coast), provide supporting documentation such as a caliper log to show how the estimated % wash-out was obtained.

E. Multi-stage cement: An operator must report the multi-stage cement shoe in II. Casing Cementing Data section by selecting the type of casing and Multi-stage cement shoe. The operator must report the multi-stage cement tool in III. Casing Cementing Data section by selecting the type of casing and Multi-stage cement/DV tool.

F. Multiple parallel strings: An operator should file the Form W-15 as an attachment to the Form W-4, Application for Multiple Completion. An operator may be required to submit multiple Form W-15s to show all data for multiple parallel strings.

G. Slurry data: If cement job exceeds three slurries, continue the list of slurries in the Slurry table in the subsequent Casing Cementing Data box.





# RAILROAD COMMISSION OF TEXAS

1701 N. Congress  
P.O. Box 12967  
Austin, Texas 78701-2967

Form W-15

Rev. 08/2014

## CEMENTING REPORT

Cementer: Fill in shaded areas.

Operator: Fill in other items.

### OPERATOR INFORMATION

Operator Name: PERCUSSION PETROLEUM OPER. II. LLC Operator P-5 No.: 653216  
Cementer Name: NexTier Completion Solutions Inc. Cementer P-5 No.: 609375

### WELL INFORMATION

District No.: 08 County: Winkler  
Well No.: 8H API No.: 42-495-34698 Drilling Permit No.: 876973  
Lease Name: UL YELLOWTAIL WEST H 21-29-17 WB Lease No.:  
Field Name: PHANTOM (WOLFCAMP) Field No.: 71052900

### I. CASING CEMENTING DATA

Type of Casing: ☐ Conductor ☐ Surface ☐ Intermediate ☐ Liner ☒ Production  
Drilled hole size (in.): 6 3/4 Depth of drilled hole (ft.): 20893 Est. % wash-out or hole enlargement: 0  
Size of casing in O.D. (in.): 5 1/2 Casing weight (lbs/ft) and grade: 23# P-110 No. of centralizers used: 15  
Was cement circulated to ground surface (or bottom of cellar) outside casing? ☐ YES ☒ NO If no for surface casing, explain in Remarks.  
Setting depth shoe (ft.): 20873 Top of liner (ft.):  
Setting depth liner (ft.):  
Hrs. waiting on cement before drill-out: Calculated top of cement (ft.): 4343 4343 Cementing date: 6/19/2022

#### SLURRY

Slurry No.	No. of Sacks	Class	Additives	Volume (cu. ft.)	Height (ft.)
1	420	50:50:H	REMARK 1	592	4975
2	790	35:65:H	REMARK 2	972	11614
3					
Total	1210			1564	16589

### II. CASING CEMENTING DATA

Type of casing: ☐ Surface ☐ Intermediate ☐ Production ☐ Tapered production ☐ Multi-stage cement shoe ☐ Multiple parallel strings  
Drilled hole size (in.): Depth of drilled hole (ft.): Est. % wash-out or hole enlargement:  
Size of casing in O.D. (in.): Casing weight (lbs/ft) and grade: No. of centralizers used:  
Tapered string drilled hole size (in.) Tapered string depth of drilled hole (ft.)  
Upper: Lower: Upper: Lower:  
Tapered string size of casing in O.D. (in.) Tapered string casing weight (lbs/ft) and grade Tapered string no. of centralizers used  
Upper: Lower: Upper: Lower: Upper: Lower:  
Was cement circulated to ground surface (or bottom of cellar) outside casing? YES ☐ NO ☐  
Setting depth shoe (ft.):  
Hrs. waiting on cement before drill-out: Calculated top of cement (ft.): Cementing date:

#### SLURRY

Slurry No.	No. of Sacks	Class	Additives	Volume (cu. ft.)	Height (ft.)
1					
2					
3					
Total					

### III. CASING CEMENTING DATA

Type of casing: ☐ Surface ☐ Intermediate ☐ Production ☐ Tapered production ☐ Multi-stage cement/DV tool ☐ Multiple parallel strings  
Drilled hole size (in.): Depth of drilled hole (ft.): Est. % wash-out or hole enlargement:  
Size of casing in O.D. (in.): Casing weight (lbs/ft) and grade: No. of centralizers used:  
Tapered string drilled hole size (in.) Tapered string depth of drilled hole (ft.)  
Upper: Lower: Upper: Lower:  
Tapered string size of casing in O.D. (in.) Tapered string casing weight (lbs/ft) and grade Tapered string no. of centralizers used  
Upper: Lower: Upper: Lower: Upper: Lower:  
Was cement circulated to ground surface (or bottom of cellar) outside casing? YES ☐ NO ☐  
Setting depth shoe (ft.):  
Hrs. waiting on cement before drill-out: Calculated top of cement (ft.): Cementing date:

#### SLURRY

Slurry No.	No. of Sacks	Class	Additives	Volume (cu. ft.)	Height (ft.)
1					
2					
3					
Total					



## CEMENTING TO SQUEEZE, PLUG BACK OR PLUG AND ABANDON

	PLUG #1	PLUG #2	PLUG #3	PLUG #4	PLUG #5	PLUG #6	PLUG #7
Cementing Date							
Size of hole or pipe (in.)							
Depth to bottom of tubing or drill pipe (ft.)							
Cement retainer setting depth (ft.)							
CIBP setting depth (ft.)							
Amount of cement on top of CIBP (ft.)							
Sacks of cement used							
Slurry volume pumped (cu. ft.)							
Calculated top of plug (ft.)							
Measured top of plug, if tagged (ft.)							
Slurry weight (lbs/gal)							
Class/type of cement							
Perforate and squeeze (YES/NO)							

## REMARKS

50:50 NPZ-010:NCM-916 + 5% NEX-020 + 0.2% NAC-104 + 0.4% NFL-549 + 0.2% NFP-703 + 0.4% NRT-213

35:65 NPZ-010:NCM-916 + 2% NEX-020 + 0.3% NFL-549 + 0.2% NFP-703 + 0.3% NRT-213

CEMENTER'S CERTIFICATE: I declare under penalties prescribed in Sec. 91.143, Texas Natural Resources Code, that I am authorized to make this certification, that the cementing of casing and/or the placing of cement plugs in this well as shown in the report was performed by me or under my supervision, and that the cementing data and facts presented on both sides of this form are true, correct, and complete, to the best of my knowledge. This certification covers cementing data only.

Eduardo Chapa

NexTier Completion Solutions Inc.

Name and title of cementer's representative

Cementing Company

Signature

2601 E 120 Midland, Texas 79706

432-686-8559

6/19/22

Address

City, State, Zip Code

Tel: Area Code

Number

Date: mo. day yr.

OPERATOR'S CERTIFICATE: I declare under penalties prescribed in Sec. 91.143, Texas Natural Resources Code, that I am authorized to make this certification, that I have knowledge of the well data and information presented in this report, and that data and facts presented on both sides of this form are true, correct, and complete, to the best of my knowledge. This certification covers all well data.

KAREN ZORNES

REGULATORY CONSULTANT

Karen Zornes

Typed or printed name of operator's representative

Title

Signature

911 REGIONAL PARK DR HOUSTON, TX 77060

281-872-9300

11/18/2022

Address

City, State, Zip Code

Tel: Area Code

Number

Date: mo. day yr.

## Instructions for Form W-15, Cementing Report

NOTICE: The Form W-15 must be submitted as an attachment to a Form G-1 (Gas Well Back Pressure Test, Completion or Recompletion Report, and Log), Form W-2 (Oil Well Potential Test, Completion or Recompletion Report, and Log),

A. **What to file:** An operator should file an original and one copy of the completed Form W-15 for each cementing company used on a well. The cementing of different casing strings on a well by one cementing company should be filed with the Form W-3, Plugging Record, unless the Form W-3 is signed by the cementing company representative. When reporting dry holes, operators must complete Form W-15, in

B. **How to file:** An oil and gas completion report and Form W-15 may be filed online using the Commission's Online System (<https://webapps.rrc.state.tx.us/security/login.do>) or a paper copy of the form may be mailed to the Commission in Austin (P.O. Box 12967, Austin, Texas 78712967).

C. **Surface casing:** An operator must set and cement sufficient surface casing to protect all usable-quality water strata, as defined by the Groundwater Advisory Unit in Austin. Sufficient cement shall be used to fill To plug and abandon a well, operators must use only cementers approved by the Commission's Director of Field Operations in accordance with SWR 14

D. **Estimated % wash-out:** If the estimated % wash-out is less than 20% (or 30% along the Gulf Coast), provide supporting documentation such as a caliper log to show how the estimated % wash-out was obtained.

E. **Multi-stage cement:** An operator must report the multi-stage cement shoe in II. Casing Cementing Data section by selecting the type of casing and Multi-stage cement shoe. The operator must report the multi-

F. **Multiple parallel strings:** An operator should file the Form W-15 as an attachment to the Form W-4, Application for Multiple Completion. An operator may be required to submit multiple Form W-15s to show all

G. **Slurry data:** If cement job exceeds three slurries, continue the list of slurries in the Slurry table in the subsequent Casing Cementing Data box.





# APPLICATION FOR APPROVAL OF SURFACE CASING > 3500 FEET

## Statewide Rule 13(b)(1)(A) RAILROAD COMMISSION OF TEXAS

Operator's Name and Address: Percussion Petroleum II, LLC  
1001 Fannin St. Suite 2200  
Houston, TX 77002

P5 Number: 653216

Area for review: RRC District 8

Lease Name: UL YELLOWTAIL 21-29-17 TB 4H, WB 5H, WB 6H, WA 7H, WB 8H, WA 9H, TB 10H, WB 11H, TB 12H

Field Name: Phantom (Wolfcamp) County: Winkler

Survey: UL Abstract: A-U69

Drilling Permits: 876937, 876941, 876948, 876953, 876973, 876974, 876975, 876976, 876977

Note: Attach a map if the request is for more than one pad.

How will the operator maintain well control during drilling operations:

Weighted drilling fluid will be used as the primary well control barrier during operations. The density of the drilling fluid is planned to be overbalanced by 0.9 – 1.0 ppg which will contain formation pore pressures and prevent influx of formation fluids. A 20" diverter system will also be utilized which is comprised a rotating head and orbit valves on the flowline to the shakers and the flowline to the pits as an extra measure against influx.

How will the operator ensure cement is circulated to surface and that there is adequate bonding of cement:

We will perform a 2 stage cement job with the DV tool placed at the base of the GAU letter requirements.  
Centralizers will be placed every 4<sup>th</sup> joint with one above and below the stage tool.  
Cement lab tests will be run to determine proper water loss of the slurries to qualify as critical zone cement.

How will the operator prevent the migration of formation fluids through the annular space:

Proper cement slurries verified with the lab test results prior to pumping will ensure quality cement will be pumped to ensure no channeling can occur.

Signature: Karen Zornes Name: Karen Zornes Date: 02/17/2022 Phone: 281-872-9300

RRC Use Only ►

RRC District Office Action:			
<input checked="checked" type="checkbox"/> Approved	<input type="checkbox"/> Approved as Modified	<input type="checkbox"/> Denied	By: <u>Jessica Kent</u> Date: <u>2/18/2022</u>
Remarks/Modifications:			

WAYNE CHRISTIAN, CHAIRMAN  
CHRISTI CRADDICK, COMMISSIONER  
JIM WRIGHT, COMMISSIONER



DANNY SORRELLS  
DIRECTOR, OIL AND GAS DIVISION

JEFFERY MORGAN  
DISTRICT DIRECTOR

**RAILROAD COMMISSION OF TEXAS**

**OIL AND GAS DIVISION**

<b>OPERATOR Name:</b>	PERCUSSION PETROLEUM OPER	<b>RE: Lease:</b>	UL YELLOWTAIL H 21-29-17 WB		
<b>Address1:</b>	1001 FANNIN STREET	<b>Well No:</b>	8H		
<b>Address2:</b>	STE 220	<b>Sec:</b>	29	<b>Block:</b>	21
<b>City:</b>	HOUSTON	<b>County:</b>	WINKLER		
<b>State:</b>	TX	<b>Survey Name:</b>	UL		

**SWR13EX Application Number:** 108360 **Drilling Permit No:** 876973

**SWR 13 CASING EXCEPTION APPLICATION/ALTERNATIVE REQUEST APPROVED**

The Proposed Casing and Cementing Program submitted for **LEASE** UL YELLOWTAIL H 21-29-17 ;  
**WELL** 8H has been approved by the Railroad Commission of Texas District Office.

- A copy of this approved letter must be kept on location during all phases of drilling and/or plugging operations. Once approved, changes CANNOT be made to the Proposed Casing Program on the original application without additional approval from the Railroad Commission of Texas District Office.
- Any substantive modifications to the cement program require prior approval from the Railroad Commission of Texas District Office, and may require re-submission of the SWR 13 (Statewide Rule 13) Alternate Surface Casing Application. Contact the Railroad Commission of Texas District Office for more information.
- The tail slurry must be sufficient to fill the Zone of Critical Cement as described in Statewide Rule 13(b)(1)(H)(i). In addition, all cement slurries must be mixed on location as described in Application for Alternate Surface Casing Program.
- The casing and cement program shall adhere to the following specifications:  
  
Set 5300 feet of surface casing with a multistage tool set at a depth of not less than 750 feet. Circulate cement from the multistage tool to the ground surface. If cement does not circulate to surface during the first stage, the multistage tool MUST be opened and neat cement be circulated from the tool to the surface.

IF CEMENT IS NOT CIRCULATED TO THE GROUND SURFACE AS REQUIRED BY THIS EXCEPTION, YOU MUST CONTACT THE RAILROAD COMMISSION OF TEXAS DISTRICT OFFICE IMMEDIATELY AND FOLLOW THE PROCEDURES SET OUT IN RULE 13(b)(1)(H)(iii) OR AS REQUIRED BY THE RAILROAD COMMISSION OF TEXAS DISTRICT OFFICE.



You must comply with all other provisions of SWR 13 (Statewide Rule 13) and a representative of the cementing company who performs the cementing job for the protection of usable quality water strata must sign the Form W-15 attesting to the information regarding cementing operations performed; including circulation of cement. (Note: If surface casing is set below the approved depth, this can result in denial of future Statewide Rule 13(b)(1)(H)(i) requests.) A condition of the approved drilling permit requires notification to the Railroad Commission of Texas District Office eight (8) hours prior to the time casing is to be set/cemented in the well. If your exception request was submitted after the subject well has been drilled and completed, the operator may be referred for enforcement action.

This authorization shall expire within five (5) years from the date the Groundwater Protection Determination was issued, or at the expiration of the drilling permit (if the well is not spudded prior to expiration) for the referenced well, whichever occurs first. Furthermore, this authorization supersedes any prior authorizations issued for the referenced well.

This exception is based on information provided when the application was submitted 02/18/2022 .  
If any information has changed, you must contact the appropriate Railroad Commission of Texas District Office, and submit a new application if applicable. If you have questions, please contact the appropriate Oil and Gas District office.

RRC APPROVAL BY: Jessica Kent

DATE: 02/18/2022

JEFFERY MORGAN

DISTRICT DIRECTOR

WAYNE CHRISTIAN, CHAIRMAN  
CHRISTI CRADDICK, COMMISSIONER  
JIM WRIGHT, COMMISSIONER



**RAILROAD COMMISSION OF TEXAS**

**OIL AND GAS DIVISION**

DANNY SORRELLS  
DIRECTOR, OIL AND GAS DIVISION

JEFFERY MORGAN  
DISTRICT DIRECTOR

**OPERATOR Name:** PERCUSSION PETROLEUM OPER

**Address1:** 1001 FANNIN STREET STE 2200

**Address2:**

**City:** HOUSTON

**State:** TX

**RE: Lease:** UL YELLOWTAIL WEST H 21-29-17 WB

**Well No:** 8H

**Sec:** 29 **Block:** 21

**County:** WINKLER

**Survey Name:** UL

**SWR13EX Application Number:** 108360

**Drilling Permit No:** 876973

**SWR 13 CASING EXCEPTION APPLICATION/ALTERNATIVE REQUEST APPROVED**

An extension to omit the installation of tubing in the above-referenced well is approved for a period of up to 180 days from the date the application was received or the date the well began producing, whichever occurred last.

**RRC APPROVAL BY:** Jean Noel Rapono Antchoue

**DATE:** 10/27/2022

JEFFERY MORGAN  
DISTRICT DIRECTOR



Tracking No.: 281414

This facsimile L-1 was generated electronically from data submitted to the RRC.

## Instructions

**When to File Form L-1:**

- with Forms G-1, W-2, and GT-1 for new and deepened gas, oil, and geothermal wells
- with Form W-3 for plugged dry holes
- when sending in a log which was held under a request for confidentiality and the period for confidentiality has not yet expired.

**When is Form L-1 NOT required:**

- with Forms W-2, G-1, and GT-1 filed for injection wells, disposal wells, water supply wells, service wells, re-test wells, re-classifications, and plugbacks of oil, gas or geothermal wells
- with Form W-3 for plugging of other than a dry hole

**Where to File Form L-1:**

- with the appropriate Commission district office

**Filling out Form L-1:**

- Section I and the signature section must be filled out for all wells
- complete only the appropriate part of Section II

**Type of log required:**

- any wireline survey run for the purpose of obtaining lithology, porosity, or resistivity information
- no more than one such log is required but it must be of the subject well
- if such log is NOT run on the subject well, do NOT substitute any other type of log; just select Section II, Part A below

## SECTION I. IDENTIFICATION

Operator Name: PERCUSSION PETROLEUM OPER II,LLC	District No. 08	Completion Date: 09/16/2022
Field Name PHANTOM (WOLFCAMP)	Drilling Permit No. 876973	
Lease Name UL YELLOWTAIL WEST H 21-29-17 WB	Lease/ID No. 58307	Well No. 8H
County WINKLER	API No. 42- 495-34698	

## SECTION II. LOG STATUS (Complete either A or B)

☐ A. BASIC ELECTRIC LOG NOT RUN

☒ B. BASIC ELECTRIC LOG RUN. (Select one)

- ☒ 1. Confidentiality is requested and a copy of the header for each log that has been run on the well is attached.
- ☐ 2. Confidentiality already granted on basic electric log covering this interval (applicable to deepened wells only).
- ☐ 3. Basic electric log covering this interval already on file with Commission (applicable to deepened wells only).
- ☐ 4. Log attached to (select one):

☐ (a) Form L-1 (this form). If the company/lease name on log is different from that shown in Section I, please enter name on log here: \_\_\_\_\_

Check here if attached log is being submitted after being held confidential. ☐

☐ (b) Form P-7, Application for Discovery Allowable and New Field Designation.

☐ (c) Form W-4, Application for Multiple Completion:

Lease or ID No(s). \_\_\_\_\_

Well No(s). \_\_\_\_\_

Karen Zornes

Signature

Name (print)

Title

(281) 872-9300

Phone

11/18/2022

Date

-FOR RAILROAD COMMISSION USE ONLY-



1" = 100'  
MD FT

Company: Percussion Petroleum Oper II, LLC  
Well: UL Yellowtail West H 21-29-17 WB 8H  
Field: Phantom (Wolfcamp)  
API: 42-495-34698  
County: Winkler  
State: Texas  
Country: USA  
Rig: Unit 407  
AFE: 22DC054  
Job: AEP-PB-220150 / GT220530

Company: Percussion Petroleum Oper II, LLC  
Well: UL Yellowtail West H 21-29-17 WB 8H  
Field: Phantom (Wolfcamp)  
API: 42-495-34698  
County: Winkler  
State Texas  
Country USA  
Rig: Unit 407

Well Location NAD 1927

Latitude: 31.711084  
Y: 755385.80

Longitude: -103.243834  
X: 1095001.63

Section: 29 Township: Block 21 Rnge: N/A UL

Permanent Datum: Mean Sea Level

Kelly Bushing Elev: N/A

Log Measured From: Rotary Table

Drill Floor Elev: 2784.0

Height of Reference: 21

Ground Level Elev: 2763

Depth Drilled: 118.0 to: 20893.0  
Depth Logged: 118.0 to: 20893.09  
Date Logged: 24 Mar 2022 06:22 to: 18 Jun 2022 18:59

Disclaimer: Altitude Energy Partners, LLC uses its best efforts to provide customers with accurate information and interpretations with services performed but does not warranty the accuracy of information or interpretations.

Hole Data			Casing Data		
Size	From (MD)	To (MD)	Size	From (MD)	To (MD)
12.250	118	5225	10.750	0	5197
8.750	5225	11569	7.625	0	11528
6.750	11569	20893			

CERTIFICATE OF COMPLIANCE  
AND TRANSPORTATION AUTHORITY

P-4

This facsimile P-4 was generated electronically from data submitted to the RRC.  
A certification of the automated data is available in the RRC's Austin office.

Tracking No.: 281414

1. Field name exactly as shown on proration schedule <b>PHANTOM (WOLFCAMP)</b>		2. Lease name as shown on proration schedule <b>UL YELLOWTAIL WEST H 21-29-17 WB</b>					
3. Current operator name exactly as shown on P-5 Organization Report <b>PERCUSSION PETROLEUM OPER II, LLC</b>		4. Operator P-5 no. <b>653216</b>	5. Oil Lse/Gas ID no <b>58307</b>	6. County <b>WINKLER</b>	7. RRC district <b>08</b>		
8. Operator address including city, state, and zip code <b>1001 FANNIN STREET STE 2200 HOUSTON, TX 77002</b>		9. Well no(s) (see instruction E) <b>8H</b>			11. Effective Date <b>09/16/2022</b>		
		10. Classification <input checked="" type="checkbox"/> Oil <input type="checkbox"/> Gas <input type="checkbox"/> Other (see instruction A)					
12. Purpose of Filing. (Complete section a or b below.) (See instructions B and G) <b>a. Change of:</b> <input type="checkbox"/> operator <input type="checkbox"/> oil or condensate gatherer <input type="checkbox"/> gas gatherer <input type="checkbox"/> gas purchaser <input type="checkbox"/> gas purchaser system code <input type="checkbox"/> field name from: _____ Docket #: _____ <input type="checkbox"/> lease name from: _____ <hr/> <b>b. New RRC Number for:</b> <input checked="" type="checkbox"/> oil lease <input type="checkbox"/> gas well <b>Due to:</b> <input checked="" type="checkbox"/> new completion or recompletion <input type="checkbox"/> reclass oil to gas <input type="checkbox"/> reclass gas to oil <input type="checkbox"/> other well (specify) _____ <input type="checkbox"/> consolidation <input type="checkbox"/> unitization <input type="checkbox"/> field transfer <input type="checkbox"/> subdivision (oil lease only)							
13. Authorized GAS WELL GAS or CASINGHEAD GAS Gatherer(s) and/or Purchaser(s). (See instruction G).							
Gatherer	Purchaser	Name of GAS WELL GAS or CASINGHEAD GAS Gatherer(s) or Purchaser(s) As Indicated in Columns to the Left (Attach an additional sheet in same format if more space is needed)			Purchaser's RRC Assigned System Code	Percent of Take	Full-well stream
X	X	TARGA DELAWARE LLC(836022)			0001	100.0	
14. Authorized OIL or CONDENSATE Gatherer(s). (See instruction G).							
Name of OIL or CONDENSATE Gatherer(s) - List Highest Volume Gatherer First (Attach an additional sheet in same format if more space is needed)						Percent of Take	
ORYX DELAWARE OIL TRANSPORT LLC(627137)						100.0	
<b>RRC USE ONLY:</b> Reviewer's initials: <u>RRC Staff</u> Approval date: <u>02/07/2023</u>							
<b>15. PREVIOUS OPERATOR CERTIFICATION FOR CHANGE OF OPERATOR P-4 FILING.</b> Being the PREVIOUS OPERATOR, I certify that operating responsibility for the well(s) designated in this filing, located on the subject lease has been transferred in its entirety to the above named Current Operator. I understand, as Previous Operator, that designation of the above named operator as Current Operator is not effective until this certificate is approved by the Commission.  <div style="display: flex; justify-content: space-between;"><div style="width: 45%;"><div style="border-bottom: 1px solid black; margin-bottom: 5px;">Name of Previous Operator</div><div style="border-bottom: 1px solid black; margin-bottom: 5px;">Name (print)</div><div style="border-bottom: 1px solid black; margin-bottom: 5px;">Title</div></div><div style="width: 45%;"><div style="border-bottom: 1px solid black; margin-bottom: 5px;">Signature</div><div style="display: flex; justify-content: space-between;"><div><input type="checkbox"/> <b>Authorized Employee of previous operator</b></div><div><input type="checkbox"/> <b>Authorized agent of previous operator (see instruction G)</b></div></div><div style="display: flex; justify-content: space-between;"><div style="border-bottom: 1px solid black; margin-bottom: 5px;">Date</div><div style="border-bottom: 1px solid black; margin-bottom: 5px;">Phone with area code</div></div></div></div>							
<b>16. CURRENT OPERATOR CERTIFICATION.</b> By signing this certificate as the Current Operator, I certify that all statements on this form are true and correct and I acknowledge responsibility for the regulatory compliance of the subject lease including plugging of well(s) pursuant to Rule 14. I further acknowledge that I assume responsibility for the physical operation, control, and proper plugging of each well designated in this filing. I also acknowledge that I will remain designated as the Current Operator until a new certificate designating a new Current Operator is approved by the Commission.  <div style="display: flex; justify-content: space-between;"><div style="width: 45%;"><div style="border-bottom: 1px solid black; margin-bottom: 5px;">Name (print)</div><div style="border-bottom: 1px solid black; margin-bottom: 5px;">Title</div><div style="border-bottom: 1px solid black; margin-bottom: 5px;">E-mail Address (optional)</div></div><div style="width: 45%;"><div style="border-bottom: 1px solid black; margin-bottom: 5px;">Signature</div><div style="display: flex; justify-content: space-between;"><div><input type="checkbox"/> <b>Authorized Employee of current operator</b></div><div><input checked="" type="checkbox"/> <b>Authorized agent of current operator (see instruction G)</b></div></div><div style="display: flex; justify-content: space-between;"><div style="border-bottom: 1px solid black; margin-bottom: 5px;">Date</div><div style="border-bottom: 1px solid black; margin-bottom: 5px;">Phone with area code</div></div></div></div>							



## Form P-16

Page 1  
Rev. 06/2022

Filer is the owner or lessee, or has been authorized by the owner or lessee, of all or an undivided portion of the mineral estate under each tract for which filer is listed as operator below. For all leases operated by other entities, the number of assigned acres shown are reflected on current Commission records or the filer has been authorized by the current operator to change the assigned acreage of that operator as shown below.

SECTION I. OPERATOR INFORMATION			
Operator Name:	PERCUSSION PETROLEUM OPER. II, LLC	Operator P-5 No.:	653216
Operator Address:	1001 FANNIN ST. SUITE 2200 HOUSTON, TX 77002		

SECTION II. WELL INFORMATION					
District No.:	08	API No.:	42-495-34698	Purpose of Filing:	
Well No.:	8H	Drilling Permit No.:	876973	<input type="checkbox"/>	Form W-1
Lease Name:	UL YELLOWTAIL WEST H 21-29-17 WB	RRC ID or Lease No.:		<input checked="" type="checkbox"/>	Form G-1/W-2
Total Lease Acres:	1281.400	Field Name:	PHANTOM (WOLFCAMP)	Ownership Interval:	
Proration Acres:	80.000	Field No.:	71052900		
Wellbore Profile:	PSA Well	Is this a UFT field?:	Yes		
SL Record (Parent) Well Drilling Permit No.:		County:	WINKLER	Upper:	
				Lower:	

SECTION III. LISTING OF ALL WELLS IN THE REGULATORY FIELD ON THE SAME ACREAGE AS THE LEASE, POOLED UNIT, OR UNITIZED TRACT DESIGNATED IN SECTION II ABOVE BY FILER							
RRC ID No. or Lease No.	Well No.	Profile	Lease Name	API No.	Acre Assigned	SWR 38 Except. (Y/N)	Operator Name and Operator No.  (if different from filing operator)
A. Total Assigned Horiz. Acreage =			C. Total Assigned Acreage =				
Total Remaining Horiz. Acreage =			Total Remaining Acreage =				
B. Total Assigned Vert./Dir. Acreage =							
Total Remaining Vert./Dir. Acreage =							

SECTION IV. REMARKS - REQUIRED FOR PSA AND CO-DEVELOPMENT <i>(refer to instructions)</i>	
PERCUSSION PETROLEUM HAS AT LEAST 65% OPERATING RIGHTS FROM MINERAL AND WORKING INTERESTS IN EACH TRACT.	

Attach Additional Pages As Needed. ☐ No additional pages ☒ Additional Pages: 1 (No. of additional pages)

CERTIFICATION: I declare under penalties prescribed in Sec. 91.143, Texas Natural Resources Code, that this report was prepared by me or under my supervision or direction, that I am authorized to make this report, and that the information contained in this report is true, correct, and complete to the best of my knowledge.

Karen Zornes  
Signature

**KAREN ZORNES-REGULATORY CONSULTANT**  
Name and title (type or print)

**Email**  
(include email address *only* if you affirmatively consent to its public release)

911 REGIONAL PARK DR	HOUSTON	TX	77060	(281) 872-9300			11/18/22		
Address	City,	State,	Zip Code	Tel:	Area Code	Number	Date:	mo.	day yr.



# RAILROAD COMMISSION OF TEXAS

**1701 N. Congress  
P.O. Box 12967  
Austin, Texas 78701-2967**

Form P-16

Page 2

Rev. 06/2022

## Acreage Designation

Filer is the owner or lessee of all or an undivided portion of the minerals under each tract listed below and has the legal right to drill on each tract traversed by the well that will have perforations or other take points open in the interval of the applied-for field(s). All tracts listed will actually be traversed by the wellbore or the filer has pooling authority or other contractual authority, such as a production sharing agreement, authorizing inclusion of the non-drill site tract in the acreage assigned to the well.

**SECTION V. LISTING OF ALL TRACTS CONTRIBUTING ACREAGE TO AN RRC DESIGNATED DEVELOPMENTAL UNIT THAT IS NOT A SINGLE LEASE, POOLED UNIT, OR GROUP OF TRACTS UNITIZED BY CONTRACT FOR PURPOSES OF SECONDARY RECOVERY**

RRC ID No., Lease No. or Tract ID		Lease Name	Beginning Lease Acres	Ownership Interval (Upper)	Ownership Interval (Lower)	Operator Name and Operator No. (if different from filing operator)
A	57779	UL 21 STAMPEDE	640.700			
B	UNIVERSITY LAND	UNIVERSITY LANDS, SEC 20, BLOCK 21	640.700			
C						
D						
E						
F						
G						
H						
Total Acreage =			1281.400			

Filer is the owner or lessee, or has been authorized by the owner or lessee, of all or an undivided portion of the mineral estate under each tract for which filer is listed as operator below. For all leases operated by other entities, the number of assigned acres shown are reflected on current Commission records or the filer has been authorized by the current operator to change the assigned acreage of that operator as shown below.

**SECTION VI. LISTING OF ALL WELLS IN THE REGULATORY FIELD AS LISTED IN SECTION II, AND ALLOCATING ACREAGE FROM ANY OR ALL TRACTS LISTED IN SECTION V BY FILER**

RRC ID No. or Lease No.	Lease Name	API No.	Well No.	Profile	SWR 38 Except. (Y/N)	*Total Acres Assigned	Aces From A 57779	Aces From B UNIVERSITYLAND	Aces From	Aces From	Aces From	Aces From	Aces From	Aces From
49015	UL 21 YELLOWTAIL	495-33769	1H	PSA	N	80.000	40.000	40.000						
56749	UL YELLOWTAIL B 21-29-17	495-33952	2H	PSA	N	80.000	40.000	40.000						
56750	UL YELLOWTAIL C 21-29-17 TB	495-34040	3H	PSA	N	80.000	40.000	40.000						
876937	UL YELLOWTAIL WEST D 21-29-17 TB	495-34694	4H	PSA	N	80.000	40.000	40.000						
57779	UL 21 STAMPEDE	495-33896	2H	Horiz.	N	80.000	80.000							
876941	UL YELLOWTAIL WEST E 21-29-17 WB	495-34695	5H	PSA	N	80.000	40.000	40.000						
876953	UL YELLOWTAIL WEST G 21-29-17 WA	495-34697	7H	PSA	N	80.000	40.000	40.000						
876973	UL YELLOWTAIL WEST H 21-29-17 WB	495-34698	8H	PSA	N	80.000	40.000	40.000						
<b>A. Total Assigned Acreage =</b>							<b>360.000</b>	<b>280.000</b>						
<b>B. Total Assigned Horiz. Acreage =</b>							<b>360.000</b>	<b>280.000</b>						
<b>C. Total Assigned Vert./Dir. Acreage =</b>							<b>0.000</b>	<b>0.000</b>						

\*A revised P-16 is required if increasing the proration acreage on an existing Allocation or PSA well utilizing acreage from a regulatory lease or undeveloped tract not listed in Section V. (refer to instructions)

## GROUNDWATER PROTECTION DETERMINATION

Form GW-2



## Groundwater Advisory Unit

**Date Issued:** 15 November 2021**GAU Number:** 321773**Attention:** PERCUSSION PETROLEUM  
1001 FANNIN ST STE 2200  
HOUSTON, TX 77002**Operator No.:** 653216**API Number:**  
**County:** WINKLER  
**Lease Name:** UL YELLOWTAIL F 21-29-17  
**Lease Number:**  
**Well Number:** 6H  
**Total Vertical** 13500  
**Latitude:** 31.712953  
**Longitude:** -103.237140  
**Datum:** NAD27**Purpose:** New Production Well**Location:** Survey-UL; Abstract-U69; Section-28

To protect usable-quality groundwater at this location, the Groundwater Advisory Unit of the Railroad Commission of Texas recommends:

The interval from the land surface to the base of the Santa Rosa, which is estimated to occur at a depth of 650 feet, must be protected.

This recommendation is applicable for all wells drilled in this abstract U69.

Note: Unless stated otherwise, this recommendation is intended to apply to all wells drilled within 200 feet of the subject well. Unless stated otherwise, this recommendation is for normal drilling, production, and plugging operations only.

This determination is based on information provided when the application was submitted on 11/12/2021. If the location information has changed, you must contact the Groundwater Advisory Unit, and submit a new application if necessary. If you have questions, please contact us at 512-463-2741 or gau@rrc.texas.gov.

Groundwater Advisory Unit, Oil and Gas Division

Form GW-2 P.O. Box 12967 Austin, Texas 78771-2967 512-463-2741 Internet address: www.rrc.texas.  
Rev. 02/2014



UNIVERSITY LAND  
SECTION 7, BLOCK 21

UNIVERSITY LAND  
SECTION 8, BLOCK 21

UNIVERSITY LAND  
SECTION 9, BLOCK 21

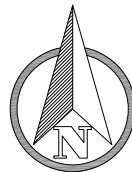

0 1000' 2000'  
1" = 2000 FEET

LAST TAKE POINT  
MD = 20,741'  
X = 764,355.64  
Y = 1,093,628.63  
LAT. = 31.735636°  
LONG. = 103.249003°

UNIVERSITY LAND  
SECTION 18, BLOCK 21

UNIVERSITY LAND  
SECTION 19, BLOCK 21

FIRST TAKE POINT  
MD = 12,481'  
X = 756,433.42  
Y = 1,095,885.09  
LAT. = 31.714027°  
LONG. = 103.241082°

UNIVERSITY LAND  
SECTION 30, BLOCK 21

UNIVERSITY LAND  
SECTION 16, BLOCK 21

UNIVERSITY LAND  
SECTION 21, BLOCK 21

UNIVERSITY LAND  
SECTION 28, BLOCK 21

UNIVERSITY LAND  
SECTION 29, BLOCK 21

### LEGEND

— SURVEY LINE

LEASE	SECTION	ACRES	LATERAL LENGTH
#115754	UNIVERSITY LANDS, SEC 20, BLK 21	640.70	5,128.06'
#115752	UNIVERSITY LANDS, SEC 17, BLK 21	640.70	3,123.55'
TOTALS		1281.40	8,251.61'

### GENERAL NOTES

- COORDINATES SHOWN ARE BASED ON TEXAS PLANE COORDINATE SYSTEM OF NAD 27, TEXAS CENTRAL ZONE 4203.
- VERTICAL DATUM IS NAVD 88
- LATITUDE AND LONGITUDE ARE NAD 27 AS SHOWN
- AREA, DISTANCES, AND COORDINATES ARE "GRID".
- UNITS ARE UNITED STATES SURVEY FOOT.
- ALL LEASE AND TRACT INFORMATION SHOWN HERE ON IS DONE SO BY LIMITED DEED RECORD INFORMATION ONLY.
- ALL ACREAGES SHOWN ARE BY DEED AND LEASE CALL, EXCEPT WHERE NOTED.
- THIS IS NOT IN ANY WAY A "BOUNDARY SURVEY".

I HEREBY STATE THAT THIS PLAT  
SHOWS THE SUBJECT SURFACE  
LOCATION AS STAKED ON THE GROUND.

JOHN E. KOWALIK  
REGISTERED PROFESSIONAL LAND SURVEYOR  
STATE OF TEXAS NO. 6408

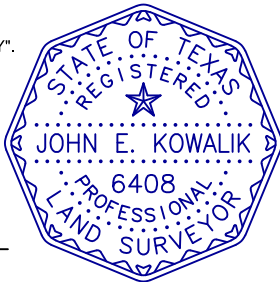

OFFSET OPERATOR:  
WPX ENERGY PERMIAN,  
LLC.

### WELL LOCATION INFORMATION

SHL	KOP	POP
590' FNL & 1598' FWL OUT OF LEASE NAD 27 TXC	194' FNL & 2375' FEL OUT OF LEASE NAD 27 TXC	189' FNL & 2360' FEL OUT OF LEASE NAD 27 TXC
Y = 755,385.80	Y = 756,133.33	Y = 756,143.06
X = 1,095,001.63	X = 1,096,146.64	X = 1,096,159.48
LAT. = 31.711084 °N	LAT. = 31.713221 °N	LAT. = 31.713248 °N
LONG. = 103.243834 °W	LONG. = 103.240216 °W	LONG. = 103.240175 °W
NAD 83 TXC	NAD 83 TXC	NAD 83 TXC
Y = 10,597,962.40	Y = 10,598,709.94	Y = 10,598,719.67
X = 1,391,466.07	X = 1,392,611.09	X = 1,392,623.93
LAT. = 31.711214 °N	LAT. = 31.713351 °N	LAT. = 31.713379 °N
LONG. = 103.244282 °W	LONG. = 103.240664 °W	LONG. = 103.240623 °W
FTP	LTP	BHL
167' FSLL & 2542' FELL NAD 27 TXC	2168' FNLL & 2488' FELL NAD 27 TXC	2016' FNL & 2493' FEL 2016' FNLL & 2493' FELL NAD 27 TXC
Y = 756,433.42	Y = 764,355.64	Y = 764,500.09
X = 1,095,885.09	X = 1,093,628.63	X = 1,093,581.35
LAT. = 31.714027 °N	LAT. = 31.735636 °N	LAT. = 31.736029 °N
LONG. = 103.241082 °W	LONG. = 103.249003 °W	LONG. = 103.249167 °W
NAD 83 TXC	NAD 83 TXC	NAD 83 TXC
Y = 10,599,010.04	Y = 10,606,932.43	Y = 10,607,076.89
X = 1,392,349.53	X = 1,390,092.93	X = 1,390,045.64
LAT. = 31.714157 °N	LAT. = 31.735765 °N	LAT. = 31.736159 °N
LONG. = 103.241530 °W	LONG. = 103.249452 °W	LONG. = 103.249616 °W

### PLAT OF:

A FINAL AS-DRILLED WELL LOCATION FOR:  
**PERCUSSION PETROLEUM OPER II, LLC.**  
**UL YELLOWTAIL WEST H 21-29-17 WB 8H**  
SITUATED IN THE UNIVERSITY LAND, SECTIONS 29, 20, AND  
17, BLOCK 21, AND BEING APPROXIMATELY 5.2 MILES  
SOUTHWEST OF WINK IN WINKLER COUNTY, TEXAS.

DATE: 09-22-2022  
DRAWN BY: JC  
CHECKED BY: LS  
FIELD CREW: DN  
PROJECT NO: 2022010078  
SCALE: 1" = 2000'  
SHEET: 1 OF 1  
REVISION: 0



550 Bailey Ave., 205 - Fort Worth, TX 76107  
Ph: 817.349.9800 - Fax: 979.732.5271  
TBPE Firm 17957 | TBPLS Firm 10193887  
www.fscinc.net

© COPYRIGHT 2016 - ALL RIGHTS RESERVED