



Railroad Commission of Texas

Form W-2

1701 N. Congress
P.O. Box 12967
Austin, Texas 78701-2967

Status: Approved
Date: 01/10/2023
Tracking No.: 281376

OIL WELL POTENTIAL TEST, COMPLETION OR RECOMPLETION REPORT,

| Operator Information | | | |
|----------------------|--|----------|--------|
| Operator | PERCUSSION PETROLEUM OPER II,LLC | Operator | 653216 |
| Operator | 1001 FANNIN STREET STE 2200 HOUSTON, TX 77002- | | |

| Well Information | | | |
|--|---|--------------|--------------------|
| API | 42-495-34697 | County: | WINKLER |
| Well No.: | 7H | RRC District | 08 |
| Lease | UL YELLOWTAIL WEST G 21-29-17 WA | Field | PHANTOM (WOLFCAMP) |
| RRC Lease | 58184 | Field No.: | 71052900 |
| Location | Section: 29, Block: 21, Survey: UL, Abstract: | | |
| Latitude | 31.711063 | Longitud | -103.243910 |
| This well is 5.2 miles in a SW direction from WINK, which is the nearest town in the | | | |

| Filing Information | | | |
|--|-------------------|----------------------------|------------|
| Purpose of | Initial Potential | | |
| Type of | New Well | | |
| Well Type: | Producing | Completion or Recompletion | 09/16/2022 |
| Type of Permit | Date | Permit No. | |
| Permit to Drill, Plug Back, or Rule 37 Exception | 03/28/2022 | 876953 | |
| Fluid Injection | | | |
| O&G Waste Disposal | | | |
| Other: | | | |

| Completion Information | | | |
|---|--|--|------------|
| Spud | 03/28/2022 | Date of first production after rig | 09/16/2022 |
| Date plug back, deepening, drilling operation | 03/28/2022 | Date plug back, deepening, recompletion, drilling operation | 07/05/2022 |
| Number of producing wells on this lease this field (reservoir) including this | 8 | Distance to nearest well in lease & reservoir | 400.0 |
| Total number of acres in | 1281.40 | Elevation | 2764 GL |
| Total depth TVD | 11847 | Total depth MD | 22506 |
| Plug back depth TVD | | Plug back depth MD | |
| Was directional survey made other inclination (Form W- | Yes | Rotation time within surface casing Is Cementing Affidavit (Form W-15) | 107.0 Yes |
| Recompletion or | No | Multiple | No |
| Type(s) of electric or other log(s) | Gamma Ray (MWD) | | |
| Electric Log Other Description: | | | |
| Location of well, relative to nearest lease of lease on which this well is | 590.0 Feet from the North Line and 1573.0 Feet from the West Line of the UL YELLOWTAIL WEST G 21-29-17 WA Lease. | Off Lease : | Yes |

| Former Field (With Reservoir) & Gas ID or Oil Lease No. | | | |
|---|---------------------|----------|--------------------|
| Field & Reservoir | Gas ID or Oil Lease | Well No. | Prior Service Type |
| PACKET: | N/A | | |

| | | | |
|--|-------|--------|-----------------|
| W2: | N/A | | |
| FOR NEW DRILL OR RE-ENTRY, SURFACE CASING DEPTH DETERMINED BY: | | | |
| GAU Groundwater Protection Determination | Depth | 650.0 | Date 11/15/2021 |
| SWR 13 Exception | Depth | 5300.0 | |

| | | | |
|--|------------|-----------------------|---------|
| INITIAL POTENTIAL TEST DATA FOR NEW COMPLETION OR RECOMPLETION | | | |
| Date of | 10/07/2022 | Production | Flowing |
| Number of hours | 24 | Choke | .46875 |
| Was swab used during this | No | Oil produced prior to | 8467.00 |
| PRODUCTION DURING TEST PERIOD: | | | |
| Oil | 827.00 | Gas | 845 |
| Gas - Oil | 1021 | Flowing Tubing | 1443.00 |
| Water | 3501 | | |
| CALCULATED 24-HOUR RATE | | | |
| Oil | 827.0 | Gas | 845 |
| Oil Gravity - API - 60.: | 42.0 | Casing | 1465.00 |
| Water | 3501 | | |

| CASING RECORD | | | | | | | | | | | |
|---------------|-------------------------|------------|--------|---------|------------|------------|--------|--------|--------------|--------------|-----------------------|
| Ro | Type of Casing | Casing | Hole | Setting | Multi - | Multi - | Cement | Cement | Slurry | Top of | TOC |
| | | Size (in.) | Size | Depth | Stage Tool | Stage Shoe | Class | Amoun | Volume (cu.) | Cement (ft.) | Determined By |
| 1 | Surface | 10 3/4 | 12 3/4 | 5122 | | | C | 2755 | 4813.0 | 0 | Circulated to Surface |
| 2 | Intermediate | 7 5/8 | 8 3/4 | 11261 | | | H | 625 | 1477.0 | 5010 | Calculation |
| 3 | Intermediate | 7 5/8 | 8 3/4 | 11261 | 5010 | | C | 355 | 820.0 | 0 | Circulated to Surface |
| 4 | Conventional Production | 5 1/2 | 6 3/4 | 22486 | | | H | 1340 | 1698.0 | 4156 | Calculation |

| LINER RECORD | | | | | | | | | |
|--------------|------------|-----------|-----------|--------------|--------------|--------------|---------------------|---------------------|----------------|
| Ro | Liner Size | Hole Size | Liner Top | Liner Bottom | Cement Class | Cement Amoun | Slurry Volume (cu.) | Top of Cement (ft.) | TOC Determined |
| N/A | | | | | | | | | |

| TUBING RECORD | | | |
|---------------|-------------------|---|-------------------|
| <u>Ro</u> | <u>Size (in.)</u> | <u>Depth</u> | <u>Size (ft.)</u> |
| | | <u>Packer Depth (ft.)</u> / <u>Type</u> | |
| | | | |
| | | | |
| / | | | |
| N/A | | | |

| PRODUCING/INJECTION/DISPOSAL INTERVAL | | | |
|---------------------------------------|------------|------------|----------|
| Ro | Open hole? | From (ft.) | To (ft.) |
| 1 | No | L1 12045 | 22405.0 |

| ACID, FRACTURE, CEMENT SQUEEZE, CAST IRON BRIDGE PLUG, RETAINER, ETC. | | | | | |
|---|--------------------------|---|----------------------------|-----------------------------|---------|
| Was hydraulic fracturing treatment | | Yes | | | |
| Is well equipped with a downhole sleeve? | | Yes | If yes, actuation pressure | | 11180.0 |
| Production casing test pressure (PSIG) | | Actual maximum pressure (PSIG) during | | | |
| hydraulic fracturing | 13000 | fracturin | 11750 | | |
| Has the hydraulic fracturing fluid disclosure been | | Yes | | | |
| <u>Ro</u> | <u>Type of Operation</u> | <u>Amount and Kind of Material Used</u> | | <u>Depth Interval (ft.)</u> | |
| 1 | Fracture | SEE FRAC FOCUS | | 12045 | 22405 |

| FORMATION RECORD | | | | | |
|---|------------|-----------|----------|--------------|------------------|
| Formations | Encountere | Depth TVD | Depth MD | Is formation | Remarks |
| RUSTLER - POSSIBLE FLOW; POSSIBLE USABLE QUALITY W | No | | | No | NOT IN THIS AREA |
| COLBY / QUEEN | No | | | No | NOT IN THIS AREA |
| YATES | No | | | No | NOT IN THIS AREA |
| SEVEN RIVERS / QUEEN | No | | | No | NOT IN THIS AREA |
| CAPITAN REEF - HIGH FLOWS | No | | | No | NOT IN THIS AREA |
| SAN ANDRES - HIGH FLOWS, H2S, CORROSIVE | No | | | No | NOT IN THIS AREA |
| DELAWARE | Yes | 5101.0 | 5154.0 | Yes | |
| GLORIETA | No | | | No | NOT IN THIS AREA |
| HOLT | No | | | No | NOT IN THIS AREA |
| CLEARFORK | No | | | No | NOT IN THIS AREA |
| CHERRY CANYON | Yes | 5985.0 | 6043.0 | Yes | |
| BRUSHY CANYON | No | | | No | NOT IN THIS AREA |
| BONE SPRING | Yes | 8767.0 | 8828.0 | Yes | |
| 2ND BONE SPRING | Yes | 10091.0 | 10153.0 | Yes | |
| 3RD BONE SPRING | Yes | 10770.0 | 10833.0 | Yes | |
| WICHITA ALBANY | No | | | No | NOT IN THIS AREA |
| WOLFCAMP | Yes | 11727.0 | 11902.0 | Yes | |
| PENNSYLVANIAN | No | | | No | BELOW TD |
| CANYON | No | | | No | BELOW TD |
| STRAWN | No | | | No | BELOW TD |
| ATOKA | No | | | No | BELOW TD |
| MISSISSIPPIAN | No | | | No | BELOW TD |
| DEVONIAN | No | | | No | BELOW TD |
| SILURIAN | No | | | No | BELOW TD |
| FUSSELMAN | No | | | No | BELOW TD |
| MONTOYA | No | | | No | BELOW TD |
| WADDELL | No | | | No | BELOW TD |
| ELLENBURGER | No | | | No | BELOW TD |
| PRECAMBRIAN (UNDIFFERENTIATED) | No | | | No | BELOW TD |

Do the producing interval of this well produce H2S with a concentration in excess of 100 ppm

No

Is the completion being downhole commingled

No

REMARKS

KOP-11298

RRC REMARKS

PUBLIC COMMENTS:

[RRC Staff 2023-01-09 13:34:34.531] EDL=10360 feet, max acres=704, PHANTOM (WOLFCAMP) oil or gas well

CASING RECORD :

TUBING RECORD:

WILL BE SET AT LATER DATE

PRODUCING/INJECTION/DISPOSAL INTERVAL :

ACID, FRACTURE, CEMENT SQUEEZE, CAST IRON BRIDGE PLUG, RETAINER, ETC. :

POTENTIAL TEST DATA:

| OPERATOR'S CERTIFICATION | | | |
|--------------------------|----------------|--------|------------|
| Printed | Karen Zornes | Title: | |
| Telephone | (281) 872-9300 | Date | 11/17/2022 |



RAILROAD COMMISSION OF TEXAS

1701 N. Congress
P.O. Box 12967
Austin, Texas 78701-2967

Form W-15

Rev. 08/2014

CEMENTING REPORT

Cementer: Fill in shaded areas.
Operator: Fill in other items.

OPERATOR INFORMATION

Operator Name: Percussion Petroleum OPER. II, LLC Operator P-5 No.: 653216
Cementer Name: West Texas Cementers Cementer P-5 No.: 910261

WELL INFORMATION

District No.: 08 County: Winkler
Well No.: 7H API No.: 42-495-34697 ILLING Permit No.: 876953
Lease Name: UL YELLOWTAIL WEST G 21-29-17 WA Lease No.:
Field Name: PHANTOM (WOLFCAMP) Field No.: 71052900

I. CASING CEMENTING DATA

Type of Casing: ☐ Conductor ☐ Surface ☐ Intermediate ☐ Liner ☐ Production
Drilled hole size (in.): Depth of drilled hole (ft.): Est. % wash-out or hole enlargement:
Size of casing in O.D. (in.): Casing weight (lbs/ft) and grade: No. of centralizers used:
Was cement circulated to ground surface (or bottom of cellar) outside casing? ☐ YES ☐ NO If no for surface casing, explain in Remarks. Setting depth shoe (ft.): Top of liner (ft.):
Setting depth liner (ft.):
Hrs. waiting on cement before drill-out: Calculated top of cement (ft.): Cementing date:

SLURRY

| Slurry No. | No. of Sacks | Class | Additives | Volume (cu. ft.) | Height (ft.) |
|------------|--------------|-------|-----------|------------------|--------------|
| 1 | | | | | |
| 2 | | | | | |
| 3 | | | | | |
| Total | 0 | | | 0 | 0 |

II. CASING CEMENTING DATA

Type of casing: ☒ Surface ☐ Intermediate ☐ Production ☐ Tapered production Multi-stage cement shoe ☐ Multiple parallel strings
Drilled hole size (in.): 12 1/4 Depth of drilled hole (ft.): 5140 Est. % wash-out or hole enlargement: 38
Size of casing in O.D. (in.): 10 3/4 Casing weight (lbs/ft) and grade: 45.5 J-55 No. of centralizers used: 35
Tapered string drilled hole size (in.) Tapered string depth of drilled hole (ft.)
Upper: Lower: Upper: Lower:
Tapered string size of casing in O.D. (in.) Tapered string casing weight (lbs/ft) and grade Tapered string no. of centralizers used
Upper: Lower: Upper: Lower:
Was cement circulated to ground surface (or bottom of cellar) outside casing? YES ☒ NO ☐ Setting depth shoe (ft.): 5122
Hrs. waiting on cement before drill-out: 24+ Calculated top of cement (ft.): 0 Cementing date: 3/29/2022

SLURRY

| Slurry No. | No. of Sacks | Class | Additives | Volume (cu. ft.) | Height (ft.) |
|------------|--------------|---------|-----------|------------------|--------------|
| 1 | 2015 | Class C | Remarks | 3829 | 12222 |
| 2 | 740 | Class C | Remarks | 984 | 3136 |
| 3 | | | | | |
| Total | 2755 | | | 4813 | 15358 |

III. CASING CEMENTING DATA

Type of casing: ☒ Surface ☐ Intermediate ☐ Production ☐ Tapered production ☒ Multi-stage cement/DV tool ☐ Multiple parallel strings
Drilled hole size (in.): Depth of drilled hole (ft.): Est. % wash-out or hole enlargement:
Size of casing in O.D. (in.): Casing weight (lbs/ft) and grade: No. of centralizers used:
Tapered string drilled hole size (in.) Tapered string depth of drilled hole (ft.)
Upper: Lower: Upper: Lower:
Tapered string size of casing in O.D. (in.) Tapered string casing weight (lbs/ft) and grade Tapered string no. of centralizers used
Upper: Lower: Upper: Lower:
Was cement circulated to ground surface (or bottom of cellar) outside casing? YES ☐ NO ☐ Setting depth shoe (ft.):
Hrs. waiting on cement before drill-out: Calculated top of cement (ft.): Cementing date:

SLURRY

| Slurry No. | No. of Sacks | Class | Additives | Volume (cu. ft.) | Height (ft.) |
|------------|--------------|-------|-----------|------------------|--------------|
| 1 | | | | | |
| 2 | | | | | |
| 3 | | | | | |
| Total | 0 | | | 0 | 0 |

| CEMENTING TO SQUEEZE, PLUG BACK OR PLUG AND ABANDON | | | | | | | |
|--|---------|---------|---------|---------|---------|---------|---------|
| | PLUG #1 | PLUG #2 | PLUG #3 | PLUG #4 | PLUG #5 | PLUG #6 | PLUG #7 |
| Cementing Date | | | | | | | |
| Size of hole or pipe (in.) | | | | | | | |
| Depth to bottom of tubing or drill pipe (ft.) | | | | | | | |
| Cement retainer setting depth (ft.) | | | | | | | |
| CIBP setting depth (ft.) | | | | | | | |
| Amount of cement on top of CIBP (ft.) | | | | | | | |
| Sacks of cement used | | | | | | | |
| Slurry volume pumped (cu. ft.) | | | | | | | |
| Calculated top of plug (ft.) | | | | | | | |
| Measured top of plug, if tagged (ft.) | | | | | | | |
| Slurry weight (lbs/gal) | | | | | | | |
| Class/type of cement | | | | | | | |
| Perforate and squeeze (YES/NO) | | | | | | | |
| REMARKS | | | | | | | |
| 1) 35% B Poz+65% Class C+6% Gel+5% SALT+0.2% R-1300+0.25PPS Pol-E-Flake+0.005GPS | | | | | | | |
| 2) 100% Class C+0.05% C-20+0.005GPS | | | | | | | |
| Cement to surface on first stage/No second stage | | | | | | | |

CEMENTER'S CERTIFICATE: I declare under penalties prescribed in Sec. 91.143, Texas Natural Resources Code, that I am authorized to make this certification, that the cementing of casing and/or the placing of cement plugs in this well as shown in the report was performed by me or under my supervision, and that the cementing data and facts presented on both sides of this form are true, correct, and complete, to the best of my knowledge. This certification covers cementing data only.

Lee Herrera/Service Supervisor

Name and title of cementer's representative

West Texas Cementers
Cementing Company

Signature

1400 S JBS Parkway

Address

Odessa, Tx. 79766

City, State, Zip Code

432-220-0100

Tel: Area Code

Number

3/29/2022

Date: mo. day yr.

OPERATOR'S CERTIFICATE: I declare under penalties prescribed in Sec. 91.143, Texas Natural Resources Code, that I am authorized to make this certification, that I have knowledge of the well data and information presented in this report, and that data and facts presented on both sides of this form are true, correct, and complete, to the best of my knowledge. This certification covers all well data.

Elwyn Evans

Typed or printed name of operator's representative

Drilling Supervisor

Title

Signature

1001 Fannin St Suite 200 Houston Tx 77002

Address

City, State, Zip Code

713-518-1331

Tel: Area Code

Number

03/30/22

Date: mo. day yr.

Instructions for Form W-15, Cementing Report

NOTICE: The Form W-15 must be submitted as an attachment to a Form G-1 (Gas Well Back Pressure Test, Completion or Recompletion Report, and Log), Form W-2 (Oil Well Potential Test, Completion or Recompletion Report, and Log), Form W-3 (Plugging Record), or Form W-4 (Application for Multiple Completion), any time cement is pumped in a wellbore.

A. **What to file:** An operator should file an original and one copy of the completed Form W-15 for each cementing company used on a well. The cementing of different casing strings on a well by one cementing company may be reported on one form.

The Form W-15 should be filed with the Form W-3, Plugging Record, unless the Form W-3 is signed by the cementing company representative. When reporting dry holes, operators must complete Form W-15, in addition to Form W-3, to show any casing cemented in the hole.

B. **How to file:** An oil and gas completion report and Form W-15 may be filed online using the Commission's Online System

(<https://webapps.rrc.state.tx.us/security/login.do>) or a paper copy of the form may be mailed to the Commission in Austin (P.O. Box 12967, Austin, Texas 787112967).

C. **Surface casing:** An operator must set and cement sufficient surface casing to protect all usable-quality water strata, as defined by the Groundwater Advisory Unit in Austin. Sufficient cement shall be used to fill the annular space outside the casing from the shoe to the ground surface or to the bottom of the cellar. Before drilling a well, an operator must obtain a letter from the Groundwater Advisory Unit stating the protection depth. Surface casing should not be set deeper than 200 feet below the specified depth without prior approval from the Commission.

To plug and abandon a well, operators must use only cementers approved by the Commission's Director of Field Operations in accordance with SWR 14 ([http://info.sos.state.tx.us/pls/pub/readtac\\$ext.TacPage?sl=R&app=9&p_dir=&p_rloc=&p_tloc=&p_ploc=&pg=1&p_tac=&ti=16&pt=1&ch=3&rl=14](http://info.sos.state.tx.us/pls/pub/readtac$ext.TacPage?sl=R&app=9&p_dir=&p_rloc=&p_tloc=&p_ploc=&pg=1&p_tac=&ti=16&pt=1&ch=3&rl=14)). Cementing companies, service companies, or operators can qualify as approved cementers by demonstrating that they are able to mix and pump cement in compliance with Commission rules and regulations.

D. **Estimated % wash-out:** If the estimated % wash-out is less than 20% (or 30% along the Gulf Coast), provide supporting documentation such as a caliper log to show how the estimated % wash-out was obtained.

E. **Multi-stage cement:** An operator must report the multi-stage cement shoe in II. Casing Cementing Data section by selecting the type of casing and Multi-stage cement shoe. The operator must report the multi-stage cement tool in III. Casing Cementing Data section by selecting the type of casing and Multi-stage cement/DV tool.

F. **Multiple parallel strings:** An operator should file the Form W-15 as an attachment to the Form W-4, Application for Multiple Completion. An operator may be required to submit multiple Form W-15s to show all data for multiple parallel strings.

G. **Slurry data:** If cement job exceeds three slurries, continue the list of slurries in the Slurry table in the subsequent Casing Cementing Data box.



RAILROAD COMMISSION OF TEXAS

1701 N. Congress
P.O. Box 12967
Austin, Texas 78701-2967

Form W-15

Rev. 08/2014

CEMENTING REPORT

Cementer: Fill in shaded areas.
Operator: Fill in other items.

| OPERATOR INFORMATION | | | | | |
|---|--------------|---|-----------|---|--------------|
| Operator Name: Percussion Petroleum OPER, II, LLC | | Operator P-5 No.: 653216 | | | |
| Cementer Name: West Texas Cementers | | Cementer P-5 No.: 910261 | | | |
| WELL INFORMATION | | | | | |
| District No.: 08 7H | | County: Winkler | | | |
| Well No.: 7H | | API No.: 42-495-34697 | | Drilling Permit No.: 876953 | |
| Lease Name: UL YELLOWTAIL WEST G 21-29-17 WA | | Lease No.: | | | |
| Field Name: PHANTOM (WOLFCAMP) | | Field No.: 71052900 | | | |
| I. CASING CEMENTING DATA | | | | | |
| Type of Casing: <input type="checkbox"/> Conductor <input type="checkbox"/> Surface <input type="checkbox"/> Intermediate <input type="checkbox"/> Liner <input type="checkbox"/> Production | | | | | |
| Drilled hole size (in.): | | Depth of drilled hole (ft.): | | Est. % wash-out or hole enlargement: | |
| Size of casing in O.D. (in.): | | Casing weight (lbs/ft) and grade: | | No. of centralizers used: | |
| Was cement circulated to ground surface (or bottom of cellar) outside casing? <input type="checkbox"/> YES <input type="checkbox"/> NO If no for surface casing, explain in Remarks. | | Setting depth shoe (ft.): | | Top of liner (ft.): | |
| | | | | Setting depth liner (ft.): | |
| Hrs. waiting on cement before drill-out: | | Calculated top of cement (ft.): | | Cementing date: | |
| SLURRY | | | | | |
| Slurry No. | No. of Sacks | Class | Additives | Volume (cu. ft.) | Height (ft.) |
| 1 | | | | | |
| 2 | | | | | |
| 3 | | | | | |
| Total | 0 | | | 0 | 0 |
| II. CASING CEMENTING DATA | | | | | |
| Type of casing: <input type="checkbox"/> Surface <input checked="" type="checkbox"/> Intermediate <input type="checkbox"/> Production <input type="checkbox"/> Tapered production <input checked="" type="checkbox"/> Multi-stage cement shoe <input type="checkbox"/> Multiple parallel strings | | | | | |
| Drilled hole size (in.): 8 3/4 | | Depth of drilled hole (ft.): 11280 | | Est. % wash-out or hole enlargement: 0 | |
| Size of casing in O.D. (in.): 7 5/8 | | Casing weight (lbs/ft) and grade: 29.7 L-80 | | No. of centralizers used: 36 | |
| Tapered string drilled hole size (in.) | | Tapered string depth of drilled hole (ft.) | | | |
| Upper: | | Lower: | | Upper: | |
| Tapered string size of casing in O.D. (in.) | | Tapered string casing weight (lbs/ft) and grade | | Tapered string no. of centralizers used | |
| Upper: | | Lower: | | Upper: | |
| Was cement circulated to ground surface (or bottom of cellar) outside casing? YES <input type="checkbox"/> NO <input checked="" type="checkbox"/> | | Setting depth shoe (ft.): 11261 | | | |
| Hrs. waiting on cement before drill-out: | | Calculated top of cement (ft.): 5010 D.V.TOOL | | Cementing date: 4/20/2022 | |
| SLURRY | | | | | |
| Slurry No. | No. of Sacks | Class | Additives | Volume (cu. ft.) | Height (ft.) |
| 1 | 560 | 50% BPOZ/H | REMARK 1 | 1400 | 13277 |
| 2 | 65 | H | REMARK 2 | 77 | 782 |
| 3 | | | | | |
| Total | 625 | | | 1477 | 14059 |
| III. CASING CEMENTING DATA | | | | | |
| Type of casing: <input type="checkbox"/> Surface <input checked="" type="checkbox"/> Intermediate <input type="checkbox"/> Production <input type="checkbox"/> Tapered production <input checked="" type="checkbox"/> Multi-stage cement/DV tool <input type="checkbox"/> Multiple parallel strings | | | | | |
| Drilled hole size (in.): 8 3/4 | | Depth of drilled hole (ft.): 11280 | | Est. % wash-out or hole enlargement: 0 | |
| Size of casing in O.D. (in.): 7 5/8 | | Casing weight (lbs/ft) and grade: 29.7 L-80 | | No. of centralizers used: 36 | |
| Tapered string drilled hole size (in.) | | Tapered string depth of drilled hole (ft.) | | | |
| Upper: | | Lower: | | Upper: | |
| Tapered string size of casing in O.D. (in.) | | Tapered string casing weight (lbs/ft) and grade | | Tapered string no. of centralizers used | |
| Upper: | | Lower: | | Upper: | |
| Was cement circulated to ground surface (or bottom of cellar) outside casing? YES <input type="checkbox"/> NO <input checked="" type="checkbox"/> | | Setting depth shoe (ft.): 5010 | | | |
| Hrs. waiting on cement before drill-out: 0 | | Calculated top of cement (ft.): 0 | | Cementing date: 4/20/2022 | |
| SLURRY | | | | | |
| Slurry No. | No. of Sacks | Class | Additives | Volume (cu. ft.) | Height (ft.) |
| 1 | 300 | 50% B-POZ/ C | REMARK 3 | 747 | 6888 |
| 2 | 55 | C | REMARK 4 | 73 | 673 |
| 3 | | | | | |
| Total | 355 | | | 820 | 7561 |

| CEMENTING TO SQUEEZE, PLUG BACK OR PLUG AND ABANDON | | | | | | | |
|---|---------|---------|---------|---------|---------|---------|---------|
| | PLUG #1 | PLUG #2 | PLUG #3 | PLUG #4 | PLUG #5 | PLUG #6 | PLUG #7 |
| Cementing Date | | | | | | | |
| Size of hole or pipe (in.) | | | | | | | |
| Depth to bottom of tubing or drill pipe (ft.) | | | | | | | |
| Cement retainer setting depth (ft.) | | | | | | | |
| CIBP setting depth (ft.) | | | | | | | |
| Amount of cement on top of CIBP (ft.) | | | | | | | |
| Sacks of cement used | | | | | | | |
| Slurry volume pumped (cu. ft.) | | | | | | | |
| Calculated top of plug (ft.) | | | | | | | |
| Measured top of plug, if tagged (ft.) | | | | | | | |
| Slurry weight (lbs/gal) | | | | | | | |
| Class/type of cement | | | | | | | |
| Perforate and squeeze (YES/NO) | | | | | | | |
| REMARKS | | | | | | | |
| 50% B Poz+50% Class H+10% Gel+5% SALT+0.4% SuspendedCem 6302+0.55% FR-5+3PPS Gilsonite+0.25PPS Pol-E-Flake+0.005GPS | | | | | | | |
| 100% Class H+0.1% SuspendedCem 6302+0.2% C-20+0.2% C-47B+0.005GPS | | | | | | | |
| 50% B Poz+50% Class C+10% Gel+5% SALT+0.1% SuspendedCem 6302+0.2% C-20+3PPS Gilsonite+0.25PPS Pol-E-Flake+0.005GPS | | | | | | | |
| 100% Class C+0.005GPS | | | | | | | |

CEMENTER'S CERTIFICATE: I declare under penalties prescribed in Sec. 91.143, Texas Natural Resources Code, that I am authorized to make this certification, that the cementing of casing and/or the placing of cement plugs in this well as shown in the report was performed by me or under my supervision, and that the cementing data and facts presented on both sides of this form are true, correct, and complete, to the best of my knowledge. This certification covers cementing data only.

SUPERVISOR ALVARO ISAIS

Name and title of cementer's representative

West Texas Cementers

Cementing Company

Signature

1400 SOUTH JBS PARKWAY

ODESSA TX 78766

Address

City, State, Zip Code

432-227-0010

Tel: Area Code

Number

4/20/2022

Date: mo. day yr.

OPERATOR'S CERTIFICATE: I declare under penalties prescribed in Sec. 91.143, Texas Natural Resources Code, that I am authorized to make this certification, that I have knowledge of the well data and information presented in this report, and that data and facts presented on both sides of this form are true, correct, and complete, to the best of my knowledge. This certification covers all well data.

KAREN ZORNES

Typed or printed name of operator's representative

REGULATORY CONSULTANT

Title

Signature

911 REGIONAL PARK DR

HOUSTON, TX 77060

Address

City, State, Zip Code

281-872-9300

Tel: Area Code

Number

11/04/20022

Date: mo. day yr.

Instructions for Form W-15, Cementing Report

NOTICE: The Form W-15 must be submitted as an attachment to a Form G-1 (Gas Well Back Pressure Test, Completion or Recompletion Report, and Log), Form W-2 (Oil Well Potential Test, Completion or Recompletion Report, and Log), Form W-3 (Plugging Record), or Form W-4 (Application for Multiple Completion), any time cement is pumped in a wellbore.

A. **What to file:** An operator should file an original and one copy of the completed Form W-15 for each cementing company used on a well. The cementing of different casing strings on a well by one cementing company may be reported on one form. The Form W-15 should be filed with the Form W-3, Plugging Record, unless the Form W-3 is signed by the cementing company representative. When reporting dry holes, operators must complete Form W-15, in addition to Form W-3, to show any casing cemented in the hole.

B. **How to file:** An oil and gas completion report and Form W-15 may be filed online using the Commission's Online System

(<https://webapps.rrc.state.tx.us/security/login.do>) or a paper copy of the form may be mailed to the Commission in Austin (P.O. Box 12967, Austin, Texas 787112967).

C. **Surface casing:** An operator must set and cement sufficient surface casing to protect all usable-quality water strata, as defined by the Groundwater Advisory Unit in Austin. Sufficient cement shall be used to fill the annular space outside the casing from the shoe to the ground surface or to the bottom of the cellar. Before drilling a well, an operator must obtain a letter from the Groundwater Advisory Unit stating the protection depth. Surface casing should not be set deeper than 200 feet below the specified depth without prior approval from the Commission.

To plug and abandon a well, operators must use only cementers approved by the Commission's Director of Field Operations in accordance with SWR 14 ([http://info.sos.state.tx.us/pls/pub/readac\\$ext.TacPage?sl=R&app=9&p_dir=&p_rloc=&p_tloc=&p_ploc=&pg=1&p_tac=&ti=16&pt=1&ch=3&rl=14](http://info.sos.state.tx.us/pls/pub/readac$ext.TacPage?sl=R&app=9&p_dir=&p_rloc=&p_tloc=&p_ploc=&pg=1&p_tac=&ti=16&pt=1&ch=3&rl=14)). Cementing companies, service companies, or operators can qualify as approved cementers by demonstrating that they are able to mix and pump cement in compliance with Commission rules and regulations.

D. **Estimated % wash-out:** If the estimated % wash-out is less than 20% (or 30% along the Gulf Coast), provide supporting documentation such as a caliper log to show how the estimated % wash-out was obtained.

E. **Multi-stage cement:** An operator must report the multi-stage cement shoe in II. Casing Cementing Data section by selecting the type of casing and Multi-stage cement shoe. The operator must report the multi-stage cement tool in III. Casing Cementing Data section by selecting the type of casing and Multi-stage cement/DV tool.

F. **Multiple parallel strings:** An operator should file the Form W-15 as an attachment to the Form W-4, Application for Multiple Completion. An operator may be required to submit multiple Form W-15s to show all data for multiple parallel strings.

G. **Slurry data:** If cement job exceeds three slurries, continue the list of slurries in the Slurry table in the subsequent Casing Cementing Data box.



RAILROAD COMMISSION OF TEXAS

1701 N. Congress
P.O. Box 12967
Austin, Texas 78701-2967

Form W-15

Rev. 08/2014

CEMENTING REPORT

Cementer: Fill in shaded areas.
Operator: Fill in other items.

OPERATOR INFORMATION

Operator Name: PERCUSSION PETROLEUM OPERATING, LLC Operator P-5 No.: 653216
Cementer Name: NexTier Completion Solutions Inc. Cementer P-5 No.: 609375

WELL INFORMATION

District No.: 08 County: Winkler
Well No.: 7H API No.: 42-495-34697 Drilling Permit No.: 876953
Lease Name: UL YELLOWTAIL WEST G 21-29-17 WA Lease No.:
Field Name: PHANTOM (WOLFCAMP) Field No.: 71052900

I. CASING CEMENTING DATA

Type of Casing: ☐ Conductor ☐ Surface ☐ Intermediate ☐ Liner ☒ Production
Drilled hole size (in.): 6 3/4 Depth of drilled hole (ft.): 22486 Est. % wash-out or hole enlargement: 0
Size of casing in O.D. (in.): 5 1/2 Casing weight (lbs/ft) and grade: 23#/P-110 No. of centralizers used: 15
Was cement circulated to ground surface (or bottom of cellar) outside casing? ☐ YES ☒ NO If no for surface casing, explain in Remarks.
Setting depth shoe (ft.): 22486 Top of liner (ft.):
Setting depth liner (ft.):
Hrs. waiting on cement before drill-out: 24+ Calculated top of cement (ft.): 4156 Cementing date: 7/3/2022

SLURRY

| Slurry No. | No. of Sacks | Class | Additives | Volume (cu. ft.) | Height (ft.) |
|------------|--------------|---------------|-----------|------------------|--------------|
| 1 | 450 | 35:65 CLASS H | REMARKS | 603 | 6407 |
| 2 | 890 | 35:65 CLASS H | REMARKS | 1095 | 12861 |
| 3 | | | | | |
| Total | 1340 | | | 1698 | 19268 |

II. CASING CEMENTING DATA

Type of casing: ☐ Surface ☐ Intermediate ☐ Production ☐ Tapered production ☐ Multi-stage cement sho ☐ Multiple parallel strings
Drilled hole size (in.): Depth of drilled hole (ft.): Est. % wash-out or hole enlargement:
Size of casing in O.D. (in.): Casing weight (lbs/ft) and grade: No. of centralizers used:
Tapered string drilled hole size (in.) Tapered string depth of drilled hole (ft.)
Upper: Lower: Upper: Lower:
Tapered string size of casing in O.D. (in.) Tapered string casing weight (lbs/ft) and grade Tapered string no. of centralizers used
Upper: Lower: Upper: Lower:
Was cement circulated to ground surface (or bottom of cellar) outside casing? YES ☐ NO ☒
Setting depth shoe (ft.):
Hrs. waiting on cement before drill-out: Calculated top of cement (ft.): Cementing date:

SLURRY

| Slurry No. | No. of Sacks | Class | Additives | Volume (cu. ft.) | Height (ft.) |
|------------|--------------|-------|-----------|------------------|--------------|
| 1 | | | | | |
| 2 | | | | | |
| 3 | | | | | |
| Total | | | | | |

III. CASING CEMENTING DATA

Type of casing: ☐ Surface ☐ Intermediate ☐ Production ☐ Tapered production ☐ Multi-stage cement/DV too ☐ Multiple parallel strings
Drilled hole size (in.): Depth of drilled hole (ft.): Est. % wash-out or hole enlargement:
Size of casing in O.D. (in.): Casing weight (lbs/ft) and grade: No. of centralizers used:
Tapered string drilled hole size (in.) Tapered string depth of drilled hole (ft.)
Upper: Lower: Upper: Lower:
Tapered string size of casing in O.D. (in.) Tapered string casing weight (lbs/ft) and grade Tapered string no. of centralizers used
Upper: Lower: Upper: Lower:
Was cement circulated to ground surface (or bottom of cellar) outside casing? YES ☐ NO ☒
Setting depth shoe (ft.):
Hrs. waiting on cement before drill-out: Calculated top of cement (ft.): Cementing date:

SLURRY

| Slurry No. | No. of Sacks | Class | Additives | Volume (cu. ft.) | Height (ft.) |
|------------|--------------|-------|-----------|------------------|--------------|
| 1 | | | | | |
| 2 | | | | | |
| 3 | | | | | |
| Total | | | | | |

CEMENTING TO SQUEEZE, PLUG BACK OR PLUG AND ABANDON

| | PLUG #1 | PLUG #2 | PLUG #3 | PLUG #4 | PLUG #5 | PLUG #6 | PLUG #7 |
|---|---------|---------|---------|---------|---------|---------|---------|
| Cementing Date | | | | | | | |
| Size of hole or pipe (in.) | | | | | | | |
| Depth to bottom of tubing or drill pipe (ft.) | | | | | | | |
| Cement retainer setting depth (ft.) | | | | | | | |
| CIBP setting depth (ft.) | | | | | | | |
| Amount of cement on top of CIBP (ft.) | | | | | | | |
| Sacks of cement used | | | | | | | |
| Slurry volume pumped (cu. ft.) | | | | | | | |
| Calculated top of plug (ft.) | | | | | | | |
| Measured top of plug, if tagged (ft.) | | | | | | | |
| Slurry weight (lbs/gal) | | | | | | | |
| Class/type of cement | | | | | | | |
| Perforate and squeeze (YES/NO) | | | | | | | |

REMARKS

REMARKS 1: 2% NEX-020 + .1% NAS-504 + .3% NFL-547 + .2% NFP-703 + .3% NRT-213

REMARKS 2: 2% NEX-020 + .3%NFL-547 + .2% NFP-703 + .25% NRT-213

CEMENTER'S CERTIFICATE: I declare under penalties prescribed in Sec. 91.143, Texas Natural Resources Code, that I am authorized to make this certification, that the cementing of casing and/or the placing of cement plugs in this well as shown in the report was performed by me or under my supervision, and that the cementing data and facts presented on both sides of this form are true, correct, and complete, to the best of my knowledge. This certification covers cementing data only.

Benny Rodriguez

NextTier Completion Solutions Inc.

Name and title of cementer's representative

Cementing Company

Signature

2601 E 120 Midland, Texas 79706

432-686-8559

Address

City, State, Zip Code

Tel: Area Code Number

Date: mo. day yr.

OPERATOR'S CERTIFICATE: I declare under penalties prescribed in Sec. 91.143, Texas Natural Resources Code, that I am authorized to make this certification, that I have knowledge of the well data and information presented in this report, and that data and facts presented on both sides of this form are true, correct, and complete, to the best of my knowledge. This certification covers all well data.

Typed or printed name of operator's representative

Title

Signature

1001 FANNIN ST. SUITE 2200 HOUSTON, TX 77002

713-518-1331

11/04/2022

Address City, State, Zip Code

Tel: Area Code Number

Date: mo. day yr.

Instructions for Form W-15, Cementing Report

NOTICE: The Form W-15 must be submitted as an attachment to a Form G-1 (Gas Well Back Pressure Test, Completion or Recompletion Report, and Log), Form W-2 (Oil Well Potential Test, Completion or Recompletion Report, and Log),

A. **What to file:** An operator should file an original and one copy of the completed Form W-15 for each cementing company used on a well. The cementing of different casing strings on a well by one cementing company should be filed with the Form W-3, Plugging Record, unless the Form W-3 is signed by the cementing company representative. When reporting dry holes, operators must complete Form W-15, in

B. **How to file:** An oil and gas completion report and Form W-15 may be filed online using the Commission's Online System (<https://webapps.rrc.state.tx.us/security/login.do>) or a paper copy of the form may be mailed to the Commission in Austin (P.O. Box 12967, Austin, Texas 78712967).

C. **Surface casing:** An operator must set and cement sufficient surface casing to protect all usable-quality water strata, as defined by the Groundwater Advisory Unit in Austin. Sufficient cement shall be used to fill To plug and abandon a well, operators must use only cementers approved by the Commission's Director of Field Operations in accordance with SWR 14

D. **Estimated % wash-out:** If the estimated % wash-out is less than 20% (or 30% along the Gulf Coast), provide supporting documentation such as a caliper log to show how the estimated % wash-out was obtained.

E. **Multi-stage cement:** An operator must report the multi-stage cement shoe in II. Casing Cementing Data section by selecting the type of casing and Multi-stage cement shoe. The operator must report the multi-

F. **Multiple parallel strings:** An operator should file the Form W-15 as an attachment to the Form W-4, Application for Multiple Completion. An operator may be required to submit multiple Form W-15s to show all

G. **Slurry data:** If cement job exceeds three slurries, continue the list of slurries in the Slurry table in the subsequent Casing Cementing Data box.



APPLICATION FOR APPROVAL OF SURFACE CASING > 3500 FEET

Statewide Rule 13(b)(1)(A) RAILROAD COMMISSION OF TEXAS

Operator's Name and Address: Percussion Petroleum II, LLC
1001 Fannin St. Suite 2200
Houston, TX 77002

P5 Number: 653216

Area for review: RRC District 8

Lease Name: UL YELLOWTAIL 21-29-17 TB 4H, WB 5H, WB 6H, WA 7H, WB 8H, WA 9H, TB 10H, WB 11H, TB 12H

Field Name: Phantom (Wolfcamp) County: Winkler

Survey: UL Abstract: A-U69

Drilling Permits: 876937, 876941, 876948, 876953, 876973, 876974, 876975, 876976, 876977

Note: Attach a map if the request is for more than one pad.

How will the operator maintain well control during drilling operations:

Weighted drilling fluid will be used as the primary well control barrier during operations. The density of the drilling fluid is planned to be overbalanced by 0.9 – 1.0 ppg which will contain formation pore pressures and prevent influx of formation fluids. A 20" diverter system will also be utilized which is comprised a rotating head and orbit valves on the flowline to the shakers and the flowline to the pits as an extra measure against influx.

How will the operator ensure cement is circulated to surface and that there is adequate bonding of cement:

We will perform a 2 stage cement job with the DV tool placed at the base of the GAU letter requirements.
Centralizers will be placed every 4th joint with one above and below the stage tool.
Cement lab tests will be run to determine proper water loss of the slurries to qualify as critical zone cement.

How will the operator prevent the migration of formation fluids through the annular space:

Proper cement slurries verified with the lab test results prior to pumping will ensure quality cement will be pumped to ensure no channeling can occur.

Signature: Karen Zornes Name: Karen Zornes Date: 02/17/2022 Phone: 281-872-9300

RRC District Office Action:

☒ Approved

☐ Approved as Modified

☐ Denied

By:

Jessica Kent

Date: 2/18/2022

RRC Use Only ►

Remarks/Modifications:

WAYNE CHRISTIAN, CHAIRMAN
CHRISTI CRADDICK, COMMISSIONER
JIM WRIGHT, COMMISSIONER



DANNY SORRELLS
DIRECTOR, OIL AND GAS DIVISION

JEFFERY MORGAN
DISTRICT DIRECTOR

RAILROAD COMMISSION OF TEXAS

OIL AND GAS DIVISION

| | | | | | |
|-----------------------|---------------------------|---------------------|--------------------------------|---------------|----|
| OPERATOR Name: | PERCUSSION PETROLEUM OPER | RE: Lease: | UL YELLOWTAIL G 21-29-17 WA | | |
| Address1: | 1001 FANNIN STREET | Well No: | 7H | | |
| Address2: | STE 220 | Sec: | 29 | Block: | 21 |
| City: | HOUSTON | County: | WINKLER | | |
| State: | TX | Survey Name: | UL | | |

SWR13EX Application Number: 108359 **Drilling Permit No:** 876953

SWR 13 CASING EXCEPTION APPLICATION/ALTERNATIVE REQUEST APPROVED

The Proposed Casing and Cementing Program submitted for **LEASE** UL YELLOWTAIL G 21-29-17 ;
WELL 7H has been approved by the Railroad Commission of Texas District Office.

- a. A copy of this approved letter must be kept on location during all phases of drilling and/or plugging operations. Once approved, changes CANNOT be made to the Proposed Casing Program on the original application without additional approval from the Railroad Commission of Texas District Office.
- b. Any substantive modifications to the cement program require prior approval from the Railroad Commission of Texas District Office, and may require re-submission of the SWR 13 (Statewide Rule 13) Alternate Surface Casing Application. Contact the Railroad Commission of Texas District Office for more information.
- c. The tail slurry must be sufficient to fill the Zone of Critical Cement as described in Statewide Rule 13(b)(1)(H)(i). In addition, all cement slurries must be mixed on location as described in Application for Alternate Surface Casing Program.
- d. The casing and cement program shall adhere to the following specifications:

Set 5300 feet of surface casing with a multistage tool set at a depth of not less than 750 feet. Circulate cement from the multistage tool to the ground surface. If cement does not circulate to surface during the first stage, the multistage tool MUST be opened and neat cement be circulated from the tool to the surface.

IF CEMENT IS NOT CIRCULATED TO THE GROUND SURFACE AS REQUIRED BY THIS EXCEPTION, YOU MUST CONTACT THE RAILROAD COMMISSION OF TEXAS DISTRICT OFFICE IMMEDIATELY AND FOLLOW THE PROCEDURES SET OUT IN RULE 13(b)(1)(H)(iii) OR AS REQUIRED BY THE RAILROAD COMMISSION OF TEXAS DISTRICT OFFICE.

You must comply with all other provisions of SWR 13 (Statewide Rule 13) and a representative of the cementing company who performs the cementing job for the protection of usable quality water strata must sign the Form W-15 attesting to the information regarding cementing operations performed; including circulation of cement. (Note: If surface casing is set below the approved depth, this can result in denial of future Statewide Rule 13(b)(1)(H)(i) requests.) A condition of the approved drilling permit requires notification to the Railroad Commission of Texas District Office eight (8) hours prior to the time casing is to be set/cemented in the well. If your exception request was submitted after the subject well has been drilled and completed, the operator may be referred for enforcement action.

This authorization shall expire within five (5) years from the date the Groundwater Protection Determination was issued, or at the expiration of the drilling permit (if the well is not spudded prior to expiration) for the referenced well, whichever occurs first. Furthermore, this authorization supersedes any prior authorizations issued for the referenced well.

This exception is based on information provided when the application was submitted 02/18/2022 .
If any information has changed, you must contact the appropriate Railroad Commission of Texas District Office, and submit a new application if applicable. If you have questions, please contact the appropriate Oil and Gas District office.

RRC APPROVAL BY: Jessica Kent

DATE: 02/18/2022

JEFFERY MORGAN

DISTRICT DIRECTOR

WAYNE CHRISTIAN, CHAIRMAN
CHRISTI CRADDICK, COMMISSIONER
JIM WRIGHT, COMMISSIONER



RAILROAD COMMISSION OF TEXAS

OIL AND GAS DIVISION

DANNY SORRELLS
DIRECTOR, OIL AND GAS DIVISION

JEFFERY MORGAN
DISTRICT DIRECTOR

OPERATOR Name: PERCUSSION PETROLEUM OPER

Address1: 1001 FANNIN STREET STE 2200

Address2:

City: HOUSTON

State: TX

RE: Lease: UL YELLOWTAIL WEST G 21-29-17 WA

Well No: 7H

Sec: 29 **Block:** 21

County: WINKLER

Survey Name: UL

SWR13EX Application Number: 108359

Drilling Permit No: 876953

SWR 13 CASING EXCEPTION APPLICATION/ALTERNATIVE REQUEST APPROVED

An extension to omit the installation of tubing in the above-referenced well is approved for a period of up to 180 days from the date the application was received or the date the well began producing, whichever occurred last.

RRC APPROVAL BY: Jean Noel Rapono Antchoue

DATE: 10/27/2022

JEFFERY MORGAN
DISTRICT DIRECTOR

Tracking No.: 281376

This facsimile L-1 was generated electronically from data submitted to the RRC.

Instructions

When to File Form L-1:

- with Forms G-1, W-2, and GT-1 for new and deepened gas, oil, and geothermal wells
- with Form W-3 for plugged dry holes
- when sending in a log which was held under a request for confidentiality and the period for confidentiality has not yet expired.

When is Form L-1 NOT required:

- with Forms W-2, G-1, and GT-1 filed for injection wells, disposal wells, water supply wells, service wells, re-test wells, re-classifications, and plugbacks of oil, gas or geothermal wells
- with Form W-3 for plugging of other than a dry hole

Where to File Form L-1:

- with the appropriate Commission district office

Filling out Form L-1:

- Section I and the signature section must be filled out for all wells
- complete only the appropriate part of Section II

Type of log required:

- any wireline survey run for the purpose of obtaining lithology, porosity, or resistivity information
- no more than one such log is required but it must be of the subject well
- if such log is NOT run on the subject well, do NOT substitute any other type of log; just select Section II, Part A below

SECTION I. IDENTIFICATION

| | | |
|--|-------------------------------|--------------------------------|
| Operator Name: PERCUSSION PETROLEUM OPER II,LLC | District No. 08 | Completion Date: 09/16/2022 |
| Field Name PHANTOM (WOLFCAMP) | Drilling Permit No. 876953 | |
| Lease Name UL YELLOWTAIL WEST G 21-29-17 WA | Lease/ID No. 58184 | Well No. 7H |
| County WINKLER | API No. 42- 495-34697 | |

SECTION II. LOG STATUS (Complete either A or B)

☐ A. BASIC ELECTRIC LOG NOT RUN

☒ B. BASIC ELECTRIC LOG RUN. (Select one)

- ☒ 1. Confidentiality is requested and a copy of the header for each log that has been run on the well is attached.
- ☐ 2. Confidentiality already granted on basic electric log covering this interval (applicable to deepened wells only).
- ☐ 3. Basic electric log covering this interval already on file with Commission (applicable to deepened wells only).
- ☐ 4. Log attached to (select one):

☐ (a) Form L-1 (this form). If the company/lease name on log is different from that shown in Section I, please enter name on log here: _____

Check here if attached log is being submitted after being held confidential. ☐

☐ (b) Form P-7, Application for Discovery Allowable and New Field Designation.

☐ (c) Form W-4, Application for Multiple Completion:

Lease or ID No(s). _____

Well No(s). _____

Karen Zornes

Signature

Name (print)

Title

(281) 872-9300

Phone

11/17/2022

Date

-FOR RAILROAD COMMISSION USE ONLY-



1" = 100'
MD FT

Company: Percussion Petroleum Oper II, LLC
Well: UL Yellowtail West G 21-29-17 WA 7H
Field: Phantom (Wolfcamp)
API: 42-495-34697
County: Winkler
State: Texas
Country: United States
Rig: Unit 407
AFE: 22DC053
Job: AEP-PB-220149 / GT-220531

Company: Percussion Petroleum Oper II, LLC
Well: UL Yellowtail West G 21-29-17 WA 7H
Field: Phantom (Wolfcamp)
API: 42-495-34697
County: Winkler
State: Texas
Country: United States
Rig: Unit 407

Well Location NAD 1927
Latitude: 31.711063 Longitude: -103.243910
Y: 755378.67 X: 1094977.69
Section: 20 Township: Blk 21 Rnge: UL

Permanent Datum: Mean Sea Level Kelly Bushing Elev: N/A
Log Measured From: Rotary Table Drill Floor Elev: 2784.0
Height of Reference: 21 Ground Level Elev: 2763

Depth Drilled: 90.0 to: 22506.0
Depth Logged: 200.0 to: 22506.1
Date Logged: 28 Mar 2022 01:27 to: 01 Jul 2022 01:44

Disclaimer: Altitude Energy Partners uses its best efforts to provide customers with accurate information and interpretations with services performed but does not warranty the accuracy of information or interpretations.

| Hole Data | | | Casing Data | | |
|-----------|-----------|---------|-------------|-----------|---------|
| Size | From (MD) | To (MD) | Size | From (MD) | To (MD) |
| 12.25 | 90 | 5140 | 10.75 | 0 | 5121 |
| 8.75 | 5140 | 11280 | 7.625 | 0 | 11261 |
| 6.75 | 11280 | 22506 | | | |
| | | | | | |
| | | | | | |

CERTIFICATE OF COMPLIANCE
AND TRANSPORTATION AUTHORITY

P-4

This facsimile P-4 was generated electronically from data submitted to the RRC.
A certification of the automated data is available in the RRC's Austin office.

Tracking No.: 281376

| | | | | | | | |
|--|-----------|---|--------------------------------------|-----------------------------|---|-----------------|------------------|
| 1. Field name exactly as shown on proration schedule PHANTOM (WOLFCAMP) | | 2. Lease name as shown on proration schedule UL YELLOWTAIL WEST G 21-29-17 WA | | | | | |
| 3. Current operator name exactly as shown on P-5 Organization Report PERCUSSION PETROLEUM OPER II, LLC | | 4. Operator P-5 no. 653216 | 5. Oil Lse/Gas ID no 58184 | 6. County WINKLER | 7. RRC district 08 | | |
| 8. Operator address including city, state, and zip code 1001 FANNIN STREET STE 2200 HOUSTON, TX 77002 | | 9. Well no(s) (see instruction E) 7H | | | 11. Effective Date 09/16/2022 | | |
| | | 10. Classification <input checked="" type="checkbox"/> Oil <input type="checkbox"/> Gas <input type="checkbox"/> Other (see instruction A) | | | | | |
| 12. Purpose of Filing. (Complete section a or b below.) (See instructions B and G) a. Change of: <input type="checkbox"/> operator <input type="checkbox"/> oil or condensate gatherer <input type="checkbox"/> gas gatherer <input type="checkbox"/> gas purchaser <input type="checkbox"/> gas purchaser system code <input type="checkbox"/> field name from: _____ Docket #: _____ <input type="checkbox"/> lease name from: _____ <hr/> b. New RRC Number for: <input checked="" type="checkbox"/> oil lease <input type="checkbox"/> gas well Due to: <input checked="" type="checkbox"/> new completion or recompletion <input type="checkbox"/> reclass oil to gas <input type="checkbox"/> reclass gas to oil <input type="checkbox"/> other well (specify) _____ <input type="checkbox"/> consolidation <input type="checkbox"/> unitization <input type="checkbox"/> field transfer <input type="checkbox"/> subdivision (oil lease only) | | | | | | | |
| 13. Authorized GAS WELL GAS or CASINGHEAD GAS Gatherer(s) and/or Purchaser(s). (See instruction G). | | | | | | | |
| Gatherer | Purchaser | Name of GAS WELL GAS or CASINGHEAD GAS Gatherer(s) or Purchaser(s) As Indicated in Columns to the Left (Attach an additional sheet in same format if more space is needed) | | | Purchaser's RRC Assigned System Code | Percent of Take | Full-well stream |
| X | X | TARGA DELAWARE LLC(836022) | | | 0001 | 100.0 | |
| | | | | | | | |
| | | | | | | | |
| | | | | | | | |
| | | | | | | | |
| | | | | | | | |
| 14. Authorized OIL or CONDENSATE Gatherer(s). (See instruction G). | | | | | | | |
| Name of OIL or CONDENSATE Gatherer(s) - List Highest Volume Gatherer First (Attach an additional sheet in same format if more space is needed) | | | | | | Percent of Take | |
| ORYX DELAWARE OIL TRANSPORT LLC(627137) | | | | | | 100.0 | |
| | | | | | | | |
| | | | | | | | |
| RRC USE ONLY: Reviewer's initials: <u>RRC Staff</u> Approval date: <u>01/10/2023</u> | | | | | | | |
| 15. PREVIOUS OPERATOR CERTIFICATION FOR CHANGE OF OPERATOR P-4 FILING. Being the PREVIOUS OPERATOR, I certify that operating responsibility for the well(s) designated in this filing, located on the subject lease has been transferred in its entirety to the above named Current Operator. I understand, as Previous Operator, that designation of the above named operator as Current Operator is not effective until this certificate is approved by the Commission. <div style="display: flex; justify-content: space-between;"><div style="width: 45%;"><div style="border-bottom: 1px solid black; margin-bottom: 5px;">Name of Previous Operator</div><div style="border-bottom: 1px solid black; margin-bottom: 5px;">Name (print)</div><div style="border-bottom: 1px solid black; margin-bottom: 5px;">Title</div></div><div style="width: 45%;"><div style="border-bottom: 1px solid black; margin-bottom: 5px;">Signature</div><div style="display: flex; justify-content: space-between; margin-bottom: 5px;"><div><input type="checkbox"/> Authorized Employee of previous operator</div><div><input type="checkbox"/> Authorized agent of previous operator (see instruction G)</div></div><div style="display: flex; justify-content: space-between; margin-bottom: 5px;"><div style="border-bottom: 1px solid black; width: 45%;">Date</div><div style="border-bottom: 1px solid black; width: 45%;">Phone with area code</div></div></div></div> | | | | | | | |
| 16. CURRENT OPERATOR CERTIFICATION. By signing this certificate as the Current Operator, I certify that all statements on this form are true and correct and I acknowledge responsibility for the regulatory compliance of the subject lease including plugging of well(s) pursuant to Rule 14. I further acknowledge that I assume responsibility for the physical operation, control, and proper plugging of each well designated in this filing. I also acknowledge that I will remain designated as the Current Operator until a new certificate designating a new Current Operator is approved by the Commission. <div style="display: flex; justify-content: space-between;"><div style="width: 45%;"><div style="border-bottom: 1px solid black; margin-bottom: 5px;">Name (print)</div><div style="border-bottom: 1px solid black; margin-bottom: 5px;">Title</div><div style="border-bottom: 1px solid black; margin-bottom: 5px;">E-mail Address (optional)</div></div><div style="width: 45%;"><div style="border-bottom: 1px solid black; margin-bottom: 5px;">Signature</div><div style="display: flex; justify-content: space-between; margin-bottom: 5px;"><div><input type="checkbox"/> Authorized Employee of current operator</div><div><input checked="" type="checkbox"/> Authorized agent of current operator (see instruction G)</div></div><div style="display: flex; justify-content: space-between; margin-bottom: 5px;"><div style="border-bottom: 1px solid black; width: 45%;">Date</div><div style="border-bottom: 1px solid black; width: 45%;">Phone with area code</div></div></div></div> | | | | | | | |

CERTIFICATE OF COMPLIANCE
AND TRANSPORTATION AUTHORITY

P-4

This facsimile P-4 was generated electronically from data submitted to the RRC.
A certification of the automated data is available in the RRC's Austin office.

Tracking No.: 281376

| | | | | | | | |
|--|-----------|---|--------------------------------------|-----------------------------|---|-----------------|------------------|
| 1. Field name exactly as shown on proration schedule PHANTOM (WOLFCAMP) | | 2. Lease name as shown on proration schedule UL YELLOWTAIL WEST G 21-29-17 WA | | | | | |
| 3. Current operator name exactly as shown on P-5 Organization Report PERCUSSION PETROLEUM OPER II, LLC | | 4. Operator P-5 no. 653216 | 5. Oil Lse/Gas ID no 58184 | 6. County WINKLER | 7. RRC district 08 | | |
| 8. Operator address including city, state, and zip code 1001 FANNIN STREET STE 2200 HOUSTON, TX 77002 | | 9. Well no(s) (see instruction E) 7H | | | 11. Effective Date 09/16/2022 | | |
| | | 10. Classification <input checked="" type="checkbox"/> Oil <input type="checkbox"/> Gas <input type="checkbox"/> Other (see instruction A) | | | | | |
| 12. Purpose of Filing. (Complete section a or b below.) (See instructions B and G) a. Change of: <input type="checkbox"/> operator <input type="checkbox"/> oil or condensate gatherer <input type="checkbox"/> gas gatherer <input type="checkbox"/> gas purchaser <input type="checkbox"/> gas purchaser system code <input type="checkbox"/> field name from: _____ Docket #: _____ <input type="checkbox"/> lease name from: _____ <hr/> b. New RRC Number for: <input checked="" type="checkbox"/> oil lease <input type="checkbox"/> gas well Due to: <input checked="" type="checkbox"/> new completion or recompletion <input type="checkbox"/> reclass oil to gas <input type="checkbox"/> reclass gas to oil <input type="checkbox"/> other well (specify) _____ <input type="checkbox"/> consolidation <input type="checkbox"/> unitization <input type="checkbox"/> field transfer <input type="checkbox"/> subdivision (oil lease only) | | | | | | | |
| 13. Authorized GAS WELL GAS or CASINGHEAD GAS Gatherer(s) and/or Purchaser(s). (See instruction G). | | | | | | | |
| Gatherer | Purchaser | Name of GAS WELL GAS or CASINGHEAD GAS Gatherer(s) or Purchaser(s) As Indicated in Columns to the Left (Attach an additional sheet in same format if more space is needed) | | | Purchaser's RRC Assigned System Code | Percent of Take | Full-well stream |
| X | X | TARGA DELAWARE LLC(836022) | | | 0001 | 100.0 | |
| | | | | | | | |
| | | | | | | | |
| | | | | | | | |
| | | | | | | | |
| | | | | | | | |
| 14. Authorized OIL or CONDENSATE Gatherer(s). (See instruction G). | | | | | | | |
| Name of OIL or CONDENSATE Gatherer(s) - List Highest Volume Gatherer First (Attach an additional sheet in same format if more space is needed) | | | | | | Percent of Take | |
| ORYX DELAWARE OIL TRANSPORT LLC(627137) | | | | | | 100.0 | |
| | | | | | | | |
| | | | | | | | |
| RRC USE ONLY: Reviewer's initials: <u>RRC Staff</u> Approval date: <u>01/10/2023</u> | | | | | | | |
| 15. PREVIOUS OPERATOR CERTIFICATION FOR CHANGE OF OPERATOR P-4 FILING. Being the PREVIOUS OPERATOR, I certify that operating responsibility for the well(s) designated in this filing, located on the subject lease has been transferred in its entirety to the above named Current Operator. I understand, as Previous Operator, that designation of the above named operator as Current Operator is not effective until this certificate is approved by the Commission. <div style="display: flex; justify-content: space-between;"><div style="width: 45%;"><div style="border-bottom: 1px solid black; margin-bottom: 5px;">Name of Previous Operator</div><div style="border-bottom: 1px solid black; margin-bottom: 5px;">Name (print)</div><div style="border-bottom: 1px solid black; margin-bottom: 5px;">Title</div></div><div style="width: 45%;"><div style="border-bottom: 1px solid black; margin-bottom: 5px;">Signature</div><div style="display: flex; justify-content: space-between;"><div><input type="checkbox"/> Authorized Employee of previous operator</div><div><input type="checkbox"/> Authorized agent of previous operator (see instruction G)</div></div><div style="display: flex; justify-content: space-between;"><div style="border-bottom: 1px solid black; margin-bottom: 5px;">Date</div><div style="border-bottom: 1px solid black; margin-bottom: 5px;">Phone with area code</div></div></div></div> | | | | | | | |
| 16. CURRENT OPERATOR CERTIFICATION. By signing this certificate as the Current Operator, I certify that all statements on this form are true and correct and I acknowledge responsibility for the regulatory compliance of the subject lease including plugging of well(s) pursuant to Rule 14. I further acknowledge that I assume responsibility for the physical operation, control, and proper plugging of each well designated in this filing. I also acknowledge that I will remain designated as the Current Operator until a new certificate designating a new Current Operator is approved by the Commission. <div style="display: flex; justify-content: space-between;"><div style="width: 45%;"><div style="border-bottom: 1px solid black; margin-bottom: 5px;">Name (print)</div><div style="border-bottom: 1px solid black; margin-bottom: 5px;">Title</div><div style="border-bottom: 1px solid black; margin-bottom: 5px;">E-mail Address (optional)</div></div><div style="width: 45%;"><div style="border-bottom: 1px solid black; margin-bottom: 5px;">Signature</div><div style="display: flex; justify-content: space-between;"><div><input type="checkbox"/> Authorized Employee of current operator</div><div><input checked="" type="checkbox"/> Authorized agent of current operator (see instruction G)</div></div><div style="display: flex; justify-content: space-between;"><div style="border-bottom: 1px solid black; margin-bottom: 5px;">Date</div><div style="border-bottom: 1px solid black; margin-bottom: 5px;">Phone with area code</div></div></div></div> | | | | | | | |

Form P-16

Page 1
Rev. 06/2022

Address
911 REGIONAL PARK DR



RAILROAD COMMISSION OF TEXAS

**1701 N. Congress
P.O. Box 12967
Austin, Texas 78701-2967**

Form P-16

Page 2

Rev. 06/2022

Acreage Designation

Filer is the owner or lessee of all or an undivided portion of the minerals under each tract listed below and has the legal right to drill on each tract traversed by the well that will have perforations or other take points open in the interval of the applied-for field(s). All tracts listed will actually be traversed by the wellbore or the filer has pooling authority or other contractual authority, such as a production sharing agreement, authorizing inclusion of the non-drill site tract in the acreage assigned to the well.

SECTION V. LISTING OF ALL TRACTS CONTRIBUTING ACREAGE TO AN RRC DESIGNATED DEVELOPMENTAL UNIT THAT IS NOT A SINGLE LEASE, POOLED UNIT, OR GROUP OF TRACTS UNITIZED BY CONTRACT FOR PURPOSES OF SECONDARY RECOVERY

| RRC ID No., Lease No. or Tract ID | | Lease Name | Beginning Lease Acres | Ownership Interval (Upper) | Ownership Interval (Lower) | Operator Name and Operator No. (if different from filing operator) |
|--------------------------------------|-----------------|------------------------------------|-----------------------|-------------------------------|-------------------------------|---|
| A | 57779 | UL 21 STAMPEDE | 640.700 | | | |
| B | UNIVERSITY LAND | UNIVERSITY LANDS, SEC 20, BLOCK 21 | 640.700 | | | |
| C | | | | | | |
| D | | | | | | |
| E | | | | | | |
| F | | | | | | |
| G | | | | | | |
| H | | | | | | |
| Total Acreage = | | | 1281.400 | | | |

Filer is the owner or lessee, or has been authorized by the owner or lessee, of all or an undivided portion of the mineral estate under each tract for which filer is listed as operator below. For all leases operated by other entities, the number of assigned acres shown are reflected on current Commission records or the filer has been authorized by the current operator to change the assigned acreage of that operator as shown below.

SECTION VI. LISTING OF ALL WELLS IN THE REGULATORY FIELD AS LISTED IN SECTION II, AND ALLOCATING ACREAGE FROM ANY OR ALL TRACTS LISTED IN SECTION V BY FILER

[illegible]

*A revised P-16 is required if increasing the proration acreage on an existing Allocation or PSA well utilizing acreage from a regulatory lease or undeveloped tract not listed in Section V. (refer to instructions)

GROUNDWATER PROTECTION DETERMINATION

Form GW-2



Groundwater Advisory Unit

Date Issued: 15 November 2021**GAU Number:** 321773**Attention:** PERCUSSION PETROLEUM
1001 FANNIN ST STE 2200
HOUSTON, TX 77002**Operator No.:** 653216**API Number:**
County: WINKLER
Lease Name: UL YELLOWTAIL F 21-29-17
Lease Number:
Well Number: 6H
Total Vertical 13500
Latitude: 31.712953
Longitude: -103.237140
Datum: NAD27**Purpose:** New Production Well**Location:** Survey-UL; Abstract-U69; Section-28

To protect usable-quality groundwater at this location, the Groundwater Advisory Unit of the Railroad Commission of Texas recommends:

The interval from the land surface to the base of the Santa Rosa, which is estimated to occur at a depth of 650 feet, must be protected.

This recommendation is applicable for all wells drilled in this abstract U69.

Note: Unless stated otherwise, this recommendation is intended to apply to all wells drilled within 200 feet of the subject well. Unless stated otherwise, this recommendation is for normal drilling, production, and plugging operations only.

This determination is based on information provided when the application was submitted on 11/12/2021. If the location information has changed, you must contact the Groundwater Advisory Unit, and submit a new application if necessary. If you have questions, please contact us at 512-463-2741 or gau@rrc.texas.gov.

Groundwater Advisory Unit, Oil and Gas Division

Form GW-2 P.O. Box 12967 Austin, Texas 78771-2967 512-463-2741 Internet address: www.rrc.texas.
Rev. 02/2014

UNIVERSITY LAND
SECTION 7, BLOCK 21

UNIVERSITY LAND
SECTION 8, BLOCK 21

UNIVERSITY LAND
SECTION 9, BLOCK 21

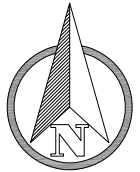

0 1000' 2000'
1" = 2000 FEET

BOTTOM HOLE LOCATION
MD = 22,506'
LAST TAKE POINT
MD = 22,405'
X = 766,205.17
Y = 1,092,666.25
LAT. = 31.740649°
LONG. = 103.252254°

UNIVERSITY LAND
SECTION 18, BLOCK 21

UNIVERSITY LAND
SECTION 19, BLOCK 21

FIRST TAKE POINT
MD = 12,045'
X = 756,237.92
Y = 1,095,416.40
LAT. = 31.713456°
LONG. = 103.242572°

UNIVERSITY LAND
SECTION 30, BLOCK 21

UNIVERSITY LAND
SECTION 16, BLOCK 21

UNIVERSITY LAND
SECTION 21, BLOCK 21

UNIVERSITY LAND
SECTION 28, BLOCK 21

UNIVERSITY LAND
SECTION 29, BLOCK 21

LEGEND

— SURVEY LINE

| LEASE | SECTION | ACRES | LATERAL LENGTH |
|---------|----------------------------------|---------|----------------|
| #115754 | UNIVERSITY LANDS, SEC 20, BLK 21 | 640.70 | 5,179.76' |
| #115752 | UNIVERSITY LANDS, SEC 17, BLK 21 | 640.70 | 5,170.49' |
| TOTALS | | 1281.40 | 10,350.24' |

GENERAL NOTES

- COORDINATES SHOWN ARE BASED ON TEXAS PLANE COORDINATE SYSTEM OF NAD 27, TEXAS CENTRAL ZONE 4203.
- VERTICAL DATUM IS NAVD 88
- LATITUDE AND LONGITUDE ARE NAD 27 AS SHOWN
- AREA, DISTANCES, AND COORDINATES ARE "GRID".
- UNITS ARE UNITED STATES SURVEY FOOT.
- ALL LEASE AND TRACT INFORMATION SHOWN HERE ON IS DONE SO BY LIMITED DEED RECORD INFORMATION ONLY.
- ALL ACREAGES SHOWN ARE BY DEED AND LEASE CALL, EXCEPT WHERE NOTED.
- THIS IS NOT IN ANY WAY A "BOUNDARY SURVEY".

I HEREBY STATE THAT THIS PLAT
SHOWS THE SUBJECT SURFACE
LOCATION AS STAKED ON THE GROUND.

JOHN E. KOWALIK
REGISTERED PROFESSIONAL LAND SURVEYOR
STATE OF TEXAS NO. 6408

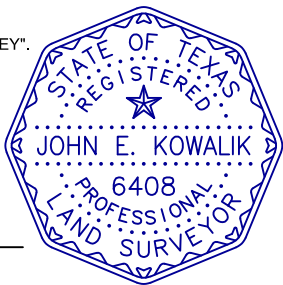

FSC INC
SURVEYORS+ENGINEERS

550 Bailey Ave., 205 - Fort Worth, TX 76107
Ph: 817.349.9800 - Fax: 979.732.5271
TBPE Firm 17957 | TBPLS Firm 10193887
www.fscinc.net

© COPYRIGHT 2016 - ALL RIGHTS RESERVED

PLAT OF:

A FINAL AS-DRILLED WELL LOCATION FOR:
PERCUSSION PETROLEUM OPER II, LLC.
UL YELLOWTAIL WEST G 21-29-17 WA 7H
SITUATED IN THE UNIVERSITY LAND, SECTIONS 29, 20, AND
17, BLOCK 21, AND BEING APPROXIMATELY 5.2 MILES
SOUTHWEST OF WINK IN WINKLER COUNTY, TEXAS.

DATE: 09-22-2022
DRAWN BY: JC
CHECKED BY: LS
FIELD CREW: DN
PROJECT NO: 2022010077
SCALE: 1" = 2000'
SHEET: 1 OF 1
REVISION: 0

OFFSET OPERATOR:
WPX ENERGY PERMIAN,
LLC.

WELL LOCATION INFORMATION

| SHL | KOP | POP |
|------------------------|------------------------|-----------------------|
| 590' FNL & 1573' FWL | 302' FNL & 2217' FWL | 300' FNL & 2214' FWL |
| OUT OF LEASE | OUT OF LEASE | OUT OF LEASE |
| NAD 27 TXC | NAD 27 TXC | NAD 27 TXC |
| Y = 755,378.67 | Y = 755,835.94 | Y = 755,837.78 |
| X = 1,094,977.69 | X = 1,095,515.08 | X = 1,095,511.76 |
| LAT. = 31.711063 °N | LAT. = 31.712358 °N | LAT. = 31.712363 °N |
| LONG. = 103.243910 °W | LONG. = 103.242221 °W | LONG. = 103.242232 °W |
| NAD 83 TXC | NAD 83 TXC | NAD 83 TXC |
| Y = 10,597,955.27 | Y = 10,598,412.55 | Y = 10,598,414.39 |
| X = 1,391,442.13 | X = 1,391,979.53 | X = 1,391,976.21 |
| LAT. = 31.711193 °N | LAT. = 31.712488 °N | LAT. = 31.712493 °N |
| LONG. = 103.244358 °W | LONG. = 103.242669 °W | LONG. = 103.242680 °W |
| BHL | | |
| 111' FSSL & 2235' FWLL | 123' FNLL & 2389' FWLL | 22' FNL & 2395' FWL |
| 22' FNLL & 2395' FWLL | | |
| NAD 27 TXC | NAD 27 TXC | NAD 27 TXC |
| Y = 756,237.92 | Y = 766,205.17 | Y = 766,303.75 |
| X = 1,095,416.40 | X = 1,092,666.25 | X = 1,092,644.32 |
| LAT. = 31.713456 °N | LAT. = 31.740649 °N | LAT. = 31.740918 °N |
| LONG. = 103.242572 °W | LONG. = 103.252254 °W | LONG. = 103.252333 °W |
| NAD 83 TXC | NAD 83 TXC | NAD 83 TXC |
| Y = 10,598,814.54 | Y = 10,608,782.00 | Y = 10,608,880.59 |
| X = 1,391,880.84 | X = 1,389,130.50 | X = 1,389,108.57 |
| LAT. = 31.713586 °N | LAT. = 31.740779 °N | LAT. = 31.741048 °N |
| LONG. = 103.243020 °W | LONG. = 103.252703 °W | LONG. = 103.252781 °W |