

UNIVERSITY LAND
SECTION 7, BLOCK 21

UNIVERSITY LAND
SECTION 8, BLOCK 21

UNIVERSITY LAND
SECTION 9, BLOCK 21

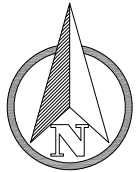

0 1000' 2000'
1" = 2000 FEET

BOTTOM HOLE LOCATION
MD = 22,506'
LAST TAKE POINT
MD = 22,405'
X = 766,205.17
Y = 1,092,666.25
LAT. = 31.740649°
LONG. = 103.252254°

UNIVERSITY LAND
SECTION 18, BLOCK 21

UNIVERSITY LAND
SECTION 19, BLOCK 21

UNIVERSITY LAND
SECTION 16, BLOCK 21

UNIVERSITY LAND
SECTION 21, BLOCK 21

UNIVERSITY LAND
SECTION 28, BLOCK 21

UNIVERSITY LAND
SECTION 30, BLOCK 21

FIRST TAKE POINT
MD = 12,045'
X = 756,237.92
Y = 1,095,416.40
LAT. = 31.713456°
LONG. = 103.242572°

KICK OF POINT
MD = 11,298'

SURFACE HOLE LOCATION
UL YELLOWTAIL WEST G
21-29-17 WA 7H
ELEV. = 2,764'

OFFSET OPERATOR:
WPX ENERGY PERMIAN,
LLC.

UNIVERSITY LAND
SECTION 29, BLOCK 21

WELL LOCATION INFORMATION

LEGEND

— SURVEY LINE

LEASE	SECTION	ACRES	LATERAL LENGTH
#115754	UNIVERSITY LANDS, SEC 20, BLK 21	640.70	5,179.76'
#115752	UNIVERSITY LANDS, SEC 17, BLK 21	640.70	5,170.49'
TOTALS		1281.40	10,350.24'

GENERAL NOTES

- COORDINATES SHOWN ARE BASED ON TEXAS PLANE COORDINATE SYSTEM OF NAD 27, TEXAS CENTRAL ZONE 4203.
- VERTICAL DATUM IS NAVD 88
- LATITUDE AND LONGITUDE ARE NAD 27 AS SHOWN
- AREA, DISTANCES, AND COORDINATES ARE "GRID".
- UNITS ARE UNITED STATES SURVEY FOOT.
- ALL LEASE AND TRACT INFORMATION SHOWN HERE ON IS DONE SO BY LIMITED DEED RECORD INFORMATION ONLY.
- ALL ACREAGES SHOWN ARE BY DEED AND LEASE CALL, EXCEPT WHERE NOTED.
- THIS IS NOT IN ANY WAY A "BOUNDARY SURVEY".

I HEREBY STATE THAT THIS PLAT
SHOWS THE SUBJECT SURFACE
LOCATION AS STAKED ON THE GROUND.

JOHN E. KOWALIK
REGISTERED PROFESSIONAL LAND SURVEYOR
STATE OF TEXAS NO. 6408

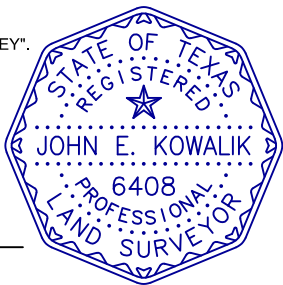

FSC INC
SURVEYORS+ENGINEERS

550 Bailey Ave., 205 - Fort Worth, TX 76107
Ph: 817.349.9800 - Fax: 979.732.5271
TBPE Firm 17957 | TBPLS Firm 10193887
www.fscinc.net

© COPYRIGHT 2016 - ALL RIGHTS RESERVED

PLAT OF:

A FINAL AS-DRILLED WELL LOCATION FOR:
PERCUSSION PETROLEUM OPER II, LLC.
UL YELLOWTAIL WEST G 21-29-17 WA 7H
SITUATED IN THE UNIVERSITY LAND, SECTIONS 29, 20, AND
17, BLOCK 21, AND BEING APPROXIMATELY 5.2 MILES
SOUTHWEST OF WINK IN WINKLER COUNTY, TEXAS.

DATE: 09-22-2022
DRAWN BY: JC
CHECKED BY: LS
FIELD CREW: DN
PROJECT NO: 2022010077
SCALE: 1" = 2000'
SHEET: 1 OF 1
REVISION: 0