

API No. <u>42-495-33445</u> Drilling Permit # <u>743402</u> SWR Exception Case/Docket No. _____		RAILROAD COMMISSION OF TEXAS OIL & GAS DIVISION APPLICATION FOR PERMIT TO DRILL, RECOMPLETE, OR RE-ENTER <i>This facsimile W-1 was generated electronically from data submitted to the RRC.</i> <i>A certification of the automated data is available in the RRC's Austin office.</i>				FORM W-1 07/2004 Permit Status: Approved	
1. RRC Operator No. <div style="text-align: center;">251726</div>		2. Operator's Name (as shown on form P-5, Organization Report) <div style="text-align: center;">ENDEAVOR ENERGY RESOURCES L.P.</div>		3. Operator Address (include street, city, state, zip):			
4. Lease Name <div style="text-align: center;">UNIVERSITY '26-20'</div>		5. Well No. <div style="text-align: center;">1</div>					
GENERAL INFORMATION							
6. Purpose of filing (mark ALL appropriate boxes): <div style="display: flex; justify-content: space-between; margin-top: 5px;"> <input checked="" type="checkbox"/> New Drill <input type="checkbox"/> Recompletion <input type="checkbox"/> Reclass <input type="checkbox"/> Field Transfer <input type="checkbox"/> Re-Enter </div> <div style="display: flex; justify-content: space-between; margin-top: 5px;"> <input type="checkbox"/> Amended <input type="checkbox"/> Amended as Drilled (BHL) (Also File Form W-1D) </div>							
7. Wellbore Profile (mark ALL appropriate boxes): <div style="display: flex; justify-content: space-between; margin-top: 5px;"> <input checked="" type="checkbox"/> Vertical <input type="checkbox"/> Horizontal (Also File Form W-1H) <input type="checkbox"/> Directional (Also File Form W-1D) <input type="checkbox"/> Sidetrack </div>							
8. Total Depth <div style="text-align: center;">14000</div>		9. Do you have the right to develop the minerals under any right-of-way ? <input checked="" type="checkbox"/> Yes <input type="checkbox"/> No		10. Is this well subject to Statewide Rule 36 (hydrogen sulfide area)? <input checked="" type="checkbox"/> Yes <input type="checkbox"/> No			
SURFACE LOCATION AND ACREAGE INFORMATION							
11. RRC District No. <div style="text-align: center;">08</div>		12. County <div style="text-align: center;">WINKLER</div>		13. Surface Location <input checked="" type="checkbox"/> Land <input type="checkbox"/> Bay/Estuary <input type="checkbox"/> Inland Waterway <input type="checkbox"/> Offshore			
14. This well is to be located <u>9.1</u> miles in a <u>W</u> direction from <u>WINK</u> which is the nearest town in the county of the well site.							
15. Section <div style="text-align: center;">26</div>		16. Block <div style="text-align: center;">20</div>		17. Survey <div style="text-align: center;">UL</div>		18. Abstract No. <div style="text-align: center;">A-</div>	
				19. Distance to nearest lease line: <div style="text-align: center;">467 ft.</div>		20. Number of contiguous acres in lease, pooled unit, or unitized tract: <div style="text-align: center;">80.1</div>	
21. Lease Perpendiculars: <u>467</u> ft from the <u>WEST</u> line and <u>467</u> ft from the <u>NORTH</u> line. 22. Survey Perpendiculars: <u>467</u> ft from the <u>WEST</u> line and <u>467</u> ft from the <u>NORTH</u> line.							
23. Is this a pooled unit? <input type="checkbox"/> Yes <input checked="" type="checkbox"/> No			24. Unitization Docket No:		25. Are you applying for Substandard Acreage Field? <input type="checkbox"/> Yes (attach Form W-1A) <input checked="" type="checkbox"/> No		
FIELD INFORMATION List all fields of anticipated completion including Wildcat. List one zone per line.							
26. RRC District No.	27. Field No.	28. Field Name (exactly as shown in RRC records)		29. Well Type	30. Completion Depth	31. Distance to Nearest Well in this Reservoir	
08	98359800	WOLFBONE (TREND AREA)		Oil or Gas Well	14000	0.00	
BOTTOMHOLE LOCATION INFORMATION is required for DIRECTIONAL, HORIZONTAL, AND AMENDED AS DRILLED PERMIT APPLICATIONS							
Remarks [FILER Jun 22, 2012 11:00 AM]: HAVE A NICE DAY!; [RRC STAFF Jul 2, 2012 11:33 AM]: Manual review ok, density met.				Certificate: I certify that information stated in this application is true and complete, to the best of my knowledge. <div style="display: flex; justify-content: space-between;"> <div> <u>Karen Hathcock, Regulatory Analyst</u> Name of filer <u>(432)262-4013</u> Phone </div> <div> <u>Jun 22, 2012</u> Date submitted <u>KarenH@eeronline.com</u> E-mail Address (OPTIONAL) </div> </div>			
RRC Use Only							
Data Validation Time Stamp: Jul 11, 2012 1:07 PM(Current Version)							

RAILROAD COMMISSION OF TEXAS
OIL & GAS DIVISION

PERMIT TO DRILL, DEEPEN, PLUG BACK, OR RE-ENTER ON A REGULAR OR ADMINISTRATIVE EXCEPTION LOCATION

PERMIT NUMBER <div style="text-align: right;">743402</div>	DATE PERMIT ISSUED OR AMENDED <div style="text-align: center;">Jul 02, 2012</div>	DISTRICT <div style="text-align: center;">* 08</div>																									
API NUMBER <div style="text-align: right;">42-495-33445</div>	FORM W-1 RECEIVED <div style="text-align: center;">Jun 22, 2012</div>	COUNTY <div style="text-align: center;">WINKLER</div>																									
TYPE OF OPERATION <div style="text-align: center;">NEW DRILL</div>	WELLBORE PROFILE(S) <div style="text-align: center;">Vertical</div>	ACRES <div style="text-align: center;">80.1</div>																									
OPERATOR <div style="text-align: right;">251726</div> <div style="text-align: center;">ENDEAVOR ENERGY RESOURCES L.P.</div>		NOTICE This permit and any allowable assigned may be revoked if payment for fee(s) submitted to the Commission is not honored. District Office Telephone No: <div style="text-align: center;">(432) 684-5581</div>																									
LEASE NAME <div style="text-align: center;">UNIVERSITY '26-20'</div>		WELL NUMBER <div style="text-align: center;">1</div>																									
LOCATION <div style="text-align: center;">9.1 miles W direction from WINK</div>		TOTAL DEPTH <div style="text-align: center;">14000</div>																									
Section, Block and/or Survey SECTION ◀ 26 BLOCK ◀ 20 ABSTRACT ◀ SURVEY ◀ UL																											
DISTANCE TO SURVEY LINES <div style="text-align: center;">467 ft. WEST 467 ft. NORTH</div>		DISTANCE TO NEAREST LEASE LINE <div style="text-align: center;">467 ft.</div>																									
DISTANCE TO LEASE LINES <div style="text-align: center;">467 ft. WEST 467 ft. NORTH</div>		DISTANCE TO NEAREST WELL ON LEASE <div style="text-align: center;">See FIELD(s) Below</div>																									
FIELD(s) and LIMITATIONS: <div style="text-align: center;">* SEE FIELD DISTRICT FOR REPORTING PURPOSES *</div>																											
<table style="width: 100%; border-collapse: collapse;"> <thead> <tr> <th style="text-align: left;">FIELD NAME</th> <th style="text-align: center;">ACRES</th> <th style="text-align: center;">DEPTH</th> <th style="text-align: center;">WELL #</th> <th style="text-align: center;">DIST</th> </tr> <tr> <th style="text-align: left;">LEASE NAME</th> <th style="text-align: center;">NEAREST LEASE</th> <th></th> <th style="text-align: center;">NEAREST WE</th> <th></th> </tr> </thead> <tbody> <tr> <td colspan="5"><hr style="border-top: 1px dashed black;"/></td> </tr> <tr> <td>WOLFBONE (TREND AREA)</td> <td style="text-align: center;">80.10</td> <td style="text-align: center;">14,000</td> <td style="text-align: center;">1</td> <td style="text-align: center;">08</td> </tr> <tr> <td>UNIVERSITY '26-20'</td> <td style="text-align: center;">467</td> <td></td> <td style="text-align: center;">0</td> <td></td> </tr> </tbody> </table>			FIELD NAME	ACRES	DEPTH	WELL #	DIST	LEASE NAME	NEAREST LEASE		NEAREST WE		<hr style="border-top: 1px dashed black;"/>					WOLFBONE (TREND AREA)	80.10	14,000	1	08	UNIVERSITY '26-20'	467		0	
FIELD NAME	ACRES	DEPTH	WELL #	DIST																							
LEASE NAME	NEAREST LEASE		NEAREST WE																								
<hr style="border-top: 1px dashed black;"/>																											
WOLFBONE (TREND AREA)	80.10	14,000	1	08																							
UNIVERSITY '26-20'	467		0																								
RESTRICTIONS: This is a hydrogen sulfide field. Hydrogen Sulfide Fields with perforations must be isolated and tested per State Wide Rule 36 and a Form H-9 filed with the district office. Fields with SWR 10 authority to downhole commingle must be isolated and tested individually prior to commingling production.																											
THE FOLLOWING RESTRICTIONS APPLY TO ALL FIELDS This well shall be completed and produced in compliance with applicable special field or statewide spacing and density rules. If this well is to be used for brine mining, underground storage of liquid hydrocarbons in salt formations, or underground storage of gas in salt formations, a permit for that specific purpose must be obtained from Environmental Services prior to construction, including drilling, of the well in accordance with Statewide Rules 81, 95, and 97.																											

Block 20, University Lands Survey Winkler County, Texas

22

23 24

27

26 25

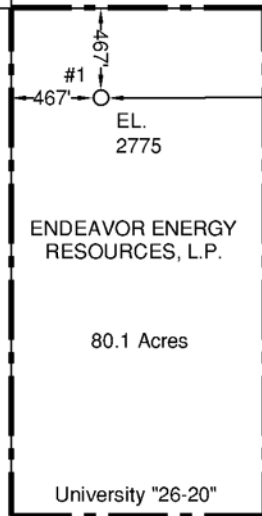

GRID N: 750740.820
GRID E: 1078679.646
NAD'83 Lat/Long
Lat: +31°41'50.152"
Long: -103°17'46.865"

Driving Directions to Location:

From the intersection of Highway 302 and Highway 115 in Kermit, Texas, drive West on Hwy 302 for 5.2 miles to Farm-to-Market Road 1232;
Turn left (South) on Farm-to-Market Road 1232, drive 4.1 miles to County Road 201;
Turn right (West) on C.R. 201, drive 9.2 miles to lease road at Lat: 31°42'39.07", Long: 103°19'37.34";
Turn left (Southeast) on lease road, drive 2.5 miles to Lat: 31°41'49.90", Long: 103°17'53.81";
Location is left (East) 600 feet.

34

35 36

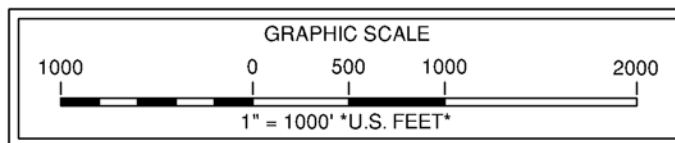

Note: Well is located 9.1 miles West-Southwest of the city of Wink, Texas.

Note: Survey Reconstruction filed in the Office of Pennell & Marlowe Land Surveyors, Inc.

Note: Coordinates shown herein are on The Texas Coordinate System of 1927, Central Zone.

USGS Quadrangle Sheet: Soda Lake NE, Tex.

Railroad Commission Permit Plat



ENDEAVOR ENERGY RESOURCES, L.P.

University "26-20" #1

467' FROM NORTH LINE

467' FROM WEST LINE

University "26-20" Lease

80.1 Acres being the W/2 of the NW/4 of

Section 26, Block 20

University Lands Survey

Winkler County, Texas

Scale: 1" = 1000'

Stephen P. Marlowe
REGISTERED PROFESSIONAL LAND SURVEYOR NO. 5715

June 21, 2012

120621B-JFG

P.O. Box 51622, Midland, Texas, 79710 (432) 570-6256 Fax (432) 682-3262