



3335 Pollok Drive
Conroe, Texas 77303
936.442.2500 (office)
www.msdir.com

26 May 2023

The Railroad Commission of Texas
Oil & Gas Division
PO Box 12967
Austin, TX 78711-2967

Point Energy Partners
UL Dino Juice 18-41-40-45 3B6 22H
Permit Number: 885356
Survey: UL
Abstract: U120
Field: PHANTOM (WOLFCAMP)
Ward County, Texas

API Number: 42-475-38495

Please find the attached survey performed on the above referenced well by MS Directional LLC; Operator Number 592486.

Other information required by your office is as follows:

Name of Surveyor	Drainhole Number	Surveyed Depths	Dates Performed	Type of Survey
Chris Alley	Original Wellbore	168.00' - 26202.00'	04/17/2023 - 05/21/2023	MWD

If any other information is required, please contact the undersigned at the letterhead address and telephone number.

Sincerely,

A handwritten signature in black ink, appearing to read "CWD" followed by a stylized flourish.

Charles Davis
MWD Operations Manager



Company: Point Energy Partners
Well: UL Dino Juice 18-41-40-45 3B6 #22H
County: Ward County, Texas (NAD 27)
Rig: Akita 90
Wellbore: Wellbore #1
Design: Design #2
Date: 9:11, May 22 2023

Geodetic System: US State Plane 1927 (Exact solution)
Datum: NAD 1927 (NADCON CONUS)
Ellipsoid: Clarke 1866
Zone: Texas Central 4203
System Datum: Mean Sea Level

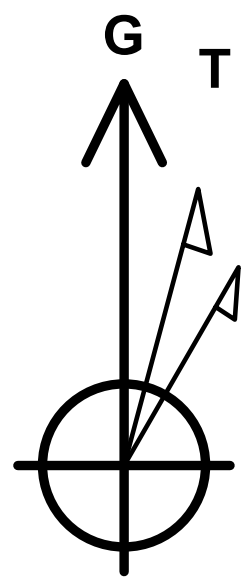

Azimuths to Grid North
True North: 1.56°
Magnetic North: 8.17°

Magnetic Field
Strength: 46925.4nT
Dip Angle: 59.25°
Date: 4/12/2023
Model: HDGM2023

To convert a Magnetic Direction to a Grid Direction, Add 8.172°
To convert a Magnetic Direction to a True Direction, Add 6.617° East
To convert a True Direction to a Grid Direction, Add 1.556°

SECTION DETAILS

MD	Inc	Azi	TVD	+N/-S	+E/-W	Dleg	TFace	Vsect	Annotation
0.00	0.00	0.00	0.00	0.00	0.00	0.00	0.000	0.00	
1500.00	0.00	0.00	1500.00	0.00	0.00	0.00	0.000	0.00	Begin 1.00°/100' Build
2372.41	8.72	270.22	2369.04	0.25	-66.29	1.00	270.219	-18.82	Begin 8.72° Tangent
7190.06	8.72	270.22	7130.96	3.05	-797.01	0.00	0.000	-226.22	Begin 1.00°/100' Drop
8062.47	0.00	0.00	8000.00	3.30	-863.30	1.00	180.000	-245.03	Begin Vertical Hold
10510.97	0.00	0.00	10448.50	3.30	-863.30	0.00	0.000	-245.03	Begin 8.00°/100' Build
10760.97	20.00	171.85	10693.45	-39.46	-857.18	8.00	171.850	-202.27	Hold 20.00° Inc, 171.85° Azm
10810.97	20.00	171.85	10740.44	-56.38	-854.75	0.00	0.000	-185.35	Begin 12.00°/100' Build
11396.81	90.30	171.85	11054.59	-503.00	-790.79	12.00	0.000	261.30	Begin 2.00°/100' Turn
11802.85	90.30	163.73	11052.46	-899.52	-704.98	2.00	-89.979	665.99	Hold 90.30° Inc, 163.73° Azm
18636.98	90.30	163.73	11016.68	-7459.83	1209.79	0.00	0.000	7500.02	Begin 2.00°/100' Build & Turn
18661.98	90.80	163.73	11016.44	-7483.83	1216.79	2.00	0.139	7525.02	Hold 90.80° Inc, 163.73° Azm
21417.18	90.80	163.73	10977.97	-10128.43	1988.62	0.00	0.000	10279.95	Begin 2.00°/100' Drop
21422.18	90.70	163.73	10977.90	-10133.23	1990.02	2.00	179.793	10284.95	Hold 90.70° Inc, 163.73° Azm
22311.18	90.70	163.73	10967.04	-10986.57	2239.06	0.00	0.000	11173.89	Begin 2.00°/100' Turn
23847.59	90.70	133.00	10947.81	-12278.96	3035.22	2.00	-89.808	12637.57	Hold 90.70° Inc, 133.00° Azm
26383.21	90.70	133.00	10916.83	-14008.11	4889.52	0.00	0.000	14816.99	PBHL

TARGET DETAILS

Name	TVD	+N/-S	+E/-W	Northing	Easting	Latitude	Longitude
10280' VS_UL DJ 18-41-40-45 3B6 #22H	10977.97	-10128.43	1988.62	713312.71	1062040.35	31° 35' 34.973 N	103° 20' 46.044 W
7500' VS_UL DJ 18-41-40-45 3B6 #22H	11016.68	-7459.83	1209.79	715981.31	1061261.52	31° 36' 1.166 N	103° 20' 55.882 W
FTP_UL DJ 18-41-40-45 3B6 #22H	0.00	-475.95	-919.34	722965.19	1059132.39	31° 37' 9.688 N	103° 21' 22.686 W
PBHL v2_UL DJ 18-41-40-45 3B6 #22H	10916.83	-14008.11	4889.52	709433.03	1064941.25	31° 34' 57.365 N	103° 20' 11.305 W

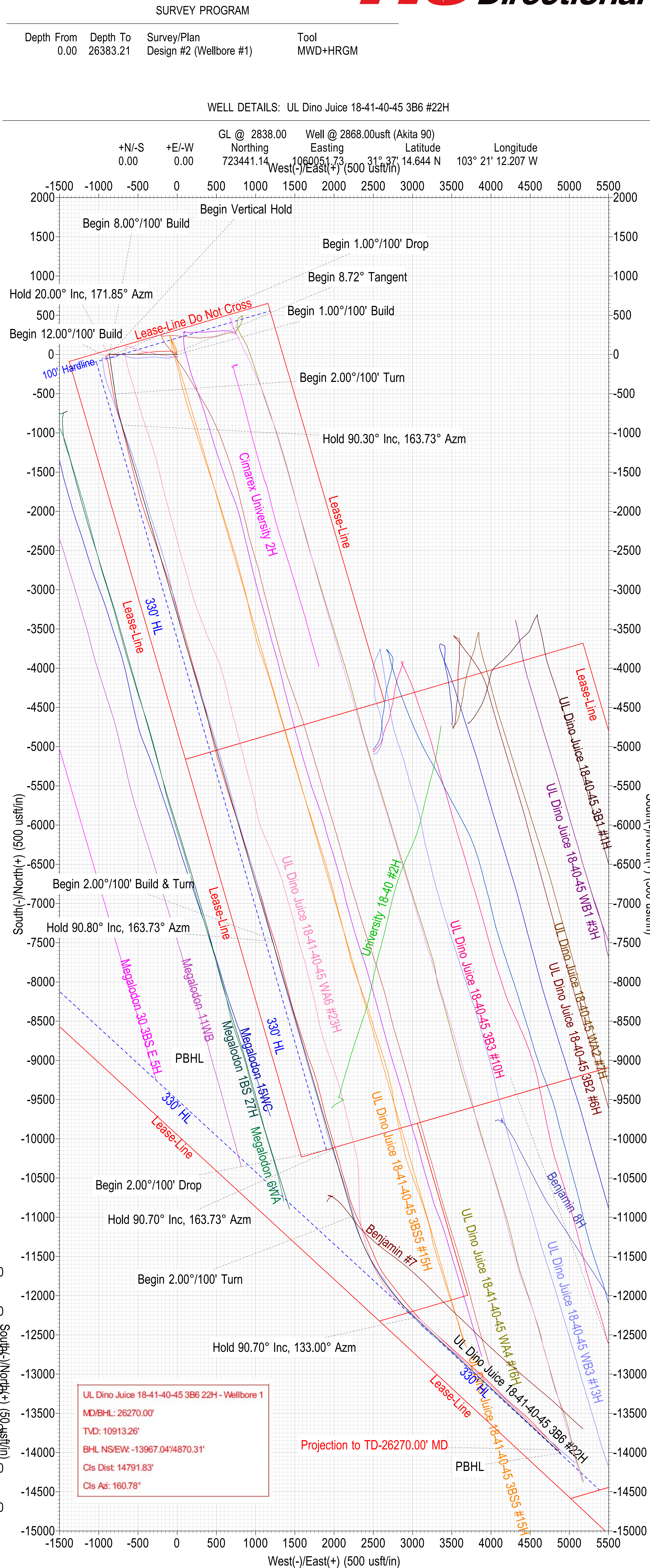
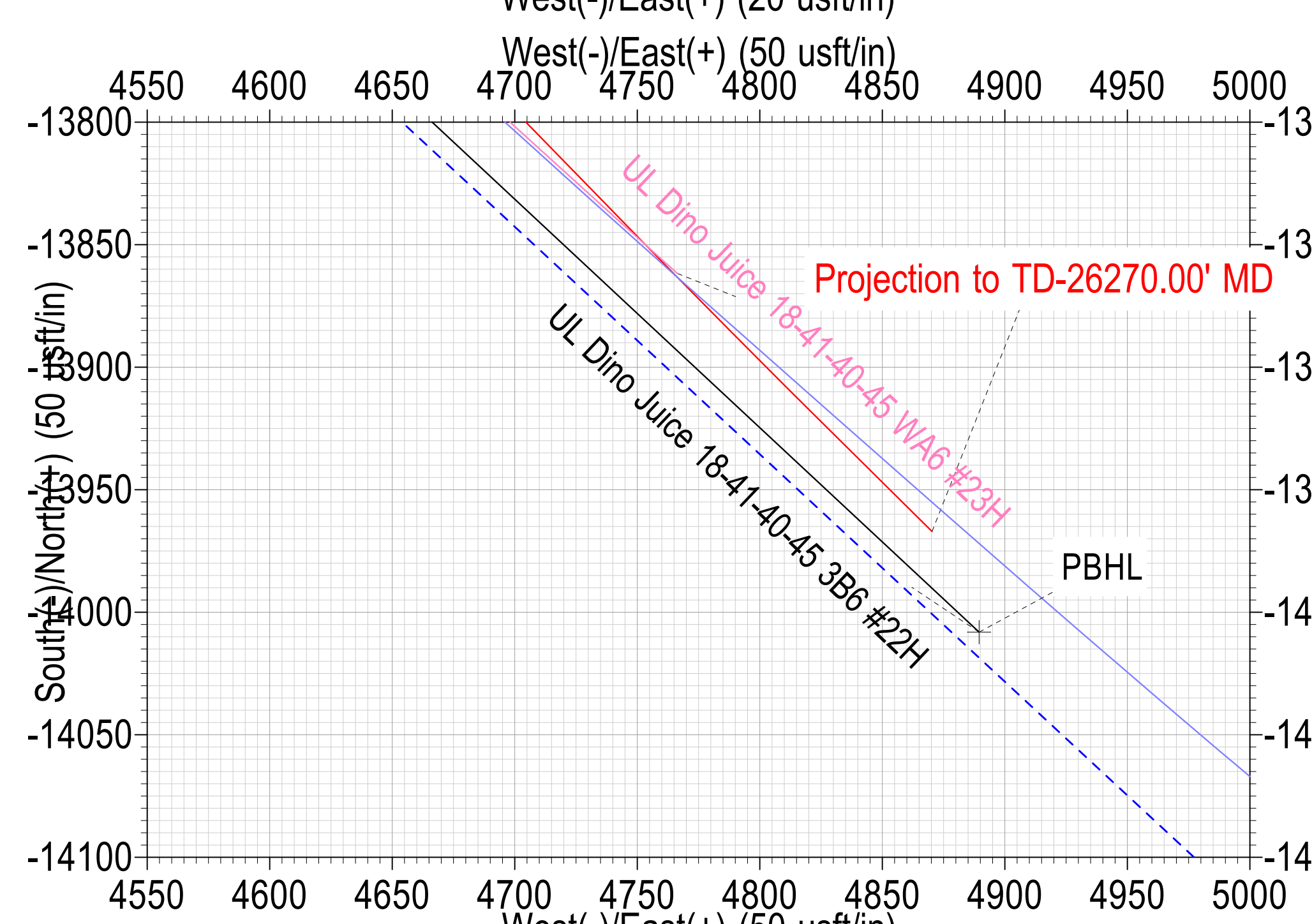
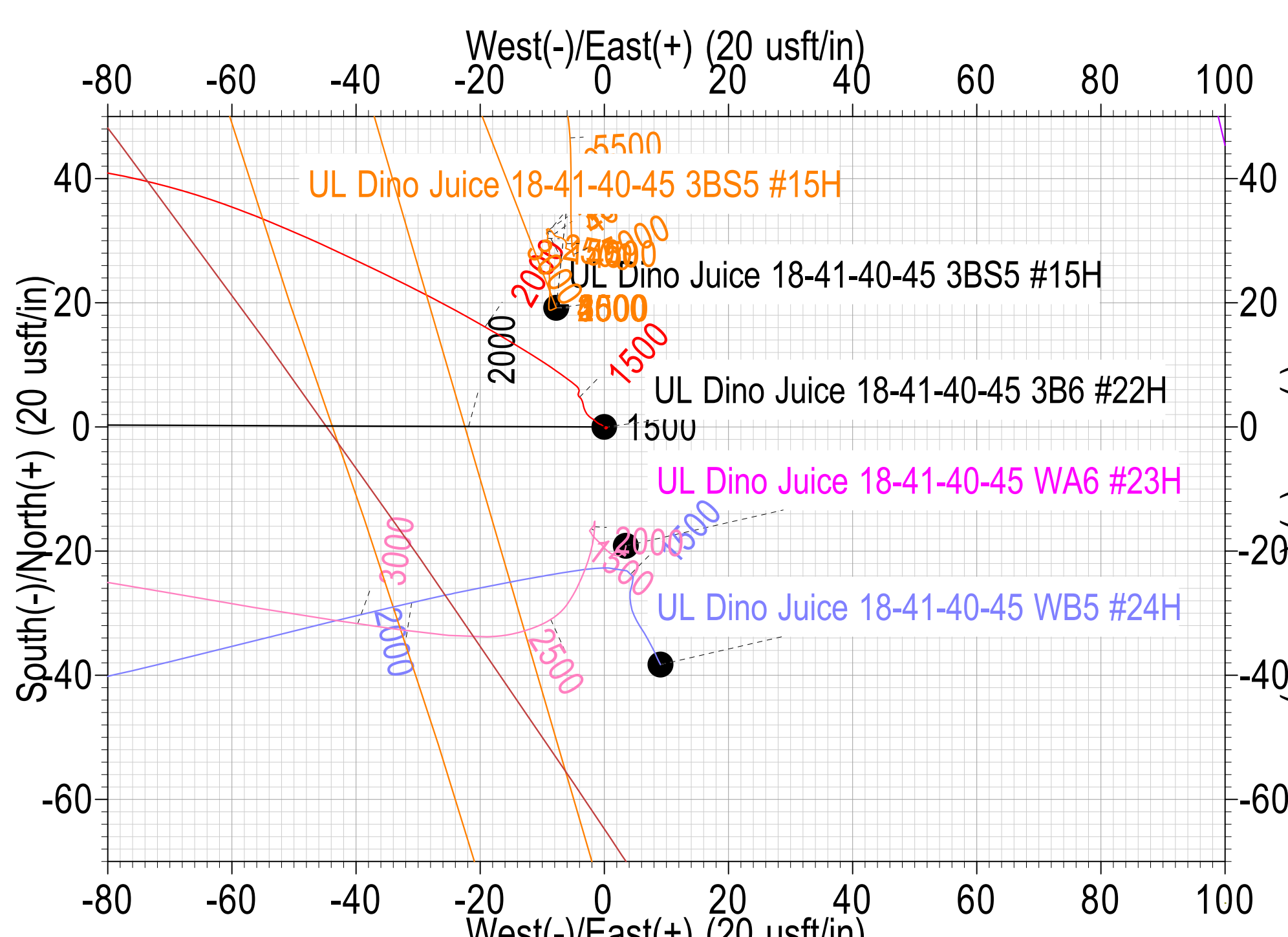
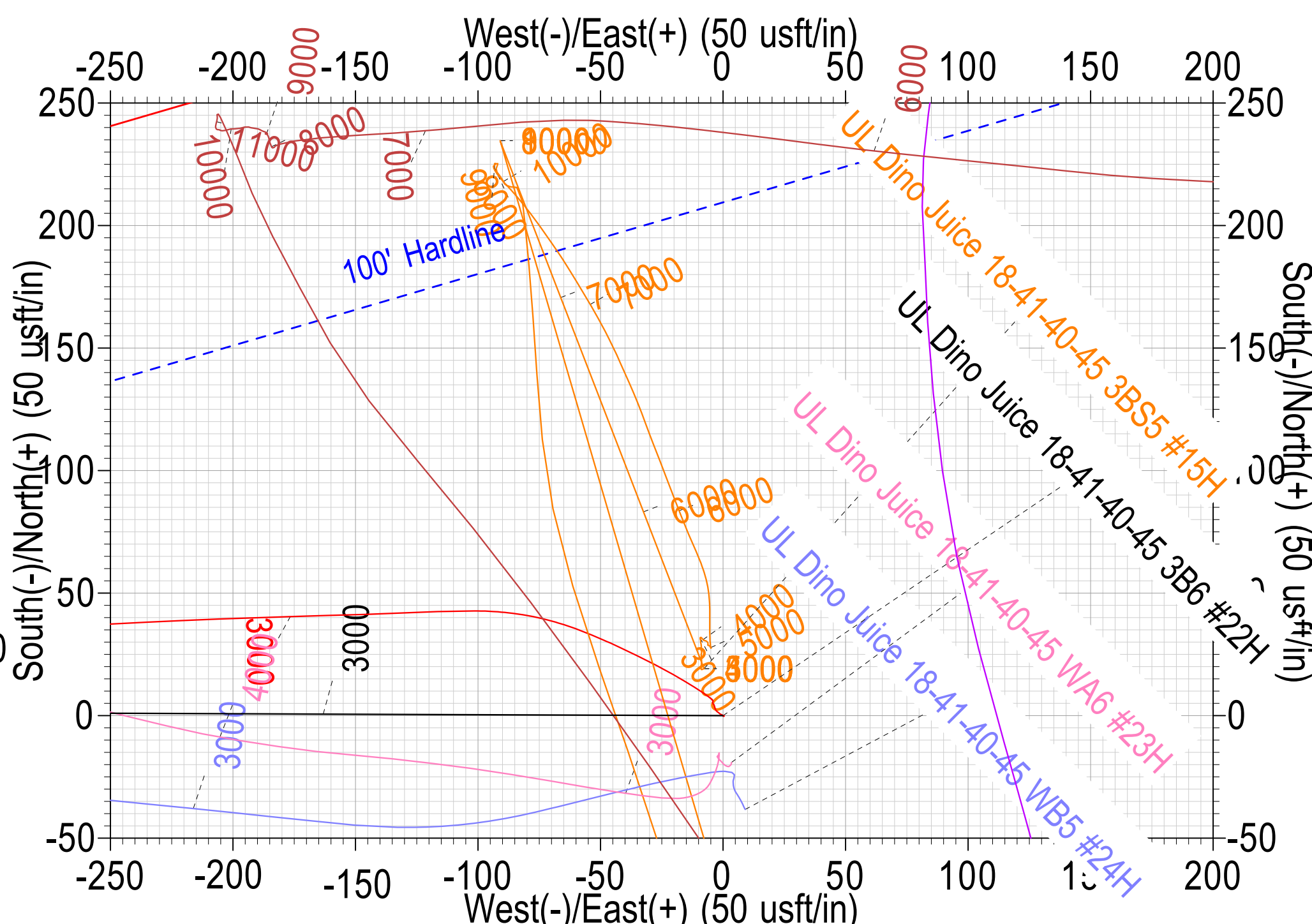
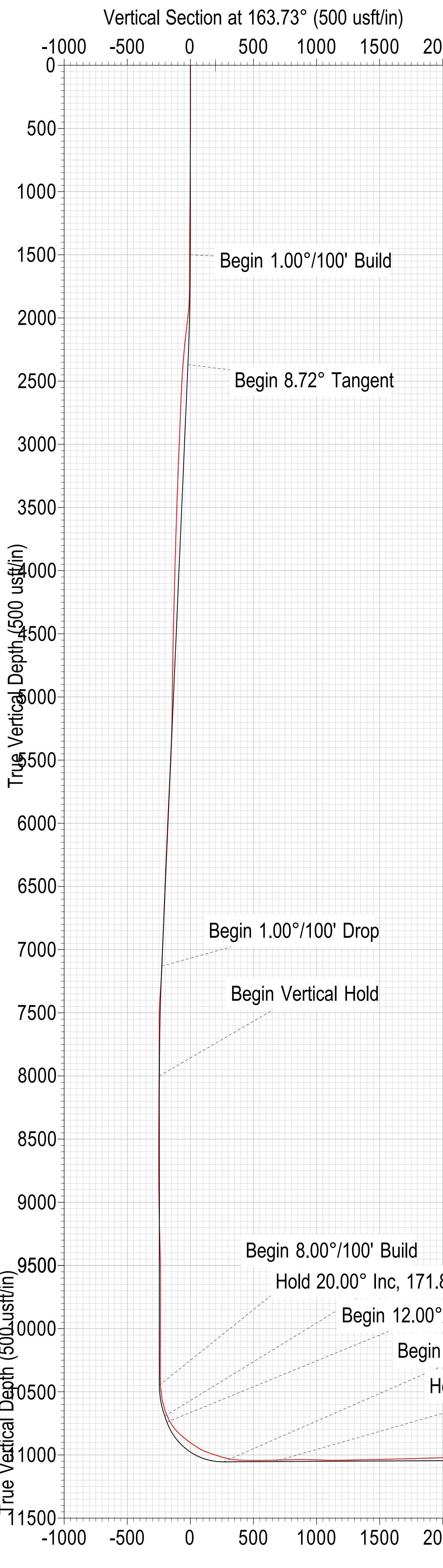

UL Dino Juice 18-41-40-45 3B6 #22H - Wellbore 1
MD/BHL: 26270.00'
TVD: 10913.26'
BHL NS/EW: -13967.04°/4870.31°
Cis Dist: 14791.83'
Cis Azi: 160.78°



**Point Energy Partners
Ward County, Texas (NAD 27)
42-475-38495
UL Dino Juice 18-41-40-45 3B6 22H
Wellbore 1**

**MS MWD
Certified Survey Report
26 May 2023**

Field	Ward County, Texas (NAD 27) - Point Energy Partners		
CRS	US-SPC27-EXACT / Texas Central 4203	North Reference	GRID
Apply Scale Factor	NO	Scale Factor	1.000
System Datum	Mean Sea Level	Depth Datum->MSL	2868.00Usft

Well	UL Dino Juice 18-41-40-45 3B6 22H		
Local North	19.145Usft	Local East	-3.480Usft
Map Northing	723441.145UsFt	Map Easting	1060051.730UsFt
Latitude	31° 37' 14.644" N	Longitude	103° 21' 12.207" W
Depth Datum / Rig	Well-Akita 90 / Akita 90	Datum Elevation	2868.00Usft
GL Elevation	2838.00Usft	Grid Convergence	-1.556

Wellbore	UL Dino Juice 18-41-40-45 3B6 22H - Wellbore 1		
Magnetic Model	User defined	Date	12/04/2023
Total Field (nT)	46925.40	Dip Angle (deg)	59.250
Declination	6.617		
VS Origin	Well	VS Azimuth	163.73
VS Origin NS	0.00Usft	VS Origin EW	0.00Usft

Survey Program	UL Dino Juice 18-41-40-45 3B6 22H - Wellbore 1		
Depth From Usft	Depth To Usft	Survey	Survey Tool
0.00	26270.00	MS MWD	MWD+HRGM

Certified Survey Report									
MD	INC	AZI	TVD	NS	EW	VS	DLS	BR	TR
Usft	deg	deg	Usft	Usft	Usft	Usft	deg/100Usft	deg/100Usft	deg/100Usft
0.00	0.00	0.00	0.00	0.00	0.00	0.00	0.00	0.00	0.00
168.00	0.22	93.78	168.00	-0.02	0.32	0.11	0.13	0.13	0.00
226.00	0.18	118.74	226.00	-0.07	0.51	0.21	0.16	-0.07	43.03
315.00	0.35	245.91	315.00	-0.25	0.39	0.35	0.54	0.19	142.89
403.00	0.13	41.83	403.00	-0.29	0.21	0.33	0.54	-0.25	177.18
500.00	0.13	307.53	500.00	-0.14	0.19	0.19	0.20	0.00	97.22
593.00	0.09	231.24	593.00	-0.12	0.05	0.13	0.15	-0.04	-82.03
686.00	0.40	325.10	686.00	0.10	-0.19	-0.15	0.45	0.33	100.92
779.00	0.35	284.59	779.00	0.44	-0.65	-0.60	0.28	-0.05	-43.56
872.00	0.62	311.66	871.99	0.85	-1.30	-1.18	0.37	0.29	29.11
964.00	0.53	301.29	963.99	1.40	-2.04	-1.91	0.15	-0.10	-11.27
1057.00	0.53	319.74	1056.98	1.95	-2.68	-2.62	0.18	0.00	19.84
1149.00	0.66	338.55	1148.98	2.77	-3.15	-3.54	0.25	0.14	20.45
1243.00	0.40	351.65	1242.97	3.60	-3.40	-4.40	0.30	-0.28	13.94
1405.00	0.31	328.97	1404.97	4.53	-3.70	-5.39	0.10	-0.06	-14.00
1435.00	0.22	311.83	1434.97	4.64	-3.79	-5.51	0.40	-0.30	-57.13
1528.00	0.22	312.01	1527.97	4.88	-4.05	-5.82	0.00	0.00	0.19
1621.00	0.31	356.48	1620.97	5.25	-4.20	-6.22	0.23	0.10	47.82
1714.00	0.31	32.25	1713.97	5.71	-4.08	-6.63	0.20	0.00	38.46
1805.00	0.70	324.49	1804.97	6.37	-4.27	-7.32	0.71	0.43	74.46
1897.00	5.01	305.06	1896.83	9.14	-7.89	-10.98	4.73	4.68	-21.12
1990.00	9.23	300.23	1989.09	15.23	-17.66	-19.57	4.58	4.54	-5.19
2083.00	9.41	296.71	2080.87	22.40	-30.90	-30.16	0.64	0.19	-3.78
2175.00	9.36	294.69	2171.63	28.91	-44.42	-40.19	0.36	-0.05	-2.20
2268.00	8.66	291.35	2263.49	34.62	-57.81	-49.43	0.94	-0.75	-3.59
2361.00	9.36	284.59	2355.34	39.07	-71.65	-57.58	1.36	0.75	-7.27
2453.00	9.36	276.68	2446.12	41.82	-86.32	-64.33	1.40	0.00	-8.60
2547.00	9.32	270.08	2538.88	42.72	-101.52	-69.46	1.14	-0.04	-7.02
2639.00	9.23	267.89	2629.67	42.46	-116.35	-73.36	0.40	-0.10	-2.38
2732.00	9.23	267.62	2721.47	41.88	-131.25	-76.97	0.05	0.00	-0.29
2825.00	9.32	268.06	2813.25	41.31	-146.23	-80.63	0.12	0.10	0.47
2918.00	9.23	268.50	2905.04	40.86	-161.21	-84.39	0.12	-0.10	0.47
3011.00	9.10	268.24	2996.85	40.44	-176.02	-88.14	0.15	-0.14	-0.28
3104.00	9.23	267.71	3088.66	39.92	-190.82	-91.78	0.17	0.14	-0.57
3197.00	9.32	268.41	3180.45	39.41	-205.80	-95.49	0.16	0.10	0.75
3290.00	9.05	267.10	3272.26	38.83	-220.64	-99.09	0.37	-0.29	-1.41
3382.00	9.05	267.18	3363.11	38.11	-235.09	-102.45	0.01	0.00	0.09
3475.00	9.14	266.92	3454.94	37.35	-249.77	-105.84	0.11	0.10	-0.28
3567.00	8.62	265.78	3545.84	36.45	-263.94	-108.94	0.60	-0.57	-1.24
3660.00	8.57	265.69	3637.79	35.42	-277.80	-111.83	0.06	-0.05	-0.10
3753.00	8.62	266.13	3729.75	34.43	-291.67	-114.77	0.09	0.05	0.47
3845.00	8.48	265.16	3820.73	33.39	-305.30	-117.59	0.22	-0.15	-1.05
3937.00	8.40	264.20	3911.73	32.14	-318.75	-120.16	0.18	-0.09	-1.04
4030.00	8.31	264.02	4003.74	30.75	-332.19	-122.59	0.10	-0.10	-0.19
4123.00	8.57	264.02	4095.74	29.33	-345.77	-125.03	0.28	0.28	0.00
4215.00	8.53	263.98	4186.71	27.90	-359.37	-127.47	0.04	-0.04	-0.04
4308.00	8.40	263.23	4278.70	26.38	-372.97	-129.82	0.18	-0.14	-0.81
4401.00	8.40	263.32	4370.70	24.79	-386.47	-132.07	0.01	0.00	0.10
4494.00	8.18	261.65	4462.73	23.04	-399.76	-134.11	0.35	-0.24	-1.80
4587.00	8.35	261.82	4554.77	21.11	-412.99	-135.97	0.18	0.18	0.18
4679.00	8.31	260.68	4645.80	19.09	-426.16	-137.72	0.18	-0.04	-1.24
4772.00	8.75	260.50	4737.77	16.83	-439.77	-139.37	0.47	0.47	-0.19

Certified Survey Report

MD Usft	INC deg	AZI deg	TVD Usft	NS Usft	EW Usft	VS Usft	DLS deg/100Usft	BR deg/100Usft	TR deg/100Usft
4865.00	8.62	258.13	4829.70	14.23	-453.57	-140.73	0.41	-0.14	-2.55
4958.00	8.84	257.16	4921.62	11.21	-467.36	-141.70	0.28	0.24	-1.04
5051.00	8.57	258.22	5013.55	8.21	-481.11	-142.67	0.34	-0.29	1.14
5144.00	8.35	260.15	5105.54	5.64	-494.54	-143.96	0.39	-0.24	2.08
5237.00	8.40	261.82	5197.55	3.51	-507.92	-145.67	0.27	0.05	1.80
5330.00	8.92	264.55	5289.49	1.86	-521.82	-147.98	0.71	0.56	2.94
5423.00	9.01	268.59	5381.35	1.00	-536.28	-151.21	0.68	0.10	4.34
5515.00	8.92	271.05	5472.23	0.95	-550.61	-155.18	0.43	-0.10	2.67
5608.00	9.05	271.58	5564.09	1.29	-565.13	-159.56	0.17	0.14	0.57
5702.00	8.92	270.96	5656.93	1.61	-579.81	-163.99	0.17	-0.14	-0.66
5794.00	8.84	270.44	5747.83	1.79	-594.01	-168.13	0.12	-0.09	-0.57
5886.00	9.01	269.47	5838.72	1.77	-608.28	-172.12	0.25	0.18	-1.05
5979.00	9.01	269.91	5930.57	1.70	-622.85	-176.13	0.07	0.00	0.47
6073.00	8.88	269.64	6023.43	1.64	-637.46	-180.17	0.15	-0.14	-0.29
6166.00	8.79	270.26	6115.32	1.63	-651.75	-184.16	0.14	-0.10	0.67
6261.00	8.92	270.08	6209.19	1.67	-666.37	-188.29	0.14	0.14	-0.19
6355.00	8.88	269.21	6302.06	1.58	-680.91	-192.28	0.15	-0.04	-0.93
6449.00	9.05	269.29	6394.91	1.39	-695.56	-196.20	0.18	0.18	0.09
6543.00	8.97	269.12	6487.75	1.18	-710.28	-200.13	0.09	-0.09	-0.18
6638.00	9.10	268.50	6581.57	0.87	-725.19	-204.01	0.17	0.14	-0.65
6732.00	9.05	268.41	6674.40	0.47	-740.01	-207.78	0.06	-0.05	-0.10
6827.00	9.05	267.01	6768.21	-0.12	-754.94	-211.39	0.23	0.00	-1.47
6920.00	8.97	266.22	6860.07	-0.98	-769.48	-214.64	0.16	-0.09	-0.85
7015.00	8.97	266.04	6953.90	-1.98	-784.26	-217.82	0.03	0.00	-0.19
7109.00	8.97	268.33	7046.75	-2.70	-798.90	-221.23	0.38	0.00	2.44
7204.00	8.84	272.90	7140.61	-2.55	-813.59	-225.49	0.76	-0.14	4.81
7299.00	8.97	276.41	7234.47	-1.35	-828.24	-230.74	0.59	0.14	3.69
7394.00	8.88	280.46	7328.32	0.80	-842.81	-236.90	0.67	-0.09	4.26
7488.00	7.47	280.81	7421.36	3.27	-855.95	-242.94	1.50	-1.50	0.37
7583.00	3.25	266.92	7515.93	4.28	-864.71	-246.37	4.62	-4.44	-14.62
7666.00	0.31	232.29	7598.88	4.02	-867.23	-246.82	3.61	-3.54	-41.72
7677.00	0.22	204.34	7609.88	3.98	-867.27	-246.80	1.41	-0.82	-254.09
7772.00	0.22	36.73	7704.88	3.96	-867.23	-246.77	0.46	0.00	-176.43
7867.00	0.09	284.59	7799.88	4.13	-867.20	-246.92	0.28	-0.14	118.04
7961.00	0.22	327.48	7893.88	4.30	-867.36	-247.13	0.18	0.14	45.63
8056.00	0.31	324.49	7988.88	4.66	-867.61	-247.55	0.10	0.09	-3.15
8149.00	0.22	333.63	8081.88	5.02	-867.84	-247.96	0.11	-0.10	9.83
8244.00	0.40	307.61	8176.87	5.39	-868.18	-248.41	0.24	0.19	-27.39
8339.00	0.48	304.27	8271.87	5.82	-868.77	-248.98	0.09	0.08	-3.52
8434.00	0.70	303.83	8366.87	6.36	-869.58	-249.73	0.23	0.23	-0.46
8528.00	0.70	288.98	8460.86	6.87	-870.60	-250.51	0.19	0.00	-15.80
8623.00	0.40	272.98	8555.85	7.08	-871.48	-250.95	0.35	-0.32	-16.84
8717.00	0.40	221.48	8649.85	6.85	-872.03	-250.88	0.37	0.00	-54.79
8812.00	0.48	209.18	8744.85	6.25	-872.44	-250.43	0.13	0.08	-12.95
8907.00	0.62	211.11	8839.85	5.46	-872.90	-249.80	0.15	0.15	2.03
9002.00	0.88	210.76	8934.84	4.40	-873.54	-248.96	0.27	0.27	-0.37
9096.00	1.23	210.58	9028.82	2.91	-874.42	-247.77	0.37	0.37	-0.19
9190.00	1.49	203.81	9122.79	0.92	-875.43	-246.15	0.32	0.28	-7.20
9283.00	1.85	203.64	9215.75	-1.56	-876.52	-244.07	0.39	0.39	-0.18
9377.00	2.24	205.04	9309.69	-4.61	-877.90	-241.53	0.42	0.41	1.49
9471.00	1.98	214.98	9403.63	-7.61	-879.61	-239.13	0.48	-0.28	10.57
9566.00	2.24	232.03	9498.57	-10.10	-882.02	-237.42	0.71	0.27	17.95
9660.00	2.81	244.33	9592.48	-12.22	-885.54	-236.36	0.83	0.61	13.09
9754.00	2.51	254.18	9686.38	-13.78	-889.60	-236.00	0.58	-0.32	10.48
9848.00	1.67	257.43	9780.31	-14.64	-892.92	-236.11	0.90	-0.89	3.46
9943.00	1.71	261.82	9875.27	-15.15	-895.67	-236.40	0.14	0.04	4.62
10037.00	2.07	264.02	9969.22	-15.52	-898.75	-236.90	0.39	0.38	2.34
10132.00	1.89	263.23	10064.16	-15.89	-902.01	-237.46	0.19	-0.19	-0.83
10227.00	1.58	259.01	10159.12	-16.32	-904.85	-237.84	0.35	-0.33	-4.44
10350.00	1.71	257.87	10282.07	-17.03	-908.31	-238.13	0.11	0.11	-0.93
10445.00	1.49	248.20	10377.03	-17.79	-910.84	-238.11	0.37	-0.23	-10.18
10539.00	3.52	153.89	10470.96	-20.83	-910.71	-235.15	4.17	2.16	-100.33
10633.00	10.90	159.08	10564.16	-31.74	-906.26	-223.43	7.87	7.85	5.52
10728.00	19.60	161.36	10655.72	-55.27	-897.94	-198.51	9.18	9.16	2.40
10811.00	27.47	162.42	10731.76	-86.76	-887.69	-165.41	9.50	9.48	1.28
10858.00	35.30	166.81	10771.86	-110.36	-881.31	-140.97	17.35	16.66	9.34
10905.00	43.69	169.63	10808.10	-139.60	-875.28	-111.21	18.25	17.85	6.00
10952.00	47.87	169.89	10840.87	-172.74	-869.30	-77.72	8.90	8.89	0.55
10999.00	51.96	170.33	10871.13	-208.16	-863.12	-41.99	8.73	8.70	0.94
11046.00	54.46	170.24	10899.27	-245.26	-856.77	-4.60	5.32	5.32	-0.19
11117.00	57.76	171.47	10938.86	-303.44	-847.42	53.87	4.87	4.65	1.73
11164.00	64.04	170.42	10961.70	-343.97	-840.95	94.59	13.50	13.36	-2.23
11211.00	70.20	171.03	10979.97	-386.69	-833.98	137.55	13.16	13.11	1.30
11258.00	71.87	170.59	10995.24	-430.56	-826.88	181.66	3.66	3.55	-0.94
11305.00	72.62	169.80	11009.58	-474.67	-819.25	226.13	2.26	1.60	-1.68
11399.00	78.86	167.60	11032.72	-563.95	-801.39	316.85	7.01	6.64	-2.34
11446.00	85.80	165.93	11038.99	-609.26	-790.73	363.33	15.18	14.77	-3.55
11494.00	87.60	165.32	11041.75	-655.68	-778.83	411.22	3.96	3.75	-1.27

Certified Survey Report

MD Usft	INC deg	AZI deg	TVD Usft	NS Usft	EW Usft	VS Usft	DLS deg/100Usft	BR deg/100Usft	TR deg/100Usft
11588.00	90.24	164.09	11043.53	-746.33	-754.04	505.18	3.10	2.81	-1.31
11683.00	90.99	164.09	11042.51	-837.68	-728.00	600.17	0.79	0.79	0.00
11777.00	91.47	164.00	11040.49	-928.04	-702.17	694.15	0.52	0.51	-0.10
11871.00	92.04	166.20	11037.61	-1018.83	-678.01	788.07	2.42	0.61	2.34
11965.00	89.10	166.20	11036.67	-1110.10	-655.59	881.97	3.13	-3.13	0.00
12060.00	88.70	166.11	11038.50	-1202.32	-632.86	976.87	0.43	-0.42	-0.09
12154.00	88.00	165.93	11041.20	-1293.50	-610.16	1070.75	0.77	-0.74	-0.19
12247.00	90.68	164.88	11042.28	-1383.48	-586.73	1163.70	3.09	2.88	-1.13
12342.00	91.87	167.69	11040.16	-1475.74	-564.22	1258.57	3.21	1.25	2.96
12437.00	90.59	162.95	11038.12	-1567.59	-540.15	1353.48	5.17	-1.35	-4.99
12530.00	91.60	165.76	11036.34	-1657.12	-515.08	1446.45	3.21	1.09	3.02
12625.00	90.55	165.85	11034.56	-1749.20	-491.79	1541.37	1.11	-1.11	0.09
12719.00	91.91	165.58	11032.54	-1840.27	-468.60	1635.29	1.48	1.45	-0.29
12812.00	91.74	161.63	11029.58	-1929.43	-442.37	1728.22	4.25	-0.18	-4.25
12907.00	91.69	161.19	11026.74	-2019.43	-412.10	1823.10	0.47	-0.05	-0.46
13000.00	91.38	162.07	11024.25	-2107.66	-382.80	1916.00	1.00	-0.33	0.95
13095.00	91.47	159.69	11021.88	-2197.38	-351.69	2010.85	2.51	0.09	-2.51
13189.00	90.77	159.52	11020.05	-2285.47	-318.94	2104.59	0.77	-0.74	-0.18
13282.00	90.81	160.57	11018.76	-2372.88	-287.21	2197.39	1.13	0.04	1.13
13374.00	90.24	160.57	11017.92	-2459.64	-256.60	2289.24	0.62	-0.62	0.00
13467.00	89.36	161.01	11018.25	-2547.46	-226.00	2382.12	1.06	-0.95	0.47
13559.00	89.98	161.36	11018.78	-2634.54	-196.33	2474.02	0.77	0.67	0.38
13652.00	89.14	160.31	11019.49	-2722.38	-165.80	2566.90	1.45	-0.90	-1.13
13745.00	89.54	161.01	11020.56	-2810.12	-135.01	2659.76	0.87	0.43	0.75
13838.00	88.92	161.01	11021.81	-2898.05	-104.75	2752.65	0.67	-0.67	0.00
13931.00	88.66	161.10	11023.77	-2986.00	-74.56	2845.53	0.30	-0.28	0.10
14024.00	89.58	164.00	11025.20	-3074.70	-46.68	2938.48	3.27	0.99	3.12
14117.00	89.23	164.44	11026.17	-3164.19	-21.39	3031.47	0.60	-0.38	0.47
14210.00	89.23	164.79	11027.42	-3253.85	3.28	3124.46	0.38	0.00	0.38
14303.00	90.64	164.53	11027.52	-3343.53	27.88	3217.44	1.54	1.52	-0.28
14397.00	90.15	164.26	11026.88	-3434.06	53.17	3311.43	0.60	-0.52	-0.29
14490.00	91.08	164.53	11025.88	-3523.63	78.18	3404.42	1.04	1.00	0.29
14582.00	91.03	164.44	11024.18	-3612.26	102.79	3496.40	0.11	-0.05	-0.10
14675.00	90.11	163.30	11023.26	-3701.59	128.62	3589.39	1.58	-0.99	-1.23
14768.00	91.65	165.41	11021.83	-3791.13	153.70	3682.36	2.81	1.66	2.27
14861.00	91.30	164.44	11019.44	-3880.90	177.88	3775.31	1.11	-0.38	-1.04
14954.00	90.86	163.74	11017.68	-3970.32	203.37	3868.29	0.89	-0.47	-0.75
15047.00	90.15	163.12	11016.86	-4059.45	229.89	3961.29	1.01	-0.76	-0.67
15140.00	90.15	163.38	11016.62	-4148.51	256.69	4054.28	0.28	0.00	0.28
15233.00	90.11	164.00	11016.41	-4237.76	282.81	4147.28	0.67	-0.04	0.67
15326.00	89.32	165.32	11016.87	-4327.45	307.41	4240.27	1.65	-0.85	1.42
15418.00	90.55	164.70	11016.98	-4416.31	331.21	4332.24	1.50	1.34	-0.67
15511.00	89.98	165.05	11016.55	-4506.09	355.47	4425.22	0.72	-0.61	0.38
15604.00	89.89	167.25	11016.65	-4596.38	377.73	4518.13	2.37	-0.10	2.37
15697.00	89.58	166.90	11017.08	-4687.02	398.53	4610.97	0.50	-0.33	-0.38
15790.00	89.23	166.64	11018.05	-4777.55	419.82	4703.84	0.47	-0.38	-0.28
15883.00	88.04	165.93	11020.26	-4867.87	441.86	4796.71	1.49	-1.28	-0.76
16005.00	90.00	165.67	11022.35	-4986.12	471.78	4918.61	1.62	1.61	-0.21
16098.00	90.00	164.57	11022.35	-5076.00	495.66	5011.58	1.18	0.00	-1.18
16191.00	90.55	162.97	11021.90	-5165.29	521.65	5104.58	1.82	0.59	-1.72
16283.00	90.60	163.57	11020.98	-5253.39	548.14	5196.57	0.65	0.05	0.65
16376.00	90.55	162.97	11020.05	-5342.45	574.91	5289.56	0.65	-0.05	-0.65
16468.00	91.10	162.37	11018.72	-5430.26	602.31	5381.54	0.88	0.60	-0.65
16561.00	90.80	162.57	11017.18	-5518.93	630.32	5474.50	0.39	-0.32	0.22
16654.00	90.90	162.27	11015.80	-5607.58	658.40	5567.47	0.34	0.11	-0.32
16747.00	91.05	162.17	11014.22	-5696.12	686.80	5660.42	0.19	0.16	-0.11
16840.00	90.95	161.77	11012.59	-5784.54	715.58	5753.36	0.44	-0.11	-0.43
16933.00	91.20	161.77	11010.85	-5872.86	744.66	5846.29	0.27	0.27	0.00
17026.00	91.45	162.37	11008.70	-5961.32	773.29	5939.23	0.70	0.27	0.65
17119.00	90.85	161.97	11006.83	-6049.83	801.76	6032.17	0.78	-0.65	-0.43
17211.00	91.90	163.57	11004.63	-6137.67	829.00	6124.13	2.08	1.14	1.74
17304.00	91.15	162.17	11002.15	-6226.51	856.38	6217.08	1.71	-0.81	-1.51
17397.00	90.85	162.07	11000.53	-6315.01	884.93	6310.03	0.34	-0.32	-0.11
17490.00	91.25	161.97	10998.82	-6403.45	913.63	6402.97	0.44	0.43	-0.11
17583.00	91.10	161.97	10996.92	-6491.87	942.41	6495.91	0.16	-0.16	0.00
17675.00	91.05	163.47	10995.19	-6579.70	969.73	6587.88	1.63	-0.05	1.63
17769.00	90.95	163.07	10993.55	-6669.70	996.79	6681.86	0.44	-0.11	-0.43
17863.00	90.95	162.97	10991.99	-6759.59	1024.24	6775.84	0.11	0.00	-0.11
17956.00	90.80	162.97	10990.57	-6848.50	1051.47	6868.82	0.16	-0.16	0.00
18049.00	90.45	163.27	10989.56	-6937.49	1078.47	6961.81	0.50	-0.38	0.32
18141.00	89.80	165.27	10989.35	-7026.04	1103.41	7053.80	2.29	-0.71	2.17
18233.00	90.00	164.77	10989.52	-7114.91	1127.19	7145.78	0.59	0.22	-0.54
18326.00	90.35	162.57	10989.23	-7204.16	1153.34	7238.77	2.40	0.38	-2.37
18420.00	90.25	162.07	10988.74	-7293.72	1181.89	7332.74	0.54	-0.11	-0.53
18512.00	89.55	161.47	10988.90	-7381.10	1210.67	7424.69	1.00	-0.76	-0.65
18605.00	90.50	162.67	10988.86	-7469.58	1239.30	7517.64	1.65	1.02	1.29
18698.00	90.75	163.77	10987.84	-7558.61	1266.15	7610.63	1.21	0.27	1.18
18791.00	90.65	164.47	10986.71	-7648.05	1291.59	7703.62	0.76	-0.11	0.75

Certified Survey Report

MD Usft	INC deg	AZI deg	TVD Usft	NS Usft	EW Usft	VS Usft	DLS deg/100Usft	BR deg/100Usft	TR deg/100Usft
18884.00	90.40	164.37	10985.86	-7737.63	1316.57	7796.61	0.29	-0.27	-0.11
18977.00	90.35	167.37	10985.25	-7827.81	1339.27	7889.53	3.23	-0.05	3.23
19069.00	90.65	165.37	10984.44	-7917.21	1360.95	7981.43	2.20	0.33	-2.17
19162.00	91.05	164.17	10983.07	-8006.93	1385.37	8074.40	1.36	0.43	-1.29
19255.00	90.40	164.07	10981.89	-8096.37	1410.82	8167.39	0.71	-0.70	-0.11
19348.00	91.05	167.47	10980.71	-8186.50	1433.67	8260.31	3.72	0.70	3.66
19441.00	92.65	165.37	10977.71	-8276.84	1455.50	8353.15	2.84	1.72	-2.26
19534.00	91.25	162.77	10974.54	-8366.21	1481.00	8446.09	3.17	-1.51	-2.80
19627.00	90.40	162.07	10973.20	-8454.86	1509.09	8539.05	1.18	-0.91	-0.75
19720.00	90.45	161.27	10972.51	-8543.13	1538.34	8631.99	0.86	0.05	-0.86
19812.00	90.90	162.37	10971.43	-8630.53	1567.04	8723.93	1.29	0.49	1.20
19905.00	90.70	161.07	10970.13	-8718.83	1596.21	8816.86	1.41	-0.22	-1.40
19999.00	92.70	164.07	10967.34	-8808.46	1624.35	8910.78	3.83	2.13	3.19
20092.00	89.55	162.27	10965.52	-8897.44	1651.26	9003.75	3.90	-3.39	-1.94
20184.00	89.40	159.17	10966.36	-8984.27	1681.64	9095.60	3.37	-0.16	-3.37
20277.00	88.60	159.37	10967.98	-9071.24	1714.55	9188.31	0.89	-0.86	0.22
20368.00	89.90	161.27	10969.17	-9156.91	1745.19	9279.13	2.53	1.43	2.09
20461.00	91.30	163.87	10968.20	-9245.62	1773.04	9372.10	3.18	1.51	2.80
20554.00	92.80	165.37	10964.87	-9335.23	1797.69	9465.02	2.28	1.61	1.61
20647.00	91.65	164.97	10961.26	-9425.06	1821.48	9557.92	1.31	-1.24	-0.43
20741.00	91.65	166.37	10958.56	-9516.10	1844.73	9651.82	1.49	0.00	1.49
20833.00	90.70	167.57	10956.67	-9605.71	1865.47	9743.66	1.66	-1.03	1.30
20926.00	91.50	164.87	10954.88	-9696.00	1887.62	9836.54	3.03	0.86	-2.90
21018.00	92.20	163.87	10951.91	-9784.55	1912.39	9928.49	1.33	0.76	-1.09
21111.00	91.15	162.67	10949.20	-9873.58	1939.15	10021.44	1.71	-1.13	-1.29
21203.00	91.40	162.67	10947.15	-9961.38	1966.55	10113.40	0.27	0.27	0.00
21296.00	91.40	163.07	10944.88	-10050.23	1993.93	10206.36	0.43	0.00	0.43
21389.00	91.25	163.17	10942.73	-10139.20	2020.93	10299.33	0.19	-0.16	0.11
21482.00	90.00	162.07	10941.71	-10227.94	2048.70	10392.31	1.79	-1.34	-1.18
21575.00	90.35	167.07	10941.43	-10317.56	2073.44	10485.27	5.39	0.38	5.38
21668.00	90.55	164.47	10940.70	-10407.70	2096.30	10578.20	2.80	0.22	-2.80
21761.00	88.65	162.97	10941.35	-10496.96	2122.37	10671.19	2.60	-2.04	-1.61
21854.00	89.25	161.47	10943.05	-10585.50	2150.76	10764.14	1.74	0.65	-1.61
21947.00	90.80	165.77	10943.01	-10674.70	2176.98	10857.11	4.91	1.67	4.62
22039.00	90.40	163.27	10942.05	-10763.35	2201.53	10949.09	2.75	-0.43	-2.72
22132.00	89.95	160.07	10941.76	-10851.62	2230.77	11042.02	3.47	-0.48	-3.44
22225.00	90.50	157.37	10941.40	-10938.27	2264.52	11134.65	2.96	0.59	-2.90
22318.00	87.95	154.57	10942.65	-11023.19	2302.38	11226.78	4.07	-2.74	-3.01
22411.00	89.85	156.17	10944.44	-11107.70	2341.13	11318.76	2.67	2.04	1.72
22504.00	88.85	155.07	10945.50	-11192.40	2379.52	11410.83	1.60	-1.08	-1.18
22597.00	89.35	155.07	10946.96	-11276.73	2418.71	11502.75	0.54	0.54	0.00
22690.00	89.40	156.07	10947.97	-11361.39	2457.17	11594.81	1.08	0.05	1.08
22783.00	91.60	157.27	10947.16	-11446.78	2494.00	11687.09	2.69	2.37	1.29
22876.00	92.75	157.37	10943.63	-11532.52	2529.83	11779.44	1.24	1.24	0.11
22969.00	93.15	153.07	10938.84	-11616.83	2568.75	11871.27	4.64	0.43	-4.62
23061.00	94.00	147.47	10933.10	-11696.53	2614.26	11960.53	6.14	0.92	-6.09
23151.00	92.84	143.52	10927.73	-11770.55	2665.15	12045.84	4.57	-1.29	-4.39
23244.00	89.76	142.12	10925.62	-11844.62	2721.33	12132.68	3.64	-3.31	-1.51
23337.00	89.58	141.41	10926.15	-11917.67	2778.88	12218.93	0.79	-0.19	-0.76
23430.00	89.93	141.94	10926.55	-11990.62	2836.55	12305.12	0.68	0.38	0.57
23523.00	88.44	141.32	10927.88	-12063.53	2894.27	12391.28	1.74	-1.60	-0.67
23616.00	88.18	140.62	10930.62	-12135.74	2952.81	12477.00	0.80	-0.28	-0.75
23709.00	88.31	138.07	10933.47	-12206.25	3013.37	12561.66	2.74	0.14	-2.74
23801.00	90.51	138.34	10934.41	-12274.84	3074.68	12644.67	2.41	2.39	0.29
23894.00	88.22	133.33	10935.45	-12341.52	3139.44	12726.83	5.92	-2.46	-5.39
23988.00	88.26	132.62	10938.33	-12405.57	3208.18	12807.57	0.76	0.04	-0.76
24080.00	89.41	132.54	10940.20	-12467.80	3275.91	12886.28	1.25	1.25	-0.09
24173.00	90.33	131.66	10940.41	-12530.15	3344.91	12965.47	1.37	0.99	-0.95
24267.00	91.43	131.83	10938.97	-12592.73	3415.04	13045.19	1.18	1.17	0.18
24359.00	91.78	131.92	10936.39	-12654.11	3483.52	13123.30	0.39	0.38	0.10
24452.00	91.87	132.71	10933.43	-12716.69	3552.25	13202.63	0.85	0.10	0.85
24545.00	92.35	131.48	10930.01	-12778.99	3621.21	13281.75	1.42	0.52	-1.32
24637.00	90.59	133.06	10927.65	-12840.85	3689.26	13360.20	2.57	-1.91	1.72
24730.00	91.30	132.10	10926.11	-12903.76	3757.73	13439.78	1.28	0.76	-1.03
24822.00	90.59	130.60	10924.60	-12964.53	3826.78	13517.46	1.80	-0.77	-1.63
24915.00	91.38	133.15	10923.00	-13026.60	3896.01	13596.43	2.87	0.85	2.74
25007.00	91.74	134.21	10920.49	-13090.11	3962.52	13676.04	1.22	0.39	1.15
25100.00	91.12	133.33	10918.17	-13154.42	4029.66	13756.58	1.16	-0.67	-0.95
25192.00	90.29	135.35	10917.04	-13218.71	4095.45	13836.73	2.37	-0.90	2.20
25285.00	90.59	134.21	10916.33	-13284.22	4161.46	13918.11	1.27	0.32	-1.23
25378.00	91.25	131.74	10914.83	-13347.60	4229.49	13998.01	2.75	0.71	-2.66
25471.00	91.30	131.48	10912.76	-13409.34	4299.00	14076.75	0.28	0.05	-0.28
25563.00	91.08	130.60	10910.85	-13469.74	4368.38	14154.17	0.99	-0.24	-0.96
25657.00	89.85	131.74	10910.09	-13531.61	4439.13	14233.39	1.78	-1.31	1.21
25750.00	92.57	135.26	10908.12	-13595.60	4506.56	14313.70	4.78	2.92	3.78
25843.00	89.76	135.96	10906.23	-13662.03	4571.60	14395.70	3.11	-3.02	0.75
25936.00	89.19	136.23	10907.09	-13729.04	4636.09	14478.08	0.68	-0.61	0.29
26028.00	89.10	135.79	10908.46	-13795.22	4699.98	14559.52	0.49	-0.10	-0.48

Certified Survey Report

MD Usft	INC deg	AZI deg	TVD Usft	NS Usft	EW Usft	VS Usft	DLS deg/100Usft	BR deg/100Usft	TR deg/100Usft
26121.00	89.10	135.61	10909.92	-13861.77	4764.92	14641.60	0.19	0.00	-0.19
26202.00	88.57	134.73	10911.57	-13919.20	4822.02	14712.72	1.27	-0.65	-1.09
26270.00	88.57	134.73	10913.26	-13967.04	4870.31	14772.18	0.00	0.00	0.00 PTB



3335 Pollok Drive
Conroe, Texas 77303
936.442.2500 (office)
www.msdir.com

MS Directional LLC Survey Data Certification

MS Directional LLC Job Number: MSMO-106061
Survey Type: MWD
Operating Company: Point Energy Partners
Well Name and Number: UL Dino Juice 18-41-40-45 3B6 22H
Drainhole Number: Original Wellbore
Location: Ward, Texas
API Number: 42-475-38495
Tie In Depth: 0.00
Surveyed Depths: 168.00' - 26202.00'
Projected TD Survey: 26270.00'
Dates Performed: 04/17/2023 - 05/21/2023

To the best of my knowledge, I certify the following:

1. The data is true, correct and complete and within the limitations of the tool set forth by MS Directional LLC
2. I am authorized and qualified to make this report; and
3. I have reviewed this report and find it conforms to the principles and procedures as set forth by MS Directional LLC

MWD Surveyor Name: Chris Alley

MWD Operations Manager: Charles Davis

Signature:

A handwritten signature in black ink, appearing to read "CWD" followed by a stylized flourish.

Date: 05/26/2023

Email: charles.davis@msdir.com