



RAILROAD COMMISSION OF TEXAS

Form W-2

1701 N. Congress
P.O. Box 12967
Austin, Texas 78701-2967

Status: Approved
Date: 11/04/2019
Tracking No.: 216186

OIL WELL POTENTIAL TEST, COMPLETION OR RECOMPLETION REPORT, AND LOG

OPERATOR INFORMATION

Operator Name: FELIX ENERGY HOLDINGS II, LLC Operator No.: 265322
Operator Address: FELIX ENERGY 1530 16TH ST SUITE 500 DENVER, CO 80202-0000

WELL INFORMATION

API No.: 42-475-37718 County: WARD
Well No.: 2H RRC District No.: 08
Lease Name: UL INDEPENDENCE 1718-17 B Field Name: PHANTOM (WOLFCAMP)
RRC Lease No.: 52396 Field No.: 71052900
Location: Section: 16, Block: 17, Survey: UL, Abstract: U55

Latitude: Longitude:
This well is located 4.14 miles in a NW
direction from PYOTE,
which is the nearest town in the county.

FILING INFORMATION

Purpose of filing: Initial Potential
Type of completion: New Well
Well Type: Producing Completion or Recompletion Date: 04/27/2019

Type of Permit	Date	Permit No.
Permit to Drill, Plug Back, or Deepen	10/31/2018	846192
Rule 37 Exception		
Fluid Injection Permit		
O&G Waste Disposal Permit		
Other:		

COMPLETION INFORMATION

Spud date: 11/18/2018	Date of first production after rig released: 04/27/2019
Date plug back, deepening, recompletion, or drilling operation commenced: 11/18/2018	Date plug back, deepening, recompletion, or drilling operation ended: 01/29/2019
Number of producing wells on this lease in this field (reservoir) including this well: 5	Distance to nearest well in lease & reservoir (ft.): 77.0
Total number of acres in lease: 640.64	Elevation (ft.): 2664 GR
Total depth TVD (ft.): 11381	Total depth MD (ft.): 22402
Plug back depth TVD (ft.):	Plug back depth MD (ft.):
Was directional survey made other than inclination (Form W-12)? Yes	Rotation time within surface casing (hours): 74.0
Recompletion or reclass? No	Is Cementing Affidavit (Form W-15) attached? Yes
Type(s) of electric or other log(s) run: Gamma Ray (MWD)	Multiple completion? No
Electric Log Other Description:	
Location of well, relative to nearest lease boundaries	Off Lease : No
of lease on which this well is located:	613.0 Feet from the South Line and
	678.0 Feet from the East Line of the
	UL INDEPENDENCE 1718-17 B Lease.

FORMER FIELD (WITH RESERVOIR) & GAS ID OR OIL LEASE NO.

Field & Reservoir	Gas ID or Oil Lease No.	Well No.	Prior Service Type
-------------------	-------------------------	----------	--------------------

PACKET: N/A

W2:	N/A		
FOR NEW DRILL OR RE-ENTRY, SURFACE CASING DEPTH DETERMINED BY:			
GAU Groundwater Protection Determination	Depth (ft.):	800.0	Date: 10/30/2018
SWR 13 Exception	Depth (ft.):		

INITIAL POTENTIAL TEST DATA FOR NEW COMPLETION OR RECOMPLETION		
Date of test: 06/04/2019		Production method: Flowing
Number of hours tested: 24		Choke size: 27
Was swab used during this test?	No	Oil produced prior to test: 24966.00
PRODUCTION DURING TEST PERIOD:		
Oil (BBLS): 1092.00		Gas (MCF): 1331
Gas - Oil Ratio: 1218		Flowing Tubing Pressure: 0.00
Water (BBLS): 2423		
CALCULATED 24-HOUR RATE		
Oil (BBLS): 1092.0		Gas (MCF): 1331
Oil Gravity - API - 60.:	45.6	Casing Pressure: 2221.00
Water (BBLS): 2423		

CASING RECORD											
Row	Type of Casing	Casing Size (in.)	Hole Size (in.)	Setting Depth (ft.)	Multi - Stage Depth (ft.)	Multi - Stage Shoe Depth (ft.)	Cement Class	Cement Amount (sacks)	Slurry Volume (cu. ft.)	Top of Cement (ft.)	TOC Determined By
1	Surface	13 3/8	17 1/2	945			C	1035	1800.0	SURFACE	Circulated to Surface
2	Intermediate	10 3/4	12 1/4	5081			C	1150	2604.8	0	Circulated to Surface
3	Intermediate	7 5/8	9 7/8	10893			NEOCEM; HALCEM H	710	1444.0	5223	Calculation
4	Intermediate	7 5/8	8 3/4	10893			NEOCEM; HALCEM H	710	1444.0	5223	Calculation
5	Intermediate	7 5/8	9 7/8	10893	5223		ECONOCE M C;	515	1166.0	699	Calculation
6	Intermediate	7 5/8	8 3/4	10893	5223		HALCEM C ECONOCE M C;	515	1166.0	699	Calculation
7	Conventional Production	5 1/2	6 3/4	22393			HALCEM C H	1520	1863.5	3810	Calculation

LINER RECORD									
Row	Liner Size (in.)	Hole Size (in.)	Liner Top (ft.)	Liner Bottom (ft.)	Cement Class	Cement Amount (sacks)	Slurry Volume (cu. ft.)	Top of Cement (ft.)	TOC Determined By
N/A									

TUBING RECORD			
<u>Row</u>	<u>Size (in.)</u>	<u>Depth Size (ft.)</u>	<u>Packer Depth (ft.)/Type</u>
/			
N/A			

PRODUCING/INJECTION/DISPOSAL INTERVAL			
Row	Open hole?	From (ft.)	To (ft.)
1	No	L1 11674	22225.0

ACID, FRACTURE, CEMENT SQUEEZE, CAST IRON BRIDGE PLUG, RETAINER, ETC.			
Was hydraulic fracturing treatment performed?		Yes	
Is well equipped with a downhole actuation sleeve?		No	
If yes, actuation pressure (PSIG):			
Production casing test pressure (PSIG) prior to hydraulic fracturing treatment:		12688	
Actual maximum pressure (PSIG) during hydraulic fracturing:		12084	
Has the hydraulic fracturing fluid disclosure been reported to FracFocus disclosure registry (SWR29)?		Yes	
Row	Type of Operation	Amount and Kind of Material Used	Depth Interval (ft.)
1	Fracture	566,513 BBLS SLKWTR; 32,044,390 LBS PROPPANT	11674 22225

FORMATION RECORD					
Formations	Encountered	Depth TVD (ft.)	Depth MD (ft.)	Is formation isolated?	Remarks
RUSTLER	Yes	1233.0	1233.0	Yes	
YATES	No			No	NOT PRESENT
SEVEN RIVERS	No			No	NOT PRESENT
QUEEN	No			No	NOT PRESENT
GLORIETA	No			No	NOT PRESENT
SAN ANDRES - HIGH FLOWS, H2S, CORROSIVE HOLT	No			No	NOT PRESENT
CLEARFORK	No			No	NOT PRESENT
DELAWARE	Yes	4989.0	4993.0	Yes	
TUBB	No			No	NOT PRESENT
WICHITA ALBANY	No			No	NOT PRESENT
CHERRY CANYON	Yes	5928.0	5932.0	Yes	
WADDELL	No			No	NOT PRESENT
BONE SPRINGS	Yes	8500.0	8504.0	Yes	
WOLFCAMP	Yes	11278.0	11321.0	Yes	
MONTOYA	No			No	NOT PENETRATED
PENNSYLVANIAN	No			No	NOT PENETRATED
ATOKA	No			No	NOT PENETRATED
FUSSELMAN	No			No	NOT PENETRATED
DEVONIAN	No			No	NOT PENETRATED
ELLENBURGER	No			No	NOT PENETRATED
Do the producing interval of this well produce H2S with a concentration in excess of 100 ppm (SWR 36)?					No
Is the completion being downhole commingled (SWR 10)?					No

REMARKS

RRC REMARKS
PUBLIC COMMENTS: [RRC Staff 2019-09-18 14:38:59.32] EDL=10550 feet, max acres=704, PHANTOM (WOLFCAMP) oil or gas well; take points: 11674-22225 feet
CASING RECORD : KOP @ 11,030'
TUBING RECORD: MORE ECONOMIC TO FLOWBACK WELL UP CASING
PRODUCING/INJECTION/DISPOSAL INTERVAL :
ACID, FRACTURE, CEMENT SQUEEZE, CAST IRON BRIDGE PLUG, RETAINER, ETC. :
POTENTIAL TEST DATA:

OPERATOR'S CERTIFICATION	
Printed Name: Heather Dahlgren	Title: Felix Admin Services
Telephone No.: (720) 974-2069	Date Certified: 06/19/2019



RAILROAD COMMISSION OF TEXAS

1701 N. Congress
P.O. Box 12967
Austin, Texas 78701-2967

CEMENTING REPORT

Form W-15

Rev. 08/2014

Cementer: Fill in shaded areas.

Operator: Fill in other items.

OPERATOR INFORMATION	
Operator Name: FELIX	Operator P-5 No.: 265322
Cementer Name: HALLIBURTON	Cementer P-5 No.: 347151

WELL INFORMATION	
District No.: 08	County: WARD
Well No.: 2H	API No.: 42-475-37718
Lease Name: UL INDEPENDENCE 1718-17 B	Drilling Permit No.: 846192
Field Name: Phantom (Wofford)	Lease No.:
	Field No.: 71052900

I. CASING CEMENTING DATA					
Type of casing: <input type="checkbox"/> Conductor <input checked="" type="checkbox"/> Surface <input type="checkbox"/> Intermediate <input type="checkbox"/> Liner <input type="checkbox"/> Production					
Drilled hole size (in.): 17.5	Depth of drilled hole (ft.): 960	Est. % wash-out or hole enlargement: 20			
Size of casing in O.D. (in.): 13 3/8	Casing weight (lbs/ft) and grade: 54.5 J55	No. of centralizers used: 7			
Was cement circulated to ground surface (or bottom of cellar) outside casing? <input checked="" type="checkbox"/> YES <input type="checkbox"/> NO If no for surface casing, explain in Remarks.		Setting depth shoe (ft.): 945	Top of liner (ft.):		
Hrs. waiting on cement before drill-out: 65	Calculated top of cement (ft.): 0	Setting depth liner (ft.):			
Cementing date: 11/19/18					
SLURRY					
Slurry No.	No. of Sacks	Class	Additives	Volume (cu. ft.)	Height (ft.)
1	695	C	SEE REMARKS	1347	362
2	340	C		453	598
3					
Total	1035			1800	

II. CASING CEMENTING DATA					
Type of casing: <input type="checkbox"/> Surface <input type="checkbox"/> Intermediate <input type="checkbox"/> Production <input type="checkbox"/> Tapered production <input type="checkbox"/> Multi-stage cement shoe <input type="checkbox"/> Multiple parallel strings					
Drilled hole size (in.):	Depth of drilled hole (ft.):	Est. % wash-out or hole enlargement:			
Size of casing in O.D. (in.):	Casing weight (lbs/ft) and grade:	No. of centralizers used:			
Tapered string drilled hole size (in.)		Tapered string drilled hole size (in.)			
Upper:	Lower:	Upper:	Lower:		
Tapered string size of casing in O.D. (in.)		Tapered string casing weight (lbs/ft) and grade		Tapered string no. of centralizers used	
Upper:	Lower:	Upper:	Lower:	Upper:	Lower:
Was cement circulated to ground surface (or bottom of cellar) outside casing? <input type="checkbox"/> YES <input type="checkbox"/> NO				Setting depth shoe (ft.):	
Hrs. waiting on cement before drill-out:	Calculated top of cement (ft.):	Cementing date:			
SLURRY					
Slurry No.	No. of Sacks	Class	Additives	Volume (cu. ft.)	Height (ft.)
1					
2					
3					
Total					

III. CASING CEMENTING DATA		
Type of casing: <input type="checkbox"/> Surface <input type="checkbox"/> Intermediate <input type="checkbox"/> Production <input type="checkbox"/> Tapered production <input type="checkbox"/> Multi-stage cement tool <input type="checkbox"/> Multiple parallel strings		
Drilled hole size (in.):	Depth of drilled hole (ft.):	Est. % wash-out or hole enlargement:
Size of casing in O.D. (in.):	Casing weight (lbs/ft) and grade:	No. of centralizers used:

Tapered string drilled hole size (in.) Upper: Lower:		Tapered string drilled hole size (in.) Upper: Lower:	
Tapered string size of casing in O.D. (in.) Upper: Lower:		Tapered string casing weight(lbs/ft) and grade Upper: Lower:	
		Tapered string no. of centralizers used Upper: Lower:	
Was cement circulated to ground surface (or bottom of cellar) outside casing? <input type="checkbox"/> YES <input type="checkbox"/> NO		Setting depth shoe (ft.):	
Hrs. waiting on cement before drill-out:		Calculated top of cement (ft.):	
		Cementing date:	
SLURRY			
Slurry No.	No. of Sacks	Class	Additives
1			
2			
3			
Total			

CEMENTING TO SQUEEZE, PLUG BACK OR PLUG AND ABANDON							
	PLUG #1	PLUG #2	PLUG #3	PLUG #4	PLUG #5	PLUG #6	PLUG #7
Cementing Date							
Size of hole or pipe (in.)							
Depth to bottom of tubing or drill pipe (ft.)							
Cement retainer setting depth (ft.)							
CIBP setting depth (ft.)							
Amount of cement on top of CIBP (ft.)							
Sacks of cement used							
Slurry volume pumped (cu. ft.)							
Calculated top of plug (ft.)							
Measured top of plug, if tagged (ft.)							
Slurry weight (lbs/gal)							
Class/type of cement							
Perforate and squeeze (YES/NO)							

REMARKS
LEAD CEMENT: 3lbm KOL-SEAL, 0.125 LBM POL-E-FLAKE

CEMENTER'S CERTIFICATE: I declare under penalties prescribed in Sec. 91.143, Texas Natural Resources Code, that I am authorized to make this certification, that the cementing of casing and/or the placing of cement plugs in this well as shown in the report was performed by me or under my supervision, and that the cementing data and facts presented on both sides of this form are true, correct, and complete, to the best of my knowledge. This certification covers cementing data only.

KYLE LANGSTON, SSI
Name and title of cementer's representative
6155 W Murphy Odessa, TX 79763
Address City, State, Zip Code

Halliburton Energy Services
Cementing Company
432-571-8600
Tel: Area Code Number

Kyle Langston
Signature
11/19/18
Date: mo. day yr.

OPERATOR'S CERTIFICATE: I declare under penalties prescribed in Sec. 91.143, Texas Natural Resources Code, that I am authorized to make this certification, that I have knowledge of the well data and information presented in this report, and that data and facts presented on both sides of this form are true, correct, and complete, to the best of my knowledge. This certification covers all well data.

Jeff Gray
Typed or printed name of operator's representative

DSM
Title

Jeff Gray
Signature

1530 16th St #500 Denver, CO 80202
Address City, State, Zip Code
720-974-2054
Tel: Area Code Number

11/19/18
Date: mo. day yr.

Instructions for form W-15, Cementing Report



RAILROAD COMMISSION OF TEXAS

1701 N. Congress
P.O. Box 12967
Austin, Texas 78701-2967

Form W-15

Rev. 08/2014

CEMENTING REPORT

Cementer: Fill in shaded areas.
Operator: Fill in other items.

OPERATOR INFORMATION

Operator Name: FELIX ENERGY

Cementer Name: HALLIBURTON ENERGY SERVICES

Operator P-5 No.: 265322

Cementer P-5 No.: 347151

WELL INFORMATION

District No.: 08

Well No.: 2H

Lease Name: UL INDEPENDENCE 171B-17 B

Field Name: Phantom Wolfcamp

County: WARD

API No.: 42-475-37718

Lease No.:

Drilling Permit No.: 846192

Field No.: 71052900

CASING CEMENTING DATA

Type of casing: ☐ Conductor ☐ Surface ☒ Intermediate ☐ Liner ☐ Production

Drilled hole size (in.): 12.25"

Depth of drilled hole (ft.): 5095'

Est. % wash-out or hole enlargement: 20 %

Size of casing in O.D. (in.): 10.75"

Casing weight (lbs/ft) and grade: 45.5# J-55

No. of centralizers used: 8

Was cement circulated to ground surface (or bottom of cellar) outside casing? ☒ YES ☐ NO If no for surface casing, explain in Remarks.

Setting depth shoe (ft.): 5081

Top of liner (ft.):

Setting depth liner (ft.):

Hrs. waiting on cement before drill-out: 38

Calculated top of cement (ft.): 0'

Cementing date: 11/24/18

SLURRY

Slurry No.	No. of Sacks	Class	Additives	Volume (cu. ft.)	Height (ft.)
1	920	C	SEE REMARKS	2294.48	4941
2	230	C	SEE REMARKS	310.27	522
3					
Total	1150			2604.75	5463

II. CASING CEMENTING DATA

Type of casing: ☐ Surface ☐ Intermediate ☐ Production ☐ Tapered production ☐ Multi-stage cement shoe ☐ Multiple parallel strings

Drilled hole size (in.):

Depth of drilled hole (ft.):

Est. % wash-out or hole enlargement:

Size of casing in O.D. (in.):

Casing weight (lbs/ft) and grade:

No. of centralizers used:

Tapered string drilled hole size (in.)

Tapered string depth of drilled hole (ft.)

Upper: Lower:

Upper: Lower:

Tapered string size of casing in O.D. (in.)

Tapered string casing weight(lbs/ft) and grade

Tapered string no. of centralizers used

Upper: Lower:

Upper: Lower:

Upper: Lower:

Was cement circulated to ground surface (or bottom of cellar) outside casing? ☐ YES ☐ NO

Setting depth shoe (ft.):

Hrs. waiting on cement before drill-out:

Calculated top of cement (ft.):

Cementing date:

SLURRY

Slurry No.	No. of Sacks	Class	Additives	Volume (cu. ft.)	Height (ft.)
1					
2					
3					
Total	0			0	0

CASING CEMENTING DATA

Type of casing: ☐ Surface ☐ Intermediate ☐ Production ☐ Tapered production ☐ Multi-stage cement/DV tool ☐ Multiple parallel strings

Drilled hole size (in.):

Depth of drilled hole (ft.):

Est. % wash-out or hole enlargement:

Size of casing in O.D. (in.):

Casing weight (lbs/ft) and grade:

No. of centralizers used:

Tapered string drilled hole size (in.)

Tapered string depth of drilled hole (ft.)

Upper: Lower:

Upper: Lower:

Tapered string size of casing in O.D. (in.)

Tapered string casing weight(lbs/ft) and grade

Tapered string no. of centralizers used

Upper: Lower:

Upper: Lower:

Upper: Lower:

Was cement circulated to ground surface (or bottom of cellar) outside casing? ☐ YES ☐ NO

Setting depth tool (ft.):

Hrs. waiting on cement before drill-out:

Calculated top of cement (ft.):

Cementing date:

SLURRY

Slurry No.	No. of Sacks	Class	Additives	Volume (cu. ft.)	Height (ft.)
1					
2					
3					
Total	0			0	0

CEMENTING TO SQUEEZE, PLUG BACK OR PLUG AND ABANDON							
	PLUG #1	PLUG #2	PLUG #3	PLUG #4	PLUG #5	PLUG #6	PLUG #7
Cementing Date							
Size of hole or pipe (in.)							
Depth to bottom of tubing or drill pipe (ft.)							
Cement retainer setting depth (ft.)							
CIBP setting depth (ft.)							
Amount of cement on top of CIBP (ft.)							
Sacks of cement used							
Slurry volume pumped (cu. ft.)							
Calculated top of plug (ft.)							
Measured top of plug, if tagged (ft.)							
Slurry weight (lbs/gal)							
Class/type of cement							
Perforate and squeeze (YES/NO)							

REMARKS

SOH 905284371
 LEAD ADDITIVES: 31 BM RCL SEAL / 3796LBM POLY-E-FLAKE / 259LBM D-MS 5000
 TAIL ADDITIVES: 31BM RCL SEAL / 3550LBM POLY-E-FLAKE / 20% 140-400
 214 BBS / 483 SSS RETURNED TO SURFACE

CEMENTER'S CERTIFICATE: I declare under penalties prescribed in Sec. 91.143, Texas Natural Resources Code, that I am authorized to make this certification, that the cementing of casing and/or the placing of cement plugs in this well as shown in the report was performed by me or under my supervision, and that the cementing data and facts presented on both sides of this form are true, correct, and complete, to the best of my knowledge. This certification covers cementing data only.

JAMES ELLIOTT

Halliburton

Name and title of cementer's representative

Cementing Company

Signature

6155 W. Murphy St.

Odessa, TX, 79763

432-571-8600

11/24/18

Address

City, State, Zip Code

Tel: Area Code Number

Date: mo. day yr.

OPERATOR'S CERTIFICATE: I declare under penalties prescribed in Sec. 91.143, Texas Natural Resources Code, that I am authorized to make this certification, that I have knowledge of the well data and information presented in this report, and that data and facts presented on both sides of this form are true, correct, and complete, to the best of my knowledge. This certification covers all well data.

Levi S. Smalley
Typed or printed name of operator's representative

Drill Site Supervisor
Title

Levi S. Smalley
Signature

1530 16th St #500 Denver, CO 80202

720-974-2054

11/24/18

Address

City, State, Zip Code

Tel: Area Code Number

Date: mo. day yr.

Instructions for Form W-15, Cementing Report

NOTICE: The Form W-15 must be submitted as an attachment to a Form G-1 (Gas Well Back Pressure Test, Completion or Recompletion Report, and Log), Form W-2 (Oil Well Potential Test, Completion or Recompletion Report, and Log), Form W-3 (Plugging Record), or Form W-4 (Application for Multiple Completion), any time cement is pumped in a wellbore.

- A. What to file:** An operator should file an original and one copy of the completed Form W-15 for each cementing company used on a well. The cementing of different casing strings on a well by one cementing company may be reported on one form.
The Form W-15 should be filed with the Form W-3, Plugging Record, unless the Form W-3 is signed by the cementing company representative. When reporting dry holes, operators must complete Form W-15, in addition to Form W-3, to show any casing cemented in the hole.
- B. How to file:** An oil and gas completion report and Form W-15 may be filed online using the Commission's Online System (<https://webapps.rrc.state.tx.us/security/login.do>) or a paper copy of the form may be mailed to the Commission in Austin (P.O. Box 12967, Austin, Texas 78711-2967).
- C. Surface casing:** An operator must set and cement sufficient surface casing to protect all usable-quality water strata, as defined by the Groundwater Advisory Unit in Austin. Sufficient cement shall be used to fill the annular space outside the casing from the shoe to the ground surface or to the bottom of the cellar. Before drilling a well, an operator must obtain a letter from the Groundwater Advisory Unit stating the protection depth. Surface casing should not be set deeper than 200 feet below the specified depth without prior approval from the Commission.
To plug and abandon a well, operators must use only cementers approved by the Commission's Director of Field Operations in accordance with SWR 14 ([http://info.sos.state.tx.us/pls/pub/readtac\\$ext.TacPage?sl=R&app=9&p_dir=&p_rloc=&p_tloc=&p_ploc=&pg=1&p_tac=&ti=16&pt=1&ch=3&ri=14](http://info.sos.state.tx.us/pls/pub/readtac$ext.TacPage?sl=R&app=9&p_dir=&p_rloc=&p_tloc=&p_ploc=&pg=1&p_tac=&ti=16&pt=1&ch=3&ri=14)). Cementing companies, service companies, or operators can qualify as approved cementers by demonstrating that they are able to mix and pump cement in compliance with Commission rules and regulations.
- D. Estimated % wash-out:** If the estimated % wash-out is less than 20% (or 30% along the Gulf Coast), provide supporting documentation such as a caliper log to show how the estimated % wash-out was obtained.
- E. Multi-stage cement:** An operator must report the multi-stage cement shoe in II. Casing Cementing Data section by selecting the type of casing and Multi-stage cement shoe. The operator must report the multi-stage cement tool in III. Casing Cementing Data section by selecting the type of casing and Multi-stage cement/DV tool.
- F. Multiple parallel strings:** An operator should file the Form W-15 as an attachment to the Form W-4, Application for Multiple Completion. An operator may be required to submit multiple Form W-15s to show all data for multiple parallel strings.
- G. Slurry data:** If cement job exceeds three slurries, continue the list of slurries in the Slurry table in the subsequent Casing Cementing Data box.



RAILROAD COMMISSION OF TEXAS

1701 N. Congress
P.O. Box 12967
Austin, Texas 78701-2967

Form W-15

Rev. 08/2014

CEMENTING REPORT

Cementer: Fill in shaded areas.
Operator: Fill in other items.

OPERATOR INFORMATION

Operator Name: FELIX ENERGY HOLDINGS II LLC-EBUS
Cementer Name: HALLIBURTON ENERGY SERVICES

Operator P-5 No.: 265322
Cementer P-5 No.: 347151

WELL INFORMATION

District No.: 08 County: WARD
Well No.: 2H API No.: 42-475-37718 Drilling Permit No.: 84619 2
Lease Name: UL INDEPENDENCE 1718-17 B Lease No.:
Field Name: Phantom Wolfcamp Field No.: 71052900

I. CASING CEMENTING DATA

Type of casing: ☐ Conductor ☐ Surface ☒ Intermediate ☐ Liner ☐ Production
Drilled hole size (in.): 9 7/8 Depth of drilled hole (ft.): 10910 Est. % wash-out or hole enlargement: 20
Size of casing in O.D. (in.): 7 5/8 Casing weight (lbs/ft) and grade: 29.7 # HCL-80 No. of centralizers used: 30
Was cement circulated to ground surface (or bottom of cellar) outside casing? ☒ YES ☐ NO If no for surface casing, explain in Remarks. Setting depth shoe (ft.): 10893 Top of liner (ft.):
Setting depth liner (ft.):
Hrs. waiting on cement before drill-out: Calculated top of cement (ft.): 0 Cementing date: 12-2-2018

SLURRY

Slurry No.	No. of Sacks	Class	Additives	Volume (cu. ft.)	Height (ft.)
1					
2					
3					
Total	0			0	0

II. CASING CEMENTING DATA

Type of casing: ☐ Surface ☒ Intermediate ☐ Production ☐ Tapered production ☒ Multi-stage cement shoe ☐ Multiple parallel strings
Drilled hole size (in.): 9 7/8 - 8 3/4 Depth of drilled hole (ft.): 10910 Est. % wash-out or hole enlargement: 20
Size of casing in O.D. (in.): 7 5/8 Casing weight (lbs/ft) and grade: 29.7 HCL-80 No. of centralizers used: 30
Tapered string drilled hole size (in.) Tapered string depth of drilled hole (ft.)
Upper: 9 7/8 Lower: 8 3/4 Upper: 8827 Lower: 10910
Tapered string size of casing in O.D. (in.) Tapered string casing weight (lbs/ft) and grade Tapered string no. of centralizers used
Upper: Lower: Upper: Lower: Upper: Lower:
Was cement circulated to ground surface (or bottom of cellar) outside casing? ☐ YES ☒ NO Setting depth shoe (ft.): 10893
Hrs. waiting on cement before drill-out: NA Calculated top of cement (ft.): 5223 Cementing date: 12/1/2018

SLURRY

Slurry No.	No. of Sacks	Class	Additives	Volume (cu. ft.)	Height (ft.)
1	635	NEOCHEM IL	SEE REMARKS	1354	5002
2	75	HALCEM H	.6% HALAD-9, 1% HR-601	90	670
3					
Total	710			1444	5672

III. CASING CEMENTING DATA

Type of casing: ☐ Surface ☒ Intermediate ☐ Production ☐ Tapered production ☒ Multi-stage cement/DV tool ☐ Multiple parallel strings
Drilled hole size (in.): 9 7/8 - 8 3/4 Depth of drilled hole (ft.): 10910 Est. % wash-out or hole enlargement: 20
Size of casing in O.D. (in.): 7 5/8 Casing weight (lbs/ft) and grade: 29.7 HCL-80 No. of centralizers used: 30
Tapered string drilled hole size (in.) Tapered string depth of drilled hole (ft.)
Upper: 9 7/8 Lower: 8 3/4 Upper: 8827 Lower: 10910
Tapered string size of casing in O.D. (in.) Tapered string casing weight (lbs/ft) and grade Tapered string no. of centralizers used
Upper: Lower: Upper: Lower: Upper: Lower:
Was cement circulated to ground surface (or bottom of cellar) outside casing? ☐ YES ☒ NO Setting depth tool (ft.): 5223
Hrs. waiting on cement before drill-out: NA Calculated top of cement (ft.): 699 Cementing date: 12/2/2018

SLURRY

Slurry No.	No. of Sacks	Class	Additives	Volume (cu. ft.)	Height (ft.)
1	425	ECONOCHEM C	.25 LB D-AIR	1046	4697
2	90	HALCEM C	HR-800	120	528
3					
Total	515			1166	5225

CEMENTING TO SQUEEZE, PLUG BACK OR PLUG AND ABANDON							
	PLUG #1	PLUG #2	PLUG #3	PLUG #4	PLUG #5	PLUG #6	PLUG #7
Cementing Date							
Size of hole or pipe (in.)							
Depth to bottom of tubing or drill pipe (ft.)							
Cement retainer setting depth (ft.)							
CIBP setting depth (ft.)							
Amount of cement on top of CIBP (ft.)							
Sacks of cement used							
Slurry volume pumped (cu. ft.)							
Calculated top of plug (ft.)							
Measured top of plug, if tagged (ft.)							
Slurry weight (lbs/gal)							
Class/type of cement							
Perforate and squeeze (YES/NO)							

REMARKS
SO # 905291043 10 BBL = 22 SKS LEAD CEMENT TO SURFACE 1ST STAGE LEAD ADDITIVES = 3 LB KOL-SEAL .125 LB POLY-E-FLAKE

CEMENTER'S CERTIFICATE: I declare under penalties prescribed in Sec. 91.143, Texas Natural Resources Code, that I am authorized to make this certification, that the cementing of casing and/or the placing of cement plugs in this well as shown in the report was performed by me or under my supervision, and that the cementing data and facts presented on both sides of this form are true, correct, and complete, to the best of my knowledge. This certification covers cementing data only.

JAMES HEIDT / SERVICE SUPERVISOR

Halliburton

Name and title of cementer's representative

Cementing Company

Signature

1301 W. Webb St.

Brownfield, Tx, 79316

575-392-0700

12/2/2018

Address

City, State, Zip Code

Tel: Area Code

Number

Date: mo. day yr.

OPERATOR'S CERTIFICATE: I declare under penalties prescribed in Sec. 91.143, Texas Natural Resources Code, that I am authorized to make this certification, that I have knowledge of the well data and information presented in this report, and that data and facts presented on both sides of this form are true, correct, and complete, to the best of my knowledge. This certification covers all well data.

Typed or printed name of operator's representative

Title

Signature

1530 16th St #500 Denver, CO 80202

DSM

720-974-2054

12/2/2018

Address

City, State, Zip Code

Tel: Area Code

Number

Date: mo. day yr.

Instructions for Form W-15, Cementing Report

NOTICE: The Form W-15 must be submitted as an attachment to a Form G-1 (Gas Well Back Pressure Test, Completion or Recompletion Report, and Log), Form W-2 (Oil Well Potential Test, Completion or Recompletion Report, and Log), Form W-3 (Plugging Record), or Form W-4 (Application for Multiple Completion), any time cement is pumped in a wellbore.

- What to file:** An operator should file an original and one copy of the completed Form W-15 for each cementing company used on a well. The cementing of different casing strings on a well by one cementing company may be reported on one form.
The Form W-15 should be filed with the Form W-3, Plugging Record, unless the Form W-3 is signed by the cementing company representative. When reporting dry holes, operators must complete Form W-15, in addition to Form W-3, to show any casing cemented in the hole.
- How to file:** An oil and gas completion report and Form W-15 may be filed online using the Commission's Online System (<https://webapps.rrc.state.tx.us/security/login.do>) or a paper copy of the form may be mailed to the Commission in Austin (P.O. Box 12967, Austin, Texas 78711-2967).
- Surface casing:** An operator must set and cement sufficient surface casing to protect all usable-quality water strata, as defined by the Groundwater Advisory Unit in Austin. Sufficient cement shall be used to fill the annular space outside the casing from the shoe to the ground surface or to the bottom of the cellar. Before drilling a well, an operator must obtain a letter from the Groundwater Advisory Unit stating the protection depth. Surface casing should not be set deeper than 200 feet below the specified depth without prior approval from the Commission.
To plug and abandon a well, operators must use only cementers approved by the Commission's Director of Field Operations in accordance with SWR 14 ([http://info.sos.state.tx.us/pls/pub/readtac\\$ext.TacPage?sl=R&app=9&p_dir=&p_rloc=&poloc=&p_loc=&pg=1&p_tac=&ti=16&pt=1&ch=3&ri=14](http://info.sos.state.tx.us/pls/pub/readtac$ext.TacPage?sl=R&app=9&p_dir=&p_rloc=&poloc=&p_loc=&pg=1&p_tac=&ti=16&pt=1&ch=3&ri=14)). Cementing companies, service companies, or operators can qualify as approved cementers by demonstrating that they are able to mix and pump cement in compliance with Commission rules and regulations.
- Estimated % wash-out:** If the estimated % wash-out is less than 20% (or 30% along the Gulf Coast), provide supporting documentation such as a caliper log to show how the estimated % wash-out was obtained.
- Multi-stage cement:** An operator must report the multi-stage cement shoe in II. Casing Cementing Data section by selecting the type of casing and Multi-stage cement shoe. The operator must report the multi-stage cement tool in III. Casing Cementing Data section by selecting the type of casing and Multi-stage cement/DV tool.
- Multiple parallel strings:** An operator should file the Form W-15 as an attachment to the Form W-4, Application for Multiple Completion. An operator may be required to submit multiple Form W-15s to show all data for multiple parallel strings.
- Slurry data:** If cement job exceeds three slurries, continue the list of slurries in the Slurry table in the subsequent Casing Cementing Data box.



RAILROAD COMMISSION OF TEXAS

1701 N. Congress
P.O. Box 12967
Austin, Texas 78701-2967

Form W-15

Rev. 08/2014

CEMENTING REPORT

Cementer: Fill in shaded areas.
Operator: Fill in other items.

OPERATOR INFORMATION

Operator Name: FELIX ENERGY
Cementer Name: HALLIBURTON

Operator P-5 No.: 265322
Cementer P-5 No.: 347151

WELL INFORMATION

District No.: 08
Well No.: 2H
Lease Name: UL INDEPENDENCE 0718-17B
Field Name: Phantom Wolcamp

County: WARD
API No.: 42-475-37718
Lease No.:
Drilling Permit No.: 846192
Field No.: 71052900

I. CASING CEMENTING DATA

Type of casing: ☐ Conductor ☐ Surface ☐ Intermediate ☐ Liner ☒ Production

Drilled hole size (in.): 6.75 Depth of drilled hole (ft.): 22402 Est. % wash-out or hole enlargement: 20

Size of casing in O.D. (in.): 5.5 Casing weight (lbs/ft) and grade: 23# 2110 No. of centralizers used: 0

Was cement circulated to ground surface (or bottom of cellar) outside casing? ☐ YES ☒ NO If no for surface casing, explain in Remarks. Setting depth shoe (ft.): 22393 Top of liner (ft.):
Setting depth liner (ft.):

Hrs. waiting on cement before drill-out: N/A Calculated top of cement (ft.): 3810 Cementing date: 1-23-2018

SLURRY

Slurry No.	No. of Sacks	Class	Additives	Volume (cu. ft.)	Height (ft.)
1	1520	H		1863.5	21140
2					
3					
Total	1520			1863.5	21140

II. CASING CEMENTING DATA

Type of casing: ☐ Surface ☐ Intermediate ☐ Production ☐ Tapered production ☐ Multi-stage cement shoe ☐ Multiple parallel strings

Drilled hole size (in.): Depth of drilled hole (ft.): Est. % wash-out or hole enlargement:

Size of casing in O.D. (in.): Casing weight (lbs/ft) and grade: No. of centralizers used:

Tapered string drilled hole size (in.) Tapered string depth of drilled hole (ft.)

Upper: Lower: Upper: Lower:

Tapered string size of casing in O.D. (in.) Tapered string casing weight (lbs/ft) and grade Tapered string no. of centralizers used

Upper: Lower: Upper: Lower: Upper: Lower:

Was cement circulated to ground surface (or bottom of cellar) outside casing? ☐ YES ☐ NO Setting depth shoe (ft.):

Hrs. waiting on cement before drill-out: Calculated top of cement (ft.): Cementing date:

SLURRY

Slurry No.	No. of Sacks	Class	Additives	Volume (cu. ft.)	Height (ft.)
1					
2					
3					
Total	0			0	0

III. CASING CEMENTING DATA

Type of casing: ☐ Surface ☐ Intermediate ☐ Production ☐ Tapered production ☐ Multi-stage cement/DV tool ☐ Multiple parallel strings

Drilled hole size (in.): Depth of drilled hole (ft.): Est. % wash-out or hole enlargement:

Size of casing in O.D. (in.): Casing weight (lbs/ft) and grade: No. of centralizers used:

Tapered string drilled hole size (in.) Tapered string depth of drilled hole (ft.)

Upper: Lower: Upper: Lower:

Tapered string size of casing in O.D. (in.) Tapered string casing weight (lbs/ft) and grade Tapered string no. of centralizers used

Upper: Lower: Upper: Lower: Upper: Lower:

Was cement circulated to ground surface (or bottom of cellar) outside casing? ☐ YES ☐ NO Setting depth tool (ft.):

Hrs. waiting on cement before drill-out: Calculated top of cement (ft.): Cementing date:

SLURRY

Slurry No.	No. of Sacks	Class	Additives	Volume (cu. ft.)	Height (ft.)
1					
2					
3					
Total	0			0	0

CEMENTING TO SQUEEZE, PLUG BACK OR PLUG AND ABANDON							
	PLUG #1	PLUG #2	PLUG #3	PLUG #4	PLUG #5	PLUG #6	PLUG #7
Cementing Date							
Size of hole or pipe (in.)							
Depth to bottom of tubing or drill pipe (ft.)							
Cement retainer setting depth (ft.)							
CIBP setting depth (ft.)							
Amount of cement on top of CIBP (ft.)							
Sacks of cement used							
Slurry volume pumped (cu. ft.)							
Calculated top of plug (ft.)							
Measured top of plug, if tagged (ft.)							
Slurry weight (lbs/gal)							
Class/type of cement							
Perforate and squeeze (YES/NO)							

REMARKS

CEMENTER'S CERTIFICATE: I declare under penalties prescribed in Sec. 91.143, Texas Natural Resources Code, that I am authorized to make this certification, that the cementing of casing and/or the placing of cement plugs in this well as shown in the report was performed by me or under my supervision, and that the cementing data and facts presented on both sides of this form are true, correct, and complete, to the best of my knowledge. This certification covers cementing data only.

STEVEN GRISHAM

Halliburton

Name and title of cementer's representative

Cementing Company

6155 W. Murphy St.

Odessa, TX, 79763

432-571-8600

1-23-2019

Address

City, State, Zip Code

Tel: Area Code Number

Date: mo. day yr.

OPERATOR'S CERTIFICATE: I declare under penalties prescribed in Sec. 91.143, Texas Natural Resources Code, that I am authorized to make this certification, that I have knowledge of the well data and information presented in this report, and that data and facts presented on both sides of this form are true, correct, and complete, to the best of my knowledge. This certification covers all well data.

Levi S. Smalley
Typed or printed name of operator's representative

DSM
Title

Levi S. Smalley
Signature

1530 16th St #500 Denver CO 80202

720-974-2054

1/23/2019

Address

City, State, Zip Code

Tel: Area Code Number

Date: mo. day yr.

Instructions for Form W-15, Cementing Report

NOTICE: The Form W-15 must be submitted as an attachment to a Form G-1 (Gas Well Back Pressure Test, Completion or Recompletion Report, and Log), Form W-2 (Oil Well Potential Test, Completion or Recompletion Report, and Log), Form W-3 (Plugging Record), or Form W-4 (Application for Multiple Completion), any time cement is pumped in a wellbore.

- What to file:** An operator should file an original and one copy of the completed Form W-15 for each cementing company used on a well. The cementing of different casing strings on a well by one cementing company may be reported on one form.
The Form W-15 should be filed with the Form W-3, Plugging Record, unless the Form W-3 is signed by the cementing company representative. When reporting dry holes, operators must complete Form W-15, in addition to Form W-3, to show any casing cemented in the hole.
- How to file:** An oil and gas completion report and Form W-15 may be filed online using the Commission's Online System (<https://webapps.rrc.state.tx.us/security/login.do>), or a paper copy of the form may be mailed to the Commission in Austin (P.O. Box 12967, Austin, Texas 78711-2967).
- Surface casing:** An operator must set and cement sufficient surface casing to protect all usable-quality water strata, as defined by the Groundwater Advisory Unit in Austin. Sufficient cement shall be used to fill the annular space outside the casing from the shoe to the ground surface or to the bottom of the cellar. Before drilling a well, an operator must obtain a letter from the Groundwater Advisory Unit stating the protection depth. Surface casing should not be set deeper than 200 feet below the specified depth without prior approval from the Commission.
To plug and abandon a well, operators must use only cementers approved by the Commission's Director of Field Operations in accordance with SWR 14 ([http://info.sos.state.tx.us/pls/pub/readtac\\$ext.TacPage?sl=R&app=9&p_dir=&p_floc=&p_tloc=&p_ploc=&pg=1&p_tac=&ti=16&pt=1&ch=3&rl=14](http://info.sos.state.tx.us/pls/pub/readtac$ext.TacPage?sl=R&app=9&p_dir=&p_floc=&p_tloc=&p_ploc=&pg=1&p_tac=&ti=16&pt=1&ch=3&rl=14)). Cementing companies, service companies, or operators can qualify as approved cementers by demonstrating that they are able to mix and pump cement in compliance with Commission rules and regulations.
- Estimated % wash-out:** If the estimated % wash-out is less than 20% (or 30% along the Gulf Coast), provide supporting documentation such as a caliper log to show how the estimated % wash-out was obtained.
- Multi-stage cement:** An operator must report the multi-stage cement shoe in II. Casing Cementing Data section by selecting the type of casing and Multi-stage cement shoe. The operator must report the multi-stage cement tool in III. Casing Cementing Data section by selecting the type of casing and Multi-stage cement/DV tool.
- Multiple parallel strings:** An operator should file the Form W-15 as an attachment to the Form W-4, Application for Multiple Completion. An operator may be required to submit multiple Form W-15s to show all data for multiple parallel strings.
- Slurry data:** If cement job exceeds three slurries, continue the list of slurries in the Slurry table in the subsequent Casing Cementing Data box.

CHRISTI CRADDICK, CHAIRMAN
RYAN SITTON, COMMISSIONER
WAYNE CHRISTIAN, COMMISSIONER



DANNY SORRELLS
DIRECTOR, OIL AND GAS DIVISION

JEFFREY MORGAN
DISTRICT DIRECTOR

RAILROAD COMMISSION OF TEXAS

OIL AND GAS DIVISION

OPERATOR Name: FELIX ENERGY HOLDINGS II, LLC

RE: Lease: UL INDEPENDENCE 1718-17 B

Address1: FELIX ENERGY

Address2: 1530 16TH ST SUITE 500

City: DENVER

State: CO

Well No: 2H

Sec: 16 **Block:** 17

County: WARD

Survey Name: UL

SWR13EX Application Number: 62601

Drilling Permit No: 846192

SWR 13 CASING EXCEPTION APPLICATION/ALTERNATIVE REQUEST APPROVED

An extension to omit the installation of tubing in the above-referenced well is approved for a period of up to 180 days from the date the application was received or the date the well began producing, whichever occurred last.

RRC APPROVAL BY: Kolby Durham

DATE: 06/17/2019

JEFFREY MORGAN
DISTRICT DIRECTOR

Tracking No.: 216186

This facsimile L-1 was generated electronically from data submitted to the RRC.

Instructions

When to File Form L-1:

- with Forms G-1, W-2, and GT-1 for new and deepened gas, oil, and geothermal wells
- with Form W-3 for plugged dry holes
- when sending in a log which was held under a request for confidentiality and the period for confidentiality has not yet expired.

When is Form L-1 NOT required:

- with Forms W-2, G-1, and GT-1 filed for injection wells, disposal wells, water supply wells, service wells, re-test wells, re-classifications, and plugbacks of oil, gas or geothermal wells
- with Form W-3 for plugging of other than a dry hole

Where to File Form L-1:

- with the appropriate Commission district office

Filling out Form L-1:

- Section I and the signature section must be filled out for all wells
- complete only the appropriate part of Section II

Type of log required:

- any wireline survey run for the purpose of obtaining lithology, porosity, or resistivity information
- no more than one such log is required but it must be of the subject well
- if such log is NOT run on the subject well, do NOT substitute any other type of log; just select Section II, Part A below

SECTION I. IDENTIFICATION

Operator Name: FELIX ENERGY HOLDINGS II, LLC	District No. 08	Completion Date: 04/27/2019
Field Name PHANTOM (WOLFCAMP)	Drilling Permit No. 846192	
Lease Name UL INDEPENDENCE 1718-17 B	Lease/ID No. 52396	Well No. 2H
County WARD	API No. 42- 475-37718	

SECTION II. LOG STATUS (Complete either A or B)

☐ A. BASIC ELECTRIC LOG NOT RUN☒ B. BASIC ELECTRIC LOG RUN. (Select one)

- ☒ 1. Confidentiality is requested and a copy of the header for each log that has been run on the well is attached.
- ☐ 2. Confidentiality already granted on basic electric log covering this interval (applicable to deepened wells only).
- ☐ 3. Basic electric log covering this interval already on file with Commission (applicable to deepened wells only).
- ☐ 4. Log attached to (select one):

☐ (a) Form L-1 (this form). If the company/lease name on log is different from that shown in Section I, please enter name on log here: _____

Check here if attached log is being submitted after being held confidential. ☐

☐ (b) Form P-7, Application for Discovery Allowable and New Field Designation.

☐ (c) Form W-4, Application for Multiple Completion:

Lease or ID No(s). _____

Well No(s). _____

Heather Dahlgren

Signature

FELIX ENERGY HOLDINGS II, LLC

Name (print)

Felix Admin Services

Title

(720) 974-2069

Phone

06/19/2019

Date

-FOR RAILROAD COMMISSION USE ONLY-

SlimPulse Gamma Ray
1in/100ft Measured Depth
Recorded Mode, Composite Log

Schlumberger

Company: FELIX ENERGY HOLDINGS II, LLC

Well: UL INDEPENDENCE 1718-17 B 2H
Field: PHANTOM (WOLFCAMP)
County: Ward
State: Texas
Country: United States of America

Latitude:	31° 34' 57.988" N	APIN:	42-475-37718
Longitude:	103° 10' 4.262" W	Rig Name:	ICD321
		Rig Type:	Land - Top Drive

FL: E 1117433.650 ftUS
FL1: N 708118.340 ftUS
FL2: NAD27 Texas State Plane, Central Zone, US Feet

Log Measured From: - Drill Floor: 2689.00 ft
Ground Level: 2664.00 ft

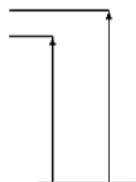

Permanent Datum: - Mean Sea Level

Acquisition Dates:	06-Jan-2019 -- 21-Jan-2019	Other Services:
Log Interval:	50.00(ft)(ft) -- 22402.00(ft)	Directional Drilling
Index Types:	Measured Depth	Direction and Inclination (Surveys)
Index Scales:	1:1200 1" / 100'	
Depth Source:	Driller's Depth	
Depth Sensor:	PASON	
Print Type:	Final	
Spud Date:	17-NOV-2018	



Disclaimer

THE USE OF AND RELIANCE UPON THIS RECORDED-DATA BY THE HEREIN NAMED COMPANY (AND ANY OF ITS AFFILIATES, PARTNERS, REPRESENTATIVES, AGENTS, CONSULTANTS AND EMPLOYEES) IS SUBJECT TO THE TERMS AND CONDITIONS AGREED UPON BETWEEN SCHLUMBERGER AND THE COMPANY, INCLUDING: (a) RESTRICTIONS ON USE OF THE RECORDED-DATA; (b) DISCLAIMERS AND WAIVERS OF WARRANTIES AND REPRESENTATIONS REGARDING COMPANY'S USE AND RELIANCE UPON THE RECORDED-DATA; AND (c) CUSTOMER'S FULL AND SOLE RESPONSIBILITY FOR ANY INFERENCE DRAWN OR DECISION MADE IN CONNECTION WITH THE USE OF THIS RECORDED-DATA.

Contents

1. Field name exactly as shown on proration schedule PHANTOM (WOLFCAMP)			2. Lease name as shown on proration schedule UL INDEPENDENCE 1718-17 B			
3. Current operator name exactly as shown on P-5 Organization Report FELIX ENERGY HOLDINGS II, LLC			4. Operator P-5 no. 265322	5. Oil Lse/Gas ID no 52396	6. County WARD	7. RRC district 08
8. Operator address including city, state, and zip code FELIX ENERGY 1530 16TH ST SUITE 500 DENVER, CO 80202			9. Well no(s) <i>(see instruction E)</i> 2H			
10. Classification <input checked="" type="checkbox"/> Oil <input type="checkbox"/> Gas <input type="checkbox"/> Other <i>(see instruction A)</i>					11. Effective Date 04/27/2019	
12. Purpose of Filing. (Complete section a or b below.) <i>(See instructions B and G)</i> a. Change of: <input type="checkbox"/> operator <input type="checkbox"/> oil or condensate gatherer <input type="checkbox"/> gas gatherer <input type="checkbox"/> gas purchaser <input type="checkbox"/> gas purchaser system code <input type="checkbox"/> field name from _____ <input type="checkbox"/> lease name from _____ <hr style="border-top: 1px dashed black;"/> OR b. New RRC Number for: <input checked="" type="checkbox"/> oil lease <input type="checkbox"/> gas well Due to: <input checked="" type="checkbox"/> new completion or recompletion <input type="checkbox"/> reclass oil to gas <input type="checkbox"/> reclass gas to oil <input type="checkbox"/> other well (specify) _____ <input type="checkbox"/> consolidation, unitization, or subdivision (oil lease only)						
13. Authorized GAS WELL GAS or CASINGHEAD GAS Gatherer(s) and/or Purchaser(s). <i>(See instruction G).</i>						
Gatherer	Purchaser	Name of GAS WELL GAS or CASINGHEAD GAS Gatherer(s) or Purchaser(s) As Indicated in Columns to the Left <i>(Attach an additional sheet in same format if more space is needed)</i>	Purchaser's RRC Assigned System Code	Percent of Take	Full-well stream	
X	X	TARGA DELAWARE LLC(836022)	0001	100.0		
14. Authorized OIL or CONDENSATE Gatherer(s). <i>(See instruction G).</i>						
Name of OIL or CONDENSATE Gatherer(s) - List Highest Volume Gatherer First <i>(Attach an additional sheet in same format if more space is needed)</i>					Percent of Take	
FELIX MIDSTREAM, LLC(265324)					100.0	
RRC USE ONLY: Reviewer's initials: <u>RRC Staff</u> Approval date: <u>11/04/2019</u>						
15. PREVIOUS OPERATOR CERTIFICATION FOR CHANGE OF OPERATOR P-4 FILING. Being the PREVIOUS OPERATOR, I certify that operating responsibility for the well(s) designated in this filing, located on the subject lease has been transferred in its entirety to the above named Current Operator. I understand, as Previous Operator, that designation of the above named operator as Current Operator is not effective until this certificate is approved by the Commission.						
Name of Previous Operator _____ Name (print) _____ Title _____			Signature _____ <input type="checkbox"/> Authorized Employee of previous operator <input type="checkbox"/> Authorized agent of previous operator <i>(see instruction G)</i> Date _____ Phone with area code _____			
16. CURRENT OPERATOR CERTIFICATION. By signing this certificate as the Current Operator, I certify that all statements on this form are true and correct and I acknowledge responsibility for the regulatory compliance of the subject lease including plugging of well(s) pursuant to Rule 14. I further acknowledge that I assume responsibility for the physical operation, control, and proper plugging of each well designated in this filing. I also acknowledge that I will remain designated as the Current Operator until a new certificate designating a new Current Operator is approved by the Commission.						
FELIX ENERGY HOLDINGS II, LLC Name (print) <u>Felix Admin Services</u> Title <u>heatherd@felix-energy.com</u> E-mail Address (optional)			Heather Dahlgren Signature <input checked="" type="checkbox"/> Authorized Employee of current operator <input type="checkbox"/> Authorized agent of current operator <i>(see instruction G)</i> <u>06/19/2019</u> <u>(720) 974-2069</u> Date Phone with area code			

Form P-16

Page 1

Rev. 02/2019

Acreage Designation

SECTION I. OPERATOR INFORMATION

Operator Name:	Felix Energy Holdings II, LLC	Operator P-5 No.:	265322
Operator Address:	1530 16th Street, Suite 500, Denver, CO 80202		

SECTION II. WELL INFORMATION

District No.:	08	API No.:	42-475-37718	Purpose of Filing: <input type="checkbox"/> Drilling Permit Application (Form W-1) <input checked="" type="checkbox"/> Completion Report (Form G-1/W-2)
Well No.:	2H	Drilling Permit No.:	846192	
Lease Name:	UL Independence 1718-17 B	RRC ID or Lease No.:		
Total Lease Acres:	640.64	Field Name:	Phantom (Wolfcamp)	
Proration Acres:	128.13	Field No.:	71052900	
Wellbore Profile	Allocation Well	Is this a UFT field?	Yes	
SL Record (Parent) Well Drilling Permit No.:		County:	Ward	

SECTION III. LISTING OF ALL WELLS IN THE APPLIED-FOR FIELD ON THE SAME ACREAGE AS THE LEASE, POOLED UNIT, OR UNITIZED TRACT DESIGNATED IN SECTION II ABOVE BY FILER

[illegible]

Total Remaining Vert./Dir. Acreage =

SECTION IV. REMARKS - REQUIRED FOR PSA AND CO-DEVELOPMENT (refer to instructions)

This is an allocation well. The unit size and boundary has been adjusted from the original since the FTP fell outside the original boundary.

☒ **Additional Pages:** 1 (No. of additional pages)

Cynthia Hill
Signature

Email
(include email address only if you affirmatively consent to its public release)

Date: 06/19/19
mo. day yr.

Form P-16

Page 2
Rev. 02/2019

Filer is the owner or lessee of all or an undivided portion of the minerals under each tract listed below and has the legal right to drill on each tract traversed by the well that will have perforations or other take points open in the interval of the applied-for field(s). All tracts listed will actually be traversed by the wellbore or the filer has pooling authority or other contractual authority, such as a production sharing agreement, authorizing inclusion of the non-drill site tract in the acreage assigned to the well.

RRC ID No., Lease No. or Tract ID		Lease Name	Beginning Lease Acres	Allocated Lease Acres	Ending Lease Acres	Operator Name and Operator No. (if different from filing operator)
A	Tract 1	UL Lease No. 111457	40.05	8.01	32.04	
B	Tract 2	UL Lease No. 111458	320.08	64.02	256.06	
C	Tract 3	UL Lease No. 105885	280.51	56.10	224.41	
D						
E						
F						
G						
H						
Total Acreage =			640.64	128.13	512.51	

Total Acreage	=	640.64	128.13	512.51
----------------------	----------	---------------	---------------	---------------

[illegible]

A. Total Assigned Acreage	=	40.05	320.09	280.50	0.00	0.00	0.00	0.00
B. Total Assigned Horiz. Acreage	=	40.05	320.09	280.50	0.00	0.00	0.00	0.00
C. Total Assigned Vert./Dir. Acreage	=	0.00	0.00	0.00	0.00	0.00	0.00	0.00

* A revised P-16 is required if updating the proration acreage on an existing Allocation or PSA well utilizing acreage from a regulatory lease or undeveloped tract not listed in Section V.
(refer to instructions)

GROUNDWATER PROTECTION DETERMINATION

Form GW-2



Groundwater Advisory Unit

Date Issued: 30 October 2018**GAU Number:** 217922**Attention:** FELIX ENERGY HOLDINGS II,
FELIX ENERGY
DENVER, CO 80202**Operator No.:** 265322**API Number:**
County: WARD
Lease Name: UL Independence 1718-17 A
Lease Number:
Well Number: 1H
Total Vertical Depth: 12000
Latitude: 31.582826
Longitude: -103.167870
Datum: NAD27**Purpose:** New Production Well**Location:** Survey-UL; Block-17; Section-16

To protect usable-quality groundwater at this location, the Groundwater Advisory Unit of the Railroad Commission of Texas recommends:

The interval from the land surface to the base of the Santa Rosa, which is estimated to occur at a depth of 800 feet, must be protected.

This recommendation is applicable to all wells within a radius of 1500 feet of this location.

Please send Gamma/Porosity log of this well when it is available.

Note: Unless stated otherwise, this recommendation is intended to apply only to the subject well and not for area-wide use. Unless stated otherwise, this recommendation is for normal drilling, production, and plugging operations only.

This determination is based on information provided when the application was submitted on 10/25/2018. If the location information has changed, you must contact the Groundwater Advisory Unit, and submit a new application if necessary. If you have questions, please contact us at 512-463-2741 or gau@rrc.texas.gov.

Groundwater Advisory Unit, Oil and Gas Division

Form GW-2 P.O. Box 12967 Austin, Texas 78771-2967 512-463-2741 Internet address: www.rrc.texas.gov
Rev. 02/2014



FELIX ENERGY HOLDINGS II, LLC
WARD COUNTY, TEXAS
S.H.L. 613' FSL - 678' FEL, SECTION 16, BLOCK 17

LEGEND

UL	UNIT LINE
SL	SECTION LINE
AS	ASSEMBLED WELL PATH
PS	PROPOSED WELL PATH
10'	10' UNIT OFFSET
S.H.L.	SURFACE HOLE LOCATION
P.O.P.	POINT OF PENETRATION
F.T.P.	FIRST TAKE POINT
L.T.P.	LAST TAKE POINT
B.H.L.	BOTTOM HOLE LOCATION

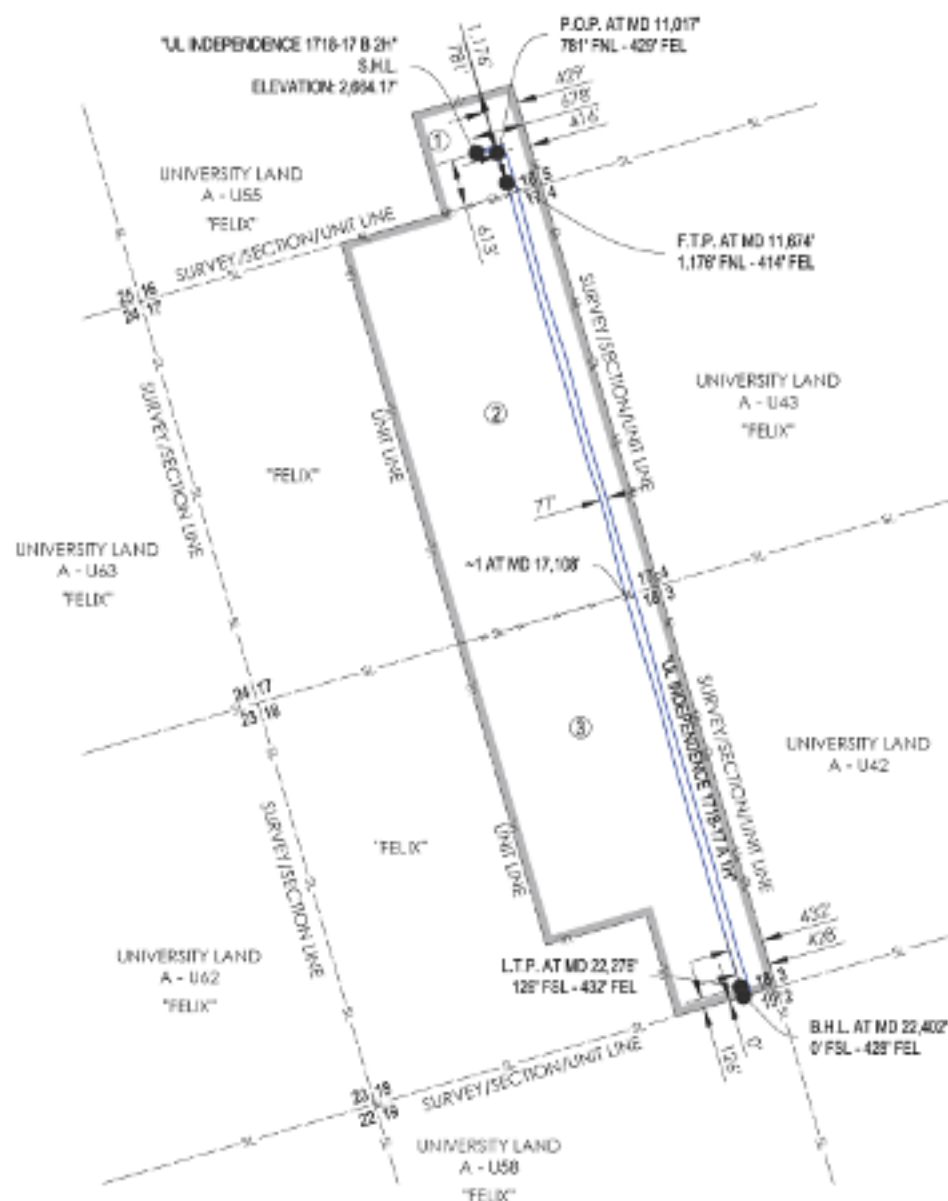

①
SE/4 SE/4 SEC. 16 - BLOCK 17
40.05 ACRES
UNIVERSITY LAND
A - U55
UL LEASE # 111457

②
E/2 SEC. 17 - BLOCK 17
320.08 ACRES
UNIVERSITY LAND
A - U56
UL LEASE # 111458

③
NE/4, N/2 SE/4, SE/4 SE/4
SEC. 18 - BLOCK 17
280.51 ACRES
UNIVERSITY LAND
A - U57
UL LEASE # 105885



OPERATOR: FELIX ENERGY HOLDINGS II, LLC

WELL NAME: UL INDEPENDENCE 1718-17 WELL NO: B 2H

TOPOGRAPHIC & VEGETATION: FLAT LOCATION WITH LOW LYING BRUSH

GOOD DRILL SITE: YES

REFERENCE STAKES OR ALTERNATE LOCATION
STAKES SET: NONE

BEST ACCESSIBILITY TO LOCATION: FROM SOUTH

DISTANCE & DIRECTION

FROM HWY JCT OR TOWN: ±4.14 MILES NORTHWEST OF PYOTE, TX
FROM THE INTERSECTION OF 3RD STREET AND PYOTE STREET, HEAD WEST ON 3RD STREET AND
CONTINUE FOR ±3.1 MILES, TURN RIGHT ONTO EXISTING LEASE ROAD AND FOLLOW FOR ±1.5
MILES, TURN RIGHT ONTO EXISTING LEASE ROAD AND CONTINUE FOR ±1.3 MILES TO
PROPOSED ACCESS EASEMENT AND FOLLOW TO PAD.

SURFACE HOLE LOCATION:

613' FSL & 678' FEL (SEC. 16)
GROUND ELEVATION: 2,664.17'
NAD 27 TEXAS CENTRAL ZONE
NORTHING: 708118.34, EASTING: 1117433.65
LATITUDE: N 31.58277449°, LONGITUDE: W 103.16785070°
NAD 83 TEXAS CENTRAL ZONE
NORTHING: 10550693.98, EASTING: 1413899.45
LATITUDE: N 31.58290657°, LONGITUDE: W 103.16829193°

POINT OF PENETRATION:

781' FNL & 429' FEL (UNIT)
NAD 27 TEXAS CENTRAL ZONE
NORTHING: 708118.17, EASTING: 1117692.71
LATITUDE: N 31.58279217°, LONGITUDE: W 103.16701902°

LAST TAKE POINT:

126' FSL & 432' FEL (SEC. 18)
NAD 27 TEXAS CENTRAL ZONE
NORTHING: 697569.49, EASTING: 1120769.02
LATITUDE: N 31.55401589°, LONGITUDE: W 103.15628369°

BOTTOM HOLE LOCATION:

0' FSL & 428' FEL (SEC. 18)
NAD 27 TEXAS CENTRAL ZONE
NORTHING: 697449.53, EASTING: 1120807.49
LATITUDE: N 31.55368887°, LONGITUDE: W 103.15615037°

UNIT CORNERS

LOCATION	STATE PLANE COORDINATES (1983 TEXAS CENTRAL ZONE)	NAD27 COORDINATES (2011)
NW CORNER SE SE SEC. 16	N = 708018.15 E = 1119810.58	LAT: 31.58409194° LONG: -103.17000624°
NE CORNER OF UNIT	N = 708088.36 E = 1117885.41	LAT: 31.58510782° LONG: -103.16847157°
SE CORNER SEC. 16-BLK. 17	N = 697589.76 E = 1121216.65	LAT: 31.55404807° LONG: -103.15434932°
SW CORNER SE SE SEC. 18	N = 697189.77 E = 1119891.55	LAT: 31.55284070° LONG: -103.15807308°
NW CORNER SE SE SEC. 18	N = 698482.48 E = 1119891.18	LAT: 31.55643544° LONG: -103.15909317°
SW CORNER N/2 SE SEC. 18	N = 698093.14 E = 1119814.63	LAT: 31.55530610° LONG: -103.15843088°
NW CORNER NE SEC. 17	N = 708079.08 E = 1115722.28	LAT: 31.57562347° LONG: -103.17325134°
SW CORNER SE SE SEC. 18	N = 707342.43 E = 1119891.03	LAT: 31.58008117° LONG: -103.15921511°



CONTACT INFORMATION:

Shannon D. Ozmert
Crafton Tull (615) 715-
1000 Ludlow Dr.
Conway, AR 72034

GENERAL NOTES

1. THE LOCATIONS OF UNDERGROUND UTILITIES AS SHOWN HEREON ARE BASED ON REASONABLE VISUAL OBSERVATION. LOCATIONS OF UNDERGROUND UTILITIES STRUCTURES MAY VARY FROM LOCATIONS SHOWN HEREON. ADDITIONAL BURIED UTILITIES STRUCTURES MAY BE ENCOUNTERED. NO EXCAVATIONS WERE MADE DURING THE PROGRESS OF THIS SURVEY TO LOCATE BURIED UTILITIES STRUCTURES. BEFORE EXCAVATIONS ARE BEGUN, THE OFFICES OF THE VARIOUS UTILITIES SERVING THIS AREA SHOULD BE CONTACTED FOR THEIR UTILITY LOCATION.
2. BASIS OF BEARINGS: TEXAS STATE PLANE GRID, CENTRAL ZONE, NAD83 AS DETERMINED BY GPS OBSERVATION.
3. COMBINED SCALE FACTOR AT S.H.L. = 0.99999987
4. VERTICAL DATUM IS NAVD83
5. AREAS, DISTANCES, AND COORDINATES ARE "GROSS" BASED ON U.S. SURVEY FEET.
6. THIS PLAT DOES NOT REPRESENT A BOUNDARY SURVEY.



1000 Ludlow Dr.
Conway, Arkansas 72034

Crafton Tull
surveying

801.328.3311 801.328.3325
www.craftontull.com

REVISION

1 REVISE DIMENSIONS 9-26-19

"UL INDEPENDENCE 1718-17 B 2H"

SE/4 SE/4 SECTION 16, BLOCK 17 - 40.05 ACRES
E/2 SECTION 17, BLOCK 17 - 320.08 ACRES
PART OF E/2 SECTION 18, BLOCK 17 - 280.51 ACRES
FINAL AS-DRILLED PLAT
WARD COUNTY, TEXAS

SCALE: 1" = 2000'

PLOT DATE: 09-26-2019

CHECKED BY:

DRAWN BY:

JWB

L.DOW

APPROVED BY:

SHEET NO.: 1 OF 1

