



BTA OIL PRODUCERS, LLC

104 SOUTH PECOS STREET
MIDLAND, TEXAS 79701-5021
432-682-3753
FAX 432-683-0311

CARLTON BEAL, JR.
BARRY BEAL
SPENCER BEAL
KELLY BEAL
BARRY BEAL, JR.
STUART BEAL
ROBERT DAVENPORT, JR.

GULF COAST DISTRICT
TOTAL PLAZA
1201 LOUISIANA STREET, STE. 570
HOUSTON, TEXAS 77002
713-658-0077 FAX 713-655-0346

ROCKY MOUNTAIN DISTRICT
600 17TH STREET, STE. 2230 SOUTH
DENVER, COLORADO 80202
303-534-4404 FAX 303-534-4661

September 23, 2013

Re: Notice of Application for Commercial Disposal Permit
7276 JV-S Wedge
Well No. 1
Abraxas (Cherry Canyon) Field
Ward County, TX

U.T. LANDS
SEP 25 2013

INTERESTED PARTIES

CERTIFIED MAIL

Gentlemen:

BTA Oil Producers, LLC has submitted to the Railroad Commission of Texas an application for a Commercial Permit to Dispose for the referenced location. Attached please find a copy of our application, front and back, along with a map outlining all wells of public record within ½ mile of the location.

Should you have any questions, please advise.

Respectfully,

Matt McCord
For BTA Oil Producers, LLC

**RAILROAD COMMISSION OF TEXAS
OIL AND GAS DIVISION**

Form H-1
05/2004

APPLICATION TO INJECT FLUID INTO A RESERVOIR PRODUCTIVE OF OIL OR GAS

1. Operator name BTA Oil Producers, LLC 2. Operator P-5 No. 041860
(as shown on P-5, Organization Report)

3. Operator Address 104 S. Pecos, Midland, TX 79701

4. County Ward 5. RRC District No. 08

6. Field Name Abraxas (Cherry Canyon) 7. Field No. 392300

8. Lease Name 7276 JV-S Wedge 9. Lease/Gas ID No. 201307

10. Check the Appropriate Boxes: New Project ☒ Amendment ☐

If amendment, Fluid Injection Project No. F- _____

Reason for Amendment: Add wells ☐ Add or change types of fluids ☐ Change pressure ☐

Change volume ☐ Change interval ☐ Other (explain) _____

RESERVOIR DATA FOR A NEW PROJECT

11. Name of Formation Cherry Canyon 12. Lithology Sandstone
(e.g., dolomite, limestone, sand, etc.)

13. Type of Trap None (SWD) 14. Type of Drive during Primary Production N/A
(anticline, fault trap, stratigraphic trap, etc.)

15. Average Pay Thickness 260' (gross) 16. Lse/Unit Acreage 336.9 17. Current Bottom Hole Pressure (psig) 2450

18. Average Horizontal Permeability (mds) 2 md 19. Average Porosity (%) 14%

INJECTION PROJECT DATA

20. No. of Injection Wells in this application 1

21. Type of Injection Project: Waterflood ☐ Pressure Maintenance ☐ Miscible Displacement ☐ Natural Gas Storage ☐
Steam ☐ Thermal Recovery ☐ Disposal ☒ Other _____

22. If disposal, are fluids from leases other than the lease identified in Item 9? Yes ☒ No ☐

23. Is this application for a Commercial Disposal Well? Yes ☒ No ☐

24. If for commercial disposal, will non-hazardous oil and gas waste other than produced water be disposed? Yes ☐ No ☒

25. Type(s) of Injection Fluid:

Salt Water ☒ Brackish Water ☐ Fresh Water ☐ CO₂ ☐ N₂ ☐ Air ☐ H₂S ☐ LPG ☐ NORM ☐

Natural Gas ☐ Polymer ☐ Other (explain) _____

26. If water other than produced salt water will be injected, identify the source of each type of injection water by formation, or by aquifer and depths, or by name of surface water source:

CERTIFICATE

I declare under penalties prescribed in Sec. 91.143, Texas Natural Resources Code, that I am authorized to make this report, that this report was prepared by me or under my supervision and direction, and that the data and facts stated therein are true, correct, and complete, to the best of my knowledge.



Signature

Matt McCord

Name of Person (type or print)

mmccord@btaoil.com

Phone 432-682-3753

Fax 432-683-0325

For Office Use Only

Register No.

Amount \$

INSTRUCTIONS FOR FORM H-1

1. **Application.** File the original Form H-1 application, including all attachments, with Assistant Director, Environmental Services, Railroad Commission of Texas, P. O. Box 12967, Capitol Station, Austin, Texas 78711. File one copy of the application and all attachments with the appropriate Railroad Commission District Office. Include with the original application a non-refundable fee of \$200, payable to the Railroad Commission of Texas. Submit an additional \$150 for each request for an exception to Statewide Rule 46(g)(3) and/or (j)(5)(B).
2. **Well Logs.** Attach the complete electric log or a similar well log for one of the proposed injection wells or for a nearby well. Attach any other logging and testing data, such as a cement bond log, available for the well that supports this application.
3.
 - (a) **For a new project,** attach a map with surveys marked showing the location and depth of all wells of public record within one-quarter (1/4) mile radius of the proposed injection well(s).
 - (b) **For an amendment to add wells to a previous authority,** attach a map with surveys marked showing the location and depth of all wells of public record within one-quarter (1/4) mile radius of the additional wells, unless such data has been submitted previously for the project.
 - (c) **Table of Wells.** For those wells in 3(a) or 3(b) that penetrate the top of the injection interval, attach a table of wells showing the dates drilled and their current status. The Commission may adjust or waive this data requirement in accordance with provisions in the "Area of Review" section of Statewide Rule 46 (Rule 46(e)).
4. **Water Letter.** Attach a letter from the Texas Commission on Environmental Quality (TCEQ) or its predecessor or successor agencies for a well within the project area stating the depth to which usable quality water occurs.
5. **Form(s) H-1A.** Attach Form H-1A showing each injection well to be used in the project. Up to TWO wells can be listed on each Form H-1A.
6. **Use of Fresh Water.** Attach Form H-7, Fresh Water Data Form, for a new injection project that includes the use of fresh water. An updated Form H-7 must be attached to Form H-1 for an expansion of a previously authorized fresh water injection project unless the fresh water is purchased from a commercial supplier, public entity, or from another operator.
7. **Plat of Leases, Notice and Hearings**
 - (a) **Plat of Leases.** Attach a plat of leases showing producing wells, injection wells, offset wells and identifying ownership of all surrounding leases within one-half (1/2) mile.
 - (b) **Notice.**
 - (1) Send or deliver a copy of the application to the owner of record of the surface tract on which the well(s) is located; each Commission-designated operator of any well located within one-half (1/2) mile of the proposed injection well(s); and the clerk of the city and county in which the well(s) is located. If this is the initial application for fluid injection authority for this reservoir, send copies of the application to all operators in the reservoir. Attach a signed statement indicating the date the copies of the application were mailed or delivered and the names and addresses of the persons to whom copies were sent.
 - (2) **Attach an affidavit of publication** signed by the publisher that notice of the application has been published in a newspaper of general circulation in the county where the well(s) will be located. Notice instructions and forms may be obtained from the Commission's Austin Office, the Commission's website (www.rrc.state.tx.us) or the District Offices. Attach a newspaper clipping of the published notice.
 - (c) **Protests and Hearings.** An affected person or local government may protest this application. A hearing on the application will be held if a protest is received and the applicant requests a hearing, or if the Commission determines that a hearing is in the public interest. Any such request for a public hearing shall be in writing and contain: (1) the name, mailing address and phone number of the person making the request; and (2) a brief description of how the protestant would be adversely affected by the granting of the application. If the Commission determines that a valid protest has been received, or that a hearing would be in the public interest, a hearing will be held after issuance of proper and timely notice of the hearing by the Commission. If no protest is received within fifteen (15) days of publication or receipt in Austin of the application, the application may be processed administratively.







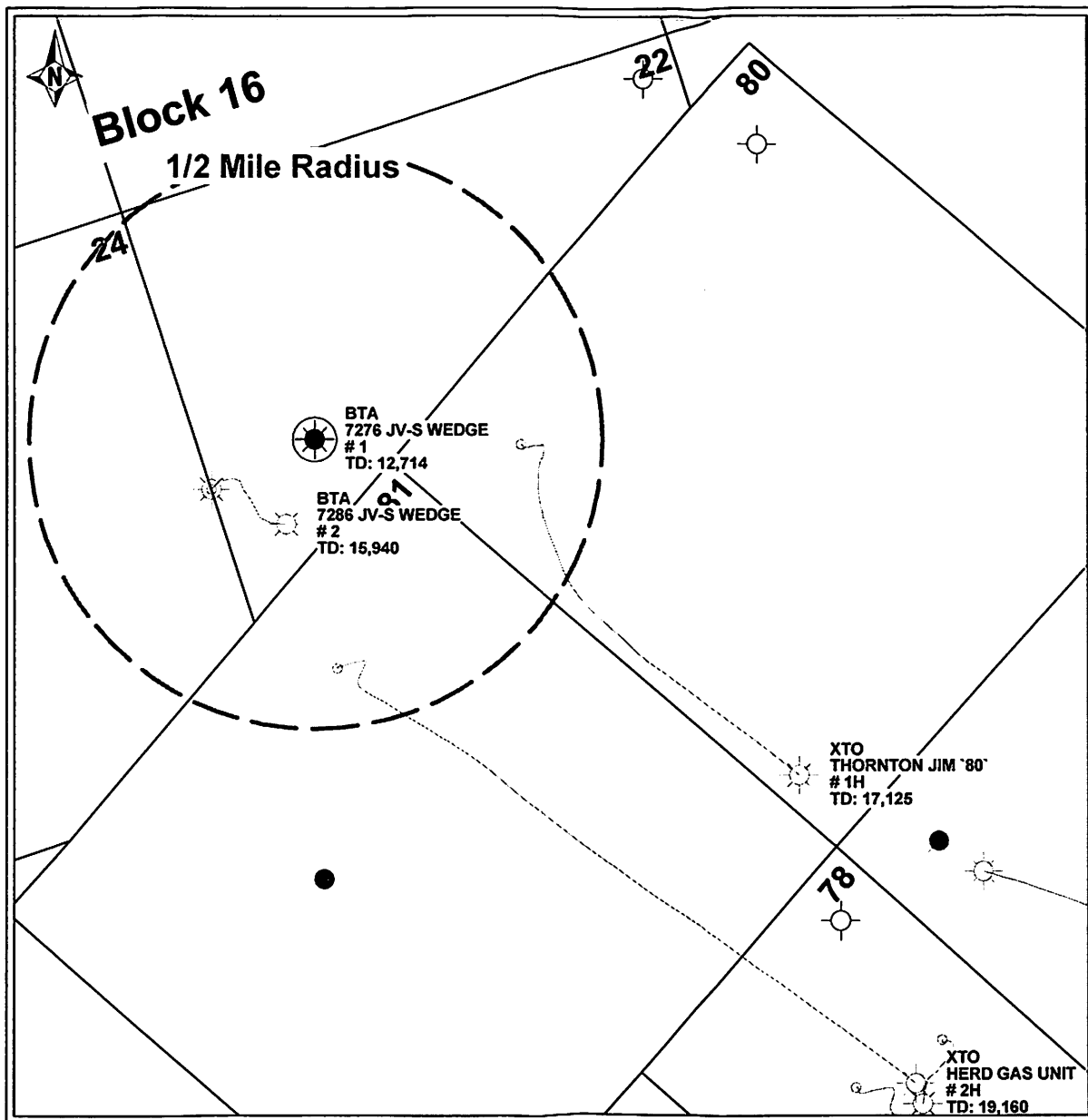

RAILROAD COMMISSION OF TEXAS -- OIL AND GAS DIVISION

Form H-1A

INJECTION WELL DATA (attach to Form H-1)

1. Operator Name (as shown on P-5) BTA Oil Producers, LLC					2. Operator P-5 No. 041860			
3. Field Name Abraxas (Cherry Canyon)					4. Field No. 392300			
5. Current Lease Name 7276 JV-S Wedge					6. Lease/Gas ID No. 201307			
7. Lease is 4 miles in a SE direction from Pyote (center of nearest town).								
8. Well No. 1	9. API No. 42-475-30720	10. UIC No.	11. Total Depth 12714'	12. Date Drilled 7/12/1975	13. Base of Usable Quality Water (ft) 5000'			
14. (a) Legal description of well location, including distance and direction from survey lines: 660' FSE & 1050' FSW, Section 22, Block 16, University Lands Survey, Ward County								
(b) Latitude and Longitude of well location, if known (optional) Lat. Long.								
15. New Injection Well <input checked="" type="checkbox"/> or Injection Well Amendment <input type="checkbox"/>				Reason for Amendment: Pressure <input type="checkbox"/> Volume <input type="checkbox"/> Interval <input type="checkbox"/> Fluid Type <input type="checkbox"/>				
* Proposed				Other (explain) _____				
Casing	* Size	* Setting Depth	* Hole Size	* Casing Weight	* Cement Class	* # Sacks of Cement	* Top of Cement	* Top Determined by
16. Surface	13-3/8"	2901'	17-1/2"	61 & 68	Class H	1900	Surface	Visual
17. Intermediate								
18. Long string	9-5/8"	9977'	12-1/4"	47	Class C	2100	3213'	Temp Survey
19. Liner								
20. Tubing size *3-1/2"	21. Tubing depth *5500'		22. Injection tubing packer depth *5500'		23. Injection interval 5546' to 5752'			
24. Cement Squeeze Operations (List all)			Squeeze Interval (ft)		No. of Sacks		Top of Cement (ft)	
25. Multiple Completion? Yes <input checked="" type="checkbox"/> No <input type="checkbox"/>			26. Downhole Water Separation? Yes <input type="checkbox"/> No <input checked="" type="checkbox"/>		NOTE: If the answer is "Yes" to Item 25 or 26, provide a Wellbore Sketch			
27. Fluid Type Produced water			28. Maximum daily injection volume for each fluid type (rate in bpd or mcf/d) 15000 bpd		29. Estimated average daily injection volume for each fluid type (rate in bpd or mcf/d) 9000 bpd			
30. Maximum Surface Injection Pressure: for Liquid 2750 psig for Gas _____ psig.								
8. Well No.	9. API No.	10. UIC No.	11. Total Depth	12. Date Drilled	13. Base of Usable Quality Water (ft)			
14. (a) Legal description of well location, including distance and direction from survey lines:								
(b) Latitude and Longitude of well location, if known (optional) Lat. Long.								
15. New Injection Well <input type="checkbox"/> or Injection Well Amendment <input type="checkbox"/>				Reason for Amendment: Pressure <input type="checkbox"/> Volume <input type="checkbox"/> Interval <input type="checkbox"/> Fluid Type <input type="checkbox"/>				
				Other (explain) _____				
Casing	Size	Setting Depth	Hole Siz	Casing Weight	Cement Class	# Sacks of Cement	Top of Cement	Top Determined by
16. Surface								
17. Intermediate								
18. Long string								
19. Liner								
20. Tubing size	21. Tubing depth		22. Injection tubing packer depth		23. Injection interval _____ to _____			
24. Cement Squeeze Operations (List all)			Squeeze Interval (ft)		No. of Sacks		Top of Cement (ft)	
25. Multiple Completion? Yes <input type="checkbox"/> No <input type="checkbox"/>			26. Downhole Water Separation? Yes <input type="checkbox"/> No <input type="checkbox"/>		NOTE: If the answer is "Yes" to Item 25 or 26, provide a Wellbore Sketch			
27. Fluid Type			28. Maximum daily injection volume for each fluid type (rate in bpd or mcf/d)		29. Estimated average daily injection volume for each fluid type (rate in bpd or mcf/d)			
30. Maximum Surface Injection Pressure: for Liquid _____ psig for Gas _____ psig.								



 BTA Oil Producers, LLC
Ward County, Texas
7276 JV-S WEDGE#1
Operator Map with 1/2 mile radius Sec 22, Blk 16, University Lands Survey
POSTED WELL DATA <div>  Operator Well Name Well Number Total Depth </div>
WELL SYMBOLS <ul style="list-style-type: none">  Oil Well  Gas Well  Oil & Gas Well  Dry Hole  Plugged & Abandoned Oil Well
REMARKS 7276 JV-S Wedge #1 Highlighted in Yellow Only Wells Within 1/2 Mile Radius Labeled
By: JHB
<div>  0 1,500 3,000 FEET </div>
August 21, 2013