

3 0 0 0 9 4 0 7 9 5



EASTMAN WHIPSTOCK, INC.

P. O. BOX 5577  
March 31, 1975

MIDLAND, TEXAS 79701

STATE OF TEXAS  
COUNTY OF MIDLAND

I, R.J. Brinlee, in the employ of the Directional Drilling Department of Eastman Whipstock, Inc., did on the days of March 28, 19 75 thru March 28, 19 75 conduct or supervise the taking of a Magnetic Multiple Shot Survey by the method of Magnetic Oriented Survey from a depth of 10144 feet to 11300 feet, with records of inclination being taken at approx. every 90 feet.

This survey was conducted at the request of B.T.A. Oil Producers for their Wedge Well No. 1 Ward \_\_\_\_\_ County, State of Texas, in the \_\_\_\_\_ Field.

R.J. Brinlee  
R.J. Brinlee

STATE OF TEXAS  
COUNTY OF MIDLAND

Before me the undersigned authority, on this day personally appeared R.J. Brinlee, known to me to be the person whose name is subscribed to this instrument, who after being by me duly sworn on oath, states that he has knowledge of all the facts stated above and that the same is a true and correct statement of facts therein recited.

Subscribed and sworn to before me this 31 day of March, 19 75.

Maethy Cordelia  
Notary Public in and for the  
Midland County, Texas

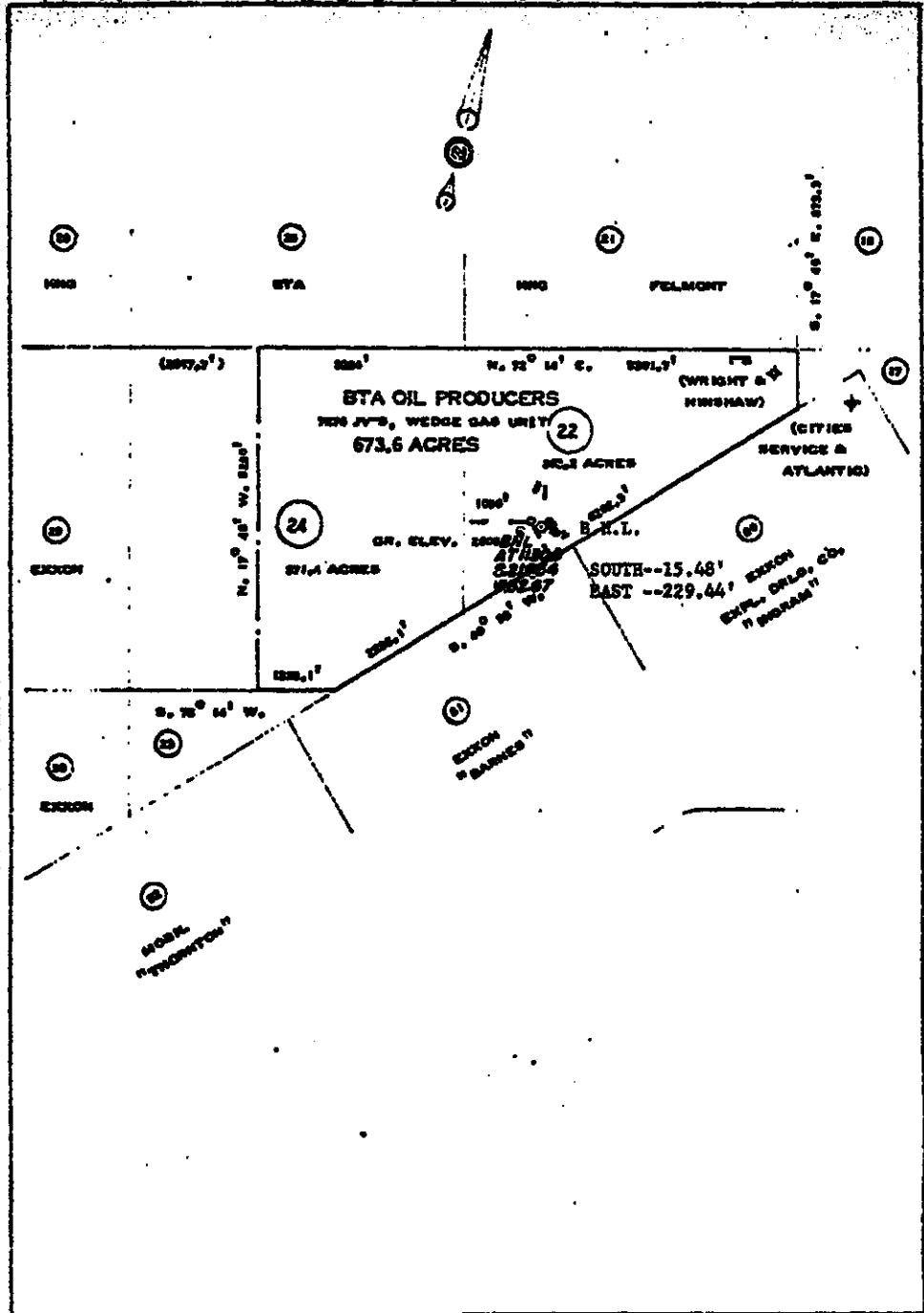

THIS IS TO CERTIFY THAT THIS LOCATION WAS MADE BY ME ON THE GROUND, AND THAT THIS PLAT IS A CORRECT REPRESENTATION THEREOF.

THIS 15TH DAY OF JANUARY, 1973

*Max A. Schumann, Jr.*  
 MAX A. SCHUMANN, JR.  
 REG. PUBLIC SURVEYOR

SCHUMANN ENGINEERING COMPANY  
 BOX 304 AREA CODE 913 MU 4 - 1348  
 MIDLAND, TEXAS, 79701

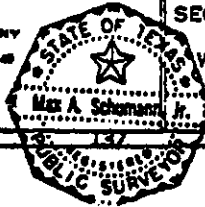

**LOCATION PLAT**

**BTA OIL PRODUCERS**  
 7276 JV-S, WEDGE GAS UNIT, WELL # 1  
 660 FT FR SOUTHEAST LINE  
 1050 FT FR SOUTHWEST LINE  
 SECTION 22, BLOCK 16, UNIVERSITY LANDS  
 WARD COUNTY, TEXAS

SCALE: 1" = 2000'

JOB NO.  
 88,420

300094 0797



*See Schlumberger  
Multi - shot survey  
later run over this  
some depth interval.  
This survey was made  
during air track operation*

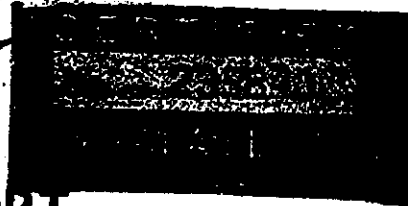

**REPORT  
of  
SUB-SURFACE  
DIRECTIONAL  
SURVEY**

B.T.A. Oil Company  
COMPANY

Wedge # 1  
WELL NAME

Ward County, Texas  
LOCATION

<u>JOB NUMBER</u>	<u>TYPE OF SURVEY</u>	<u>DATE</u>
WT 375 S-16	M M S	March 31, 1975

**SURVEY BY**  
R.J. Brinlee

**OFFICE**  
Midland, Texas

8-16-65059



ALL THE POINTS  
 WERE ON THE  
 SAME LEVEL AS  
 THESE WILL AS  
 VARIATION TO  
 POINTS WITHIN 10  
 FEET OF 100

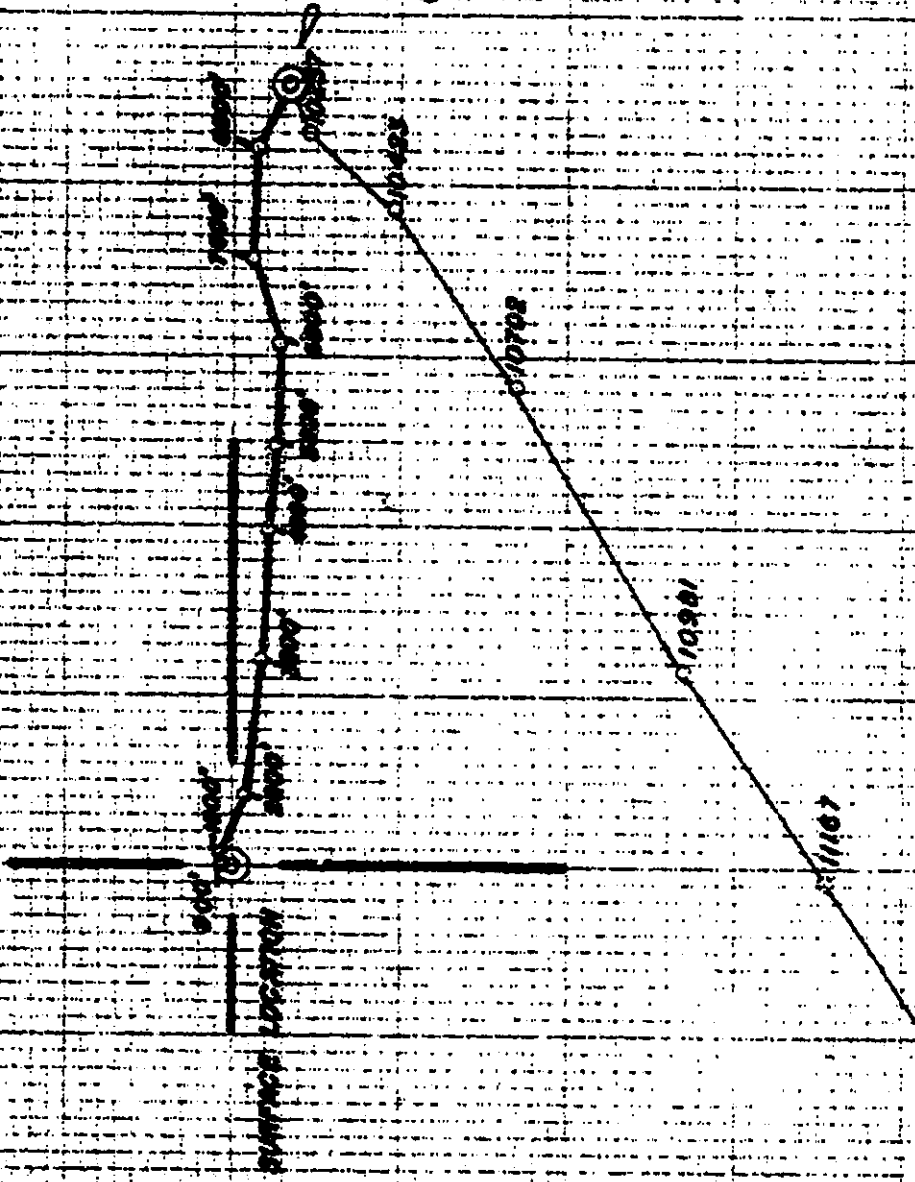

STARTING LOCATION

PREVIOUS SURVEY

DEPTH - 229.14' NORTH-SOUTH  
 WIDTH - 15.48'  
 EAST - 229.54'  
 CLOSURE: 229.88' S86°14'E

BULLY 11800 CLOSURE 317.20'  
 S 21° 54' W  
 11020