

Type or Print only

RAILROAD COMMISSION OF TEXAS

Form G-1

483-047

Oil and Gas Division

Rev. 4/1/83

API No. 42- 413-32472

Gas Well Back Pressure Test, Completion or Recompletion Report, and Log

1. FIELD NAME (as per RCC Records or Wildcat) Baker Ranch (Canyon)		2. LEASE NAME University "17"		7. RCC District No. 7C
3. OPERATOR'S NAME (Exactly as shown on Form P-5, Organization Report) Unit Petroleum Company		RCC Operator No. 877099		8. RCC Gas ID No.
4. ADDRESS 407 N. Big Spring, Ste. #300 Midland, TX 79701				9. Well No. 4
5. Location (Section, Block, and Survey) Sec 17, Block 53, University Lands Survey				10. County of well site Schleicher
5b. Distance and direction to nearest town in this county 20.5 miles NW of Eldorado				11. Purpose of filing Initial Potential <input checked="" type="checkbox"/> Retest <input type="checkbox"/> Reclass <input type="checkbox"/> Well record only (Explain in remarks) <input type="checkbox"/>
6. If operator has changed within last 60 days, name former operator		12. If workover or reclass, give former field (with reservoir) & Gas ID or oil lease no. FIELD & RESERVOIR		
13. Pipe Line Connection Targa Texas Field Services L.P.		Oil-O Gas-G		
14. Completion or recompletion date 11/28/07		15. Any condensate on hand at time of workover or recompletion? <input type="checkbox"/> Yes <input checked="" type="checkbox"/> No		16. Type of Electric or other Log Run. DIL & Neut-Density

Section I

GAS MEASUREMENT DATA

Date of Test 12/08/07		Gas Measurement Method (Check One) Orifice Meter <input type="checkbox"/> Flange Taps <input checked="" type="checkbox"/> Pipe Taps <input type="checkbox"/> Positive Choke <input type="checkbox"/> Orifice Vent Meter <input type="checkbox"/> Pitot Tube <input type="checkbox"/> Critical-flow Prover <input type="checkbox"/>								Gas production during test 1362 MCF	
Run Size	Line Size	Orif. or Choke Size	24 hr Coeff. Orif. or Choke	Static P _m or Choke Press	Diff. h _w	Flow Temp. °F	Temp. Factor F _{tf}	Gravity Factor F _g	Compress Factor F _{pr}	Volume MCF/DAY	
1	2.067	.500	Volume obtained from electronic calibrated flow meter								454
2											
3											
4											

Section II

FIELD DATA AND PRESSURE CALCULATIONS

Gravity (Dry Gas) .678		Gravity Liquid Hydrocarbon 58.6		Gas-Liquid Hydro Ratio 113,500		Gravity of Mixture G _{mix} =		Avg. Shut-in Temp. °F		Bottom Hole Temp. °F@ (Depth)	
D _{eff} ^{8/3} =		$\sqrt{T_f} = \sqrt{\quad} = \quad$		$\sqrt{GL} = \sqrt{\quad} = \quad$							
C= $\frac{1118 \times (D_{eff})^{8/3}}{\sqrt{T}}$						$\frac{\sqrt{GL}}{C} = \quad = \quad$					
Run No.	Time of Run Min.	Choke Size	Wellhead Press. PSIA P _w	Wellhead Flow Temp. °F	P _w ² (Thousands)	R	R ² (Thousands)	P _i	P _w /P _i		
Shut-In											
1	4320	48/64	1260	30							
2											
3											
4											
Run No.	F	K	S - $\frac{1}{z}$	E ^{ks}	P _f and P _s	P _f ² and P _s ² (Thousands)	P _f ² - P _s ² (Thousands)	Angle of Slope			
Shut-In											
1					2150			θ n Absolute Open Flow MCF/DAY			
2					360						
3											
4											

WELL TESTER'S CERTIFICATION: I declare under penalties prescribed in Sec.91.143, Texas Natural Resources Code, that I conducted or supervised this test and that data and facts shown in Sections I and II above are true, correct, and complete, to the best of my knowledge. Bottomhole temperature and the diameter and length of flow string were furnished by the operator of the well.

Signature: Well Tester

Name of Company

RRC Representative

OPERATOR'S CERTIFICATION: I declare under penalties prescribed in Sec.91.143, Texas Natural Resources Code, that I am authorized to make this report, that I prepared or supervised and directed this report, and that data and facts stated therein are true, correct, and complete, to the best of my knowledge.

Signature: Operator's representative

Title

District Engineer

Date

12/20/07

Tel:

432

685-9020

A/C

Number

SECTION III DATA ON WELL COMPLETION AND LOG (Not Required on Retest)							
17. Type of Completion: New Well <input checked="" type="checkbox"/> Deepening <input type="checkbox"/> Plug Back <input type="checkbox"/> Other <input type="checkbox"/>					18. Permit to Drill Plug Back or Deepen Rule 37 Exception DATE 8/27/07 PERMIT NO. 643048 CASE NO. 0252915 Water Injection Permit PERMIT NO. Salt Water Disposal Permit PERMIT NO. Other PERMIT NO.		
19. Notice of Intention to Drill this well was filed in Name of Unit Petroleum Company							
20. Number of producing wells on this lease in this field (reservoir) including this well			21. Total number of acres in this lease 291.7				
22. Date Plug Back, Deepening Workover or Drilling Operations: 10/14/07		Commenced 10/29/07		Completed 1105'		23. Distance to nearest well, Same Lease & Reservoir	
24. Location of well, relative to the nearest lease boundaries of lease on which this well is located 969' Feet From North Line and 2150' Feet From West Line of the University "17" Lease							
25. Elevation (DF, RKB, RT, GR, ETC.) GR 2557 KB 2571				26. Was directional survey made other than inclination (Form W-12)? <input type="checkbox"/> Yes <input checked="" type="checkbox"/> No			
27. Top of Pay 7031'	28. Total Depth 7200'	29. P.B. Depth 7146'	30. Surface Casing Determined by: Field Rules <input type="checkbox"/> Recommendation of T.D.W.R. Railroad Commission (Special) <input checked="" type="checkbox"/>		Dt. of Letter 8/21/07		
31. Is well multiple completion? <input type="checkbox"/> Yes <input checked="" type="checkbox"/> No		32. If multiple completion, list all reservoir names (completions in this well) and Oil Lease or Gas ID No. FIELD & RESERVOIR			33. Intervals Drilled by: Rotary Tools <input checked="" type="checkbox"/> Cable Tools <input type="checkbox"/>		
34. Name of Drilling Contractor Sand Dollar Drilling					35. Is Cementing Affidavit Attached? <input checked="" type="checkbox"/> Yes <input type="checkbox"/> No		
36. CASING RECORD (Report All Strings Set in Well)							
CASING SIZE	WT#/FT.	DEPTH SET	MULTISTAGE TOOL DEPTH	TYPE & AMOUNT CEMENT (sacks)	HOLE SIZE	TOP OF CEMENT	SLURRY VOL. cu. ft.
8-5/8"	32#	1196'		417 sx C 65/35 + 213 sx C	12-1/4"	Circulated	1102
4-1/2"	11.6#	7200'		253 sx H 10% + 388 sx H 2%	7-7/8"		1160

37. LINER RECORD				
Size	TOP	Bottom	Sacks Cement	Screen

38. TUBING RECORD			39. Producing Interval (this completion) Indicate depth of perforation or open hole	
Size	Depth Set	Packer Set	From	To
2-3/8"	7137'	None	From 7031	To 7070'
			From	To
			From	To

40. ACID, SHOT, FRACTURE, CEMENT SQUEEZE, ETC.	
Depth Interval	Amount and Kind of Material Used
7031 - 47' and 7064 - 70'	A/1500 gals 15% NeFe HCL F/42,000 gals 500 C02 Foam + 71,000# 20/40

41. FORMATION RECORD (LIST DEPTHS OF PRINCIPAL GEOLOGICAL MARKERS AND FORMATION TOPS)			
Formations	Depth	Formations	Depth
Clearfork	2134'	Canyon Top Sand	6420'
Wolfcamp	5190'		
Canyon Marker	6070'		

REMARKS

READ INSTRUCTIONS ON BACK

Form G-5

www

1. OPERATOR NAME (Exactly as shown on Form PS Organization Report) Unit Petroleum Company		3. RRC DISTRICT NO. 7C	4. OIL LEASE NO OR GAS WELL ID NO.
2. MAILING ADDRESS 407 N. Big Spring, Ste. 300 Midland, TX 79701		5. WELL NO. 4	6. API NO. 42- 413-32472
		7. COUNTY OF WELL SITE Schleicher	
8. FIELD NAME (as per RRC Records) Baker Ranch (Canyon)		9. LEASE NAME University "17"	
10. LOCATION (Section, Block and Survey)		11. PIPELINE CONNECTION OR USE OF GAS Targa Texas Field Services, L.P.	
PRODUCTION TEST AT RATE ELECTED BY OPERATOR (data on 24-hour basis)		A.S.T.M. DISTILLATION OF LIQUID SAMPLE. Distillation test is required for gas wells ONLY if the producing gas-liquid hydrocarbon ratio is less than 100,000 CF/barrel.	
A. Date of Test 12/08/07		Date Liquid Sample Obtained _____	
B. Gas Volume 454 (Mcf)		Where Obtained: <input type="checkbox"/> Separator <input type="checkbox"/> Stock Tank	
C. Oil or Condensate Volume 4 (Bbl)		% Over Temp. (deg. F) % Over Temp. (deg. F)	
D. Water Volume 3 (Bbl)		Initial Boiling Temp. _____ 60 _____	
E. Gas/Liquid Hydrocarbon Ratio 113,500 (Cf/Bbl)		10 _____ 70 _____	
F. Flowing Tubing Pressure 30 (psia)		20 _____ 80 _____	
G. Choke Size 48/64 (in.)		30 _____ 90 _____	
H. Casing Pressure 150 (psia)		40 _____ 95 _____	
I. Shut-in Wellhead Pressure-- Tubing 1260 (psia)		50 _____ End Point _____	
J. Separator Operating Pressure 18 (psia)		Total Recovery _____ percent	
K. Color of Stock Tank Liquid Yellow		Residue _____ percent	
L. Gravity of Separator Liquid 58.6 °API		Loss _____ percent	
M. Gravity of Stock Tank Liquid 57.4 °API			
N. Specific Gravity of the Gas (Air = 1) .678			
I declare under penalties prescribed in Sec. 91.143, Texas Natural Resources Code, that I am authorized to make this report, that this report was prepared by me or under my supervision and direction, and that data and facts stated therein are true, correct, and complete to the best of my knowledge.		RRC USE ONLY	
Matthew Doffer NAME (Type or Print)			
Matthew Doffer SIGNATURE			
District Engineer TITLE			
Matthew Doffer CONTACT PERSON		(432) 685-9020 PHONE NUMBER	
12/20/07 DATE			

OPERATOR NAME AND ADDRESS including city, state and zip

Unit Petroleum Company
407 N. Big Spring, Ste. #300
Midland, TX 79701

**GAS WELL
STATUS REPORT**
RAILROAD COMMISSION OF TEXAS
Oil and Gas Division
P.O. Box 12967
Austin, Texas 78711-2967

Page 1 of 1

Operator P-5 Organization No. 877099
RRC Dist. No. 7C

G-10
REV. 7/95

Test Period:
Due Date:
Effective Date:

FIELD NAME * LEASE NAME	RRC IDENT NO. WELL NO.	DATE TESTED MO/DAY/YR MARK X FOR SHUT-IN WELL	Reason for Filing			CONDENSATE PRODUCED	WATER PROD BBL/DAY X BOTTOM-HOLE PRESSURE PSIA	***SIWH PRESSURE PSIA ***FLOWING PRESSURE PSIA
			<input type="checkbox"/> Survey	<input type="checkbox"/> Retest	<input checked="" type="checkbox"/> Initial Test			
Baker Ranch (Canyon) University "17"	4	12/08/07				454 MCF	3 BBL	1260
						678	2150	30
						MCF	BBL	
						MCF	BBL	
						MCF	BBL	
						MCF	BBL	
						MCF	BBL	
						MCF	BBL	
						MCF	BBL	
						MCF	BBL	

CERTIFICATION: I declare under penalties prescribed in Texas Natural Resources Code, Sec. 91.143, that I am authorized to make this report, and that data and facts stated herein are true, correct, and complete to the best of my knowledge.

Signature: Matthew Dodd Title: District Engineer Phone: 432-685-9020 Date: 12/20/07
* AN ASTERISK PREPRINTED ON A SURVEY IDENTIFIES WELL SUBJECT TO COMMINGLING TEST REQUIREMENT
** GAS PRODUCTION RATE, IN MCF, IS TO BE REPORTED FULL-WELL STREAM, INCLUDING CONDENSATE
*** PRESSURE FOR THE TEXAS HUGOTON FIELD IS REPORTED IN PSIG
X AN "X" PREPRINTED ON A SURVEY IN THE BOTTOM-HOLE PRESSURE BOX INDICATES A BOTTOM-HOLE PRESSURE MUST BE REPORTED FOR THE WELL

[illegible]

STATEMENT OF PRODUCTIVITY OF ACREAGE
ASSIGNED TO PRORATION UNITS

Form P-15
(5-5-71)

The undersigned states that he is authorized to make this statement; that he has knowledge of the facts concerning the Unit Petroleum Company OPERATOR, University "17" LEASE, No. 4 WELL; that such well is completed in the Baker Ranch (Canyon) Field, Schleicher County, Texas and that the acreage claimed, and assigned to such well for proration purposes as authorized by special rule and as shown on the attached certified plat embraces 80 _____ acres which can reasonably be considered to be productive of hydrocarbons.

- CERTIFICATE -

I declare under penalties prescribed in Sec. 91.143, Texas Natural Resources Code, that I am authorized to make this report, that this report was prepared by me or under my supervision and direction, and that data and facts stated therein are true, correct, and complete, to the best of my knowledge.

Date 12/20/07 Signature Matthew Doffe

Telephone 432-685-9020 AREA CODE Title District Engineer

Block 53, University Lands

(1440) (1440)

(1452)

13 14

N 89°51'55" W 5309.38'

15

18

Broken Conc. Mon.

17

16

(1455)

(1454)

(1453)

N 0°10'33" E 5439.72'

S 0°08'05" W 5439.72'

UNIT PETROLEUM COMPANY

80 acre

2150'

291.7 Acres

EL. 2557

University "17"

N 89°51'55" W 5313.29'

(1460) 23

24

25

(1461)

(1462)

Note: Survey Reconstruction filed in the Office of Luchini and Mertz Land Surveying Company.

Note: All bearings and coordinates shown are based on the Texas Coordinate System of 1927, Central Zone.

A combined grid factor of 0.9997577 must be divided into Section Line distances to obtain a true horizontal distance.

Note: Example: (S-99999) indicates General Land Office file number.

Note: NAD '27 Coordinates & Latitude/Longitude on well location in Section 17.

Note: Well location is approximately 20.5 miles northwest of Eldorado.



X: 1828800.47

Latitude - 31°02'07.281" N

Y: 498190.82

Longitude - 100°52'47.898" W

Railroad Commission Permit Plat

UNIT PETROLEUM COMPANY
University "17" Lease
S/2 (Less 40 acres) of
Section 17, Block 53,
University Land,
Schleicher County, Texas

Scale: 1" = 1000'

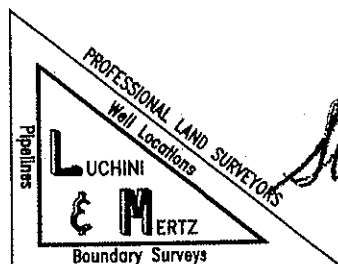

Revised: July 14, 2007

May 30, 2007

07053083

RAILROAD COMMISSION OF TEXAS OIL AND GAS DIVISION

Form W-12
DBC1297 (1-1-71)

INCLINATION REPORT (One Copy Must Be Filed With Each Completion Report.)		6. RRC District 7C
1. FIELD NAME (as per RRC Records or Wildcat) Baker Ranch (Canyon)	2. LEASE NAME UNIVERSITY 17	7. RRC Lease Number. (Oil completions only)
3. OPERATOR UNIT PETROLEUM		8. Well Number 4
4. ADDRESS 407 NORTH BIG SPRING STREET, STE 101 MIDLAND, TX 79701		9. RRC Identification Number (Gas completions only)
5. LOCATION (Section, Block, and Survey) Sec 17, Blk 53, University Lands Survey		10. County SCHLEICHER

RECORD OF INCLINATION

*11. Measured Depth (feet)	12. Course Length (Hundreds of feet)	*13. Angle of Inclination (Degrees)	14. Displacement per Hundred Feet (Sine of Angle X100)	15. Course Displacement (feet)	16. Accumulative Displacement (feet)
251	251	1.00	1.75	4.38	4.38
524	273	1.00	1.75	4.76	9.15
800	276	0.75	1.31	3.61	12.76
1400	600	0.75	1.31	7.85	20.61
1469	69	1.00	1.75	1.20	21.82
1677	208	1.00	1.75	3.63	25.45
1902	225	1.75	3.05	6.87	32.32
2152	250	1.00	1.75	4.36	36.68
2402	250	0.50	0.87	2.18	38.86
2622	220	1.50	2.62	5.76	44.62
2652	30	2.00	3.49	1.05	45.67
2904	252	2.00	3.49	8.79	54.46
3153	249	3.00	5.23	13.03	67.49
3686	533	1.50	2.62	13.95	81.45
3812	126	1.00	1.75	2.20	83.65
4062	250	0.75	1.31	3.27	86.92

If additional space is needed, use the reverse side of this form.

17. Is any information shown on the reverse side of this form? ☒ yes ☐ no
18. Accumulative total displacement of well bore at total depth of 6894 feet = 131.48 feet.
- *19. Inclination measurements were made in - ☐ Tubing ☐ Casing ☐ Open hole ☒ Drill Pipe
20. Distance from surface location of well to the nearest lease line 969 feet.
21. Minimum distance to lease line as prescribed by field rules 660 feet.
22. Was the subject well at any time intentionally deviated from the vertical in any manner whatsoever? No

(If the answer to the above question is "yes", attach written explanation of the circumstances.)

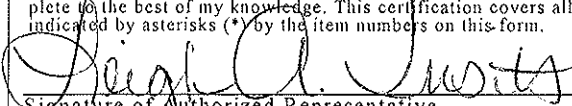
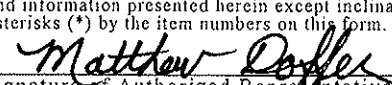
<p>INCLINATION DATA CERTIFICATION</p> <p>I declare under penalties prescribed in Sec. 91-143, Texas Natural Resources Code, that I am authorized to make this certification, that I have personal knowledge of the inclination data and facts placed on both sides of this form and that such data and facts are true, correct, and complete to the best of my knowledge. This certification covers all data as indicated by asterisks (*) by the item numbers on this form.</p> <p> Signature of Authorized Representative LEIGH A. JUSTIS REGULATORY ASSISTANT Name of Person and Title (type or print) SAND DOLLAR DRILLING, L.P. Name of Company Telephone: <u>(817) 737-2235</u> Area Code</p>	<p>OPERATOR CERTIFICATION</p> <p>I declare under penalties prescribed in Sec. 91-143, Texas Natural Resources Code, that I am authorized to make this certification, that I have personal knowledge of all information presented in this report, and that all data presented on both sides of this form are true, correct, and complete to the best of my knowledge. This certification covers all data and information presented herein except inclination data as indicated by asterisks (*) by the item numbers on this form.</p> <p> Signature of Authorized Representative Matthew Doffer District Engineer Name of Person and Title (type or print) Unit Petroleum Company Operator Telephone: <u>432</u> <u>685-9020</u> Area Code</p>
--	---

Railroad Commission Use Only:

Approved By: _____ Title: _____ Date: _____

* Designates items certified by company that conducted the inclination surveys.

RECORD OF INCLINATION (Continued from reverse side)

[illegible]

If additional space is needed, attach separate sheet and check here. ☐

REMARKS:

- INSTRUCTIONS -

An inclination survey made by persons or concerns approved by the Commission shall be filed on a form prescribed by the Commission for each well drilled or deepened with rotary tools or when, as a result of any operation, the course of the well is changed. No inclination survey is required on wells that are drilled and completed as dry holes that are plugged and abandoned. (Inclination surveys are required on re-entry of abandoned wells.) Inclination surveys must be made in accordance with the provisions of Statewide Rule 11.

This report shall be filed in the District Office of the Commission for the district in which the well is drilled, by attaching one copy to each appropriate completion for the well. (except Plugging Report)

The Commission may require the submittal of the original charts, graphs, or discs, resulting from the surveys.

Cement: Fill in shaded areas.
Operator: Fill in other items.

RAILROAD COMMISSION OF TEXAS
Oil and Gas Division

Form W-15
Cementing Report
Rev. 4/1/83
483-045

1. Operator's Name (As shown on Form P-5, Organization Report) Unit Petroleum Company		2. RRC Operator No. 877099	3. RRC District No. 7C	4. County of Well Site Schleicher
5. Field Name (Wildcat or exactly as shown on RRC Records) Baker Ranch (Canyon)			6. API No. 42-413-32472	7. Drilling Permit No. 643048
8. Lease Name University 17^r		9. Rule 37 Case No.	10. Oil Lease/Gas ID No.	11. Well No. 4

CASING CEMENTING DATA:			SURFACE CASING	INTER-MEDIATE CASING	PRODUCTION CASING		MULTI-STAGE CEMENTING PROCESS	
					Single String	Multiple Parallel Strings	Tool	Shoe
12. Cementing Date			10-16-07					
13. • Drilled Hole Size			12-1/4					
• Est. % wash or hole enlargement								
14. Size of casing (in. O.D.)			8-5/8					
15. Top of liner (ft.)								
16. Setting depth (ft.)			1,196					
17. Number of centralizers used			8					
18. Hrs. Waiting on cement before drill-out			14					
1 st Slurry	19. API cement used: No. of sacks	›	417					
	Class	›	C					
	Additives	›	Remarks					
2 nd Slurry	No. of sacks	›	213					
	Class	›	C					
	Additives	›	C+2%cacl2					
3 rd Slurry	No. of sacks	›						
	Class	›						
	Additives	›						
1st	20. Slurry pumped: Volume (cu. ft.)	›	817					
	Height (ft.)	›	1979					
2nd	Volume (cu. ft.)	›	285					
	Height (ft.)	›	690					
3rd	Volume (cu. ft.)	›						
	Height (ft.)	›						
Total	Volume (cu. ft.)	›	1102					
	Height (ft.)	›	2669					
21. Was cement circulated to ground surface (or bottom of cellar) outside casing?			Yes					
Remark: C 65/35 Poz+6% Gel+5% Salt+.01% Static Free								

Cementer: Fill in shaded areas.
Operator: Fill in other items.

RAILROAD COMMISSION OF TEXAS
Oil and Gas Division

Form W-15
Cementing Report
Rev. 4/1/83
483-045

1. Operator's Name (As shown on Form P-5, Organization Report) UNIT PETROLEUM COMPANY		2. RRC Operator No. 877099	3. RRC District No. 7C	4. County of Well Site SCHLEICHER
5. Field Name (Wildcat or exactly as shown on RRC Records) Baker Ranch (Canyon)			6. API No. 42-413-32472	7. Drilling Permit No. 643048
8. Lease Name UNIVERSITY "17"		9. Rule 37 Case No.	10. Oil Lease/Gas ID No.	11. Well No. 4

CASING CEMENTING DATA:		SURFACE CASING	INTER-MEDIATE CASING	PRODUCTION CASING		MULTI-STAGE CEMENTING PROCESS	
				Single String	Multiple Parallel Strings	Tool	Shoe
12. Cementing Date				10/31/07			
13. • Drilled Hole Size				7-7/8			
• Est. % wash or hole enlargement							
14. Size of casing (in. O.D.)				4-1/2			
15. Top of liner (ft.)							
16. Setting depth (ft.)				7200			
17. Number of centralizers used				10			
18. Hrs. Waiting on cement before drill-out				NA			
1st Slurry	19. API cement used: No. of sacks ▶			253			
	Class ▶			"H"			
	Additives ▶			#21			
2nd Slurry	No. of sacks ▶			388			
	Class ▶			"H"			
	Additives ▶			#21			
3rd Slurry	No. of sacks ▶						
	Class ▶						
	Additives ▶						
1st	20. Slurry pumped: Volume (cu. ft.) ▶			683			
	Height (ft.) ▶			2998			
2nd	Volume (cu. Ft.) ▶			477			
	Height (ft.) ▶			2093			
3rd	Volume (cu. ft.) ▶						
	Height (ft.) ▶						
Total	Volume (cu. ft.) ▶			1160			
	Height (ft.) ▶			5091			
21. Was cement circulated to ground surface (or bottom of cellar) outside casing ?				NO			
Remark: 1ST SLURRY "H" 50/50 POZ+10%GEL+1/10%+.01%STATICFREE 2ND SLURRY "H"50/50POZ+2%SALT+4/10%FL25+2%GEL+.01%STATICFREE							