



Railroad Commission of Texas
Oil and Gas Division
P.O. Box 12967
Capitol Station
Austin, TX 78711

December 17, 2014

Attn: Pam Johns

RE: Devon Energy Production CO, L.P.
University 43-15 #11H (ST01)
Reagan County, Texas
API #: 42-383-39225

Enclosed, please find the original and one copy of the survey performed on the referenced well by LEAM Drilling Systems LLC. (P-5 No. 491647). Other information required by your office is as follows:

<u>Name & Title of Surveyor</u>	<u>Drainhole Number</u>	<u>Surveyed Depths</u>	<u>Dates Performed</u>	<u>Type of Survey</u>
Randy W. Rakowitz	ST01	6,160' – 15,296'	12/05/14 – 12/10/14	MWD

A certified plat on which the bottom hole location is oriented both to the surface location and to the lease lines (or unit lines in case of pooling) is attached to the survey report. If any other information is required, please contact the undersigned at the letterhead address and phone number.

Nora Tucker
Well Planner

Enclosures

LEAM Drilling Systema LLC

Survey Report

Company:	Devon Energy	Local Co-ordinate Reference:	Well #11H
Project:	Reagan County, TX (NAD-83)	TVD Reference:	H&P 265: 2652' GL + 25' RKB @ 2677.00usft
Site:	University 43-15	MD Reference:	H&P 265: 2652' GL + 25' RKB @ 2677.00usft
Well:	#11H	North Reference:	Grid
Wellbore:	ST	Survey Calculation Method:	Minimum Curvature
Design:	ST	Database:	EDM 5000.1 MULTI User DB

Project	Reagan County, TX (NAD-83)		
Map System:	US State Plane 1983	System Datum:	Mean Sea Level
Geo Datum:	North American Datum 1983		
Map Zone:	Texas Central Zone		

Site	University 43-15				
Site Position:		Northing:	10,367,878.51 usft	Latitude:	31° 6' 27.560 N
From:	Map	Easting:	1,996,322.04 usft	Longitude:	101° 17' 34.139 W
Position Uncertainty:	0.00 usft	Slot Radius:	13-3/16 "	Grid Convergence:	-0.49 °

Well	#11H, Wolfcamp					
Well Position	+N/-S	0.00 usft	Northing:	10,367,938.05 usft	Latitude:	31° 6' 28.154 N
	+E/-W	0.00 usft	Easting:	1,996,375.46 usft	Longitude:	101° 17' 33.531 W
Position Uncertainty		0.00 usft	Wellhead Elevation:	2,677.00 usft	Ground Level:	2,652.00 usft

Wellbore	ST				
Magnetics	Model Name	Sample Date	Declination (°)	Dip Angle (°)	Field Strength (nT)
	BGGM2013	12/01/14	6.03	59.39	47,796

Design	ST				
Audit Notes:					
Version:	1.0	Phase:	ACTUAL	Tie On Depth:	6,116.00
Vertical Section:	Depth From (TVD) (usft)	+N/-S (usft)	+E/-W (usft)	Direction (°)	
	0.00	0.00	0.00	360.00	

Survey Program	Date	12/17/14			
From (usft)	To (usft)	Survey (Wellbore)	Tool Name	Description	
86.00	945.00	Survey #1 (OH)	MWD-ISCWSA	MWD - Standard	
1,047.00	6,116.00	Survey #2 (OH)	LEAM MWD+HDGM	MWD+HDGM	
6,160.00	15,229.00	Survey #1 (ST)	LEAM MWD+HDGM	MWD+HDGM	
15,296.00	15,296.00	Survey #2 (ST)	Project	Projection	

Survey										
Measured Depth (usft)	Inclination (°)	Azimuth (°)	Vertical Depth (usft)	+N/-S (usft)	+E/-W (usft)	Vertical Section (usft)	Dogleg Rate (°/100usft)	Build Rate (°/100usft)	Turn Rate (°/100usft)	
0.00	0.00	0.00	0.00	0.00	0.00	0.00	0.00	0.00	0.00	
86.00	0.37	329.36	86.00	0.24	-0.14	0.24	0.43	0.43	0.00	
145.00	0.44	10.28	145.00	0.63	-0.20	0.63	0.49	0.12	69.36	
239.00	0.35	25.30	239.00	1.24	-0.01	1.24	0.15	-0.10	15.98	
332.00	0.64	343.92	331.99	2.00	-0.03	2.00	0.48	0.31	-44.49	
438.00	0.48	333.52	437.99	2.96	-0.40	2.96	0.18	-0.15	-9.81	
566.00	0.51	19.50	565.98	3.98	-0.44	3.98	0.30	0.02	35.92	
693.00	0.28	16.88	692.98	4.81	-0.17	4.81	0.18	-0.18	-2.06	

LEAM Drilling Systema LLC

Survey Report

Company:	Devon Energy	Local Co-ordinate Reference:	Well #11H
Project:	Reagan County, TX (NAD-83)	TVD Reference:	H&P 265: 2652' GL + 25' RKB @ 2677.00usft
Site:	University 43-15	MD Reference:	H&P 265: 2652' GL + 25' RKB @ 2677.00usft
Well:	#11H	North Reference:	Grid
Wellbore:	ST	Survey Calculation Method:	Minimum Curvature
Design:	ST	Database:	EDM 5000.1 MULTI User DB

Survey									
Measured Depth (usft)	Inclination (°)	Azimuth (°)	Vertical Depth (usft)	+N/-S (usft)	+E/-W (usft)	Vertical Section (usft)	Dogleg Rate (°/100usft)	Build Rate (°/100usft)	Turn Rate (°/100usft)
821.00	0.08	1.39	820.98	5.20	-0.07	5.20	0.16	-0.16	-12.10
945.00	0.32	314.66	944.98	5.53	-0.32	5.53	0.22	0.19	-37.69
1,047.00	0.21	260.86	1,046.98	5.70	-0.70	5.70	0.25	-0.11	-52.75
1,142.00	0.73	257.13	1,141.97	5.54	-1.47	5.54	0.55	0.55	-3.93
1,237.00	0.81	96.45	1,236.97	5.33	-1.39	5.33	1.60	0.08	-169.14
1,331.00	2.41	86.84	1,330.93	5.36	1.25	5.36	1.72	1.70	-10.22
1,426.00	4.44	85.86	1,425.76	5.74	6.91	5.74	2.14	2.14	-1.03
1,520.00	6.82	82.21	1,519.30	6.75	16.07	6.75	2.56	2.53	-3.88
1,615.00	8.86	82.20	1,613.40	8.51	28.91	8.51	2.15	2.15	-0.01
1,709.00	10.15	87.82	1,706.11	9.81	44.36	9.81	1.69	1.37	5.98
1,804.00	10.39	88.41	1,799.59	10.37	61.28	10.37	0.28	0.25	0.62
1,898.00	10.11	86.09	1,892.09	11.16	77.99	11.16	0.53	-0.30	-2.47
1,993.00	9.62	86.22	1,985.69	12.26	94.23	12.26	0.52	-0.52	0.14
2,087.00	9.39	85.03	2,078.40	13.44	109.70	13.44	0.32	-0.24	-1.27
2,182.00	10.17	91.88	2,172.02	13.83	125.81	13.83	1.47	0.82	7.21
2,276.00	10.30	94.42	2,264.52	12.91	142.48	12.91	0.50	0.14	2.70
2,371.00	10.29	93.59	2,357.99	11.73	159.42	11.73	0.16	-0.01	-0.87
2,465.00	10.28	93.64	2,450.48	10.67	176.17	10.67	0.01	-0.01	0.05
2,560.00	10.44	92.97	2,543.93	9.69	193.22	9.69	0.21	0.17	-0.71
2,654.00	10.47	92.65	2,636.37	8.85	210.26	8.85	0.07	0.03	-0.34
2,749.00	10.46	93.09	2,729.79	7.99	227.49	7.99	0.08	-0.01	0.46
2,844.00	10.46	93.45	2,823.21	7.00	244.71	7.00	0.07	0.00	0.38
2,938.00	10.24	93.54	2,915.68	5.97	261.57	5.97	0.23	-0.23	0.10
3,033.00	10.08	92.69	3,009.20	5.06	278.30	5.06	0.23	-0.17	-0.89
3,127.00	9.16	93.13	3,101.87	4.27	293.99	4.27	0.98	-0.98	0.47
3,221.00	7.65	91.84	3,194.86	3.66	307.71	3.66	1.62	-1.61	-1.37
3,316.00	7.36	88.23	3,289.05	3.64	320.12	3.64	0.58	-0.31	-3.80
3,410.00	8.08	81.14	3,382.20	4.85	332.66	4.85	1.27	0.77	-7.54
3,505.00	8.86	81.24	3,476.16	6.99	346.49	6.99	0.82	0.82	0.11
3,599.00	9.64	85.40	3,568.94	8.72	361.49	8.72	1.09	0.83	4.43
3,694.00	9.80	91.38	3,662.58	9.17	377.50	9.17	1.08	0.17	6.29
3,788.00	10.10	89.35	3,755.16	9.07	393.74	9.07	0.49	0.32	-2.16
3,883.00	10.54	87.56	3,848.63	9.53	410.75	9.53	0.57	0.46	-1.88
3,977.00	9.39	83.69	3,941.21	10.74	426.96	10.74	1.42	-1.22	-4.12
4,072.00	9.63	82.79	4,034.90	12.59	442.55	12.59	0.30	0.25	-0.95
4,166.00	10.35	85.59	4,127.48	14.22	458.77	14.22	0.92	0.77	2.98
4,261.00	10.34	92.58	4,220.94	14.50	475.80	14.50	1.32	-0.01	7.36
4,355.00	9.05	95.27	4,313.59	13.44	491.59	13.44	1.45	-1.37	2.86
4,450.00	8.82	91.87	4,407.44	12.51	506.30	12.51	0.61	-0.24	-3.58
4,544.00	10.13	89.00	4,500.16	12.42	521.77	12.42	1.48	1.39	-3.05
4,639.00	10.58	85.90	4,593.61	13.19	538.83	13.19	0.75	0.47	-3.26
4,733.00	10.07	88.47	4,686.09	14.03	555.65	14.03	0.73	-0.54	2.73
4,828.00	8.36	86.92	4,779.86	14.62	570.85	14.62	1.82	-1.80	-1.63

LEAM Drilling Systema LLC

Survey Report

Company:	Devon Energy	Local Co-ordinate Reference:	Well #11H
Project:	Reagan County, TX (NAD-83)	TVD Reference:	H&P 265: 2652' GL + 25' RKB @ 2677.00usft
Site:	University 43-15	MD Reference:	H&P 265: 2652' GL + 25' RKB @ 2677.00usft
Well:	#11H	North Reference:	Grid
Wellbore:	ST	Survey Calculation Method:	Minimum Curvature
Design:	ST	Database:	EDM 5000.1 MULTI User DB

Survey									
Measured Depth (usft)	Inclination (°)	Azimuth (°)	Vertical Depth (usft)	+N/-S (usft)	+E/-W (usft)	Vertical Section (usft)	Dogleg Rate (°/100usft)	Build Rate (°/100usft)	Turn Rate (°/100usft)
4,922.00	8.03	85.04	4,872.90	15.56	584.21	15.56	0.45	-0.35	-2.00
5,017.00	8.41	95.40	4,966.93	15.48	597.74	15.48	1.61	0.40	10.91
5,111.00	9.14	99.89	5,059.83	13.55	611.94	13.55	1.06	0.78	4.78
5,206.00	8.98	93.48	5,153.64	11.80	626.77	11.80	1.08	-0.17	-6.75
5,300.00	9.92	90.41	5,246.37	11.30	642.19	11.30	1.13	1.00	-3.27
5,395.00	9.45	89.22	5,340.01	11.35	658.17	11.35	0.54	-0.49	-1.25
5,490.00	8.56	88.65	5,433.84	11.62	673.04	11.62	0.94	-0.94	-0.60
5,584.00	7.71	88.81	5,526.89	11.91	686.34	11.91	0.90	-0.90	0.17
5,678.00	7.69	87.94	5,620.05	12.27	698.93	12.27	0.13	-0.02	-0.93
5,773.00	9.08	89.23	5,714.03	12.60	712.78	12.60	1.48	1.46	1.36
5,867.00	9.86	91.60	5,806.75	12.48	728.24	12.48	0.93	0.83	2.52
5,962.00	8.94	92.05	5,900.47	11.98	743.75	11.98	0.97	-0.97	0.47
6,057.00	7.54	92.85	5,994.49	11.41	757.35	11.41	1.48	-1.47	0.84
6,116.00	6.37	93.65	6,053.05	11.01	764.48	11.01	1.99	-1.98	1.36
6,160.00	11.65	77.90	6,096.50	11.79	771.27	11.79	13.14	12.00	-35.80
6,186.00	13.10	72.36	6,121.90	13.23	776.64	13.23	7.20	5.58	-21.31
6,217.00	14.77	61.81	6,151.99	16.16	783.47	16.16	9.79	5.39	-34.03
6,249.00	16.48	51.18	6,182.81	20.93	790.61	20.93	10.40	5.34	-33.22
6,280.00	18.15	40.72	6,212.41	27.35	797.19	27.35	11.37	5.39	-33.74
6,312.00	20.04	31.23	6,242.66	35.82	803.28	35.82	11.34	5.91	-29.66
6,344.00	22.41	24.02	6,272.49	46.08	808.61	46.08	11.01	7.41	-22.53
6,375.00	24.83	17.78	6,300.90	57.68	813.00	57.68	11.21	7.81	-20.13
6,406.00	27.47	12.33	6,328.72	70.87	816.52	70.87	11.51	8.52	-17.58
6,438.00	30.50	9.25	6,356.71	86.10	819.40	86.10	10.55	9.47	-9.63
6,470.00	31.73	7.94	6,384.11	102.45	821.87	102.45	4.39	3.84	-4.09
6,501.00	33.09	8.11	6,410.28	118.90	824.19	118.90	4.40	4.39	0.55
6,533.00	34.28	7.58	6,436.91	136.48	826.61	136.48	3.83	3.72	-1.66
6,564.00	36.04	7.76	6,462.25	154.17	828.99	154.17	5.69	5.68	0.58
6,596.00	37.92	6.88	6,487.81	173.27	831.44	173.27	6.10	5.88	-2.75
6,627.00	39.07	6.09	6,512.08	192.44	833.62	192.44	4.03	3.71	-2.55
6,659.00	40.52	5.04	6,536.66	212.82	835.60	212.82	4.99	4.53	-3.28
6,690.00	42.28	3.98	6,559.91	233.26	837.21	233.26	6.11	5.68	-3.42
6,722.00	44.12	3.54	6,583.24	255.12	838.65	255.12	5.83	5.75	-1.38
6,753.00	46.10	3.28	6,605.12	277.04	839.95	277.04	6.41	6.39	-0.84
6,785.00	48.95	3.72	6,626.72	300.59	841.40	300.59	8.96	8.91	1.38
6,817.00	51.94	4.86	6,647.10	325.19	843.25	325.19	9.74	9.34	3.56
6,848.00	55.63	5.39	6,665.41	350.10	845.48	350.10	11.98	11.90	1.71
6,880.00	58.32	4.42	6,682.85	376.83	847.77	376.83	8.78	8.41	-3.03
6,911.00	61.61	2.40	6,698.37	403.61	849.36	403.61	12.02	10.61	-6.52
6,943.00	63.98	0.64	6,713.00	432.06	850.11	432.06	8.88	7.41	-5.50
6,974.00	66.40	359.50	6,726.00	460.20	850.14	460.20	8.49	7.81	-3.68
7,006.00	68.64	358.62	6,738.24	489.76	849.66	489.76	7.45	7.00	-2.75
7,038.00	70.49	358.18	6,749.41	519.73	848.82	519.73	5.92	5.78	-1.38
7,069.00	72.64	359.94	6,759.21	549.13	848.34	549.13	8.78	6.94	5.68

LEAM Drilling Systema LLC

Survey Report

Company:	Devon Energy	Local Co-ordinate Reference:	Well #11H
Project:	Reagan County, TX (NAD-83)	TVD Reference:	H&P 265: 2652' GL + 25' RKB @ 2677.00usft
Site:	University 43-15	MD Reference:	H&P 265: 2652' GL + 25' RKB @ 2677.00usft
Well:	#11H	North Reference:	Grid
Wellbore:	ST	Survey Calculation Method:	Minimum Curvature
Design:	ST	Database:	EDM 5000.1 MULTI User DB

Survey									
Measured Depth (usft)	Inclination (°)	Azimuth (°)	Vertical Depth (usft)	+N/-S (usft)	+E/-W (usft)	Vertical Section (usft)	Dogleg Rate (°/100usft)	Build Rate (°/100usft)	Turn Rate (°/100usft)
7,101.00	74.66	0.47	6,768.22	579.84	848.45	579.84	6.51	6.31	1.66
7,132.00	77.34	0.29	6,775.72	609.91	848.65	609.91	8.66	8.65	-0.58
7,164.00	79.23	359.24	6,782.22	641.24	848.52	641.24	6.72	5.91	-3.28
7,195.00	81.74	358.62	6,787.34	671.81	847.95	671.81	8.33	8.10	-2.00
7,227.00	83.67	359.06	6,791.41	703.54	847.30	703.54	6.18	6.03	1.38
7,258.00	85.65	359.06	6,794.29	734.40	846.80	734.40	6.39	6.39	0.00
7,290.00	87.32	359.50	6,796.25	766.34	846.40	766.34	5.40	5.22	1.38
7,322.00	88.46	358.80	6,797.43	798.31	845.92	798.31	4.18	3.56	-2.19
7,353.00	88.64	359.32	6,798.21	829.30	845.41	829.30	1.77	0.58	1.68
7,448.00	88.64	358.88	6,800.47	924.26	843.92	924.26	0.46	0.00	-0.46
7,542.00	88.81	359.32	6,802.56	1,018.22	842.45	1,018.22	0.50	0.18	0.47
7,637.00	89.25	358.09	6,804.17	1,113.18	840.30	1,113.18	1.37	0.46	-1.29
7,731.00	89.47	357.04	6,805.22	1,207.09	836.31	1,207.09	1.14	0.23	-1.12
7,826.00	89.96	356.60	6,805.69	1,301.94	831.04	1,301.94	0.69	0.52	-0.46
7,920.00	90.40	357.30	6,805.40	1,395.81	826.04	1,395.81	0.88	0.47	0.74
8,015.00	89.47	358.80	6,805.50	1,490.75	822.80	1,490.75	1.86	-0.98	1.58
8,109.00	90.13	359.15	6,805.83	1,584.73	821.12	1,584.73	0.79	0.70	0.37
8,204.00	89.38	358.27	6,806.24	1,679.71	818.98	1,679.71	1.22	-0.79	-0.93
8,299.00	89.52	357.65	6,807.15	1,774.64	815.60	1,774.64	0.67	0.15	-0.65
8,394.00	89.25	357.70	6,808.17	1,869.56	811.75	1,869.56	0.29	-0.28	0.05
8,488.00	89.25	357.57	6,809.40	1,963.47	807.87	1,963.47	0.14	0.00	-0.14
8,583.00	89.17	357.48	6,810.71	2,058.37	803.77	2,058.37	0.13	-0.08	-0.09
8,677.00	90.00	356.42	6,811.39	2,152.24	798.77	2,152.24	1.43	0.88	-1.13
8,772.00	90.79	356.86	6,810.74	2,247.07	793.20	2,247.07	0.95	0.83	0.46
8,866.00	91.27	359.59	6,809.05	2,341.00	790.29	2,341.00	2.95	0.51	2.90
8,961.00	90.22	358.71	6,807.81	2,435.98	788.88	2,435.98	1.44	-1.11	-0.93
9,055.00	90.75	0.55	6,807.02	2,529.97	788.27	2,529.97	2.04	0.56	1.96
9,150.00	89.52	0.11	6,806.79	2,624.97	788.82	2,624.97	1.38	-1.29	-0.46
9,244.00	88.20	359.32	6,808.66	2,718.94	788.35	2,718.94	1.64	-1.40	-0.84
9,339.00	88.77	359.59	6,811.17	2,813.90	787.45	2,813.90	0.66	0.60	0.28
9,433.00	89.52	358.27	6,812.58	2,907.88	785.69	2,907.88	1.61	0.80	-1.40
9,528.00	89.96	358.80	6,813.01	3,002.84	783.26	3,002.84	0.73	0.46	0.56
9,623.00	88.99	358.62	6,813.88	3,097.81	781.12	3,097.81	1.04	-1.02	-0.19
9,717.00	89.12	359.06	6,815.43	3,191.78	779.22	3,191.78	0.49	0.14	0.47
9,811.00	88.24	357.04	6,817.59	3,285.70	776.02	3,285.70	2.34	-0.94	-2.15
9,906.00	87.28	358.36	6,821.31	3,380.54	772.21	3,380.54	1.72	-1.01	1.39
10,000.00	87.14	358.27	6,825.88	3,474.39	769.45	3,474.39	0.18	-0.15	-0.10
10,095.00	88.02	0.64	6,829.89	3,569.29	768.55	3,569.29	2.66	0.93	2.49
10,189.00	89.03	1.87	6,832.31	3,663.24	770.61	3,663.24	1.69	1.07	1.31
10,284.00	91.01	1.52	6,832.28	3,758.19	773.42	3,758.19	2.12	2.08	-0.37
10,379.00	89.78	0.29	6,831.63	3,853.17	774.92	3,853.17	1.83	-1.29	-1.29
10,473.00	89.78	0.20	6,831.99	3,947.17	775.32	3,947.17	0.10	0.00	-0.10
10,568.00	90.53	0.64	6,831.73	4,042.17	776.02	4,042.17	0.92	0.79	0.46

LEAM Drilling Systema LLC

Survey Report

Company:	Devon Energy	Local Co-ordinate Reference:	Well #11H
Project:	Reagan County, TX (NAD-83)	TVD Reference:	H&P 265: 2652' GL + 25' RKB @ 2677.00usft
Site:	University 43-15	MD Reference:	H&P 265: 2652' GL + 25' RKB @ 2677.00usft
Well:	#11H	North Reference:	Grid
Wellbore:	ST	Survey Calculation Method:	Minimum Curvature
Design:	ST	Database:	EDM 5000.1 MULTI User DB

Survey										
Measured Depth (usft)	Inclination (°)	Azimuth (°)	Vertical Depth (usft)	+N/-S (usft)	+E/-W (usft)	Vertical Section (usft)	Dogleg Rate (°/100usft)	Build Rate (°/100usft)	Turn Rate (°/100usft)	
10,662.00	89.25	2.05	6,831.91	4,136.14	778.22	4,136.14	2.03	-1.36	1.50	
10,757.00	89.96	3.37	6,832.57	4,231.03	782.72	4,231.03	1.58	0.75	1.39	
10,851.00	88.86	2.40	6,833.53	4,324.90	787.45	4,324.90	1.56	-1.17	-1.03	
10,946.00	90.40	4.51	6,834.15	4,419.72	793.17	4,419.72	2.75	1.62	2.22	
11,040.00	89.60	2.31	6,834.15	4,513.54	798.76	4,513.54	2.49	-0.85	-2.34	
11,135.00	89.30	0.99	6,835.06	4,608.50	801.50	4,608.50	1.42	-0.32	-1.39	
11,229.00	90.62	2.66	6,835.12	4,702.45	804.49	4,702.45	2.26	1.40	1.78	
11,324.00	89.74	0.29	6,834.83	4,797.41	806.94	4,797.41	2.66	-0.93	-2.49	
11,418.00	88.20	359.85	6,836.52	4,891.39	807.05	4,891.39	1.70	-1.64	-0.47	
11,513.00	87.98	359.85	6,839.68	4,986.33	806.80	4,986.33	0.23	-0.23	0.00	
11,607.00	89.47	0.03	6,841.77	5,080.31	806.70	5,080.31	1.60	1.59	0.19	
11,702.00	89.78	359.15	6,842.40	5,175.30	806.02	5,175.30	0.98	0.33	-0.93	
11,796.00	90.22	359.32	6,842.40	5,269.29	804.77	5,269.29	0.50	0.47	0.18	
11,891.00	88.68	0.55	6,843.31	5,364.28	804.66	5,364.28	2.07	-1.62	1.29	
11,985.00	89.17	0.73	6,845.07	5,458.26	805.71	5,458.26	0.56	0.52	0.19	
12,080.00	89.12	0.55	6,846.49	5,553.25	806.77	5,553.25	0.20	-0.05	-0.19	
12,176.00	89.96	0.20	6,847.26	5,649.24	807.40	5,649.24	0.95	0.88	-0.36	
12,269.00	89.21	0.64	6,847.93	5,742.23	808.08	5,742.23	0.93	-0.81	0.47	
12,364.00	89.74	1.96	6,848.80	5,837.20	810.24	5,837.20	1.50	0.56	1.39	
12,458.00	90.31	2.40	6,848.76	5,931.13	813.81	5,931.13	0.77	0.61	0.47	
12,553.00	90.40	0.29	6,848.17	6,026.10	816.04	6,026.10	2.22	0.09	-2.22	
12,647.00	89.82	1.34	6,847.99	6,120.09	817.38	6,120.09	1.28	-0.62	1.12	
12,742.00	90.66	0.11	6,847.60	6,215.08	818.58	6,215.08	1.57	0.88	-1.29	
12,836.00	90.18	1.96	6,846.91	6,309.06	820.28	6,309.06	2.03	-0.51	1.97	
12,931.00	90.62	1.52	6,846.24	6,404.01	823.16	6,404.01	0.65	0.46	-0.46	
13,026.00	90.31	1.52	6,845.47	6,498.97	825.68	6,498.97	0.33	-0.33	0.00	
13,120.00	89.60	2.75	6,845.55	6,592.90	829.19	6,592.90	1.51	-0.76	1.31	
13,215.00	87.54	3.28	6,847.92	6,687.74	834.18	6,687.74	2.24	-2.17	0.56	
13,310.00	87.98	1.17	6,851.63	6,782.59	837.87	6,782.59	2.27	0.46	-2.22	
13,404.00	88.20	0.90	6,854.76	6,876.52	839.56	6,876.52	0.37	0.23	-0.29	
13,499.00	88.51	2.05	6,857.49	6,971.45	842.01	6,971.45	1.25	0.33	1.21	
13,593.00	89.25	2.22	6,859.33	7,065.36	845.51	7,065.36	0.81	0.79	0.18	
13,688.00	87.76	1.61	6,861.81	7,160.28	848.68	7,160.28	1.69	-1.57	-0.64	
13,782.00	88.07	1.43	6,865.23	7,254.18	851.17	7,254.18	0.38	0.33	-0.19	
13,877.00	88.68	2.31	6,867.92	7,349.09	854.27	7,349.09	1.13	0.64	0.93	
13,971.00	88.11	359.94	6,870.55	7,443.03	856.12	7,443.03	2.59	-0.61	-2.52	
14,066.00	88.20	359.32	6,873.61	7,537.98	855.50	7,537.98	0.66	0.09	-0.65	
14,160.00	87.06	0.03	6,877.50	7,631.89	854.97	7,631.89	1.43	-1.21	0.76	
14,255.00	88.07	0.90	6,881.53	7,726.80	855.74	7,726.80	1.40	1.06	0.92	
14,349.00	88.68	1.17	6,884.20	7,820.75	857.44	7,820.75	0.71	0.65	0.29	
14,444.00	89.03	0.64	6,886.10	7,915.72	858.94	7,915.72	0.67	0.37	-0.56	
14,538.00	88.95	1.43	6,887.76	8,009.69	860.64	8,009.69	0.84	-0.09	0.84	
14,633.00	89.56	0.73	6,888.99	8,104.66	862.43	8,104.66	0.98	0.64	-0.74	

LEAM Drilling Systema LLC

Survey Report

Company:	Devon Energy	Local Co-ordinate Reference:	Well #11H
Project:	Reagan County, TX (NAD-83)	TVD Reference:	H&P 265: 2652' GL + 25' RKB @ 2677.00usft
Site:	University 43-15	MD Reference:	H&P 265: 2652' GL + 25' RKB @ 2677.00usft
Well:	#11H	North Reference:	Grid
Wellbore:	ST	Survey Calculation Method:	Minimum Curvature
Design:	ST	Database:	EDM 5000.1 MULTI User DB

Survey										
Measured Depth (usft)	Inclination (°)	Azimuth (°)	Vertical Depth (usft)	+N/-S (usft)	+E/-W (usft)	Vertical Section (usft)	Dogleg Rate (°/100usft)	Build Rate (°/100usft)	Turn Rate (°/100usft)	
14,728.00	89.47	359.76	6,889.80	8,199.65	862.83	8,199.65	1.03	-0.09	-1.02	
14,822.00	88.20	0.11	6,891.71	8,293.63	862.73	8,293.63	1.40	-1.35	0.37	
14,917.00	88.02	2.40	6,894.84	8,388.55	864.81	8,388.55	2.42	-0.19	2.41	
15,011.00	88.64	1.61	6,897.58	8,482.45	868.09	8,482.45	1.07	0.66	-0.84	
15,106.00	88.95	2.05	6,899.58	8,577.38	871.13	8,577.38	0.57	0.33	0.46	
15,200.00	89.03	1.17	6,901.23	8,671.33	873.77	8,671.33	0.94	0.09	-0.94	
15,229.00	89.34	1.17	6,901.65	8,700.32	874.36	8,700.32	1.07	1.07	0.00	
15,296.00	89.34	1.17	6,902.42	8,767.30	875.73	8,767.30	0.00	0.00	0.00	
Projection										

NOTE:
COMBINED SCALE FACTOR: 0.999760376
SHL IS APPROXIMATELY 11.55 MILES S 58°54'49" E OF THE
COURTHOUSE IN BIG LAKE, REAGAN COUNTY, TEXAS.

INSERT
SCALE 1" = 50'

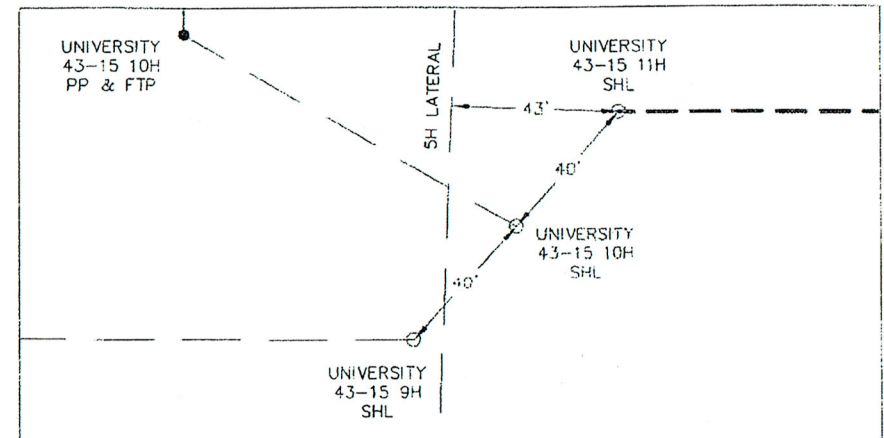

PERMIT PLAT OF
DEVON ENERGY PRODUCTION COMPANY, L.P.

UNIVERSITY 43-15 11H

LIN (WOLFCAMP) FIELD

(1344.30 ACRES)

UNIVERSITY LEASE

SURVEY LINES

SHL: 1760' FSL & 2667' FEL

PP & FTP: 1760' FSL & 1800' FEL

SECTION 15, BLOCK 43

UNIVERSITY LAND SURVEY

LTP & BHL: 100' FNL & 1800' FEL

SECTION 6, BLOCK 43

UNIVERSITY LAND SURVEY

LEASE LINES

SHL: 1760' FSL & 2667' FEL

PP & FTP: 1760' FSL & 1800' FEL

LTP & BHL: 100' FNL & 1800' FEL

REAGAN COUNTY, TEXAS

DRILLABLE

09/30/14

TB

0' 2000' 4000' 6000'

NOTE:
1. BEARINGS, DISTANCES & ACREAGE ARE GRD, NAD 83 US TX CENTRAL ZONE AND ARE OBTAINED BY NORMAL GPS TECHNIQUES.
2. ELEVATIONS ARE BASED ON NAVD 83.
3. THIS SURVEY IS FOR AN OIL & GAS SUB-SURFACE LEASE AND THEREFORE THIS IS NOT A BOUNDARY SURVEY.
4. LOCATION OF ADJOINING WELLS OUTSIDE LEASE BOUNDARY ARE APPROXIMATED FROM TEXAS RAILROAD COMMISSION DATA.
5. DOWNHOLE INFORMATION PROVIDED BY THE CLIENT.
6. THE UNDERSIGNED, DO HEREBY CERTIFY THAT THE SURVEY INFORMATION FOUND ON THIS PLAT WAS DERIVED FROM ACTUAL FIELD NOTES OF ON-THE-GROUND SURVEYS MADE BY ME OR UNDER MY SUPERVISION AND IS TRUE AND CORRECT TO THE BEST OF MY KNOWLEDGE AND BELIEF.

ORIGINALLY STAKED: 09-24-2014
LATERAL UPDATE: 09-29-2014

REV: 1 JOB NO.: 14-01451 DRAWN BY: JTL

09-30-2014
DATE

SHEET 1 OF 1

SECTION 1
BLOCK 48
UNIVERSITY LAND
SURVEY

SECTION 5
BLOCK 43
UNIVERSITY LAND
SURVEY

11H LTP & BHL
N:10376705.70
E:1997266.46
LAT:31°07'55.0088"
LON:-101°17'24.1489"
LAT:31.13194690
LON:-101.29004135
NAD 83, US TX
CENTRAL ZONE

DEVON ENERGY PRODUCTION COMPANY, L.P.
UNIVERSITY 45-13 #11H
BOTTOM HOLE LOCATION: ST01
TERMINUS 15296.00' MD / 5.70' TVD
CLOSURE: 8810.93' @ 5.70° AZI.
N 8767.30' E 875.73'

SECTION 10
BLOCK 48
UNIVERSITY LAND
SURVEY

SECTION 6
BLOCK 43
UNIVERSITY LAND
SURVEY

SECTION 7
BLOCK 43
UNIVERSITY LAND
SURVEY

DEVON ENERGY PRODUCTION COMPANY, L.P.
UNIVERSITY 45-13 #11H
BOTTOM HOLE LOCATION: OH
TERMINUS 10195.00' MD / 6712.50' TVD
CLOSURE: 3788.53' @ 13.49° AZI.
N 3683.99' E 883.84'

LINE	BEARING	DISTANCE
L1	S 89°50'29" E	866.74'
L2	N 00°09'31" E	8670.08'

SECTION 11
BLOCK 48
UNIVERSITY LAND
SURVEY

11H SHL
N:10367938.05
E:1998375.46
ELEV:2652
LAT:31°06'28.1537"
LON:-101°17'33.5309"
LAT:31.10782046
LON:-101.29264747
NAD 83, US TX
CENTRAL ZONE

(674.2 ACRES)
UNIVERSITY LEASE
#109832

11H PP & FTP
N:10367935.65
E:1997242.20
LAT:31°06'28.2038"
LON:-101°17'23.5604"
LAT:31.10783438
LON:-101.28987788
NAD 83, US TX
CENTRAL ZONE

SECTION 14
BLOCK 43
UNIVERSITY LAND
SURVEY

SECTION 20
BLOCK 48
UNIVERSITY LAND
SURVEY

SECTION 16
BLOCK 43
UNIVERSITY LAND
SURVEY

SECTION 17
BLOCK 43
UNIVERSITY LAND
SURVEY

111 Austin St., Mason, Texas 76856
(877) 347-6883
TX FIRM REG. #100248-00
www.crosstexaslandservices.com

SHL SURFACE HOLE LOCATION
PP- PENETRATION POINT
FTP FIRST TAKE POINT
LTP LAST TAKE POINT
BHL BOTTOM HOLE LOCATION
RRR RAILROAD COMMISSION

LEGEND

POINT PROPOSED WELL LOCATION SET EXISTING WELLHEAD SURFACE LOCATION OBTAINED FROM RRC

SURVEY LINE
SUBJECT PROPOSED LATERAL
PROPOSED LATERAL
ABANDONED LATERAL

LEASE BOUNDARY

UNLEASED AREA

