

| | | | | | | | |
|---|--|--|---|--|--|---|--|
| API No. <u>42-383-37800</u> Drilling Permit # <u>739176</u> SWR Exception Case/Docket No. _____ | | RAILROAD COMMISSION OF TEXAS OIL & GAS DIVISION APPLICATION FOR PERMIT TO DRILL, RECOMPLETE, OR RE-ENTER <i>This facsimile W-1 was generated electronically from data submitted to the RRC.</i> <i>A certification of the automated data is available in the RRC's Austin office.</i> | | | | FORM W-1 Permit Status: Approved | |
| 1. RRC Operator No. <div style="text-align: center;">252014</div> | | 2. Operator's Name (as shown on form P-5, Organization Report) <div style="text-align: center;">ENDURING RESOURCES, LLC</div> | | | 3. Operator Address (include street, city, state, zip) <div style="text-align: center;">511 16TH STREET SUITE 700 DENVER, CO 80202-4248</div> | | |
| 4. Lease Name <div style="text-align: center;">UNIVERSITY 09</div> | | | 5. Well No. <div style="text-align: center;">1803H</div> | | | | |
| GENERAL INFORMATION | | | | | | | |
| 6. Purpose of filing (mark ALL appropriate boxes): <div style="display: flex; justify-content: space-between; margin-top: 5px;"> <input checked="" type="checkbox"/> New Drill <input type="checkbox"/> Recompletion <input type="checkbox"/> Reclass <input type="checkbox"/> Field Transfer <input type="checkbox"/> Re-Enter </div> <div style="display: flex; justify-content: space-between; margin-top: 5px;"> <input checked="" type="checkbox"/> Amended <input type="checkbox"/> Amended as Drilled (BHL)(Also File Form W-1D) </div> | | | | | | | |
| 7. Wellbore Profile (mark ALL appropriate boxes): <div style="display: flex; justify-content: space-between; margin-top: 5px;"> <input type="checkbox"/> Vertical <input checked="" type="checkbox"/> Horizontal (Also File Form W-1H) <input type="checkbox"/> Directional (Also File Form W-1D) <input type="checkbox"/> Sidetrack </div> | | | | | | | |
| 8. Total Depth <div style="text-align: center;">8601</div> | | 9. Do you have the right to develop the minerals under any right-of-way? <input checked="" type="checkbox"/> Yes <input type="checkbox"/> No | | 10. Is this well subject to Statewide Rule 36 (hydrogen sulfide area)? <input type="checkbox"/> Yes <input checked="" type="checkbox"/> No | | | |
| SURFACE LOCATION AND ACREAGE INFORMATION | | | | | | | |
| 11. RRC District No. <div style="text-align: center;">7C</div> | | 12. County <div style="text-align: center;">REAGAN</div> | | 13. Surface Location <div style="display: flex; justify-content: space-between; margin-top: 5px;"> <input checked="" type="checkbox"/> Land <input type="checkbox"/> Bay/Estuary <input type="checkbox"/> Inland Waterway <input type="checkbox"/> Offshore </div> | | | |
| 14. This well is to be located <u>10.15</u> miles in a <u>NW</u> direction from <u>BIG LAKE</u> which is the nearest town in the county of the well site. | | | | | | | |
| 15. Section <div style="text-align: center;">18</div> | 16. Block <div style="text-align: center;">09</div> | 17. Survey <div style="text-align: center;">UL</div> | 18. Abstract No. | 19. Distance to nearest lease line: <u>100.0</u> ft. | 20. Number of contiguous acres in lease, pooled unit, or unitized tract: <u>4522.28</u> | | |
| 21. Lease Perpendiculars: <u>6268.3</u> ft. from the <u>SOUTH</u> line and <u>2269.5</u> ft. from the <u>EAST</u> line. | | | | | | | |
| 22. Survey Perpendiculars: <u>2269.5</u> ft. from the <u>EAST</u> line and <u>1728.6</u> ft. from the <u>NORTH</u> line. | | | | | | | |
| 23. Is this a pooled unit? <input checked="" type="checkbox"/> Yes <input type="checkbox"/> No | | 24. Unitization Docket No: | | 25. Are you applying for Substandard Acreage Field? <input type="checkbox"/> Yes (attach Form W-1A) <input checked="" type="checkbox"/> No | | | |
| FIELD INFORMATION List all fields of anticipated completion including Wildcat. List one zone per line. | | | | | | | |
| 26. RRC District No. <div style="text-align: center;">7C</div> | 27. Field No. <div style="text-align: center;">53613750</div> | 28. Field Name (exactly as shown in RRC records) <div style="text-align: center;">LIN (WOLFCAMP)</div> | 29. Well Type <div style="text-align: center;">Oil or Gas Well</div> | 30. Completion Depth <div style="text-align: center;">8101</div> | 31. Distance to Nearest Well in this Reservoir <div style="text-align: center;">330.0</div> | 32. Number of Wells on this lease in this Reservoir <div style="text-align: center;">3</div> | |
| BOTTOMHOLE LOCATION INFORMATION is required for DIRECTIONAL, HORIZONTAL, AND AMENDED AS DRILLED PERMIT APPLICATIONS | | | | | | | |
| Remarks [FILER 10/22/2013 08:10:57 AM]: Moved SHL so plat can be converted to a 3-well pad from a one-well pad. Also, pooled unit area has increased 4522.285 acres.; [RRC STAFF 10/28/2013 11:43:44 AM]: Corrected well count to match original permit.; | | | | Certificate: I certify that information stated in this application is true and complete, to the best of my knowledge <div style="display: flex; justify-content: space-between;"> <div> RRC User Name of filer _____ Phone _____ </div> <div> 10/22/2013 Date Submitted _____ Email Address(OPTIONAL) _____ </div> </div> | | | |
| RRC Use Only Date Validation Time Stamp: Wed, 30 Oct 2013 07:15:08 | | | | | | | |

RAILROAD COMMISSION OF TEXAS

FORM W-1H

Permit Status: Approved

The RRC has not approved this application. Duplication or distribution of information is at the user's own risk.

OIL & GAS DIVISION

APPLICATION FOR PERMIT TO DRILL, RECOMPLETE, OR RE-

*This facsimile W-1 was generated electronically from data submitted to the RRC.
A certification of the automated data is available in the RRC's Austin office.*

Supplemental Horizontal Well Information

Permit # 739176
Approved Date: 10/29/2013

| | | | |
|---|---|--------------------------------|--|
| 1. RRC Operator No. 252014 | 2. Operator's Name (as shown on form P-5, Organization Report) ENDURING RESOURCES, LLC | 3. Lease Name UNIVERSITY 09 | 4 Well No. 1803H |
| Lateral Drainhole Location Information | | | |
| 5. Field as shown on Form W-1 LIN (WOLFCAMP) (Field # 53613750, RRC District 7C) | | | |
| 6. Section 19 | 7. Block 09 | 8. Survey UL | 9. Abstract 10. County of BHL REAGAN |
| 11. Terminus Lease Line Perpendiculars 100.0 ft. from the SOUTH line and 2309.4 ft. from the EAST line | | | |
| 12. Terminus Survey Line Perpendiculars 2566.0 ft. from the NORTH line and 2309.4 ft. from the EAST line | | | |
| 13. Penetration Point Lease Line Perpendiculars 5993.3 ft. from the SOUTH line and 2309.2 ft. from the EAST line | | | |

**RAILROAD COMMISSION OF TEXAS
OIL & GAS DIVISION**

PERMIT TO DRILL, DEEPEN, PLUG BACK, OR RE-ENTER ON A REGULAR OR ADMINISTRATIVE EXCEPTION LOCATION

| | | | |
|---|---|---|---|
| PERMIT NUMBER <div align="center">739176</div> | DATE PERMIT ISSUED OR AMENDED (AMENDED) Oct 29, 2013 | DISTRICT <div align="center">* 7C</div> | |
| API NUMBER <div align="center">42-383-37800</div> | FORM W-1 RECEIVED <div align="center">Oct 22, 2013</div> | COUNTY <div align="center">REAGAN</div> | |
| TYPE OF OPERATION <div align="center">NEW DRILL</div> | WELLBORE PROFILE(S) <div align="center">Horizontal</div> | ACRES <div align="center">4522.28</div> | |
| OPERATOR <div align="center">ENDURING RESOURCES, LLC</div> | | 252014 | NOTICE This permit and any allowable assigned may be revoked if payment for fee(s) submitted to the Commission is not honored. District Office Telephone No: <div align="center">(325) 657-7450</div> |
| LEASE NAME <div align="center">UNIVERSITY 09</div> | | WELL NUMBER <div align="center">1803H</div> | |
| LOCATION <div align="center">10.15 miles NW direction from BIG LAKE</div> | | TOTAL DEPTH <div align="center">8601</div> | |
| Section, Block and/or Survey SECTION 18 BLOCK 09 ABSTRACT SURVEY UL | | | |
| DISTANCE TO SURVEY LINES <div align="center">2269.5 ft. EAST 1728.6 ft. NORTH</div> | | DISTANCE TO NEAREST LEASE LINE <div align="center">100 ft.</div> | |
| DISTANCE TO LEASE LINES <div align="center">6268.3 ft. SOUTH 2269.5 ft. EAST</div> | | DISTANCE TO NEAREST WELL ON LEASE <div align="center">See FIELD(s) Below</div> | |
| FIELD(s) and LIMITATIONS: <div align="center">* SEE FIELD DISTRICT FOR REPORTING PURPOSES *</div> | | | |
| FIELD NAME LEASE NAME | | ACRES NEAREST LEASE | DEPTH NEAREST WE |
| ----- LIN (WOLFCAMP) <div align="center">UNIVERSITY 09</div> ----- | | <div align="center">4522.28</div> <div align="center">100</div> | <div align="center">8,101</div> <div align="center">330</div> |
| ----- WELLBORE PROFILE(s) FOR FIELD: Horizontal ----- | | | |
| RESTRICTIONS: Lateral: TH1 Penetration Point Location Lease Lines: 5993.3 F SOUTH L 2309.2 F EAST L Terminus Location BH County: REAGAN Section: 19 Block: 09 Abstract: Survey: UL Lease Lines: 100.0 F SOUTH L 2309.4 F EAST L Survey Lines: 2566.0 F NORTH L 2309.4 F EAST L | | | |
| <div align="center">THE FOLLOWING RESTRICTIONS APPLY TO ALL FIELDS</div> <p>This well shall be completed and produced in compliance with applicable special field or statewide spacing and density rules. If this well is to be used for brine mining, underground storage of liquid hydrocarbons in salt formations, or underground storage of gas in salt formations, a permit for that specific purpose must be obtained from Environmental Services prior to construction, including drilling, of the well in accordance with Statewide Rules 81, 95, and 97.</p> | | | |

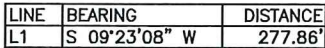

§ = APPROXIMATE SURVEY ABSTRACT LINE

ENDURING RESOURCES, L.L.C.
UNIVERSITY 09,
#1803H WELL
SURFACE HOLE LOCATION
X=1,612,111.68
Y=584,744.09
LAT= 31°16'07.29"
LON= 101°34'31.07"
SURFACE ELEVATION=2722.52

ENDURING RESOURCES, L.L.C.
UNIVERSITY 09,
#1803H WELL
PENETRATION POINT LOCATION

FINAL
ENDURING RESOURCES, L.L.C.
UNIVERSITY 09,
#1803H WELL
4522.285 ACRES
REAGAN COUNTY, TEXAS

PERCHERON
SURVEYING, L L C

15411 Vantage Pkwy West
Suite 205
Houston, Texas 77032
(281) 447-6230

OCTOBER 18, 2013
JOB NO. 140.0002.003