

FORM W-1 07/2004
 Permit Status: **Approved**

API No. 42-383-36649
 Drilling Permit # 690588
 SWR Exception Case/Docket No. _____
 1. RRC Operator No. 665748
 2. Operator's Name (as shown on form P-5, Organization Report) PIONEER NATURAL RES. USA, INC.
 3. Operator Address (include street, city, state, zip): _____
 4. Lease Name UNIVERSITY "2-23" 5. Well No. 2

GENERAL INFORMATION

6. Purpose of filing (mark ALL appropriate boxes):
 New Drill Recompletion Reclass Field Transfer Re-Enter
 Amended Amended as Drilled (BHL) (Also File Form W-1D)
 7. Wellbore Profile (mark ALL appropriate boxes):
 Vertical Horizontal (Also File Form W-1H) Directional (Also File Form W-1D) Sidetrack

8. Total Depth 10300
 9. Do you have the right to develop the minerals under any right-of-way? Yes No
 10. Is this well subject to Statewide Rule 36 (hydrogen sulfide area)? Yes No

SURFACE LOCATION AND ACREAGE INFORMATION

11. RRC District No. 7C 12. County REAGAN 13. Surface Location Land Bay/Estuary Inland Waterway Offshore
 14. This well is to be located 14.7 miles in a NW direction from Big Lake which is the nearest town in the county of the well site.

15. Section 23 16. Block 2 17. Survey UNIVERSITY LANDS
 18. Abstract No. A- 19. Distance to nearest lease line: 660 ft. 20. Number of contiguous acres in lease, pooled unit, or unitized tract: 329.5

21. Lease Perpendiculars: 660 ft from the SOUTH line and 1834 ft from the EAST line.
 22. Survey Perpendiculars: 660 ft from the S line and 860 ft from the WEST line.

23. Is this a pooled unit? Yes No 24. Unitization Docket No.: _____ 25. Are you applying for Substandard Acreage Field? Yes No (attach Form W-1A)

FIELD INFORMATION List all fields of anticipated completion including Wildcat. List one zone per line.

26. RRC District No.	27. Field No.	28. Field Name (exactly as shown in RRC records)	29. Well Type	30. Completion Depth	31. Distance to Nearest Well in this Reservoir	32. Number of Wells on this lease in this Reservoir
7C	85279200	SPRABERRY (TREND AREA)	Oil or Gas Well	10300	0.00	1

BOTTOMHOLE LOCATION INFORMATION is required for DIRECTIONAL, HORIZONTAL, AND AMENDED AS DRILLED PERMIT APPLICATIONS

Remarks

Certificate:
 I certify that information stated in this application is true and complete, to the best of my knowledge.
HEATHER BARCIA, ENGINEERING
TECH III
 Name of filer _____ Date submitted Feb 01, 2010
 Phone (972)9695711 E-mail Address (OPTIONAL) heather.barcia@pdx.com



Texas Commission
on Environmental Quality
Surface Casing Program

DEPTH OF USABLE-QUALITY GROUND WATER TO BE PROTECTED

Date **February 23, 2010**

TCEQ File No.: SC- **9512**

API Number **38336649**

Attention: **HEATHER BARCIA**

RRC Lease No. **000000**

SC_665748_38336649_000000_9512.pdf

**PIONEER NATURAL RESOURCES USA
5205 N O'CONNOR BLVD
IRVING TX 75039**

--Measured--

860 ft FWL

660 ft FSL

MRL:SECTION

P-5# 665748

Digital Map Location:	
X-coord/Long	1572689
Y-coord/Lat	586720
Datum	27
Zone	C

County **REAGAN**

Lease & Well No. **UNIVERSITY-2-23- #2**

Purpose **ND**

Location **SUR-UL, BLK-2, SEC-23, -- [TD=10300], [RRC 7C],**

To protect usable-quality ground water at this location, the Texas Commission on Environmental Quality recommends:

The interval from the land surface to a depth of 600 feet must be protected.

Note: Unless stated otherwise, this recommendation is intended to apply only to the subject well and not for area-wide use. Approval of the well completion methods for protection of this groundwater falls under the jurisdiction of the Railroad Commission of Texas. **This recommendation is intended for normal drilling, production, and plugging operations only. It does not apply to saltwater disposal operation into a nonproductive zone (RRC Form W-14).**

If you have any questions, please contact us at 512-239-0515, sc@tceq.state.tx.us, or by mail MC-151.

Sincerely,

Digitally signed by Jack M Oswalt
DN: c=US, st=Texas, l=Austin,
cn=Jack M Oswalt,
email=joswalt@tceq.state.tx.us
Date: 2010.02.23 08:14:34 -06'00'

GEOLOGIST SEAL

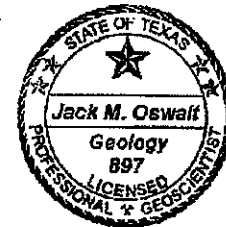

Jack M. Oswalt, P.G.

Geologist, Surface Casing Team
Waste Permits Division

The seal appearing on this document was authorized by *Jack M. Oswalt* on 2/23/2010
Note: Alteration of this electronic document will invalidate the digital signature.

Block 2, University Land

N 88°51'13" W 5386.01

27
(63) Fnd. Conc. Mon.

26 25
(62) (61)

22 23
(58) (59)

PIONEER NATURAL RESOURCES

24
(60)



S 1°14'05" W 5327.38

S 1°12'12" W 5328.73

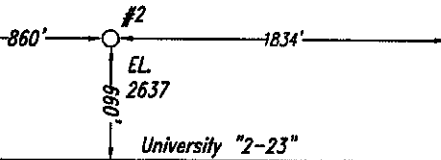

15
(51)

S 88°50'22" E 5388.93'

14 13
(50) (49)

Note: Survey Reconstruction filed in the Office of Luchini and Mertz Land Surveying Company.
 Note: All bearings and coordinates shown are based on the Texas Coordinate System of 1927, Central Zone.
 A combined grid factor of 0.999765054 must be divided into Section Line distances to obtain a true horizontal distance.
 Note: Example: (S-99999) indicates General Land Office file number.
 Note: NAD '27 Coordinates & Latitude/Longitude on well location in Section 22.
 Note: Well location is approximately 14.7 miles northwest of Big Lake.

#2

X: 1572688.77 Latitude- 31°15'40.933"N
 Y: 586720.30 Longitude- 101°42'03.561"W

Railroad Commission Permit Plat

PIONEER NATURAL RESOURCES USA, Inc.
 University "2-23" Lease
 W/2 of
 Section 23, Block 2,
 University Land,
 Reagan County, Texas

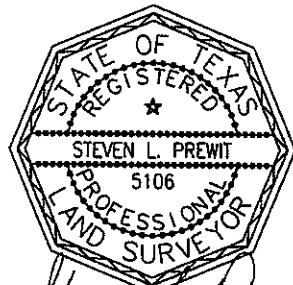

Steven L. Prewit

January 27, 2010

100127J2

