

OPERATOR: PDEH LLC

WELL LOCATION

LEASE NAME & WELL NO.:

UL 20 POPPIN CORK H #1672H

PSA ACREAGE:

1281.40 ACRES (CALLED)

NEAREST TOWN IN COUNTY:

±15.4 MILES EAST OF MENTONE, TEXAS

DESCRIPTION:

S.H.L./P.P./F.T.P.: SECTION 16, BLOCK 20, UNIVERSITY LAND SURVEY, LOVING COUNTY, TEXAS

L.T.P./B.H.L.: SECTION 21, BLOCK 20, UNIVERSITY LAND SURVEY, WINKLER COUNTY, TEXAS

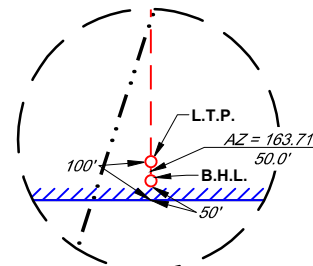
SCALE: 1" = 1000'
0' 500' 1000'

DETAIL VIEW

SCALE: 1" = 500'

TRACT 41
UL 104399
(CALLED 640.700 Ac)BLOCK 20
UNIVERSITY LAND
SURVEYTRACT 47
UL 104403
(CALLED 640.700 Ac)

TIES TABLE

POINT	PSA	SURVEY/SECTION
S.H.L.	300' FNWL 1400' FSWL	300' FNWL & 1400' FSWL
P.P. / F.T.P.	100' FNWL 1950' FSWL	100' FNWL & 1950' FSWL
L.T.P.	100' FSEL 1950' FSWL	100' FSEL & 1950' FSWL
B.H.L.	50' FSEL 1950' FSWL	50' FSEL & 1950' FSWL

PRODUCTIVE LATERAL

LENGTH (F.T.P. TO L.T.P.)	
41	5,188'
47	5,189'
TOTAL	10,377'

OWNERSHIP TABLE

#	MINERAL TRACT	ACREAGE
41	UL 104399	640.700
47	UL 104403	640.700
***	TOTAL ACREAGE	1281.40

LEGEND:

	PSA Boundary
	Approximate Location County Line
	Section Line
	Proposed Well Path
	Existing/Permitted Well Path
	Mineral Tract Boundary
	Monument Found
	Calculated Corner
	Well Point

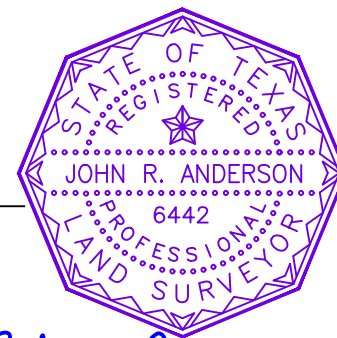
John R. Anderson 8/16/2024
John R. Anderson, R.P.L.S. No. 6442481 WINSOTT ROAD, Ste. 200 • BENBROOK, TEXAS 76126
TELEPHONE: (817) 744-7512 • FAX (817) 744-7554
TEXAS FIRM REGISTRATION NO. 10042504
WWW.TOPOGRAPHIC.COM

REVISION:

INT DATE

NOTES:

1. ORIGINAL DOCUMENT SIZE: 11" X 17"
2. ALL BEARINGS, DISTANCES, AND COORDINATE VALUES CONTAINED HEREIN ARE GRID BASED UPON THE TEXAS STATE PLANE COORDINATE SYSTEM, CENTRAL ZONE, U.S. SURVEY FEET, NORTH AMERICAN DATUM 1927, UNLESS OTHERWISE NOTED.
3. THIS LOCATION AND/OR UNIT/LEASE BOUNDARY HAS BEEN CAREFULLY SURVEYED ON THE GROUND UNDER MY SUPERVISION AND IS TRUE AND CORRECT TO THE BEST OF MY KNOWLEDGE ACCORDING TO THE EVIDENCE, OFFICIAL SURVEY RECORDS, MAPS, AND OTHER DATA PROVIDED BY PERMIAN DELAWARE ENTERPRISES HOLDINGS, LLC. THIS PLAT WAS CREATED FOR THE SOLE PURPOSE OF FILING A PERMIT WITH THE RAILROAD COMMISSION OF TEXAS AND SHOULD NOT BE CONSTRUED AS A "BOUNDARY SURVEY" IN COMPLIANCE WITH T.B.P.E.L.S. MINIMUM STANDARDS OF PROCEDURES FOR BOUNDARY SURVEYS. THIS CERTIFICATION IS MADE AND LIMITED TO THOSE PERSONS OR ENTITIES SHOWN ON THE FACE OF THIS PLAT AND IS NON-TRANSFERABLE. THIS SURVEY IS CERTIFIED FOR THIS TRANSACTION ONLY.
4. ALL ELEVATION VALUES CONTAINED HEREON ARE ORTHOMETRIC ONLY, BASED UPON THE NORTH AMERICAN VERTICAL DATUM OF 1988 (NAVD 88), U.S. SURVEY FEET.
5. ALL MINERAL OWNERSHIP DATA SHOWN HEREIN IS BASED ON INFORMATION PROVIDED BY PERMIAN DELAWARE ENTERPRISES HOLDINGS, LLC OR ITS SUBSIDIARIES & AFFILIATES.

NOTES CONT'D:

6. THE PRELIMINARY LOCATION HAS BEEN CAREFULLY SURVEYED ON THE GROUND DURING THE DATE OF JULY 9, 2024.
7. S.H.L. = SURFACE HOLE LOCATION
8. P.P. = POINT OF PENETRATION
9. F.T.P. = FIRST TAKE POINT
10. L.T.P. = LAST TAKE POINT
11. B.H.L. = BOTTOM HOLE LOCATION

UL-20-16 P2_CG2
UL 20 POPPIN CORK
H #1672H

DATE: 08/13/2024

FILE: LQ_UL-20-16 P2_CG2_UL_20_POPPIN_CORK_H_1672H

DRAWN BY: SAR

SHEET: 1 OF 1