



## **EOG Resources**

**Irion County, TX (NAD27 TC)**

**University 43 #1011H**

**University 43 #1011H**

**OH - Job #32D0512532**

**Survey: MWD**

## **SDI Standard Survey Report**

**08 June, 2012**



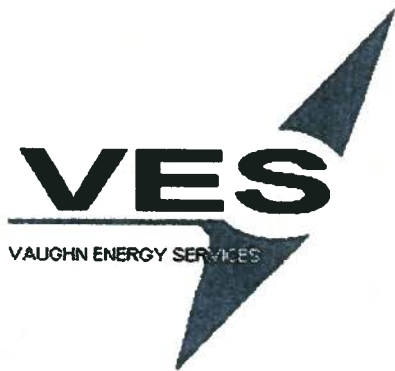

I Eric McMahon certify that I am employed by Vaughn Energy Services. That I did on the day(s) of 04/30/12 through 04/30/12 conduct or supervise the taking of a Rate Gyro survey from a depth of 0 feet to a depth of 700 feet; that the data is true, correct, complete and within the limitations of the tool as set forth by Vaughn Energy Services, that I am authorized and qualified to make this report; that this survey was conducted at the at the request of EOG Resources for the University 43 Well # 1011H API # 42-235-35000 in Irion County, Texas ; and that I have reviewed this report and find that it conforms to the principles and procedures as set forth by Vaughn Energy Services

Eric McMahon  
Service Technician  
Vaughn Energy Services



Tel: 432-689-5600 • Fax: 432-697-0324

I, DOUG BOWLING certify that; I am employed by Scientific Drilling International; that I did on the day(s) of 05/09/12 through 05/19/12 conduct or supervise the taking of a MWD survey from a depth of 882 feet to a depth of 14873 feet; that the data is true, correct, complete and within the limitations of the tool as set forth by Scientific Drilling International; that I am authorized and qualified to make this report; that this survey was conducted at the request of EOG RESOURCES for the UNIVERSITY 43 #1011H WELL, API# 42-235-35000 in IRION County, Texas; and that I have reviewed this report and find that it conforms to the principals and procedures as set forth by Scientific Drilling International.

Field Technician

<b>Company:</b>	EOG Resources	<b>Local Co-ordinate Reference:</b>	Well University 43 #1011H
<b>Project:</b>	Irion County, TX (NAD27 TC)	<b>TVD Reference:</b>	RF @ 2683.00usft (Patterson #452)
<b>Site:</b>	University 43 #1011H	<b>MD Reference:</b>	RF @ 2683.00usft (Patterson #452)
<b>Well:</b>	University 43 #1011H	<b>North Reference:</b>	Grid
<b>Wellbore:</b>	OH - Job #32D0512532	<b>Survey Calculation Method:</b>	Minimum Curvature
<b>Design:</b>	Actual	<b>Database:</b>	EDM-Regulatory

<b>Project</b>	Irion County, TX (NAD27 TC)		
<b>Map System:</b>	US State Plane 1927 (Exact solution)	<b>System Datum:</b>	Mean Sea Level
<b>Geo Datum:</b>	NAD 1927 (NADCON CONUS)		
<b>Map Zone:</b>	Texas Central 4203		

<b>Site</b>	University 43 #1011H		
<b>Site Position:</b>		<b>Northing:</b>	530,947.00 usft
<b>From:</b>	Map	<b>Easting:</b>	1,720,077.00 usft
<b>Position Uncertainty:</b>	0.00 usft	<b>Slot Radius:</b>	13-3/16"
		<b>Latitude:</b>	31° 7' 24.538 N
		<b>Longitude:</b>	101° 13' 40.633 W
		<b>Grid Convergence:</b>	-0.46 °

<b>Well</b>	University 43 #1011H		
<b>Well Position</b>	+N/-S	0.00 usft	<b>Northing:</b> 530,947.00 usft
	+E/-W	0.00 usft	<b>Easting:</b> 1,720,077.00 usft
<b>Position Uncertainty</b>	0.00 usft	<b>Wellhead Elevation:</b>	usft
		<b>Latitude:</b>	31° 7' 24.538 N
		<b>Longitude:</b>	101° 13' 40.633 W
		<b>Ground Level:</b>	2,656.00 usft

<b>Wellbore</b>	OH - Job #32D0512532		
<b>Magnetics</b>	<b>Model Name</b>	<b>Sample Date</b>	<b>Declination (°)</b>
	IGRF2010	2012/05/13	6.28
			<b>Dip Angle (°)</b> 59.52
			<b>Field Strength (nT)</b> 48,098

<b>Design</b>	Actual		
<b>Audit Notes:</b>			
<b>Version:</b>	1.0	<b>Phase:</b>	ACTUAL
		<b>Tie On Depth:</b>	0.00
<b>Vertical Section:</b>	<b>Depth From (TVD) (usft)</b>	<b>+N/-S (usft)</b>	<b>+E/-W (usft)</b>
	0.00	0.00	0.00
			<b>Direction (°)</b> 356.86

<b>Survey Program</b>	<b>Date</b>	2012/05/19		
<b>From (usft)</b>	<b>To (usft)</b>	<b>Survey (Wellbore)</b>	<b>Tool Name</b>	<b>Description</b>
127.00	727.00	VES Gyro (OH - Job #32D0512532)	UNKNOWN	Unknown survey
882.00	14,920.00	MWD (OH - Job #32D0512532)	MWD	MWD - Standard ISCWSA

<b>Survey</b>							
<b>Measured Depth (usft)</b>	<b>Inclination (°)</b>	<b>Azimuth (°)</b>	<b>True Vertical Depth</b>	<b>North/South (usft)</b>	<b>East/West (usft)</b>	<b>Closure Azimuth (°)</b>	<b>Closure Distance (usft)</b>
727.00	1.11	273.60	726.95	3.73	-5.42	304.52	6.57
<b>Gyro Tie-in</b>							
882.00	0.70	229.20	881.93	3.20	-7.63	292.76	8.28
1,066.00	1.14	222.43	1,065.91	1.12	-9.72	276.55	9.78
1,257.00	1.06	212.94	1,256.87	-1.77	-11.96	261.59	12.09
1,448.00	1.06	207.76	1,447.84	-4.82	-13.74	250.69	14.56
1,639.00	0.97	215.67	1,638.81	-7.69	-15.51	243.62	17.31
1,830.00	0.97	227.27	1,829.78	-10.10	-17.64	240.20	20.33
2,021.00	1.06	224.19	2,020.75	-12.47	-20.06	238.14	23.62
2,211.00	1.14	227.27	2,210.72	-15.01	-22.67	236.50	27.19
2,402.00	0.97	228.15	2,401.68	-17.38	-25.27	235.49	30.67



<b>Company:</b>	EOG Resources	<b>Local Co-ordinate Reference:</b>	Well University 43 #1011H
<b>Project:</b>	Irion County, TX (NAD27 TC)	<b>TVD Reference:</b>	RF @ 2683.00usft (Patterson #452)
<b>Site:</b>	University 43 #1011H	<b>MD Reference:</b>	RF @ 2683.00usft (Patterson #452)
<b>Well:</b>	University 43 #1011H	<b>North Reference:</b>	Grid
<b>Wellbore:</b>	OH - Job #32D0512532	<b>Survey Calculation Method:</b>	Minimum Curvature
<b>Design:</b>	Actual	<b>Database:</b>	EDM-Regulatory

Survey							
Measured Depth (usft)	Inclination (°)	Azimuth (°)	True Vertical Depth	North/South (usft)	East/West (usft)	Closure Azimuth (°)	Closure Distance (usft)
2,593.00	1.14	275.61	2,592.66	-18.27	-28.37	237.22	33.74
2,784.00	0.35	311.03	2,783.64	-17.70	-30.70	240.03	35.44
2,975.00	0.09	171.72	2,974.64	-17.47	-31.12	240.69	35.68
3,165.00	0.62	6.84	3,164.63	-16.59	-30.97	241.82	35.14
3,356.00	0.88	333.00	3,355.62	-14.26	-31.52	245.65	34.59
3,547.00	0.79	320.96	3,546.60	-11.93	-33.01	250.13	35.10
3,738.00	0.70	12.29	3,737.58	-9.77	-33.59	253.79	34.98
3,929.00	0.18	29.43	3,928.58	-8.37	-33.20	255.85	34.23
4,120.00	0.62	80.67	4,119.57	-7.94	-32.03	256.08	33.00
4,310.00	0.70	64.32	4,309.56	-7.27	-29.97	256.37	30.84
4,501.00	0.53	45.60	4,500.55	-6.14	-28.29	257.74	28.95
4,692.00	0.53	59.31	4,691.54	-5.08	-26.90	259.31	27.37
4,883.00	0.18	121.10	4,882.54	-4.78	-25.88	259.53	26.32
5,074.00	1.85	207.49	5,073.50	-7.67	-27.05	254.17	28.11
5,265.00	1.14	209.49	5,264.44	-12.06	-29.40	247.70	31.78
5,456.00	0.53	213.73	5,455.42	-14.45	-30.83	244.89	34.05
5,647.00	0.18	167.50	5,646.41	-15.48	-31.26	243.66	34.88
5,838.00	0.09	63.53	5,837.41	-15.70	-31.06	243.18	34.80
6,028.00	0.18	38.30	6,027.41	-15.40	-30.74	243.39	34.38
6,073.00	0.35	24.06	6,072.41	-15.22	-30.64	243.58	34.21
6,116.00	0.62	11.67	6,115.41	-14.87	-30.54	244.03	33.97
6,148.00	2.99	336.87	6,147.39	-13.93	-30.83	245.68	33.83
6,180.00	7.47	333.97	6,179.25	-11.30	-32.07	250.60	34.00
6,212.00	12.93	335.90	6,210.73	-6.16	-34.45	259.87	34.99
6,244.00	17.15	336.78	6,241.63	1.45	-37.77	272.20	37.80
6,275.00	20.49	338.45	6,270.97	10.70	-41.57	284.44	42.92
6,307.00	23.83	338.10	6,300.60	21.91	-46.04	295.45	50.99
6,339.00	26.38	338.19	6,329.58	34.51	-51.09	304.04	61.65
6,371.00	29.37	337.48	6,357.86	48.36	-56.74	310.44	74.55
6,403.00	32.54	335.81	6,385.30	63.47	-63.27	315.09	89.62
6,434.00	35.17	335.29	6,411.04	79.19	-70.42	318.35	105.97
6,466.00	37.90	333.53	6,436.75	96.36	-78.66	320.78	124.39
6,498.00	40.54	332.28	6,461.54	114.37	-87.88	322.46	144.23
6,530.00	43.88	332.30	6,485.24	133.40	-97.87	323.73	165.45
6,562.00	47.84	332.39	6,507.52	153.74	-108.53	324.78	188.18
6,594.00	51.97	331.77	6,528.13	175.36	-119.99	325.62	212.48
6,625.00	56.01	331.95	6,546.35	197.47	-131.82	326.28	237.42
6,657.00	59.79	331.24	6,563.35	221.31	-144.71	326.82	264.42
6,689.00	63.58	332.12	6,578.52	246.10	-158.07	327.29	292.49
6,721.00	67.18	332.03	6,591.85	271.80	-171.69	327.72	321.49
6,753.00	71.40	332.30	6,603.17	298.26	-185.66	328.10	351.33
6,785.00	76.24	332.47	6,612.08	325.49	-199.90	328.44	381.97
6,816.00	81.07	332.39	6,618.18	352.42	-213.97	328.74	412.29
6,850.00	85.21	334.58	6,622.24	382.62	-229.03	329.10	445.93
6,945.00	89.16	335.81	6,626.90	468.74	-268.83	330.16	540.35

<b>Company:</b>	EOG Resources	<b>Local Co-ordinate Reference:</b>	Well University 43 #1011H
<b>Project:</b>	Irion County, TX (NAD27 TC)	<b>TVD Reference:</b>	RF @ 2683.00usft (Patterson #452)
<b>Site:</b>	University 43 #1011H	<b>MD Reference:</b>	RF @ 2683.00usft (Patterson #452)
<b>Well:</b>	University 43 #1011H	<b>North Reference:</b>	Grid
<b>Wellbore:</b>	OH - Job #32D0512532	<b>Survey Calculation Method:</b>	Minimum Curvature
<b>Design:</b>	Actual	<b>Database:</b>	EDM-Regulatory

Survey							
Measured Depth (usft)	Inclination (°)	Azimuth (°)	True Vertical Depth	North/South (usft)	East/West (usft)	Closure Azimuth (°)	Closure Distance (usft)
7,040.00	91.36	335.90	6,626.47	555.42	-307.68	331.01	634.95
7,136.00	90.13	338.80	6,625.22	644.00	-344.65	331.85	730.42
7,231.00	87.76	340.38	6,626.97	733.01	-377.77	332.73	824.63
7,326.00	89.60	344.07	6,629.16	823.43	-406.75	333.71	918.41
7,422.00	90.48	347.77	6,629.10	916.53	-430.10	334.86	1,012.43
7,517.00	90.40	348.29	6,628.37	1,009.46	-449.81	335.98	1,105.14
7,613.00	90.57	351.90	6,627.55	1,104.01	-466.32	337.10	1,198.45
7,708.00	88.90	354.01	6,627.99	1,198.28	-477.97	338.25	1,290.09
7,803.00	88.46	356.99	6,630.18	1,292.95	-485.42	339.42	1,381.07
7,899.00	88.64	0.25	6,632.61	1,388.88	-487.73	340.65	1,472.03
7,994.00	89.96	2.53	6,633.77	1,483.84	-485.42	341.88	1,561.22
8,090.00	91.71	2.79	6,632.37	1,579.72	-480.97	343.07	1,651.32
8,185.00	89.96	1.30	6,630.99	1,674.64	-477.58	344.08	1,741.41
8,280.00	88.29	1.04	6,632.44	1,769.61	-475.64	344.96	1,832.42
8,375.00	89.60	1.56	6,634.19	1,864.57	-473.49	345.75	1,923.75
8,471.00	89.16	2.00	6,635.23	1,960.51	-470.50	346.50	2,016.18
8,566.00	90.31	1.74	6,635.67	2,055.46	-467.40	347.19	2,107.93
8,662.00	88.72	0.51	6,636.48	2,151.43	-465.52	347.79	2,201.22
8,757.00	88.90	3.06	6,638.45	2,246.36	-462.56	348.36	2,293.49
8,852.00	89.34	0.77	6,639.91	2,341.29	-459.39	348.90	2,385.93
8,948.00	89.16	2.36	6,641.17	2,437.24	-456.77	349.39	2,479.67
9,043.00	90.75	3.59	6,641.24	2,532.11	-451.84	349.88	2,572.11
9,135.00	91.19	2.62	6,639.69	2,623.96	-446.85	350.34	2,661.74
9,228.00	92.07	2.09	6,637.04	2,716.84	-443.03	350.74	2,752.73
9,320.00	90.22	2.36	6,635.20	2,808.75	-439.46	351.11	2,842.92
9,412.00	88.29	1.48	6,636.40	2,900.68	-436.38	351.44	2,933.33
9,504.00	89.08	1.21	6,638.51	2,992.63	-434.22	351.74	3,023.97
9,596.00	90.22	2.27	6,639.07	3,084.59	-431.43	352.04	3,114.61
9,688.00	89.52	1.48	6,639.28	3,176.54	-428.42	352.32	3,205.30
9,780.00	89.25	358.23	6,640.27	3,268.52	-428.65	352.53	3,296.51
9,873.00	87.23	355.59	6,643.12	3,361.33	-433.66	352.65	3,389.19
9,965.00	87.85	358.58	6,647.07	3,453.11	-438.33	352.77	3,480.82
10,057.00	88.81	358.14	6,649.76	3,545.03	-440.96	352.91	3,572.35
10,152.00	87.58	357.52	6,652.75	3,639.92	-444.56	353.04	3,666.96
10,248.00	88.37	356.73	6,656.14	3,735.73	-449.37	353.14	3,762.66
10,343.00	88.20	358.93	6,658.98	3,830.62	-452.97	353.26	3,857.31
10,438.00	89.87	0.16	6,660.58	3,925.60	-453.72	353.41	3,951.73
10,534.00	91.01	359.02	6,659.85	4,021.59	-454.41	353.55	4,047.18
10,629.00	88.55	359.19	6,660.21	4,116.57	-455.89	353.68	4,141.74
10,724.00	89.60	359.30	6,661.74	4,211.55	-457.14	353.81	4,236.28
10,820.00	91.10	359.72	6,661.16	4,307.54	-457.96	353.93	4,331.81
10,915.00	87.23	358.31	6,662.54	4,402.49	-459.60	354.04	4,426.42
11,010.00	87.67	357.17	6,666.77	4,497.32	-463.34	354.12	4,521.13
11,106.00	88.72	359.19	6,669.79	4,593.22	-466.39	354.20	4,616.84

<b>Company:</b>	EOG Resources	<b>Local Co-ordinate Reference:</b>	Well University 43 #1011H
<b>Project:</b>	Irion County, TX (NAD27 TC)	<b>TVD Reference:</b>	RF @ 2683.00usft (Patterson #452)
<b>Site:</b>	University 43 #1011H	<b>MD Reference:</b>	RF @ 2683.00usft (Patterson #452)
<b>Well:</b>	University 43 #1011H	<b>North Reference:</b>	Grid
<b>Wellbore:</b>	OH - Job #32D0512532	<b>Survey Calculation Method:</b>	Minimum Curvature
<b>Design:</b>	Actual	<b>Database:</b>	EDM-Regulatory

Survey							
Measured Depth (usft)	Inclination (°)	Azimuth (°)	True Vertical Depth	North/South (usft)	East/West (usft)	Closure Azimuth (°)	Closure Distance (usft)
11,201.00	90.20	358.93	6,670.69	4,688.20	-467.94	354.30	4,711.50
11,296.00	87.76	359.02	6,672.38	4,783.16	-469.64	354.39	4,806.17
11,392.00	89.16	359.72	6,674.96	4,879.12	-470.70	354.49	4,901.77
11,487.00	91.45	1.21	6,674.45	4,974.11	-469.93	354.60	4,996.26
11,582.00	89.87	0.95	6,673.36	5,069.08	-468.14	354.72	5,090.65
11,678.00	90.57	0.16	6,672.99	5,165.07	-467.21	354.83	5,186.16
11,773.00	91.98	359.81	6,670.88	5,260.05	-467.23	354.92	5,280.76
11,869.00	89.60	359.54	6,669.55	5,356.03	-467.78	355.01	5,376.42
11,964.00	91.28	0.33	6,668.82	5,451.02	-467.88	355.09	5,471.07
12,059.00	88.20	359.89	6,669.26	5,546.01	-467.70	355.18	5,565.70
12,155.00	89.43	359.98	6,671.24	5,641.99	-467.81	355.26	5,661.35
12,250.00	88.37	0.77	6,673.06	5,736.97	-467.19	355.34	5,755.96
12,345.00	88.46	359.28	6,675.69	5,831.93	-467.15	355.42	5,850.61
12,441.00	90.66	0.42	6,676.43	5,927.92	-467.40	355.49	5,946.31
12,536.00	87.85	359.10	6,677.66	6,022.90	-467.80	355.56	6,041.04
12,631.00	89.16	359.63	6,680.14	6,117.86	-468.85	355.62	6,135.79
12,727.00	87.49	0.07	6,682.95	6,213.81	-469.10	355.68	6,231.49
12,822.00	88.46	0.07	6,686.31	6,308.75	-468.98	355.75	6,326.16
12,917.00	90.13	0.25	6,687.47	6,403.74	-468.72	355.81	6,420.87
13,013.00	87.49	359.28	6,689.47	6,499.71	-469.11	355.87	6,516.62
13,108.00	88.90	359.81	6,692.46	6,594.66	-469.87	355.92	6,611.37
13,204.00	86.88	0.25	6,695.99	6,690.59	-469.82	355.98	6,707.06
13,299.00	88.02	0.42	6,700.22	6,785.49	-469.26	356.04	6,801.69
13,394.00	89.16	0.77	6,702.56	6,880.45	-468.27	356.11	6,896.37
13,490.00	89.69	359.19	6,703.52	6,976.44	-468.31	356.16	6,992.14
13,585.00	89.69	356.03	6,704.04	7,071.35	-472.27	356.18	7,087.10
13,681.00	88.29	356.91	6,705.73	7,167.15	-478.18	356.18	7,183.08
13,776.00	89.69	359.72	6,707.40	7,262.08	-480.97	356.21	7,277.99
13,871.00	90.31	358.49	6,707.40	7,357.07	-482.46	356.25	7,372.87
13,967.00	91.01	0.25	6,706.30	7,453.05	-483.51	356.29	7,468.72
14,062.00	89.87	0.42	6,705.57	7,548.04	-482.96	356.34	7,563.48
14,158.00	91.28	359.54	6,704.60	7,644.04	-482.99	356.38	7,659.28
14,253.00	89.96	0.60	6,703.58	7,739.03	-482.87	356.43	7,754.08
14,348.00	91.89	1.21	6,702.04	7,834.00	-481.37	356.48	7,848.77
14,444.00	89.60	1.04	6,700.80	7,929.96	-479.49	356.54	7,944.45
14,539.00	90.92	1.04	6,700.36	8,024.95	-477.76	356.59	8,039.15
14,635.00	88.55	1.83	6,700.81	8,120.91	-475.36	356.65	8,134.81
14,730.00	89.87	1.65	6,702.12	8,215.85	-472.48	356.71	8,229.43
14,825.00	89.60	1.56	6,702.56	8,310.81	-469.82	356.76	8,324.08
14,873.00	90.57	0.69	6,702.49	8,358.80	-468.87	356.79	8,371.94
Last MWD Survey - PBHL-Univ 43 #1011H							
14,920.00	90.57	0.69	6,702.02	8,405.80	-468.31	356.81	8,418.83
Projection to Bit							



<b>Company:</b>	EOG Resources	<b>Local Co-ordinate Reference:</b>	Well University 43 #1011H
<b>Project:</b>	Irion County, TX (NAD27 TC)	<b>TVD Reference:</b>	RF @ 2683.00usft (Patterson #452)
<b>Site:</b>	University 43 #1011H	<b>MD Reference:</b>	RF @ 2683.00usft (Patterson #452)
<b>Well:</b>	University 43 #1011H	<b>North Reference:</b>	Grid
<b>Wellbore:</b>	OH - Job #32D0512532	<b>Survey Calculation Method:</b>	Minimum Curvature
<b>Design:</b>	Actual	<b>Database:</b>	EDM-Regulatory

Survey Annotations				
Measured Depth (usft)	Vertical Depth (usft)	Local Coordinates		Comment
		+N/-S (usft)	+E/-W (usft)	
727.00	726.95	3.73	-5.42	Gyro Tie-in
14,873.00	6,702.49	8,358.80	-468.87	Last MWD Survey
14,920.00	6,702.02	8,405.80	-468.31	Projection to Bit





To convert Magnetic North to Grid, Add 6.74°  
To convert True North to Grid, Add 0.46°

Azimuths to Grid North  
True North: 0.46°  
Magnetic North: 6.74°

Magnetic Field  
Strength: 48097.8nT  
Dip Angle: 59.52°  
Date: 05/13/2012  
Model: IGRF2010

University 43 #1011H  
Iron County, TX (NAD27 TC)  
Northing: (Y) 530947.00  
Easting: (X) 1720077.00  
Plan #2 vs Actual - 8-3/4" Hole

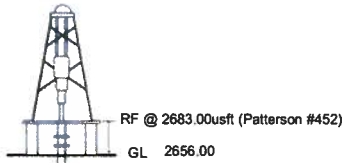

WELL DETAILS: University 43 #1011H						
+N/-S	+E/-W	Northing	Easting	Latitude	Longitude	Ground Level: 2656.00
0.00	0.00	530947.00	1720077.0031° 7'	24.538° N	101° 13' 40.633° W	

SECTION DETAILS										
Sec	MD	Inc	Azi	TVD	+N/-S	+E/-W	Dleg	TFace	VSec	Target
1	6073.00	0.35	24.06	6072.41	-15.22	-30.64	0.00	0.00	-13.50	
2	6150.00	0.35	24.06	6149.41	-14.79	-30.45	0.00	0.00	-13.08	
3	6893.95	89.50	331.85	6625.00	403.54	-251.70	12.00	-52.21	416.89	
4	7693.72	89.50	358.84	6632.13	1171.32	-445.31	3.50	90.131194.22		
5	14888.71	89.50	359.84	6695.00	8366.00	-465.00	0.00	0.008378.91		PBHL-Univ 43 #1011H

DESIGN TARGET DETAILS							
Name	TVD	+N/-S	+E/-W	Northing	Easting	Latitude	Longitude
PBHL-Univ 43 #1011H	6695.00	8366.00	-465.00	539313.00	1719612.0031° 8'	47.308° N	01° 13' 46.758° W
- plan hits target center							

SITE DETAILS: University 43 #1011H	
Site Centre Northing:	530947.00
Easting:	1720077.00
Positional Uncertainty:	0.00
Convergence:	-0.46
Local North:	Grid

PROJECT DETAILS: Iron County, TX (NAD27 TC)	
Geodetic System:	US State Plane 1927 (Exact solution)
Datum:	NAD 1927 (NADCON CONUS)
Ellipsoid:	Clarke 1866
Zone:	Texas Central 4203
System Datum:	Mean Sea Level

Julio C. Piña  
15:37, May 19 2012  
  
Scientific Drilling  
2034 Trade Drive  
Midland, TX 79703

LEGEND	
—	University 43 #1009H, OH, Plan #1 - 8-3/4" Hole V0
—	University 43 #1011H, OH - Job #32D0512532, MWD
—	University 43 #1011H, OH - Job #32D0512532, VES Gyro
—	Plan #2 - 8-3/4" Hole

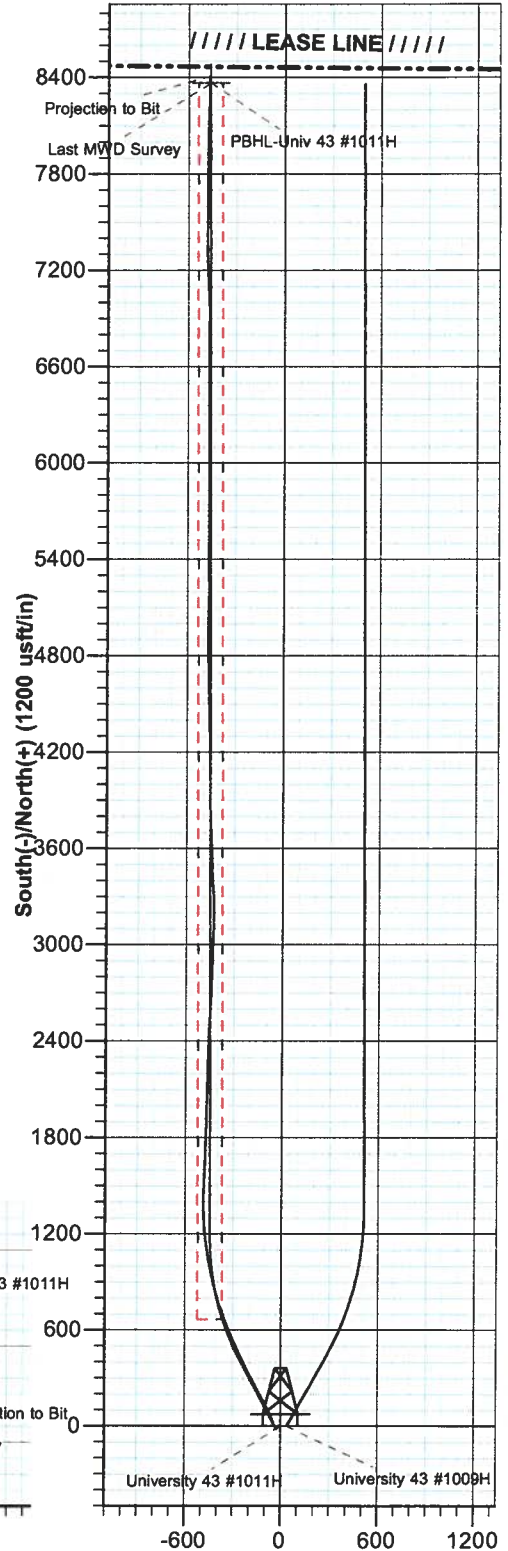
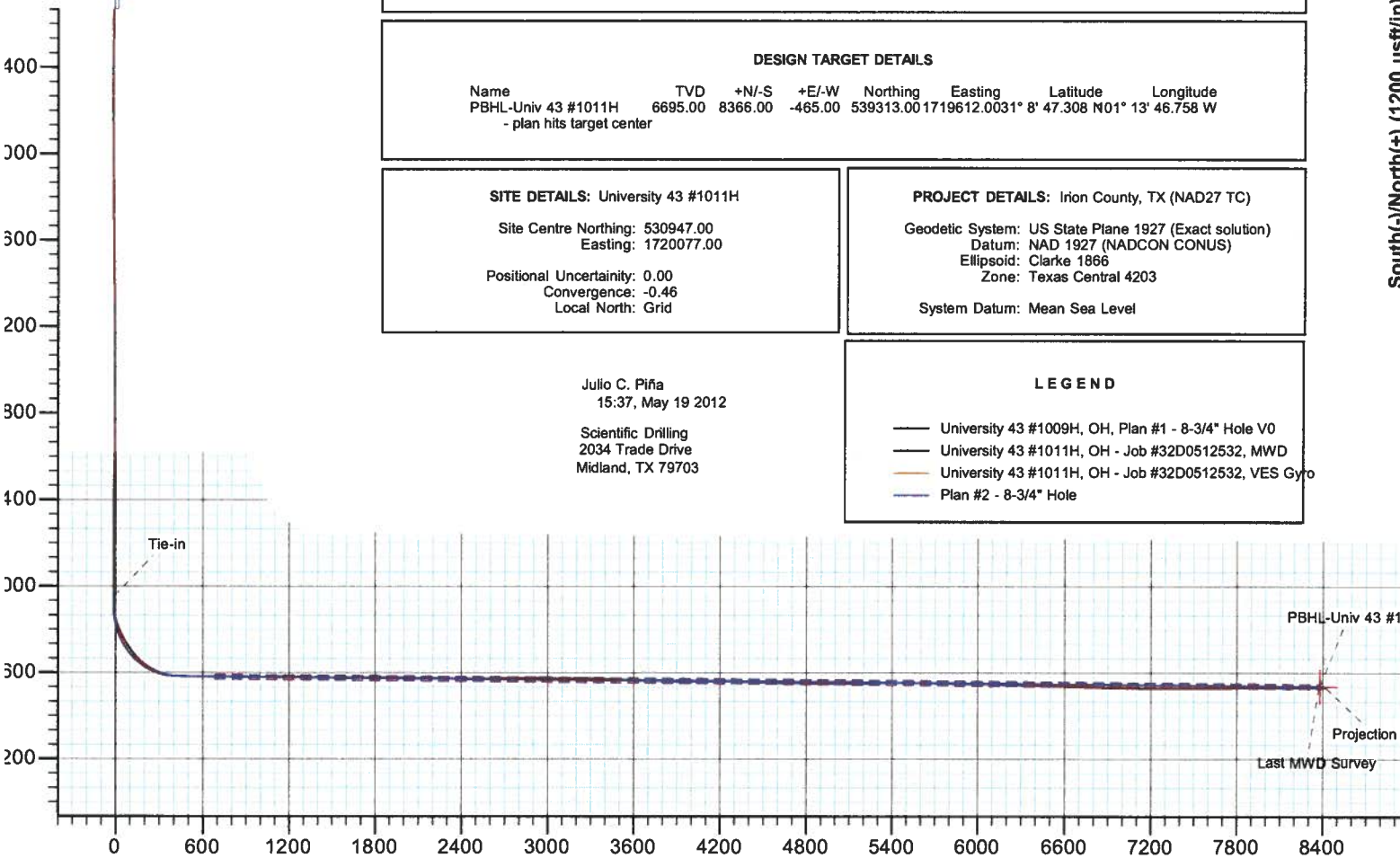



LEASE NAME & WELL NO.:

UNIVERSITY 43 #1011H

TOPOGRAPHY & VEGETATION:

NATURAL MESQUITE PASTURE

NEAREST TOWN IN COUNTY:

±3.1 MILES WEST OF BARNHART, TEXAS

DESCRIPTION:

SECTION 10, BLOCK 43, UNIVERSITY LAND  
IRION COUNTY, TEXAS

This location has been very carefully staked on the ground according to the best official survey records, maps, and other data available to us. This plat does not in any way represent a "Boundary Survey", and does not comply with correct T.B.P.L.S. Minimum Standards of Procedures for Boundary Surveys.

CERTIFICATION:



*William J. Keating*  
Texas Reg. No. 5041

I, William J. Keating, a Registered Professional Land Surveyor, and an authorized agent of Topographic Land Surveyors, do hereby certify that the above described well location was surveyed and staked on the ground as shown herein. This plat is for Texas Railroad Commission permitting only.

**TOPOGRAPHIC**  
SURVEYING • MAPPING • GIS • GPS

2903 N. BIG SPRING • MIDLAND, TEXAS 79705  
TELEPHONE: (432) 682-1653 (800) 767-1653 • FAX (432) 682-1743



LEGEND:

—X— Fence  
—E— Powerline  
—v— Water Line  
—\\— Pipeline  
== == Lease Road

Surface Hole Location:

2130' FSL & 963' FWL  
SHL Ground Elevation: 2656'  
X = 1720077 Y = 530947  
LAT.: N 31.1234828 LONG.: W 101.2279535  
NAD 83 TX-C ZONE  
X = 2016544 Y = 10373525  
LAT.: N 31.1236432 LONG.: W 101.2283454

Terminus Hole Location:

100' FNL & 476' FWL (SEC. 1)  
X = 1719612 Y = 539313  
LAT.: N 31.1464744 LONG.: W 101.2296550  
NAD 83 TX-C ZONE  
X = 2016079 Y = 10381891  
LAT.: N 31.1466340 LONG.: W 101.2300470

All Coordinates are in NAD 27 TX-C Zone unless otherwise noted.

ORIGINAL DOC. SIZE: 8.5"x14"

SCALE: 1" = 2000'  
DATE: MARCH 14, 2012  
COGO: IRION\_REAGAN\_CROCKETT\_SCHLEICHER/  
518-124590  
LO\_UNIVERSITY\_1011H\_ALT  
INVOICE #: 180916  
DRAWN BY: A.C.P.

