

UNIVERSITY 6-48D #104H	EASTING (X) (NAD 27)	NORTHING (Y) (NAD 27)	LATITUDE (NAD 27)	LONGITUDE (NAD 27)	SECTION LINE			LEASE LINE			SECTION
					FOOTAGE	FNL/FSL	FEL/FWL	FOOTAGE	FNL/FSL	FEL/FWL	
SURFACE HOLE LOCATION (SHL)	1403673.5	1009251.5	32.427178	-102.265566	518'	FSL	FWL	1821'	FSL	FWL	48
POINT OF PENETRATION (POP)	1403700.3	1009132.9	32.426854	-102.265472	397'	FSL	FWL	1819'	FSL	FWL	48
FIRST TAKE POINT (FTP)	1403814.1	1008617.7	32.425444	-102.265074	131'	FNL	FWL	1803'	FNL	FWL	6
LAST TAKE POINT (LTP)	1406325.1	998652.5	32.398181	-102.256382	153'	FSL	FWL	1809'	FSL	FWL	9
BOTTOM HOLE LOCATION (BHL)	1406335.6	998608.7	32.398062	-102.256345	108'	FSL	FWL	1809'	FSL	FWL	9

UNIVERSITY 6-48D #104H			LENGTH
TRACT 1 UNIVERSITY 7-6			5,152'
TRACT 2 UNIVERSITY 7-9			5,127'
TOTAL PRODUCTIVE LATERAL LENGTH			10,279'

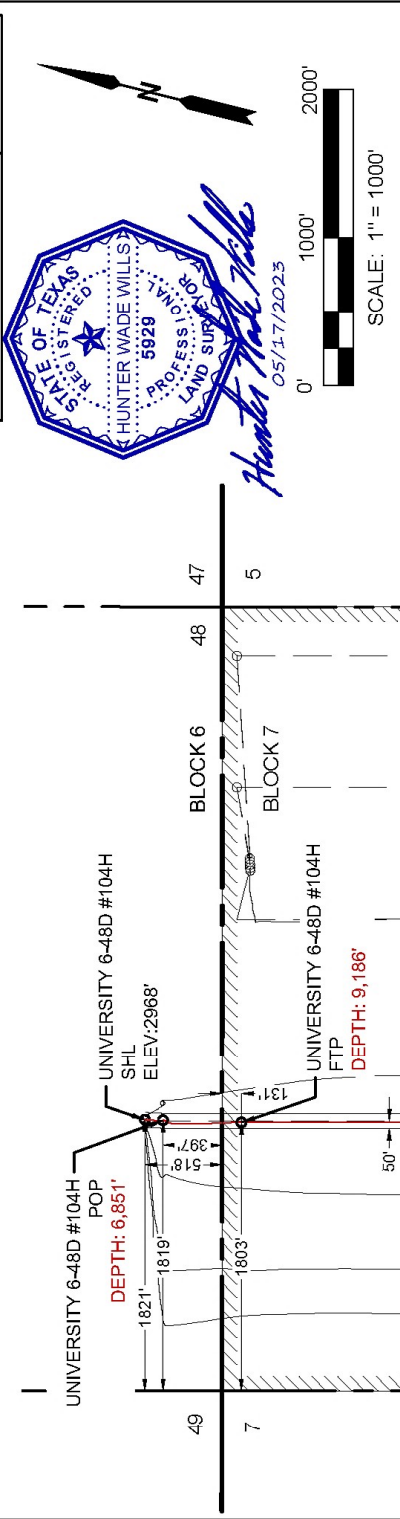

NOTE: WELL IS LOCATED APPROXIMATELY 18 MILES NORTHEAST OF ANDREWS, ANDREWS COUNTY, TEXAS



3300 NORTH A STREET, BUILDING 2, SUITE 120  
MIDLAND, TX 79705-0471  
TEL (432) 253-3255

TEPELS SURVEYING FIRM # 0193998  
DATE: 5/17/2023  
BY: J. B. S. 023  
A.V.O. 047474.237

LEGEND

- SECTION LINE
- BLOCK/TOWNSHIP LINE
- LEASE LINE
- SUBJECT AS-DRILLED LATERAL
- AS-DRILLED LATERAL
- PERMITTED LATERAL
- PROPOSED LATERAL
- PROPOSED WELL

NOTES:

- THE BASIS OF BEARING OF THE SURVEY IS THE TEXAS COORDINATE SYSTEM, NORTH AMERICAN DATUM 1927 (NAD 27), CENTRAL ZONE (4203).
- ALL TEXAS STATE PLANE COORDINATES AND GEOGRAPHIC COORDINATES SHOWN HEREON ARE NAD 27 GRID COORDINATES AS COMPUTED BY CORPSON VERSION 6.0.1. ALL GEOGRAPHIC COORDINATES SHOWN HEREON WERE CONVERTED USING CORPSON VERSION 6.0.1. UNLESS OTHERWISE NOTED, ALL DISTANCES SHOWN HEREON ARE GRID DISTANCES AND THEY CAN BE CONVERTED TO SURFACE WHEN MULTIPLIED WITH A "SURFACE ADJUSTMENT FACTOR" OF 1.000188348, AS CALCULATED BY CORPSON.
- ELEVATIONS SHOWN HEREON ARE NAVD88 AS DERIVED BY GPS.
- THIS EXHIBIT IS FOR TEXAS RAILROAD COMMISSION WELL PERMITTING PURPOSES ONLY. BOUNDARY LINES AND ACREAGE SHOWN HEREON REFLECT THE SURVEYOR'S PROFESSIONAL OPINION OF MINERAL RIGHTS AS DETERMINED FROM CLIENT-PROVIDED OIL AND GAS MINERAL LEASE DOCUMENTATION. THE INFORMATION DEPICTED HEREON SHALL NOT BE USED IN THE CONVEYANCE OF FEE TITLE TO REAL PROPERTY.
- ALL MEASUREMENTS TO LEASE UNIT, AND SURVEY LINES ARE PERPENDICULAR TO SAID LINES.
- THIS SURVEY WAS PREPARED WITHOUT THE BENEFIT OF A TITLE REPORT.
- THE AS-DRILLED DATA USED TO DEPICT THE WELL BORE PATH WAS PROVIDED BY OTHERS. NO WARRANTY IS EITHER EXPRESSED OR IMPLIED AS TO THE ACCURACY OR THE INFORMATION HEREIN.

PIONEER NATURAL RESOURCES  
USA, INC.

FINAL AS-DRILLED PLAT

UNIVERSITY 6-48D #104H  
  
UNIVERSITY 7-6 - 640.0± ACRES  
UNIVERSITY 7-9 - 640.0± ACRES  
TOTAL TRACT: 1,280.0± ACRES  
(SURFACE AREA)

LOCATED IN:  
SECTION 48, BLOCK 6,  
SECTION 6, BLOCK 7,  
SECTION 9, BLOCK 7,  
UNIVERSITY LANDS SURVEY,  
ANDREWS COUNTY, TEXAS