

7

8-10W H 6LS
SURFACE HOLE LOCATION
NG ELEVATION 3008'
GRID N: 6846396.22
GRID E: 786442.79
LAT: N32.390049
LONG: W102.330270

8-10W H 6LS
PP
461' FROM THE NORTH LEASE LINE
AND 528' FROM THE WEST
LEASE/SECTION LINE
2170' FROM NORTH SECTION LINE
GRID N: 6846346.68
GRID E: 786535.23
LAT: N32.389922
LONG: W102.329965

PIEDRA RESOURCES LLC ET AL
UL LEASE #110916

PIEDRA
ENERGY
III
LLC



10
LEASE LINE

8-10W H 6LS
FTP
100' FROM THE NORTH LEASE LINE
2539' FROM SOUTH SECTION LINE
AND 513' FROM THE WEST
LEASE/SECTION LINE
GRID N: 6845796.57
GRID E: 786647.81
LAT: N32.388422
LONG: W102.329535

PIEDRA ENERGY IV LLC
UL LEASE #38947

PIEDRA
ENERGY
III
LLC

PIEDRA ENERGY IV LLC
972.5 ACRES

PIEDRA
ENERGY
III
LLC

LEASE LINE

660' BOX WELL BORE 8-10W H 6LS

WELL BORE 8-10W H 6LS

660' BOX WELL BORE 8-10W H 6LS

PIEDRA ENERGY IV LLC
UL LEASE #38950

15

PIEDRA ENERGY III LLC
324 ACRES

LEASE LINE

PIEDRA ENERGY IV LLC
UL LEASE #38951

BHL
GRID N: 6838240.04
GRID E: 788352.83
LAT: N32.367836
LONG: W102.323125

8-10W H 6LS
LAST TAKE
100' FROM SOUTH AND
471' FROM WEST LEASE/SECTION LINE
GRID N: 6838264.97
GRID E: 788347.45
LAT: N32.367903
LONG: W102.323145

LEASE LINE

G&MMB&A
Block Number 40 T3N
SURVEY # 21
A-152

G&MMB&A
Block Number 40 T3N
SURVEY # 12
A-150

LEGEND:

--- SECTION LINE
--- BLOCK LINE
--- LEASE LINE

TOTAL ACREAGE IN LEASE 972.5 ACRES
BLOCK 8

324 ACRES UL S/2 SEC 10 LEASE #38947	BORE 2542 FEET
324.25 ACRES UL N/2 SEC 15 LEASE #38950	BORE 2641 FEET
324.25 ACRES UL S/2 SEC 16 LEASE #38951	BORE 2541 FEET
TOTAL	BORE 7724 FEET

GRAPHIC SCALE

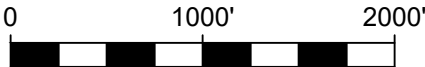

(IN FEET)
1 inch = 1000 ft.

NOTE:

COURSES, DISTANCES AND COORDINATES SHOWN HEREON ARE LAMBERT GRID AND CONFORM TO THE "TEXAS COORDINATE SYSTEM", TEXAS NORTH CENTRAL ZONE, NORTH AMERICAN DATUM OF 1983. ALL DISTANCES AND COORDINATES ARE SHOWN IN GRID FEET.

ELEVATION NAVD 1988



SCHUMANN
ENGINEERING CO.
A LATERAL LAND COMPANY

CIVIL ENGINEERING - LAND SURVEYING
TEXAS FIRM No. F1880 - TEXAS FIRM No. 10149500

800 N. MARLENFELD STREET
SUITE 100
MIDLAND, TEXAS 79701

Office (432) 684-5548

11TH
OCTOBER, 2022
RJ DAUM
TEXAS RPLS 4826

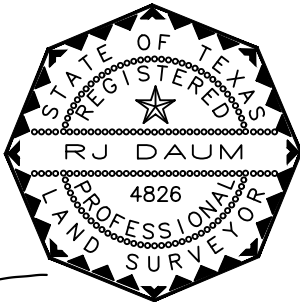

THIS WELL IS TO BE LOCATED 15.0 MILES IN A NORTHEAST DIRECTION FROM ANDREWS WHICH IS THE NEAREST TOWN IN THE COUNTY OF THE WELL SITE.

LOCATION PLAT

PIEDRA OPERATING, LLC.
AS DRILLED
WELL NO. H 6LS
UNIVERSITY 8-10W

SURFACE HOLE
2109 FEET FROM THE NORTH AND
449 FEET FROM THE WEST LINES,
SECTION 10, BLOCK 8,
BOTTOM HOLE
75 FEET FROM THE SOUTH AND
471 FEET FROM THE WEST LINES
SECTION 15, BLOCK 8,
UNIVERSITY LAND
ANDREWS COUNTY, TEXAS
QUAD: FIVE WELLS RANCH
SCALE: 1" = 1000'

PROJECT: 78329PO
JOB NO: 78,902