

# **Elevation Resources, LLC**

**Andrews County, TX**

**Sec 28, Blk 1**

**University 1-28A Unit #2H**

**Original Wellbore**

**Design: Original Wellbore**

## **Standard Survey Report**

**05 December, 2015**

## Survey Report

<b>Company:</b>	Elevation Resources, LLC	<b>Local Co-ordinate Reference:</b>	Well University 1-28A Unit #2H
<b>Project:</b>	Andrews County, TX	<b>TVD Reference:</b>	RKB @ 3166.00usft
<b>Site:</b>	Sec 28, Blk 1	<b>MD Reference:</b>	RKB @ 3166.00usft
<b>Well:</b>	University 1-28A Unit #2H	<b>North Reference:</b>	Grid
<b>Wellbore:</b>	Original Wellbore	<b>Survey Calculation Method:</b>	Minimum Curvature
<b>Design:</b>	Original Wellbore	<b>Database:</b>	EDM 5000.1 Single User Db

<b>Project</b>	Andrews County, TX		
<b>Map System:</b>	US State Plane 1927 (Exact solution)	<b>System Datum:</b>	Mean Sea Level
<b>Geo Datum:</b>	NAD 1927 (NADCON CONUS)		
<b>Map Zone:</b>	Texas North Central 4202		

<b>Site</b>	Sec 28, Blk 1		
<b>Site Position:</b>		<b>Northing:</b>	219,821.60 usft
<b>From:</b>	Map	<b>Easting:</b>	450,917.20 usft
<b>Position Uncertainty:</b>	0.00 usft	<b>Slot Radius:</b>	13-3/16 "
		<b>Latitude:</b>	32° 10' 9.775 N
		<b>Longitude:</b>	102° 30' 28.232 W
		<b>Grid Convergence:</b>	-2.73 °

<b>Well</b>	University 1-28A Unit #2H		
<b>Well Position</b>	<b>+N-S</b>	0.00 usft	<b>Northing:</b> 219,821.60 usft
	<b>+E-W</b>	0.00 usft	<b>Easting:</b> 450,917.20 usft
<b>Position Uncertainty</b>	0.00 usft	<b>Wellhead Elevation:</b>	3,141.00 usft
		<b>Latitude:</b>	32° 10' 9.775 N
		<b>Longitude:</b>	102° 30' 28.232 W
		<b>Ground Level:</b>	3,141.00 usft

<b>Wellbore</b>	Original Wellbore				
<b>Magnetics</b>	<b>Model Name</b>	<b>Sample Date</b>	<b>Declination (°)</b>	<b>Dip Angle (°)</b>	<b>Field Strength (nT)</b>
	IGRF2015	10/30/2015	6.62	60.20	48,185

<b>Design</b>	Original Wellbore				
<b>Audit Notes:</b>					
<b>Version:</b>	1.0	<b>Phase:</b>	ACTUAL	<b>Tie On Depth:</b>	0.00
<b>Vertical Section:</b>	<b>Depth From (TVD) (usft)</b>	<b>+N-S (usft)</b>	<b>+E-W (usft)</b>	<b>Direction (°)</b>	
	0.00	0.00	0.00	344.26	

<b>Survey Program</b>	<b>Date</b>	12/5/2015			
<b>From (usft)</b>	<b>To (usft)</b>	<b>Survey (Wellbore)</b>	<b>Tool Name</b>	<b>Description</b>	
93.84	1,564.00	Survey #1 (Original Wellbore)	GYRO-NS-CT	OWSG XYZ Accel with XY Static and Continuous	
1,695.00	17,212.00	Survey #2 (Original Wellbore)	MWD	OWSG MWD - Standard	

<b>Survey</b>										
<b>Measured Depth (usft)</b>	<b>Inclination (°)</b>	<b>Azimuth (°)</b>	<b>Vertical Depth (usft)</b>	<b>+N-S (usft)</b>	<b>+E-W (usft)</b>	<b>Vertical Section (usft)</b>	<b>Dogleg Rate (°/100usft)</b>	<b>Build Rate (°/100usft)</b>	<b>Turn Rate (°/100usft)</b>	
0.00	0.00	0.00	0.00	0.00	0.00	0.00	0.00	0.00	0.00	
93.84	0.96	323.25	93.84	0.63	-0.47	0.73	1.02	1.02	0.00	
190.00	0.60	31.16	189.99	1.71	-0.69	1.83	0.96	-0.37	70.62	
282.00	0.68	44.69	281.98	2.51	-0.06	2.43	0.19	0.09	14.71	
374.00	0.24	160.09	373.98	2.71	0.39	2.51	0.88	-0.48	125.43	
466.00	0.63	280.83	465.98	2.63	-0.04	2.54	0.85	0.42	131.24	
560.00	0.86	297.73	559.97	3.05	-1.17	3.26	0.34	0.24	17.98	
654.00	0.99	309.89	653.96	3.90	-2.42	4.41	0.25	0.14	12.94	
748.00	0.93	309.70	747.95	4.91	-3.63	5.71	0.06	-0.06	-0.20	
843.00	0.87	325.55	842.93	6.00	-4.63	7.03	0.27	-0.06	16.68	

## Survey Report

<b>Company:</b>	Elevation Resources, LLC	<b>Local Co-ordinate Reference:</b>	Well University 1-28A Unit #2H
<b>Project:</b>	Andrews County, TX	<b>TVD Reference:</b>	RKB @ 3166.00usft
<b>Site:</b>	Sec 28, Blk 1	<b>MD Reference:</b>	RKB @ 3166.00usft
<b>Well:</b>	University 1-28A Unit #2H	<b>North Reference:</b>	Grid
<b>Wellbore:</b>	Original Wellbore	<b>Survey Calculation Method:</b>	Minimum Curvature
<b>Design:</b>	Original Wellbore	<b>Database:</b>	EDM 5000.1 Single User Db

### Survey

Measured Depth (usft)	Inclination (°)	Azimuth (°)	Vertical Depth (usft)	+N/-S (usft)	+E/-W (usft)	Vertical Section (usft)	Dogleg Rate (°/100usft)	Build Rate (°/100usft)	Turn Rate (°/100usft)
937.00	0.85	348.39	936.92	7.27	-5.17	8.40	0.36	-0.02	24.30
1,031.00	0.81	351.35	1,030.91	8.61	-5.42	9.75	0.06	-0.04	3.15
1,125.00	0.79	4.07	1,124.90	9.91	-5.47	11.02	0.19	-0.02	13.53
1,219.00	0.56	28.04	1,218.90	10.96	-5.21	11.96	0.38	-0.24	25.50
1,313.00	0.50	358.07	1,312.89	11.78	-5.01	12.69	0.30	-0.06	-31.88
1,407.00	0.64	356.31	1,406.89	12.71	-5.05	13.61	0.15	0.15	-1.87
1,501.00	0.52	14.33	1,500.88	13.65	-4.98	14.49	0.23	-0.13	19.17
1,564.00	0.58	12.11	1,563.88	14.24	-4.84	15.02	0.10	0.10	-3.52
<b>Tie-In to MS Gyro Survey @ 1564' MD</b>									
1,695.00	0.06	347.17	1,694.88	14.95	-4.72	15.67	0.40	-0.40	-19.04
2,165.00	0.93	72.67	2,164.86	16.33	-1.13	16.02	0.20	0.19	18.19
2,635.00	0.81	69.77	2,634.80	18.61	5.63	16.39	0.03	-0.03	-0.62
2,824.00	0.64	64.04	2,823.79	19.54	7.83	16.68	0.10	-0.09	-3.03
3,012.00	0.71	43.47	3,011.78	20.84	9.57	17.47	0.13	0.04	-10.94
3,199.00	0.74	41.61	3,198.76	22.59	11.17	18.71	0.02	0.02	-0.99
3,388.00	0.75	39.46	3,387.75	24.45	12.77	20.07	0.02	0.01	-1.14
3,576.00	0.73	28.71	3,575.73	26.46	14.13	21.63	0.07	-0.01	-5.72
3,764.00	0.40	31.45	3,763.72	28.07	15.04	22.93	0.18	-0.18	1.46
3,952.00	0.62	28.79	3,951.71	29.52	15.88	24.10	0.12	0.12	-1.41
4,140.00	0.75	33.14	4,139.70	31.44	17.04	25.64	0.07	0.07	2.31
4,328.00	0.50	41.88	4,327.69	33.08	18.26	26.89	0.14	-0.13	4.65
4,516.00	0.77	34.63	4,515.68	34.73	19.52	28.13	0.15	0.14	-3.86
4,705.00	0.64	43.40	4,704.66	36.54	20.97	29.48	0.09	-0.07	4.64
4,893.00	0.66	44.97	4,892.65	38.07	22.46	30.55	0.01	0.01	0.84
5,080.00	0.34	47.62	5,079.64	39.21	23.63	31.33	0.17	-0.17	1.42
5,268.00	0.20	354.33	5,267.64	39.91	24.01	31.90	0.14	-0.07	-28.35
5,456.00	0.23	31.95	5,455.64	40.56	24.18	32.48	0.08	0.02	20.01
5,645.00	0.18	49.17	5,644.64	41.07	24.60	32.86	0.04	-0.03	9.11
5,833.00	0.17	52.87	5,832.64	41.43	25.05	33.09	0.01	-0.01	1.97
6,022.00	0.18	68.19	6,021.64	41.71	25.55	33.22	0.03	0.01	8.11
6,210.00	0.23	9.00	6,209.64	42.20	25.88	33.59	0.11	0.03	-31.48
6,680.00	1.00	41.70	6,679.61	46.19	28.76	36.66	0.17	0.16	6.96
6,991.00	2.30	79.10	6,990.48	49.40	36.69	37.59	0.52	0.42	12.03
7,172.00	0.86	102.56	7,171.41	49.79	41.58	36.64	0.86	-0.80	12.96
7,361.00	0.40	235.28	7,360.40	49.10	42.42	35.75	0.62	-0.24	70.22
7,549.00	1.13	242.80	7,548.38	47.88	40.24	35.17	0.39	0.39	4.00
7,737.00	1.11	174.39	7,736.35	45.22	38.77	33.01	0.67	-0.01	-36.39
7,926.00	1.99	132.63	7,925.29	41.18	41.36	28.42	0.73	0.47	-22.10
8,020.00	1.74	178.81	8,019.24	38.65	42.59	25.64	1.58	-0.27	49.13
8,208.00	2.25	204.01	8,207.13	32.42	41.15	20.04	0.53	0.27	13.40
8,397.00	0.63	218.05	8,396.07	28.21	39.00	16.58	0.87	-0.86	7.43
8,585.00	0.66	230.06	8,584.05	26.70	37.53	15.52	0.07	0.02	6.39
8,772.00	0.56	235.37	8,771.04	25.49	35.95	14.79	0.06	-0.05	2.84

## Survey Report

<b>Company:</b>	Elevation Resources, LLC	<b>Local Co-ordinate Reference:</b>	Well University 1-28A Unit #2H
<b>Project:</b>	Andrews County, TX	<b>TVD Reference:</b>	RKB @ 3166.00usft
<b>Site:</b>	Sec 28, Blk 1	<b>MD Reference:</b>	RKB @ 3166.00usft
<b>Well:</b>	University 1-28A Unit #2H	<b>North Reference:</b>	Grid
<b>Wellbore:</b>	Original Wellbore	<b>Survey Calculation Method:</b>	Minimum Curvature
<b>Design:</b>	Original Wellbore	<b>Database:</b>	EDM 5000.1 Single User Db

### Survey

Measured Depth (usft)	Inclination (°)	Azimuth (°)	Vertical Depth (usft)	+N/-S (usft)	+E/-W (usft)	Vertical Section (usft)	Dogleg Rate (°/100usft)	Build Rate (°/100usft)	Turn Rate (°/100usft)
8,961.00	0.68	209.98	8,960.03	24.00	34.63	13.70	0.16	0.06	-13.43
9,149.00	0.68	210.04	9,148.02	22.06	33.52	12.15	0.00	0.00	0.03
9,338.00	0.86	200.56	9,337.00	19.77	32.46	10.22	0.12	0.10	-5.02
9,526.00	0.79	198.93	9,524.98	17.22	31.54	8.02	0.04	-0.04	-0.87
9,714.00	1.33	240.61	9,712.95	14.92	29.22	6.44	0.48	0.29	22.17
9,902.00	1.32	258.23	9,900.90	13.41	25.20	6.07	0.22	-0.01	9.37
10,090.00	2.52	298.68	10,088.80	14.95	19.45	9.11	0.93	0.64	21.52
10,278.00	3.65	322.85	10,276.53	21.71	12.21	17.58	0.90	0.60	12.86
10,466.00	1.40	309.46	10,464.34	27.94	6.82	25.04	1.23	-1.20	-7.12
10,560.00	0.89	266.08	10,558.32	28.62	5.21	26.13	1.03	-0.54	-46.15
10,621.00	0.92	283.95	10,619.32	28.70	4.26	26.47	0.46	0.05	29.30
10,652.00	3.29	323.05	10,650.29	29.47	3.48	27.42	8.52	7.65	126.13
10,684.00	6.72	331.07	10,682.17	31.85	2.03	30.10	10.91	10.72	25.06
10,715.00	10.18	335.82	10,712.83	35.93	0.03	34.58	11.38	11.16	15.32
10,747.00	13.55	335.31	10,744.14	41.92	-2.70	41.08	10.54	10.53	-1.59
10,778.00	16.07	335.62	10,774.11	49.13	-5.99	48.91	8.13	8.13	1.00
10,809.00	18.09	337.69	10,803.74	57.49	-9.59	57.94	6.80	6.52	6.68
10,840.00	21.16	338.83	10,832.93	67.16	-13.44	68.29	9.98	9.90	3.68
10,872.00	25.05	338.67	10,862.36	78.86	-17.99	80.79	12.16	12.16	-0.50
10,903.00	29.16	338.66	10,889.95	92.02	-23.12	94.84	13.26	13.26	-0.03
10,934.00	33.23	339.12	10,916.46	106.99	-28.90	110.82	13.15	13.13	1.48
10,966.00	37.39	339.89	10,942.57	124.32	-35.37	129.25	13.07	13.00	2.41
10,997.00	40.94	340.40	10,966.60	142.73	-42.02	148.78	11.50	11.45	1.65
11,028.00	44.20	340.62	10,989.43	162.50	-49.01	169.70	10.53	10.52	0.71
11,060.00	47.67	341.40	11,011.68	184.24	-56.49	192.65	10.98	10.84	2.44
11,091.00	50.92	342.10	11,031.90	206.55	-63.84	216.13	10.62	10.48	2.26
11,122.00	53.82	342.80	11,050.82	229.96	-71.24	240.66	9.52	9.35	2.26
11,153.00	57.20	343.31	11,068.37	254.40	-78.69	266.20	10.99	10.90	1.65
11,184.00	60.97	343.72	11,084.30	279.90	-86.23	292.79	12.21	12.16	1.32
11,216.00	64.47	344.05	11,098.96	307.22	-94.12	321.23	10.98	10.94	1.03
11,247.00	67.52	344.53	11,111.57	334.47	-101.79	349.54	9.94	9.84	1.55
11,278.00	69.81	344.90	11,122.85	362.33	-109.40	378.42	7.47	7.39	1.19
11,309.00	72.50	345.79	11,132.86	390.71	-116.82	407.75	9.09	8.68	2.87
11,341.00	75.93	345.99	11,141.56	420.57	-124.32	438.52	10.74	10.72	0.63
11,372.00	80.63	346.23	11,147.86	450.03	-131.61	468.85	15.18	15.16	0.77
11,398.00	80.15	347.98	11,152.20	475.01	-137.33	494.46	6.89	-1.85	6.73
11,438.00	81.50	348.01	11,158.58	513.64	-145.54	533.86	3.38	3.38	0.08
11,469.00	83.42	347.79	11,162.65	543.69	-151.98	564.53	6.23	6.19	-0.71
11,501.00	85.60	347.05	11,165.71	574.77	-158.92	596.33	7.19	6.81	-2.31
11,532.00	87.06	347.10	11,167.69	604.92	-165.84	627.23	4.71	4.71	0.16
11,563.00	88.68	347.72	11,168.84	635.16	-172.59	658.16	5.59	5.23	2.00
11,626.00	91.12	346.70	11,168.95	696.59	-186.54	721.07	4.20	3.87	-1.62
11,720.00	91.12	345.66	11,167.12	787.85	-208.99	815.00	1.11	0.00	-1.11

## Survey Report

<b>Company:</b>	Elevation Resources, LLC	<b>Local Co-ordinate Reference:</b>	Well University 1-28A Unit #2H
<b>Project:</b>	Andrews County, TX	<b>TVD Reference:</b>	RKB @ 3166.00usft
<b>Site:</b>	Sec 28, Blk 1	<b>MD Reference:</b>	RKB @ 3166.00usft
<b>Well:</b>	University 1-28A Unit #2H	<b>North Reference:</b>	Grid
<b>Wellbore:</b>	Original Wellbore	<b>Survey Calculation Method:</b>	Minimum Curvature
<b>Design:</b>	Original Wellbore	<b>Database:</b>	EDM 5000.1 Single User Db

### Survey

Measured Depth (usft)	Inclination (°)	Azimuth (°)	Vertical Depth (usft)	+N-S (usft)	+E-W (usft)	Vertical Section (usft)	Dogleg Rate (°/100usft)	Build Rate (°/100usft)	Turn Rate (°/100usft)
11,814.00	91.26	345.65	11,165.16	878.90	-232.27	908.95	0.15	0.15	-0.01
11,909.00	91.90	346.20	11,162.54	971.01	-255.37	1,003.87	0.89	0.67	0.58
12,003.00	91.26	344.05	11,159.95	1,061.82	-279.49	1,097.82	2.39	-0.68	-2.29
12,097.00	92.31	343.12	11,157.02	1,151.94	-306.04	1,191.77	1.49	1.12	-0.99
12,191.00	92.19	342.81	11,153.33	1,241.75	-333.55	1,285.67	0.35	-0.13	-0.33
12,285.00	92.31	342.34	11,149.64	1,331.36	-361.68	1,379.56	0.52	0.13	-0.50
12,379.00	92.13	343.11	11,146.00	1,421.06	-389.57	1,473.45	0.84	-0.19	0.82
12,473.00	92.08	343.57	11,142.55	1,511.05	-416.50	1,567.38	0.49	-0.05	0.49
12,568.00	91.23	343.11	11,139.81	1,602.02	-443.73	1,662.32	1.02	-0.89	-0.48
12,662.00	90.90	343.31	11,138.06	1,692.00	-470.88	1,756.29	0.41	-0.35	0.21
12,756.00	90.17	343.31	11,137.18	1,782.03	-497.87	1,850.27	0.78	-0.78	0.00
12,850.00	90.42	342.34	11,136.70	1,871.84	-525.63	1,944.24	1.07	0.27	-1.03
12,945.00	91.29	343.37	11,135.28	1,962.61	-553.63	2,039.20	1.42	0.92	1.08
13,039.00	90.87	343.37	11,133.51	2,052.66	-580.53	2,133.17	0.45	-0.45	0.00
13,133.00	90.76	344.64	11,132.17	2,143.01	-606.43	2,227.16	1.36	-0.12	1.35
13,227.00	90.67	345.40	11,131.00	2,233.81	-630.72	2,321.14	0.81	-0.10	0.81
13,322.00	91.15	345.45	11,129.49	2,325.74	-654.62	2,416.11	0.51	0.51	0.05
13,416.00	91.46	344.19	11,127.35	2,416.43	-679.23	2,510.08	1.38	0.33	-1.34
13,510.00	91.09	344.10	11,125.26	2,506.83	-704.91	2,604.06	0.41	-0.39	-0.10
13,604.00	91.15	343.62	11,123.42	2,597.11	-731.03	2,698.03	0.51	0.06	-0.51
13,699.00	91.94	344.12	11,120.86	2,688.34	-757.41	2,793.00	0.98	0.83	0.53
13,793.00	91.55	342.90	11,118.00	2,778.43	-784.08	2,886.94	1.36	-0.41	-1.30
13,887.00	91.46	343.09	11,115.53	2,868.29	-811.56	2,980.89	0.22	-0.10	0.20
13,981.00	91.29	342.74	11,113.27	2,958.11	-839.17	3,074.83	0.41	-0.18	-0.37
14,076.00	91.68	342.46	11,110.81	3,048.73	-867.57	3,169.76	0.51	0.41	-0.29
14,170.00	91.40	343.17	11,108.28	3,138.50	-895.33	3,263.70	0.81	-0.30	0.76
14,264.00	90.62	343.25	11,106.63	3,228.48	-922.48	3,357.67	0.83	-0.83	0.09
14,358.00	91.23	343.66	11,105.11	3,318.58	-949.25	3,451.64	0.78	0.65	0.44
14,452.00	91.40	343.80	11,102.95	3,408.79	-975.58	3,545.62	0.23	0.18	0.15
14,547.00	90.90	343.69	11,101.04	3,499.97	-1,002.16	3,640.59	0.54	-0.53	-0.12
14,641.00	91.46	343.66	11,099.11	3,590.16	-1,028.58	3,734.57	0.60	0.60	-0.03
14,750.00	91.93	343.71	11,095.88	3,694.73	-1,059.19	3,843.51	0.43	0.43	0.05
14,844.00	91.96	344.30	11,092.69	3,785.04	-1,085.07	3,937.46	0.63	0.03	0.63
14,938.00	92.85	344.07	11,088.75	3,875.40	-1,110.67	4,031.37	0.98	0.95	-0.24
15,032.00	92.32	344.75	11,084.51	3,965.85	-1,135.90	4,125.28	0.92	-0.56	0.72
15,127.00	91.31	345.29	11,081.50	4,057.57	-1,160.45	4,220.22	1.21	-1.06	0.57
15,221.00	92.35	345.86	11,078.50	4,148.56	-1,183.85	4,314.15	1.26	1.11	0.61
15,315.00	92.02	346.31	11,074.92	4,239.73	-1,206.44	4,408.03	0.59	-0.35	0.48
15,409.00	90.98	346.63	11,072.45	4,331.09	-1,228.42	4,501.93	1.16	-1.11	0.34
15,503.00	91.26	346.35	11,070.62	4,422.47	-1,250.38	4,595.84	0.42	0.30	-0.30
15,598.00	92.13	346.59	11,067.81	4,514.80	-1,272.60	4,690.72	0.95	0.92	0.25
15,692.00	91.06	346.49	11,065.19	4,606.18	-1,294.47	4,784.61	1.14	-1.14	-0.11
15,786.00	91.48	347.10	11,063.11	4,697.67	-1,315.93	4,878.50	0.79	0.45	0.65
15,880.00	90.28	346.73	11,061.66	4,789.22	-1,337.21	4,972.38	1.34	-1.28	-0.39

## Survey Report

<b>Company:</b>	Elevation Resources, LLC	<b>Local Co-ordinate Reference:</b>	Well University 1-28A Unit #2H
<b>Project:</b>	Andrews County, TX	<b>TVD Reference:</b>	RKB @ 3166.00usft
<b>Site:</b>	Sec 28, Blk 1	<b>MD Reference:</b>	RKB @ 3166.00usft
<b>Well:</b>	University 1-28A Unit #2H	<b>North Reference:</b>	Grid
<b>Wellbore:</b>	Original Wellbore	<b>Survey Calculation Method:</b>	Minimum Curvature
<b>Design:</b>	Original Wellbore	<b>Database:</b>	EDM 5000.1 Single User Db

### Survey

Measured Depth (usft)	Inclination (°)	Azimuth (°)	Vertical Depth (usft)	+N/-S (usft)	+E/-W (usft)	Vertical Section (usft)	Dogleg Rate (°/100usft)	Build Rate (°/100usft)	Turn Rate (°/100usft)
15,974.00	91.23	347.11	11,060.43	4,880.77	-1,358.48	5,066.27	1.09	1.01	0.40
16,068.00	90.06	347.42	11,059.37	4,972.45	-1,379.20	5,160.13	1.29	-1.24	0.33
16,163.00	90.36	347.92	11,059.02	5,065.26	-1,399.49	5,254.97	0.61	0.32	0.53
16,257.00	90.87	347.91	11,058.01	5,157.17	-1,419.17	5,348.77	0.54	0.54	-0.01
16,351.00	92.04	348.29	11,055.62	5,249.12	-1,438.55	5,442.53	1.31	1.24	0.40
16,445.00	91.03	348.41	11,053.11	5,341.14	-1,457.52	5,536.25	1.08	-1.07	0.13
16,539.00	91.82	348.94	11,050.77	5,433.28	-1,475.97	5,629.94	1.01	0.84	0.56
16,634.00	91.15	348.60	11,048.31	5,526.43	-1,494.47	5,724.62	0.79	-0.71	-0.36
16,728.00	92.24	348.82	11,045.53	5,618.57	-1,512.86	5,818.29	1.18	1.16	0.23
16,822.00	91.90	348.61	11,042.13	5,710.70	-1,531.25	5,911.95	0.43	-0.36	-0.22
16,916.00	91.59	348.62	11,039.27	5,802.80	-1,549.79	6,005.63	0.33	-0.33	0.01
17,011.00	92.66	348.39	11,035.75	5,895.83	-1,568.71	6,100.30	1.15	1.13	-0.24
17,105.00	93.89	348.40	11,030.38	5,987.76	-1,587.59	6,193.90	1.31	1.31	0.01
17,165.00	94.93	348.79	11,025.76	6,046.40	-1,599.42	6,253.55	1.85	1.73	0.65
17,212.00	94.93	348.79	11,021.72	6,092.33	-1,608.52	6,300.23	0.00	0.00	0.00

**Straight Line Projection to Bit Depth @ 17212'MD**

### Design Annotations

Measured Depth (usft)	Vertical Depth (usft)	+N/-S (usft)	+E/-W (usft)	Comment
1,564.00	1,563.88	14.24	-4.84	Tie-In to MS Gyro Survey @ 1564'MD
17,212.00	11,021.72	6,092.33	-1,608.52	Straight Line Projection to Bit Depth @ 17212'MD

Checked By: _____	Approved By: _____	Date: _____
-------------------	--------------------	-------------



Company: Elevation Resources, LLC  
Field: Andrews County, TX  
Location: Sec 28, Blk 1  
Well: University 1-28A Unit #2H  
Original Wellbore  
Plan: Design #5  
RKB @ 3166.00usft



WELL DETAILS: University 1-28A Unit #2H

+N/-S	+E/-W	Northing	Ground Level: Easting	3141.00 Latitude	102° 30' 28.232 W Longitude	Slot
0.00	0.00	219821.60	450917.20	32° 10' 9.775 N	102° 30' 28.232 W	

SECTION DETAILS

Sec	MD	Inc	Azi	TVD	+N/-S	+E/-W	Dleg	TFace	VSect	Target	Annotation
1	10560.00	0.89	266.08	10558.32	28.62	5.21	0.00	0.00	26.13		Tie-In to MWD Survey @ 10560'MD
2	10619.33	0.00	0.00	10617.65	28.58	4.75	1.50	180.00	26.22		KOP 12°/100' @ 10678'MD
3	10678.21	0.00	0.00	10676.53	28.58	4.75	0.00	0.00	26.22		Land Curve @ 11428'MD
4	11428.21	90.00	344.15	11154.00	487.90	-125.66	12.00	344.15	503.69	BHL	Build 1.5°/100' @ 11524'MD
5	11524.53	90.00	344.15	11154.00	580.55	-151.96	0.00	0.00	600.00		Hold 90.81° Inc
6	11578.73	90.81	344.15	11153.61	632.69	-166.76	1.50	-0.01	654.20		Build 1.5°/100' @ 13524'MD
7	13524.73	90.81	344.15	11126.00	2504.51	-698.20	0.00	0.00	2600.00	WP1 (17Nov15)	Hold 90.86° Inc
8	13527.82	90.86	344.15	11125.95	2507.48	-699.04	1.50	0.63	2603.09		Build 1.5°/100' @ 14524'MD
9	14524.84	90.86	344.15	11111.00	3466.49	-971.31	0.00	0.00	3600.00	WP2 (17Nov15)	Hold 90.93° Inc
10	14529.34	90.93	344.15	11110.93	3470.82	-972.54	1.50	-0.40	3604.50		Well TD @ 17306'MD
11	17306.63	90.93	344.15	11066.00	6142.17	-1730.97	0.00	0.00	6381.42	BHL	

ANNOTATIONS

TVD	MD	Annotation
10558.32	10560.00	Tie-In to MWD Survey @ 10560'MD
10676.53	10678.21	KOP 12°/100' @ 10678'MD
11154.00	11428.21	Land Curve @ 11428'MD
11154.00	11524.53	Build 1.5°/100' @ 11524'MD
11153.61	11578.73	Hold 90.81° Inc
11126.00	13524.73	Build 1.5°/100' @ 13524'MD
11125.95	13527.82	Hold 90.86° Inc
11111.00	14524.84	Build 1.5°/100' @ 14524'MD
11110.93	14529.34	Hold 90.93° Inc
11066.00	17306.63	Well TD @ 17306'MD

PROJECT DETAILS: Andrews County, TX

Geodetic System: US State Plane 1927 (Exact solution)  
Datum: NAD 1927 (NADCON CONUS)  
Ellipsoid: Clarke 1866  
Zone: Texas North Central 4202  
System Datum: Mean Sea Level

FORMATION TOP DETAILS

TVDPath	MDPath	Formation
1905.00	1905.12	Rustler
3155.00	3155.23	Yates
4905.00	4905.35	Top San Andres
5700.00	5700.36	Base San Andres
6710.00	6710.40	Top Clearfork
8520.00	8520.94	Top Wolfcamp
10420.00	10421.64	Top Mississippian Lime
10710.00	10711.71	Top Woodford Shale
10805.00	10808.28	Top Devonian



Azimuths to Grid North  
True North: 2.73°  
Magnetic North: 9.35°

Magnetic Field  
Strength: 48185.3snT  
Dip Angle: 60.20°  
Date: 10/30/2015  
Model: IGRF2015

West(-)/East(+) (1200 usft/in)

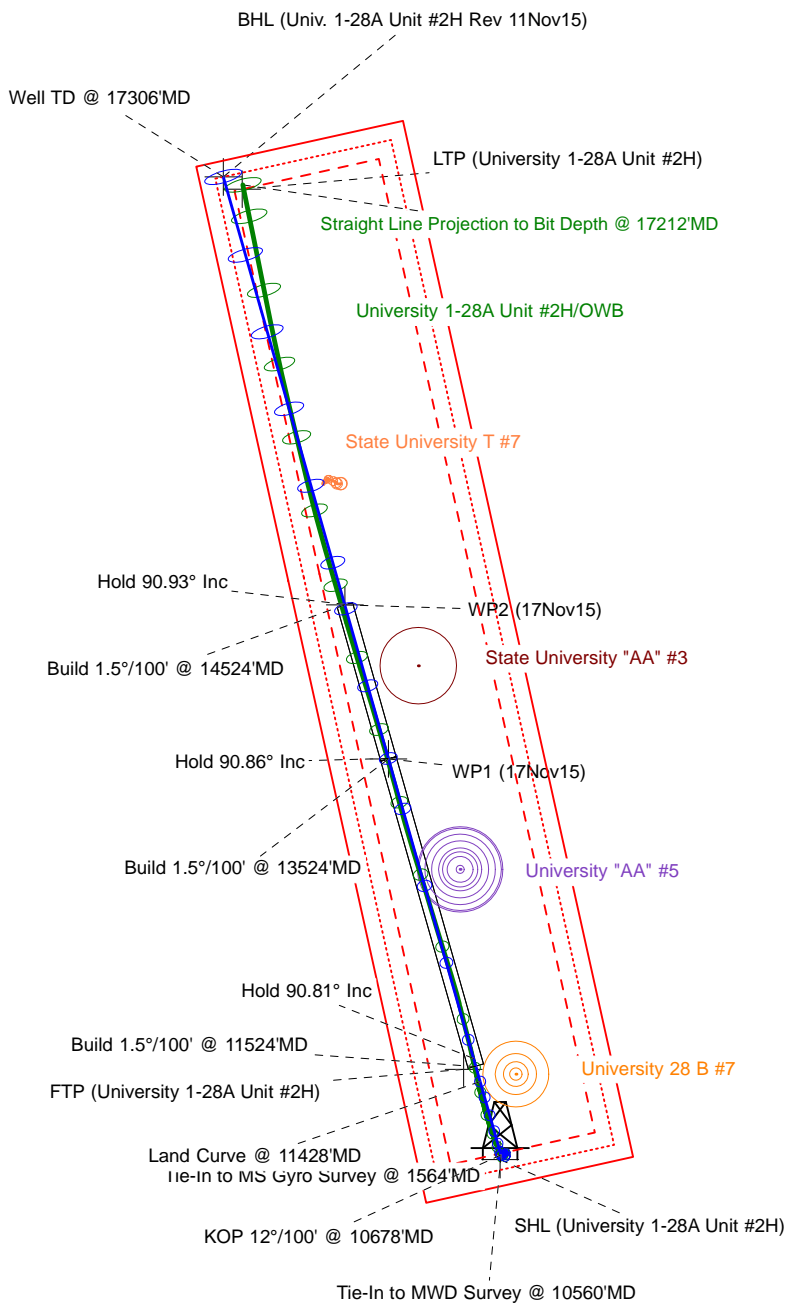

Lease Line  
200' Offset  
100' Offset

Target Window  
50' Left / Right  
25' Up / 15' Down  
\*25' Down / 0' Up from  
3600'VS to BHL

