

API No. <u>42-003-41938</u> Drilling Permit # <u>700140</u> SWR Exception Case/Docket No. <u>0267046</u> (R37)		RAILROAD COMMISSION OF TEXAS OIL & GAS DIVISION APPLICATION FOR PERMIT TO DRILL, RECOMPLETE, OR RE-ENTER <i>This facsimile W-1 was generated electronically from data submitted to the RRC.</i> <i>A certification of the automated data is available in the RRC's Austin office.</i>			FORM W-1 07/2004 Permit Status: Approved	
1. RRC Operator No. <u>562560</u>		2. Operator's Name (as shown on form P-5, Organization Report) MEWBOURNE OIL COMPANY		3. Operator Address (include street, city, state, zip):		
4. Lease Name UNIVERSITY "B11" "28"		5. Well No. <u>1</u>				
GENERAL INFORMATION						
6. Purpose of filing (mark ALL appropriate boxes): <input checked="" type="checkbox"/> New Drill <input type="checkbox"/> Recompletion <input type="checkbox"/> Reclass <input type="checkbox"/> Field Transfer <input type="checkbox"/> Re-Enter <input checked="" type="checkbox"/> Amended <input type="checkbox"/> Amended as Drilled (BHL) (Also File Form W-1D)						
7. Wellbore Profile (mark ALL appropriate boxes): <input checked="" type="checkbox"/> Vertical <input type="checkbox"/> Horizontal (Also File Form W-1H) <input type="checkbox"/> Directional (Also File Form W-1D) <input type="checkbox"/> Sidetrack						
8. Total Depth <u>10500</u>		9. Do you have the right to develop the minerals under any right-of-way? <input checked="" type="checkbox"/> Yes <input type="checkbox"/> No		10. Is this well subject to Statewide Rule 36 (hydrogen sulfide area)? <input checked="" type="checkbox"/> Yes <input type="checkbox"/> No		
SURFACE LOCATION AND ACREAGE INFORMATION						
11. RRC District No. <u>08</u>		12. County <u>ANDREWS</u>		13. Surface Location <input checked="" type="checkbox"/> Land <input type="checkbox"/> Bay/Estuary <input type="checkbox"/> Inland Waterway <input type="checkbox"/> Offshore		
14. This well is to be located <u>19</u> miles in a <u>S</u> direction from <u>Frankel City</u> which is the nearest town in the county of the well site.						
15. Section <u>28</u>	16. Block <u>11</u>	17. Survey <u>UL</u>	18. Abstract No. <u>A-</u>	19. Distance to nearest lease line: <u>467</u> ft.	20. Number of contiguous acres in lease, pooled unit, or unitized tract: <u>660.8</u>	
21. Lease Perpendiculars: <u>467</u> ft from the <u>SOUTH</u> line and <u>1980</u> ft from the <u>WEST</u> line.		22. Survey Perpendiculars: <u>467</u> ft from the <u>SOUTH</u> line and <u>1980</u> ft from the <u>WEST</u> line.				
23. Is this a pooled unit? <input type="checkbox"/> Yes <input checked="" type="checkbox"/> No		24. Unitization Docket No:		25. Are you applying for Substandard Acreage Field? <input type="checkbox"/> Yes (attach Form W-1A) <input checked="" type="checkbox"/> No		
FIELD INFORMATION List all fields of anticipated completion including Wildcat. List one zone per line.						
26. RRC District No.	27. Field No.	28. Field Name (exactly as shown in RRC records)	29. Well Type	30. Completion Depth	31. Distance to Nearest Well in this Reservoir	
08	00018001	WILDCAT	Oil or Gas Well	10500	0.00	
08	35659625	GOLDSMITH, W. (SAN ANDRES)	Oil or Gas Well	4300	0.00	
08	35652062	GOLDSMITH (CLEAR FORK)	Oil or Gas Well	6300	0.00	
08	02596820	ANDECTOR (WICHITA ALBANY)	Oil Well	7300	0.00	
BOTTOMHOLE LOCATION INFORMATION is required for DIRECTIONAL, HORIZONTAL, AND AMENDED AS DRILLED PERMIT APPLICATIONS						
Remarks [FILER Aug 12, 2010 1:44 PM]: Amending to add fields. SWR37LL exception required. Description of offset operators attached. Form H-9 mailed to Midland RRC.; [RRC STAFF Aug 13, 2010 1:27 PM]: On the service list, the spelling of Sandbridge will be corrected to Sandridge.			Certificate: I certify that information stated in this application is true and complete, to the best of my knowledge. <div style="display: flex; justify-content: space-between;"> <div> <u>Rebecca Dunn, Regulatory Analyst</u> Name of filer <u>(806)6656692</u> Phone </div> <div> <u>Aug 12, 2010</u> Date submitted <u>becca@mannaservices.com</u> E-mail Address (OPTIONAL) </div> </div>			
RRC Use Only Data Validation Time Stamp: Sep 13, 2010 4:02 PM(Current Version)						

Permit Status:	Approved
<i>The RRC has not approved this application. Duplication or distribution of information is at the user's own risk.</i>	

**RAILROAD COMMISSION OF TEXAS
OIL & GAS DIVISION**

APPLICATION FOR PERMIT TO DRILL, RECOMPLETE, OR RE-ENTER

*This facsimile W-1 was generated electronically from data submitted to the RRC.
 A certification of the automated data is available in the RRC's Austin office.*

W-1 Supplemental Field Data	
07/2004	
Permit #	700140
Approved Date:	Sep 08, 2010

1. RRC Operator No. 562560	2. Operator's Name (exactly as shown on form P-5, Organization Report) MEWBOURNE OIL COMPANY	3. Lease Name UNIVERSITY "B11" "28"	4. County ANDREWS
-------------------------------	---	--	----------------------

ADDITIONAL FIELD INFORMATION (continued from Page 1)						
26. RRC District No.	27. Field No.	28. Field Name (exactly as shown in RRC records)	29. Well Type	30. Completion Depth	31. Distance to Nearest Well in this Reservoir	32. Number of Wells on this lease in this Reservoir
08	57774275	MARTIN (CONSOLIDATED)	Oil or Gas Well	5500	0.00	1

**RAILROAD COMMISSION OF TEXAS
OIL & GAS DIVISION**

PERMIT TO DRILL, DEEPEN, PLUG BACK, OR RE-ENTER ON A REGULAR OR ADMINISTRATIVE EXCEPTION LOCATION

PERMIT NUMBER 700140	DATE PERMIT ISSUED OR AMENDED (AMENDED) Sep 08, 2010	DISTRICT * 08		
API NUMBER 42-003-41938	FORM W-1 RECEIVED Aug 12, 2010	COUNTY ANDREWS		
TYPE OF OPERATION NEW DRILL	WELLBORE PROFILE(S) Vertical	ACRES 660.8		
OPERATOR MEWBOURNE OIL COMPANY		562560 NOTICE This permit and any allowable assigned may be revoked if payment for fee(s) submitted to the Commission is not honored. District Office Telephone No: (432) 684-5581		
LEASE NAME UNIVERSITY "B11" "28"		WELL NUMBER 1		
LOCATION 19 miles S direction from FRANKEL CITY		TOTAL DEPTH 10500		
Section, Block and/or Survey SECTION ◀ 28 BLOCK ◀ 11 ABSTRACT ◀ SURVEY ◀ UL				
DISTANCE TO SURVEY LINES 467 ft. SOUTH 1980 ft. WEST		DISTANCE TO NEAREST LEASE LINE 467 ft.		
DISTANCE TO LEASE LINES 467 ft. SOUTH 1980 ft. WEST		DISTANCE TO NEAREST WELL ON LEASE See FIELD(s) Below		
FIELD(s) and LIMITATIONS: * SEE FIELD DISTRICT FOR REPORTING PURPOSES * ** THIS PERMIT IS GRANTED PURSUANT TO STATEWIDE RULE 37(h)(2)(A) ** CASE NO. 0267046				
FIELD NAME LEASE NAME	ACRES NEAREST LEASE	DEPTH	WELL # NEAREST WE	DIST
----- WILDCAT UNIVERSITY "B11" "28"	660.80 467	10,500	1 0	08
RESTRICTIONS: This is a hydrogen sulfide field. This well shall be drilled in accordance with SWR 36.				
----- MARTIN (CONSOLIDATED) UNIVERSITY "B11" "28"	660.80 467	5,500	1 0	08
RESTRICTIONS: This is a hydrogen sulfide field. This well shall be drilled in accordance with SWR 36.				
----- ** ANDECTOR (WICHITA ALBANY) UNIVERSITY "B11" "28"	660.80 467	7,300	1 0	08
RESTRICTIONS: This is a hydrogen sulfide field. This well shall be drilled in accordance with SWR 36.				
----- GOLDSMITH (CLEAR FORK) UNIVERSITY "B11" "28"	660.80 467	6,300	1 0	08
RESTRICTIONS: This is a hydrogen sulfide field. This well shall be drilled in accordance with SWR 36.				
----- GOLDSMITH, W. (SAN ANDRES)	660.80	4,300	1	08

RAILROAD COMMISSION OF TEXAS

OIL & GAS DIVISION

PERMIT TO DRILL, DEEPEN, PLUG BACK, OR RE-ENTER ON A REGULAR OR ADMINISTRATIVE EXCEPTION LOCATION

PERMIT NUMBER <div style="text-align: right;">700140</div>	DATE PERMIT ISSUED OR AMENDED (AMENDED) <div style="text-align: right;">Sep 08, 2010</div>	DISTRICT <div style="text-align: right;">* 08</div>
API NUMBER <div style="text-align: right;">42-003-41938</div>	FORM W-1 RECEIVED <div style="text-align: right;">Aug 12, 2010</div>	COUNTY <div style="text-align: right;">ANDREWS</div>
TYPE OF OPERATION <div style="text-align: right;">NEW DRILL</div>	WELLBORE PROFILE(S) <div style="text-align: right;">Vertical</div>	ACRES <div style="text-align: right;">660.8</div>
OPERATOR <div style="text-align: right;">MEWBOURNE OIL COMPANY</div>		NOTICE This permit and any allowable assigned may be revoked if payment for fee(s) submitted to the Commission is not honored. District Office Telephone No: <div style="text-align: right;">(432) 684-5581</div>
LEASE NAME <div style="text-align: right;">UNIVERSITY "B11" "28"</div>		WELL NUMBER <div style="text-align: right;">1</div>
LOCATION <div style="text-align: right;">19 miles S direction from FRANKEL CITY</div>		TOTAL DEPTH <div style="text-align: right;">10500</div>
Section, Block and/or Survey <div style="display: flex; justify-content: space-between;"> <div> SECTION ◀ 28 SURVEY ◀ UL </div> <div> BLOCK ◀ 11 </div> <div> ABSTRACT ◀ </div> </div>		
DISTANCE TO SURVEY LINES <div style="text-align: right;">467 ft. SOUTH 1980 ft. WEST</div>		DISTANCE TO NEAREST LEASE LINE <div style="text-align: right;">467 ft.</div>
DISTANCE TO LEASE LINES <div style="text-align: right;">467 ft. SOUTH 1980 ft. WEST</div>		DISTANCE TO NEAREST WELL ON LEASE <div style="text-align: right;">See FIELD(s) Below</div>
FIELD(s) and LIMITATIONS: <div style="text-align: center;"> <p>* SEE FIELD DISTRICT FOR REPORTING PURPOSES *</p> <p>** THIS PERMIT IS GRANTED PURSUANT TO STATEWIDE RULE 37(h)(2)(A) **</p> <p>CASE NO. 0267046</p> </div>		
FIELD NAME LEASE NAME <div style="text-align: right;">UNIVERSITY "B11" "28"</div>	ACRES NEAREST LEASE <div style="text-align: right;">467</div>	DEPTH WELL # NEAREST WE <div style="text-align: right;">0</div>
RESTRICTIONS: This is a hydrogen sulfide field. This well shall be drilled in accordance with SWR 36.		
<p>' *** ' PRECEDING FIELD NAME INDICATES RULE (R37)</p>		
<p style="text-align: center;">THE FOLLOWING RESTRICTIONS APPLY TO ALL FIELDS</p> <p>This well shall be completed and produced in compliance with applicable special field or statewide spacing and density rules. If this well is to be used for brine mining, underground storage of liquid hydrocarbons in salt formations, or underground storage of gas in salt formations, a permit for that specific purpose must be obtained from Environmental Services prior to construction, including drilling, of the well in accordance with Statewide Rules 81, 95, and 97.</p>		

Block 11, University Lands Survey Andrews County, Texas

20 21

22

29 28

MEWBOURNE OIL COMPANY

27

660.8 Acres

GRID N:(Y) 6749339.986
GRID E:(X) 640733.524
Latitude: +32.1079927
Longitude: -102.7890876

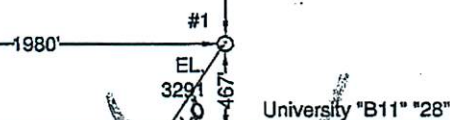

32 33 SANDRIDGE
E+P

CONOCOPHILLIPS

34

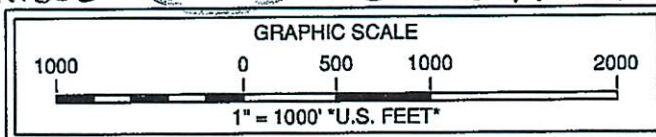

Note: City of Frankel City, Texas from well location bears N 3°37'33" E, 19.0 miles.
Note: Survey Reconstruction filed in the Office of Pennell & Marlowe Land Surveyors, Inc.
Note: Acreages shown have been converted to surface acreages.
Note: Coordinates shown herein are on The Texas Coordinate System of 1983, North Central Zone.
Latitudes and Longitudes shown are on NAD'83 Datum.

USGS Quadrangle Sheet: Bedford Ranch, Tex.

Railroad Commission Permit Plat

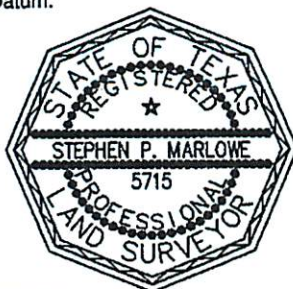

MEWBOURNE OIL COMPANY
University "B11" "28" #1
467' FROM SOUTH LINE
1980' FROM WEST LINE
University "B11" "28" Lease
660.8 Acres being all of
Section 28, Block 11
University Lands Survey
Andrews County, Texas

Stephen P. Marlowe
REGISTERED PROFESSIONAL LAND SURVEYOR NO. 5715

July 26, 2010

100726B

P.O. Box 51622, Midland, Texas, 79710 (432) 570-6256 Fax (432) 682-3262

Scale: 1" = 1000'