

gyrodata

Gyrodata Incorporated
3811 S. Co. Rd. 1285
Odessa, TX 79765

432/561-8458
Fax: 432/563-7982

Date: March 10, 2010

Railroad Commission of Texas
Oil & Gas Division
P.O. Box 12867
Capitol Station
Austin, Texas 78711

Attn: Ms. Pam Johns

LATERAL #1

RE:
XTO Energy
Univarsity Block 9 Well No. 11Q
RRC Lease/Gas ID No. Not Assigned
Univarsity Block 9 (Devonian)
UL, Abstract not given
Andrews County, Texas
API No. 42-003-39848

BHL 176' FSL & 1979' FWL OF SECT 10
MD 12,080'
TVD 10,531'

Ms. Johns,

Enclosed, please find the original and one copy of the survey performed on the referenced well by Gyrodata, Inc. (P-E No. 339711). Other information required by your office is as follows:

Name & Title Of Surveyor	Drainhole Number	Surveyed Depths	Dates Performed	Type of Survey
Wesley Vessell Surveyor	Original Hole	10398' - 12135'	01/23/10	Magnetic Gyro Multishot

A certified plat on which the bottom hole location is oriented both to the surface location and to the lease lines (or unit lines in the case of pooling) is attached to the survey report. If any other information is required, please contact the undersigned at the letterhead address and phone number.

Sincerely,

Jeff Tumlin
Operations
Enclosure



Gyrodata Incorporated
3811 S. Co. Rd. 1385
Odessa, TX 79765

432/561-8458
Fax: 432/563-7982

State of Texas
County of Harris

I, Jena Tumlin, certify that; I am employed by Gyrodata Inc.; that I am authorized and qualified to review the Magnetic Gyroscopic Multishot survey from a depth of 10398 feet to a depth of 12080 feet conducted on the day(s) of 01/23/10 through 01/29/10; that this survey was conducted at the request of XTO Energy for the University Block 9 Well No. 11Q, API No. 42-003-38646 in Andrews County, Texas; that the data is true, correct, complete, and within the limitations of the tool as set forth by Gyrodata Inc; that I am authorized and qualified to make this report; and that I have reviewed this report and find that it conforms to the principles and procedures as set forth by Gyrodata Inc.



Jena Tumlin
Operations

A Gyrodata Directional Survey

for

XTO ENERGY

Lease: University Block 9 Well: 11Q,
Location: Key # 115, Andrews County, Texas

Job Number: MD0110ESTW117

Run Date: 11/23/10 *57:14*

Surveyor: Francisco Mayorga, Corey Wurf, Manual Garcia

Survey Latitude: 0 deg 0 min 0 sec deg. N

A Gyrodata Directional Survey

XTO Energy
 Lease: University Block 9 Well: 11Q
 Location: Key # 115, Andrews County, Texas
 Job Number: MD0110BSTW117

MEASURED DEPTH feet	INCL deg.	AZIMUTH deg.	VERTICAL SECTION feet	DOGLEG SEVERITY deg/ 25 ft.	VERTICAL DEPTH feet	CLOSURE DIST. AZIMUTH feet deg.	HORIZONTAL COORDINATES feet
10317.00	2.16	94.25	-1.4	0.00	10313.58	107.2 183.2	107.01 S 6.06W
10398 TO 12080 FT MAGNETIC MULTISHOT SURVEY RUN ALL MEASURED DEPTHS AND COORDINATES REFERENCED TO KEY # 115							
10398.00	10.50	104.40	7.4	2.59	10394.02	109.0 178.6	108.96 S 2.63 E
10430.00	19.40	107.70	15.4	6.98	10424.90	111.8 174.6	111.31 S 10.53 E
10461.00	29.50	101.30	27.9	8.41	10453.09	116.7 168.7	114.38 S 22.95 E
10493.00	41.70	101.90	46.3	9.54	10479.06	125.1 160.8	118.13 S 41.16 E
10525.00	53.50	102.40	69.5	9.22	10500.60	138.8 152.4	123.10 S 64.22 E
10557.00	64.20	104.40	96.4	8.47	10517.13	158.1 145.0	129.47 S 90.81 E
10588.00	77.30	106.20	124.8	10.65	10527.33	181.6 139.1	137.19 S 118.98 E
10619.00	90.70	105.00	154.8	10.85	10530.56	207.9 134.4	145.46 S 148.60 E
10650.00	92.40	106.00	185.0	1.59	10529.72	235.6 130.7	153.74 S 178.46 E
10681.00	93.90	105.40	215.1	1.30	10528.02	263.9 127.9	162.12 S 208.26 E
10713.00	94.40	104.80	246.3	0.61	10525.71	293.6 125.5	170.43 S 239.08 E
10745.00	94.60	105.50	277.4	0.57	10523.19	323.7 123.5	178.77 S 269.87 E
10776.00	94.50	103.10	307.7	1.93	10520.74	353.0 121.9	186.40 S 299.81 E
10808.00	94.30	101.70	339.1	1.10	10518.28	383.3 120.3	193.25 S 330.97 E
10840.00	94.60	100.70	370.6	0.81	10515.80	413.5 118.8	199.45 S 362.27 E
10872.00	94.20	99.70	402.2	0.84	10513.34	443.9 117.5	205.10 S 393.67 E
10903.00	93.80	97.50	433.0	1.80	10511.18	473.2 116.3	209.72 S 424.24 E
10935.00	93.50	95.40	464.8	1.65	10509.14	503.4 115.1	213.31 S 455.97 E
10966.00	93.10	94.90	495.8	0.52	10507.36	532.6 113.9	216.09 S 486.80 E

A Gyrodata Directional Survey

XTO Energy

Lease: University Block 9 Well: 11Q

Location: Key # 115, Andrews County, Texas

Job Number: MD0110BSTW117

MEASURED DEPTH feet	INCL deg.	AZIMUTH deg.	VERTICAL SECTION feet	DOGLEG SEVERITY deg/ 25 ft.	VERTICAL DEPTH feet	CLOSURE DIST. AZIMUTH feet deg.	HORIZONTAL COORDINATES feet
10998.00	92.10	93.20	527.7	1.54	10505.91	562.8 112.8	218.34 S 518.68 E
11029.00	91.90	91.70	558.7	1.22	10504.82	591.9 111.8	219.67 S 549.63 E
11061.00	91.20	91.10	590.7	0.72	10503.96	622.0 110.8	220.45 S 581.61 E
11092.00	90.60	90.50	621.7	0.68	10503.47	651.2 109.8	220.88 S 612.61 E
11124.00	90.60	89.80	653.6	0.55	10503.14	681.4 108.9	220.97 S 644.60 E
11155.00	90.70	89.50	684.6	0.26	10502.78	710.8 108.1	220.78 S 675.60 E
11187.00	91.00	90.00	716.5	0.46	10502.31	741.2 107.3	220.64 S 707.60 E
11219.00	90.60	88.00	748.5	1.59	10501.86	771.6 106.6	220.08 S 739.59 E
11250.00	89.50	86.50	779.4	1.50	10501.84	801.0 105.8	218.59 S 770.55 E
11281.00	89.30	85.90	810.2	0.51	10502.16	830.2 105.1	216.54 S 801.48 E
11313.00	89.90	85.00	841.9	0.85	10502.38	860.4 104.4	214.00 S 833.38 E
11344.00	90.40	83.10	872.6	1.58	10502.30	889.5 103.7	210.78 S 864.21 E
11376.00	90.30	81.20	904.1	1.49	10502.11	919.4 103.0	206.41 S 895.91 E
11407.00	90.00	79.90	934.4	1.08	10502.03	948.1 102.3	201.32 S 926.49 E
11439.00	90.10	78.10	965.5	1.41	10502.00	977.6 101.5	195.22 S 957.90 E
11470.00	89.90	78.50	995.5	0.36	10502.00	1006.2 100.8	188.93 S 988.25 E
11502.00	90.20	78.40	1026.6	0.25	10501.97	1035.8 100.1	182.53 S 1019.60 E
11534.00	90.10	78.20	1057.6	0.17	10501.89	1065.6 99.5	176.04 S 1050.94 E
11565.00	90.30	78.20	1087.7	0.16	10501.78	1094.5 98.9	169.70 S 1081.28 E
11597.00	90.30	78.60	1118.7	0.31	10501.61	1124.5 98.3	163.26 S 1112.63 E
11628.00	90.50	79.00	1148.8	0.36	10501.39	1153.8 97.8	157.24 S 1143.04 E
11660.00	90.20	79.30	1179.9	0.33	10501.20	1184.2 97.3	151.22 S 1174.47 E
11691.00	90.10	78.90	1210.1	0.33	10501.12	1213.6 96.9	145.36 S 1204.91 E
11723.00	90.70	79.30	1241.2	0.56	10500.89	1244.2 96.4	139.31 S 1236.33 E
11754.00	90.90	78.70	1271.4	0.51	10500.46	1273.8 96.0	133.39 S 1266.76 E

A Gyrodata Directional Survey

XTO Energy
Lease: University Block 9 Well: 11Q
Location: Key # 115, Andrews County, Texas
Job Number: MD01108STW117

MEASURED DEPTH feet	INCL deg.	AZIMUTH deg.	VERTICAL SECTION feet	DOGLEG SEVERITY deg/ 25 ft.	VERTICAL DEPTH feet	CLOSURE DIST. AZIMUTH feet deg.	HORIZONTAL COORDINATES feet
11786.00	90.80	78.60	1302.4	0.11	10499.99	1304.3 95.6	127.09 S 1298.13 E
11818.00	90.80	79.30	1333.5	0.55	10499.54	1335.0 95.2	120.96 S 1329.53 E
11849.00	91.10	78.80	1363.7	0.47	10499.03	1364.8 94.8	115.07 S 1359.96 E
11880.00	91.30	79.70	1393.8	0.74	10498.38	1394.7 94.5	109.29 S 1390.41 E
11912.00	91.60	78.80	1425.0	0.74	10497.57	1425.6 94.2	103.33 S 1421.84 E
11944.00	92.10	77.70	1456.0	0.94	10496.53	1456.4 93.8	96.81 S 1453.15 E
11975.00	92.10	76.70	1485.9	0.81	10495.40	1486.1 93.5	89.95 S 1483.36 E
12007.00	92.10	77.80	1516.7	0.86	10494.23	1516.8 93.1	82.89 S 1514.55 E
12039.00	92.50	77.20	1547.6	0.56	10492.94	1547.6 92.8	75.97 S 1545.77 E
12080.00	92.50	77.20	1587.1	0.00	10491.15	1587.1 92.4	66.90 S 1585.71 E

Final Station Closure: Distance: 1587.12 ft Az: 92.42 deg.

XTO Energy
Well: University Block 9 11Q
Location: Key # 115, Andrews County, Texas

10 Mar 12:05 Final
Gyrodata
MD0110ESTW117 DEFINITIVE

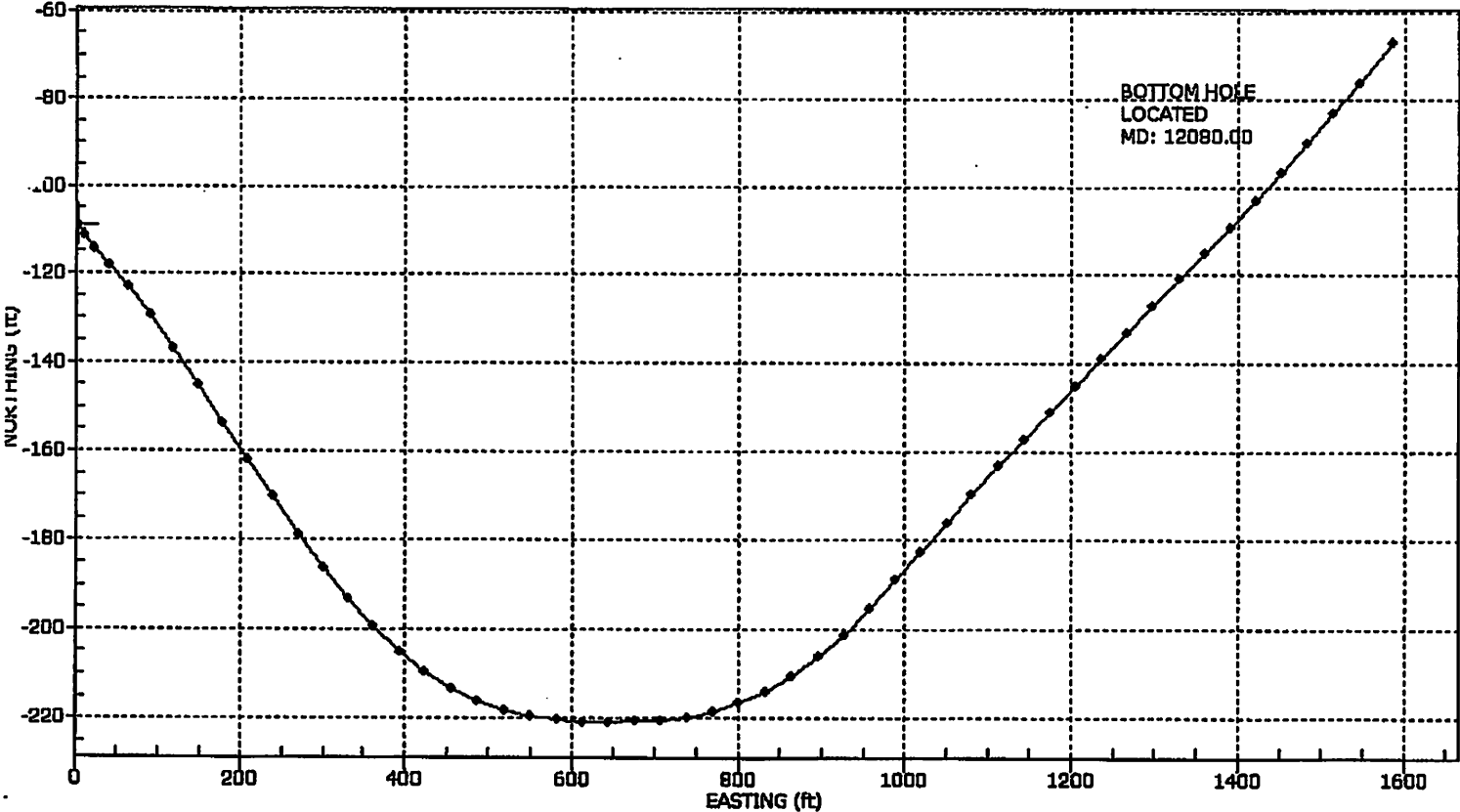

XTO Energy
Well: University Block 9 11Q
Location: Key # 115, Andrews County, Texas

10 Mar 12:06 Final
Gyrodata
MD0110ESTW117 DEFINITIVE

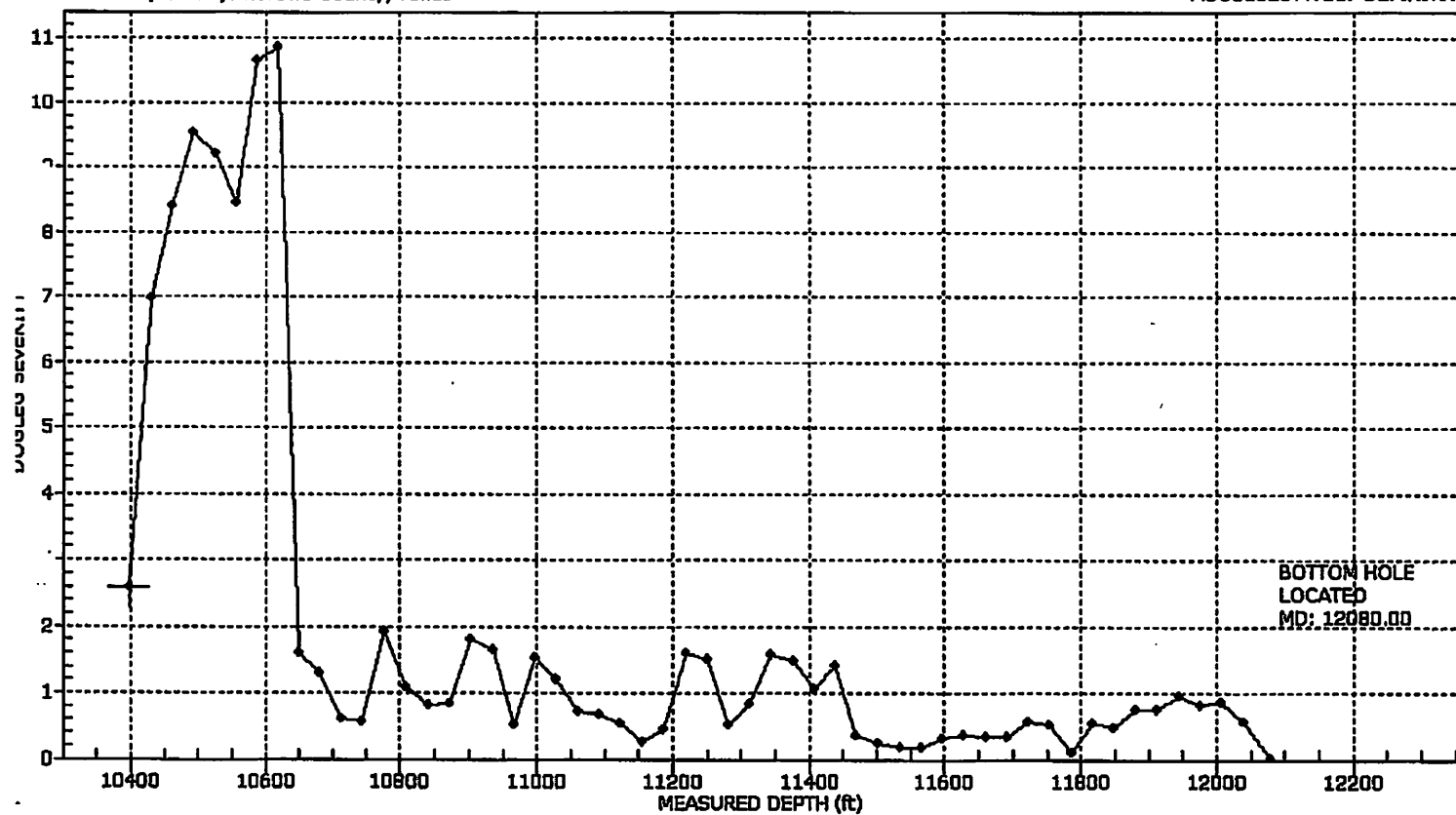

XTO Energy
Well: University Block 9 11Q
Location: Key # 115, Andrews County, Texas

10 Mar 12:07 Final
Gyrodata
MD0110ESTW117 DEFINITIVE

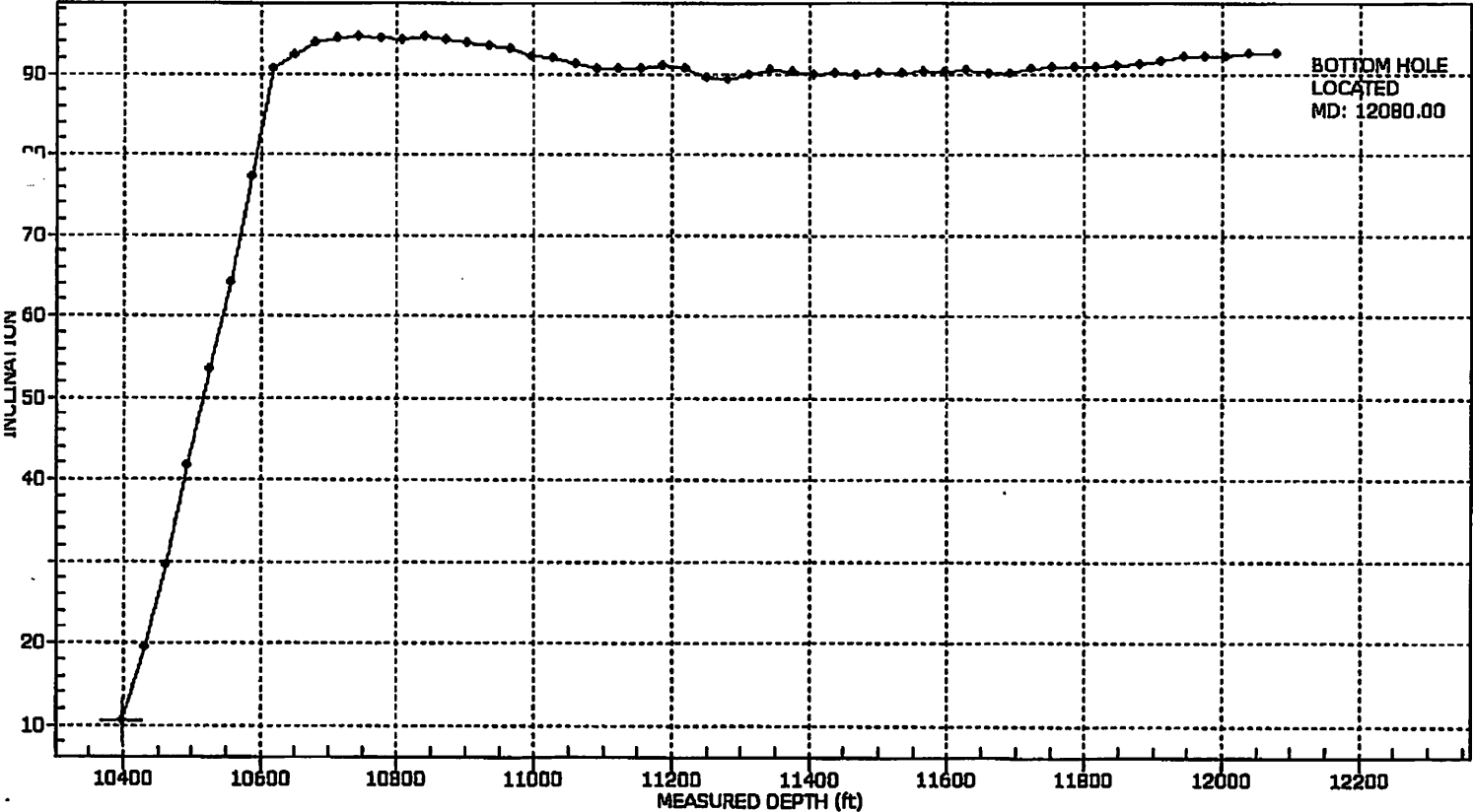

XTO Energy
WELL NUMBER : University Block 9 11Q
SURVEY
DATE RUN : 100310
JOB NUMBER : MD0110ESTW117

MD	INC	AZ	TVD	LOCAL N	LOCAL E	V/S	DOG/ 25FT
10398	10.5	104.4	10394.02	-108.96	2.63	7.4	2.59
10430	19.4	107.7	10424.8	-111.31	10.53	15.4	8.98
10461	29.5	101.3	10453.09	-114.38	22.95	27.9	8.41
10493	41.7	101.9	10479.06	-118.13	41.16	46.3	9.54
10525	53.5	102.4	10500.6	-123.1	64.22	69.5	9.22
10557	64.2	104.4	10517.13	-129.47	90.81	96.4	8.47
10588	77.3	105.2	10527.33	-137.19	118.98	124.8	10.85
10619	90.7	105	10530.56	-145.46	148.6	154.8	10.85
10650	92.4	106	10529.72	-153.74	178.46	185	1.59
10681	93.9	105.4	10528.02	-162.12	208.26	215.1	1.3
10713	94.4	104.8	10525.71	-170.43	239.08	246.3	0.61
10745	94.6	105.5	10523.19	-178.77	269.87	277.4	0.57
10778	94.5	103.1	10520.74	-186.4	299.81	307.7	1.93
10808	94.3	101.7	10518.28	-193.25	330.97	339.1	1.1
10840	94.6	100.7	10515.8	-199.45	362.27	370.6	0.81
10872	94.2	99.7	10513.34	-205.1	393.67	402.2	0.84
10903	93.8	97.5	10511.18	-209.72	424.24	433	1.8
10935	93.5	95.4	10509.14	-213.31	455.97	464.8	1.65
10966	93.1	94.9	10507.36	-216.09	486.8	495.8	0.52
10998	92.1	93.2	10505.91	-218.34	518.68	527.7	1.54
11029	91.9	91.7	10504.82	-219.67	549.63	558.7	1.22
11061	91.2	91.1	10503.96	-220.45	581.61	590.7	0.72
11092	90.6	90.5	10503.47	-220.88	612.61	621.7	0.66
11124	90.6	89.8	10503.14	-220.97	644.6	653.6	0.55
11155	90.7	89.5	10502.78	-220.78	675.6	684.6	0.26
11187	91	90	10502.31	-220.64	707.6	716.5	0.48
11219	90.6	89	10501.86	-220.08	739.59	748.5	1.59
11250	89.5	86.5	10501.64	-218.59	770.55	779.4	1.5
11281	89.3	85.9	10502.16	-216.54	801.48	810.2	0.51
11313	89.9	85	10502.38	-214	833.38	841.9	0.85
11344	90.4	83.1	10502.3	-210.78	864.21	872.6	1.58
11376	90.3	81.2	10502.11	-206.41	895.91	904.1	1.49
11407	90	79.9	10502.03	-201.32	926.49	934.4	1.08
11439	90.1	78.1	10502	-195.22	957.9	965.5	1.41
11470	89.9	78.5	10502	-188.93	988.25	995.6	0.36
11502	90.2	78.4	10501.97	-182.53	1019.6	1026.6	0.25
11534	90.1	78.2	10501.89	-176.04	1050.94	1057.6	0.17
11565	90.3	78.2	10501.78	-169.7	1081.28	1087.7	0.16
11597	90.3	78.6	10501.61	-163.26	1112.63	1118.7	0.31
11628	90.5	79	10501.39	-157.24	1143.04	1148.8	0.36
11660	90.2	79.3	10501.2	-151.22	1174.47	1179.9	0.33
11691	90.1	78.9	10501.12	-145.36	1204.91	1210.1	0.33
11723	90.7	79.3	10500.89	-139.31	1236.33	1241.2	0.56
11754	90.9	78.7	10500.46	-133.39	1266.76	1271.4	0.51
11786	90.8	78.6	10499.99	-127.09	1298.13	1302.4	0.11

11818	90.8	79.3	10499.54	-120.98	1329.53	1333.5	0.55
11849	91.1	78.8	10499.03	-115.07	1359.96	1383.7	0.47
11880	91.3	79.7	10498.38	-109.29	1390.41	1393.9	0.74
11912	91.6	78.8	10497.57	-103.33	1421.84	1425	0.74
11944	92.1	77.7	10496.53	-96.81	1453.15	1456	0.94
11975	92.1	76.7	10495.4	-89.95	1483.36	1485.9	0.81
12007	92.1	77.8	10494.23	-82.89	1514.55	1516.7	0.88
12039	92.5	77.2	10492.94	-75.97	1545.77	1547.6	0.56
12080	92.5	77.2	10491.15	-66.9	1585.71	1587.1	0

TOPOGRAPHIC

SURVEYING • MAPPING • GIS • GPS
2803 N. 800 STREET • ARLING, TEXAS 76010
TELEPHONE (817) 882-1433 (FAX) 767-1433 • FAX (817) 882-1743

ANDREWS County, TEXAS
SHL: 1250' FRI & 450' FRI
Description: SHL: 1250' FRI & 450' FRI (SEC. 18)
SHL: 2: 250' FRI & 2500' FRI
SECTION 10, BLOCK 9, UNIVERSITY LAND

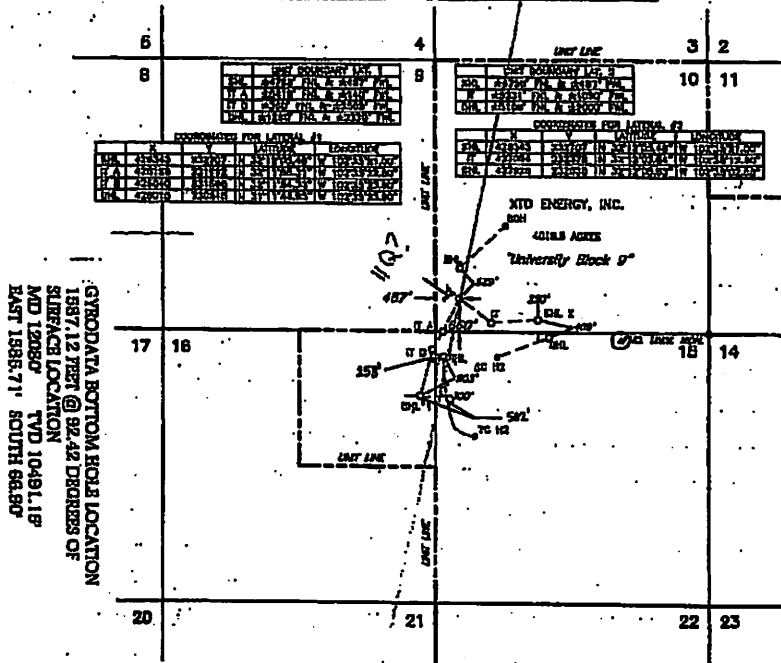

GRID DATA BOTTOM HOLE LOCATION
1887.12 WEST @ 82.42 DEGREES OF
SURFACE LOCATION
MAD 12080' TWD 10491.18'
EAST 1886.71' SOUTH 86.80'

SCALE 1" = 1000'
0 500' 1000'

Operator **XTO**
ENERGY, INC.

Date Staked MAY 19, 2005

Lease Name & Well No. UNIVERSITY BLOCK 9 #119

Ground Elev. 3165'

Topography & Vegetation SANDY NATURAL PASTURE

Nearest Town in County 48.4 MILES SOUTH OF ANDREWS, TEXAS

Driving Directions FROM THE JCT OF U.S. HWY 385 & COUNTY ROAD SW8900, GO SOUTHWEST

SW8900 3.8 MILES THENCE NORTH 0.7 MILES THENCE WEST 1.1 MILES TO A POINT 4300' SOUTH OF THE

LOCATION



Invoice # 181421/0385W
PLS
Amount 4117.00 USD

CERTIFICATION:

I, Robert J. Dutton, Jr., a Registered Professional Land Surveyor, and an authorized agent of Topographic Land Surveyors, do hereby certify that in my professional opinion the above described well location was surveyed and staked on the ground as shown. This plot is for Texas Railroad Commission permitting only.

Robert J. Dutton, Jr.
Texas Reg. No. 8916