



INTEQ

2105 Market Street
Midland, Texas 79703
Tel. 915-694-9517
Fax 915-694-5648

Railroad Commission of Texas
Oil and Gas Division
P.O. Box 12967
Capitol Station
Austin, Texas 78711

Attention:

Re: Customer: Cross Timbers Operating Co.
Well Name: University 9 CEC No. 8H
RRC Lease/Gas ID No. :
Field: University Block 9
Section 14, Block 9
University Land Survey
Andrews County, Texas
API No. 42-003-38502

Enclosed, please find the original and one copy of the survey performed on the referenced well by Baker Hughes INTEQ (P-5 No. 046289). Other information required by your office is as follows:

<u>Name & Title</u> <u>of Surveyor</u>	<u>Drainhole Number</u>	<u>Surveyed Depths</u>	<u>Dates Performed</u>	<u>Type of Survey</u>
Adryan Mitcham Surveyor	Vertical	0' to 10400'	08-03-00	Gyroscopic
Adryan Mitcham Surveyor	Sidetrack No.1	10400' to 11908'	08-10-00 to 08-17-00	MWD

A certified plat on which the bottom hole location is oriented both to the surface location and to the lease lines (or unit line in case of pooling) is attached to the survey report. If any other information is required, please contact the undersigned at the letterhead address and phone number.

Bart Welch
Operations Coordinator

Enclosures
cc:





2105 Market Street Midland, Texas 79703
915-694-9517 Fax 915-694-5648

SURVEY CERTIFICATION SHEET

STATE OF TEXAS
COUNTY OF MIDLAND

I, Adryan Mitcham, certify that; I am employed by Baker Hughes INTEQ; that I did on the day(s) of August 3, 2000 conduct or supervise the taking of a gyroscopic survey **from a depth of 0 feet to a depth of 10400 feet**; that the data is true, correct, complete and within the limitations of the tool as set forth by Baker Hughes INTEQ; that I am authorized and qualified to make this report; that this survey was conducted at the request of Cross Timbers Operating Co. for the University 9 CEC No. 8H Well API No. 42-003-38502 in Andrews County, Texas; and that I have reviewed this report and find that it conforms to the principles and procedures as set forth by Baker Hughes INTEQ.

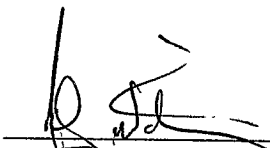

Surveyor



2105 Market Street Midland, Texas 79703
915-694-9517 Fax 915-694-5648

SURVEY CERTIFICATION SHEET

STATE OF TEXAS
COUNTY OF MIDLAND

I, Adryan Mitcham, certify that; I am employed by Baker Hughes INTEQ; that I did on the day(s) of August 10, 2000 to August 17, 2000 conduct or supervise the taking of a MWD survey **from a depth of 10400 feet to a depth of 11908 feet**; that the data is true, correct, complete and within the limitations of the tool as set forth by Baker Hughes INTEQ; that I am authorized and qualified to make this report; that this survey was conducted at the request of Cross Timbers Operating Co. for the University 9 CEC No. 8H Well API No. 42-003-38502 in Andrews County, Texas; and that I have reviewed this report and find that it conforms to the principles and procedures as set forth by Baker Hughes INTEQ.

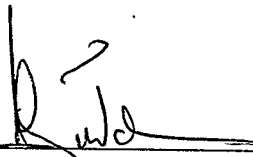

Surveyor

CROSS TIMBERS OPERATING CO.

Structure : University 9 CEC No.8H Slot : slot #1
 Field : BLK. 9 DEVONIAN Location : ANDREWS CO., TEXAS



Created by bartw
 Date plotted : 26-Sep-2000
 Plot Reference is Gyro/MWD.
 Coordinates are in feet reference slot #1.
 True Vertical Depths are reference rotary table.
 --- Baker Hughes INTEQ ---

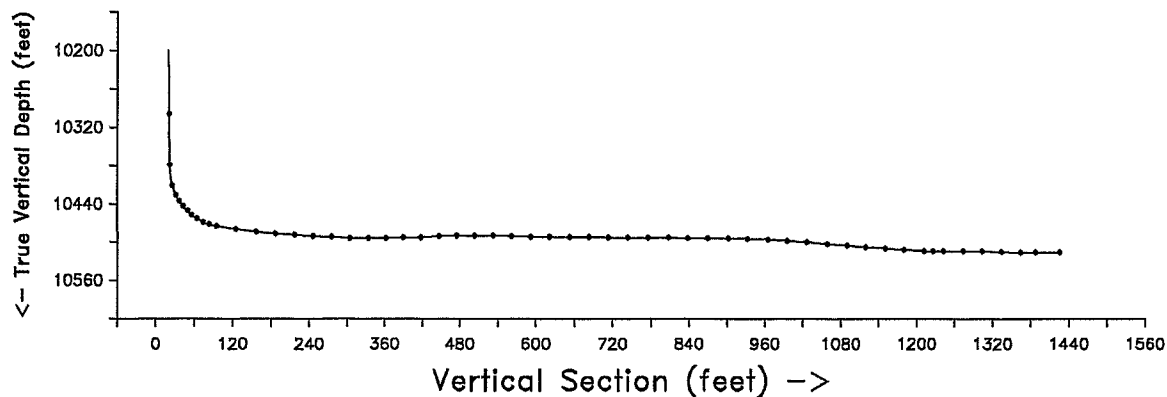

Azimuth 164.95 with reference 0.00 S, 0.00 W from slot #1

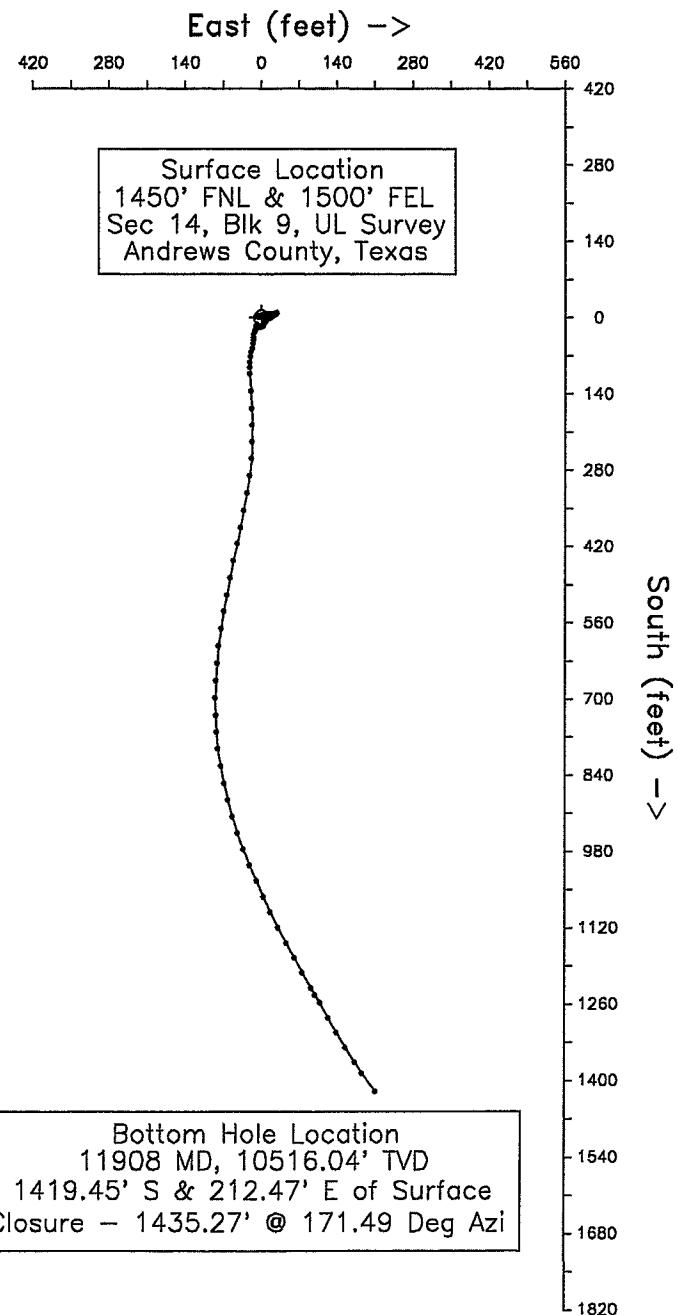

Surface Location
 1450' FNL & 1500' FEL
 Sec 14, Blk 9, UL Survey
 Andrews County, Texas

Bottom Hole Location
 11908 MD, 10516.04' TVD
 1419.45' S & 212.47' E of Surface
 Closure - 1435.27' @ 171.49 Deg Azi

CROSS TIMBERS OPERATING CO.
University 9 CEC No.8H

slot #1
BLK. 9 DEVONIAN
ANDREWS CO., TEXAS

S U R V E Y L I S T I N G

by
Baker Hughes INTEQ

Your ref : Gyro/MWD
Our ref : svy1434
License :

Date printed : 26-Sep-2000
Date created : 4-Aug-2000
Last revised : 26-Sep-2000

Field is centred on 429051.000,234682.000,999.00000,N
Structure is centred on 435199.000,232501.000,3.00000,N

Slot location is n32 12 7.651,w102 33 37.982
Slot Grid coordinates are N 232501.000, E 435199.000
Slot local coordinates are 0.00 N 0.00 E

Projection type: lambert - Texas North Central (4202), Spheroid: Clarke - 1866

Reference North is Grid North

CROSS TIMBERS OPERATING CO.
University 9 CEC No.8H,slot #1
BLK. 9 DEVONIAN,ANDREWS CO., TEXAS

SURVEY LISTING Page 1
Your ref : Gyro/MWD
Last revised : 26-Sep-2000

Measured Depth	Inclin Degrees	Azimuth Degrees	True Vert Depth	R E C T A N G U L A R C O O R D I N A T E S		Dogleg Deg/100ft	Vert Sect	G R I D Easting	C O O R D S Northing
0.00	0.00	0.00	0.00	0.00N	0.00E	0.00	0.00	435199.00	232501.00
100.00	0.17	12.56	100.00	0.15N	0.03E	0.17	-0.13	435199.03	232501.15
200.00	0.29	332.24	200.00	0.52N	0.05W	0.20	-0.52	435198.95	232501.52
300.00	0.42	316.61	300.00	1.01N	0.42W	0.15	-1.09	435198.58	232502.01
400.00	0.39	300.62	399.99	1.45N	0.96W	0.12	-1.65	435198.04	232502.45
500.00	0.35	282.92	499.99	1.69N	1.56W	0.12	-2.04	435197.44	232502.69
600.00	0.32	272.08	599.99	1.77N	2.14W	0.07	-2.26	435196.86	232502.77
700.00	0.17	244.80	699.99	1.72N	2.55W	0.19	-2.32	435196.45	232502.72
800.00	0.12	242.48	799.99	1.60N	2.78W	0.05	-2.27	435196.22	232502.60
900.00	0.23	259.02	899.99	1.51N	3.08W	0.12	-2.26	435195.92	232502.51
1000.00	0.20	266.91	999.99	1.46N	3.46W	0.04	-2.31	435195.54	232502.46
1100.00	0.41	285.50	1099.99	1.55N	3.98W	0.23	-2.53	435195.02	232502.55
1200.00	0.51	318.50	1199.98	1.98N	4.63W	0.28	-3.11	435194.37	232502.98
1300.00	0.12	293.84	1299.98	2.36N	5.02W	0.41	-3.58	435193.98	232503.36
1400.00	0.52	301.44	1399.98	2.64N	5.50W	0.40	-3.97	435193.50	232503.64
1500.00	0.13	212.70	1499.98	2.78N	5.95W	0.53	-4.23	435193.05	232503.78
1600.00	0.34	266.77	1599.98	2.67N	6.31W	0.29	-4.22	435192.69	232503.67
1700.00	0.25	191.54	1699.98	2.44N	6.65W	0.37	-4.08	435192.35	232503.44
1800.00	0.41	248.49	1799.98	2.09N	7.03W	0.35	-3.85	435191.97	232503.09
1900.00	0.16	285.79	1899.97	2.00N	7.49W	0.30	-3.88	435191.51	232503.00
2000.00	0.89	71.87	1999.97	2.28N	6.88W	1.03	-3.99	435192.12	232503.28
2100.00	0.90	74.41	2099.96	2.73N	5.39W	0.04	-4.04	435193.61	232503.73
2200.00	0.82	71.63	2199.95	3.17N	3.96W	0.09	-4.09	435195.04	232504.17
2300.00	0.80	75.62	2299.94	3.57N	2.60W	0.06	-4.12	435196.40	232504.57
2400.00	1.09	69.70	2399.92	4.07N	1.03W	0.30	-4.20	435197.97	232505.07

All data in feet unless otherwise stated. Calculation uses minimum curvature method.

Coordinates from slot #1 and TVD from rotary table.

Bottom hole distance is 1435.27 on azimuth 171.49 degrees from wellhead.

Vertical section is from N 0.00 E 0.00 on azimuth 164.95 degrees.

Grid is lambert - Texas North Central (4202).

Lambert coordinates in FEET and computed using the Clarke - 1866 spheroid

Presented by Baker Hughes INTEQ

CROSS TIMBERS OPERATING CO.
University 9 CEC No.8H,slot #1
BLK. 9 DEVONIAN,ANDREWS CO., TEXAS

SURVEY LISTING Page 2
Your ref : Gyro/MWD
Last revised : 26-Sep-2000

Measured Depth	Inclin Degrees	Azimuth Degrees	True Vert Depth	R E C T A N G U L A R C O O R D I N A T E S		Dogleg Deg/100ft	Vert Sect	G R I D Easting	C O O R D S Northing
2500.00	0.88	86.69	2499.91	4.44N	0.63E	0.36	-4.13	435199.63	232505.44
2600.00	1.04	66.80	2599.90	4.84N	2.23E	0.37	-4.10	435201.23	232505.84
2700.00	1.08	85.86	2699.88	5.27N	4.00E	0.35	-4.05	435203.00	232506.27
2800.00	1.09	88.84	2799.86	5.36N	5.90E	0.06	-3.64	435204.90	232506.36
2900.00	1.08	82.60	2899.84	5.50N	7.79E	0.12	-3.29	435206.79	232506.50
3000.00	1.45	79.75	2999.82	5.84N	9.96E	0.38	-3.06	435208.96	232506.84
3100.00	1.55	83.35	3099.78	6.23N	12.56E	0.14	-2.75	435211.56	232507.23
3200.00	1.35	90.36	3199.75	6.38N	15.08E	0.27	-2.24	435214.08	232507.38
3300.00	1.23	97.54	3299.73	6.23N	17.32E	0.20	-1.52	435216.32	232507.23
3400.00	1.10	98.89	3399.71	5.94N	19.34E	0.13	-0.71	435218.34	232506.94
3500.00	0.94	85.10	3499.69	5.86N	21.11E	0.29	-0.18	435220.11	232506.86
3600.00	0.95	72.00	3599.68	6.19N	22.72E	0.22	-0.08	435221.72	232507.19
3700.00	0.87	72.19	3699.66	6.67N	24.22E	0.08	-0.15	435223.22	232507.67
3800.00	0.82	66.75	3799.65	7.19N	25.60E	0.09	-0.29	435224.60	232508.19
3900.00	0.81	67.46	3899.64	7.74N	26.92E	0.02	-0.49	435225.92	232508.74
4000.00	0.46	66.18	3999.64	8.18N	27.94E	0.35	-0.64	435226.94	232509.18
4100.00	0.46	82.02	4099.63	8.39N	28.70E	0.13	-0.65	435227.70	232509.39
4200.00	0.16	253.37	4199.63	8.41N	28.96E	0.61	-0.60	435227.96	232509.41
4300.00	0.21	218.33	4299.63	8.23N	28.71E	0.12	-0.49	435227.71	232509.23
4400.00	0.77	221.92	4399.63	7.58N	28.15E	0.56	-0.01	435227.15	232508.58
4500.00	0.94	234.00	4499.62	6.60N	27.03E	0.25	0.65	435226.03	232507.60
4600.00	0.88	235.59	4599.60	5.68N	25.74E	0.07	1.20	435224.74	232506.68
4700.00	0.89	238.66	4699.59	4.84N	24.44E	0.05	1.67	435223.44	232505.84
4800.00	1.08	241.99	4799.58	4.00N	22.95E	0.20	2.10	435221.95	232505.00
4900.00	1.03	233.31	4899.56	3.02N	21.39E	0.17	2.64	435220.39	232504.02

All data in feet unless otherwise stated. Calculation uses minimum curvature method.

Coordinates from slot #1 and TVD from rotary table.

Bottom hole distance is 1435.27 on azimuth 171.49 degrees from wellhead.

Vertical section is from N 0.00 E 0.00 on azimuth 164.95 degrees.

Grid is lambert - Texas North Central (4202).

Lambert coordinates in FEET and computed using the Clarke - 1866 spheroid

Presented by Baker Hughes INTEQ

CROSS TIMBERS OPERATING CO.
University 9 CEC No.8H,slot #1
BLK. 9 DEVONIAN,ANDREWS CO., TEXAS

SURVEY LISTING Page 3
Your ref : Gyro/MWD
Last revised : 26-Sep-2000

Measured Depth	Inclin Degrees	Azimuth Degrees	True Vert Depth	R E C T A N G U L A R C O O R D I N A T E S		Dogleg Deg/100ft	Vert Sect	G R I D Easting	C O O R D S Northing
5000.00	0.85	229.64	4999.55	2.00N	20.11E	0.19	3.29	435219.11	232503.00
5100.00	0.76	237.24	5099.54	1.16N	18.98E	0.14	3.81	435217.98	232502.16
5200.00	1.09	239.77	5199.52	0.32N	17.60E	0.34	4.26	435216.60	232501.32
5300.00	0.85	255.85	5299.51	0.34S	16.06E	0.37	4.50	435215.06	232500.66
5400.00	0.98	262.24	5399.50	0.64S	14.49E	0.17	4.38	435213.49	232500.36
5500.00	1.20	259.39	5499.48	0.95S	12.60E	0.23	4.19	435211.60	232500.05
5600.00	1.18	257.14	5599.46	1.37S	10.56E	0.05	4.07	435209.56	232499.63
5700.00	0.79	250.08	5699.44	1.84S	8.91E	0.41	4.09	435207.91	232499.16
5800.00	0.89	262.75	5799.43	2.17S	7.50E	0.21	4.04	435206.50	232498.83
5900.00	0.89	248.31	5899.42	2.55S	6.00E	0.22	4.02	435205.00	232498.45
6000.00	0.28	197.60	5999.41	3.07S	5.21E	0.74	4.32	435204.21	232497.93
6100.00	0.58	199.20	6099.41	3.79S	4.97E	0.30	4.95	435203.97	232497.21
6200.00	0.22	189.47	6199.41	4.45S	4.77E	0.37	5.54	435203.77	232496.55
6300.00	0.56	166.27	6299.41	5.11S	4.85E	0.37	6.20	435203.85	232495.89
6400.00	0.50	157.91	6399.40	5.99S	5.13E	0.09	7.12	435204.13	232495.01
6500.00	0.49	175.18	6499.40	6.82S	5.34E	0.15	7.97	435204.34	232494.18
6600.00	0.64	189.33	6599.39	7.80S	5.28E	0.20	8.90	435204.28	232493.20
6700.00	0.97	187.98	6699.38	9.19S	5.07E	0.33	10.19	435204.07	232491.81
6800.00	0.92	176.90	6799.37	10.83S	5.00E	0.19	11.76	435204.00	232490.17
6900.00	0.63	196.29	6899.36	12.16S	4.89E	0.39	13.02	435203.89	232488.84
7000.00	0.83	209.13	6999.35	13.32S	4.38E	0.26	14.00	435203.38	232487.68
7100.00	0.49	198.01	7099.35	14.36S	3.90E	0.36	14.88	435202.90	232486.64
7200.00	0.70	205.39	7199.34	15.31S	3.51E	0.22	15.70	435202.51	232485.69
7300.00	0.40	253.23	7299.34	15.96S	2.91E	0.52	16.17	435201.91	232485.04
7400.00	0.58	253.24	7399.33	16.21S	2.09E	0.17	16.20	435201.09	232484.79

All data in feet unless otherwise stated. Calculation uses minimum curvature method.

Coordinates from slot #1 and TVD from rotary table.

Bottom hole distance is 1435.27 on azimuth 171.49 degrees from wellhead.

Vertical section is from N 0.00 E 0.00 on azimuth 164.95 degrees.

Grid is lambert - Texas North Central (4202).

Lambert coordinates in FEET and computed using the Clarke - 1866 spheroid

Presented by Baker Hughes INTEQ

CROSS TIMBERS OPERATING CO.
University 9 CEC No.8H,slot #1
BLK. 9 DEVONIAN,ANDREWS CO., TEXAS

SURVEY LISTING Page 4
Your ref : Gyro/MWD
Last revised : 26-Sep-2000

Measured Depth	Inclin Degrees	Azimuth Degrees	True Vert Depth	R E C T A N G U L A R C O O R D I N A T E S		Dogleg Deg/100ft	Vert Sect	G R I D Easting	C O O R D S Northing
7500.00	0.40	255.78	7499.33	16.44S	1.27E	0.18	16.21	435200.27	232484.56
7600.00	0.76	273.73	7599.32	16.48S	0.28E	0.40	15.99	435199.28	232484.52
7700.00	0.63	253.19	7699.32	16.60S	0.91W	0.28	15.79	435198.09	232484.40
7800.00	0.55	258.47	7799.31	16.85S	1.90W	0.10	15.78	435197.10	232484.15
7900.00	0.27	279.56	7899.31	16.91S	2.61W	0.31	15.65	435196.39	232484.09
8000.00	0.54	250.82	7999.31	17.02S	3.29W	0.32	15.59	435195.71	232483.98
8100.00	0.19	208.09	8099.30	17.32S	3.81W	0.42	15.74	435195.19	232483.68
8200.00	0.18	195.76	8199.30	17.63S	3.93W	0.04	16.00	435195.07	232483.37
8300.00	0.24	326.07	8299.30	17.61S	4.09W	0.38	15.94	435194.91	232483.39
8400.00	0.55	323.45	8399.30	17.05S	4.49W	0.32	15.30	435194.51	232483.95
8500.00	0.49	320.59	8499.30	16.34S	5.05W	0.07	14.47	435193.95	232484.66
8600.00	0.56	317.77	8599.29	15.64S	5.65W	0.08	13.64	435193.35	232485.36
8700.00	0.47	301.71	8699.29	15.07S	6.32W	0.17	12.91	435192.68	232485.93
8800.00	0.30	300.30	8799.29	14.72S	6.90W	0.16	12.42	435192.10	232486.28
8900.00	0.04	93.37	8899.29	14.59S	7.10W	0.34	12.24	435191.90	232486.41
9000.00	0.10	22.83	8999.29	14.51S	7.03W	0.09	12.19	435191.97	232486.49
9100.00	0.57	342.21	9099.28	13.96S	7.15W	0.50	11.63	435191.85	232487.04
9200.00	0.33	319.84	9199.28	13.27S	7.49W	0.29	10.87	435191.51	232487.73
9300.00	0.17	258.17	9299.28	13.08S	7.81W	0.29	10.61	435191.19	232487.92
9400.00	0.07	111.45	9399.28	13.14S	7.91W	0.23	10.63	435191.09	232487.86
9500.00	0.13	359.66	9499.28	13.04S	7.85W	0.17	10.55	435191.15	232487.96
9600.00	0.19	289.37	9599.28	12.87S	8.01W	0.19	10.35	435190.99	232488.13
9700.00	0.58	245.11	9699.28	13.03S	8.62W	0.47	10.34	435190.38	232487.97
9800.00	1.42	196.51	9799.26	14.43S	9.44W	1.12	11.48	435189.56	232486.57
9900.00	1.72	176.07	9899.23	17.10S	9.69W	0.63	14.00	435189.31	232483.90

All data in feet unless otherwise stated. Calculation uses minimum curvature method.

Coordinates from slot #1 and TVD from rotary table.

Bottom hole distance is 1435.27 on azimuth 171.49 degrees from wellhead.

Vertical section is from N 0.00 E 0.00 on azimuth 164.95 degrees.

Grid is lambert - Texas North Central (4202).

Lambert coordinates in FEET and computed using the Clarke - 1866 spheroid

Presented by Baker Hughes INTEQ

CROSS TIMBERS OPERATING CO.
University 9 CEC No.8H,slot #1
BLK. 9 DEVONIAN,ANDREWS CO., TEXAS

SURVEY LISTING Page 5
Your ref : Gyro/MWD
Last revised : 26-Sep-2000

Measured Depth	Inclin Degrees	Azimuth Degrees	True Vert Depth	R E C T A N G U L A R C O O R D I N A T E S	Dogleg Deg/100ft	Vert Sect	G R I D Easting	C O O R D S Northing	
10000.00	1.21	190.50	9999.19	19.63S	9.78W	0.63	16.42	435189.22	232481.37
10100.00	1.13	202.06	10099.17	21.58S	10.34W	0.25	18.16	435188.66	232479.42
10200.00	1.31	203.26	10199.15	23.54S	11.16W	0.18	19.84	435187.84	232477.46
10300.00	1.11	219.15	10299.13	25.34S	12.22W	0.39	21.30	435186.78	232475.66
10380.00	1.16	222.24	10379.11	26.54S	13.25W	0.10	22.19	435185.75	232474.46
10412.00	14.90	188.00	10410.73	30.87S	14.04W	43.61	26.17	435184.96	232470.13
10429.00	27.30	180.60	10426.56	36.96S	14.39W	74.47	31.95	435184.61	232464.04
10439.00	35.20	184.50	10435.10	42.13S	14.64W	81.51	36.89	435184.36	232458.87
10449.00	41.70	185.90	10442.93	48.32S	15.21W	65.58	42.72	435183.79	232452.68
10460.00	47.40	194.30	10450.77	55.90S	16.59W	74.45	49.67	435182.41	232445.10
10470.00	53.20	192.90	10457.16	63.37S	18.39W	58.99	56.42	435180.61	232437.63
10480.00	59.60	187.00	10462.69	71.57S	19.82W	80.65	63.97	435179.18	232429.43
10492.00	65.60	183.10	10468.21	82.18S	20.74W	57.72	73.97	435178.26	232418.82
10502.00	72.20	180.30	10471.81	91.50S	21.01W	70.97	82.90	435177.99	232409.50
10514.00	79.10	175.70	10474.79	103.10S	20.60W	68.44	94.22	435178.40	232397.90
10546.00	83.00	177.10	10479.76	134.64S	18.62W	12.93	125.19	435180.38	232366.36
10578.00	83.00	177.80	10483.66	166.37S	17.21W	2.17	156.20	435181.79	232334.63
10609.00	85.30	178.50	10486.82	197.19S	16.21W	7.75	186.22	435182.79	232303.81
10640.00	86.40	181.70	10489.07	228.11S	16.27W	10.89	216.06	435182.73	232272.89
10671.00	87.40	184.10	10490.74	259.02S	17.83W	8.38	245.51	435181.17	232241.98
10703.00	87.70	187.70	10492.11	290.82S	21.12W	11.28	275.36	435177.88	232210.18
10735.00	87.90	190.50	10493.34	322.39S	26.17W	8.77	304.53	435172.83	232178.61
10767.00	90.40	190.80	10493.82	353.83S	32.09W	7.87	333.36	435166.91	232147.17
10799.00	90.70	191.20	10493.51	385.24S	38.19W	1.56	362.11	435160.81	232115.76
10829.00	90.70	191.20	10493.14	414.67S	44.02W	0.00	389.01	435154.98	232086.33

All data in feet unless otherwise stated. Calculation uses minimum curvature method.

Coordinates from slot #1 and TVD from rotary table.

Bottom hole distance is 1435.27 on azimuth 171.49 degrees from wellhead.

Vertical section is from N 0.00 E 0.00 on azimuth 164.95 degrees.

Grid is lambert - Texas North Central (4202).

Lambert coordinates in FEET and computed using the Clarke - 1866 spheroid

Presented by Baker Hughes INTEQ

CROSS TIMBERS OPERATING CO.
University 9 CEC No.8H,slot #1
BLK. 9 DEVONIAN,ANDREWS CO., TEXAS

SURVEY LISTING Page 6
Your ref : Gyro/MWD
Last revised : 26-Sep-2000

Measured Depth	Inclin Degrees	Azimuth Degrees	True Vert Depth	R E C T A N G U L A R C O O R D I N A T E S	Dogleg Deg/100ft	Vert Sect	G R I D Easting	C O O R D S Northing
10861.00	91.80	191.20	10492.44	446.05S	50.23W	3.44	417.71	232054.95
10893.00	92.50	191.20	10491.24	477.42S	56.44W	2.19	446.39	232023.58
10925.00	92.30	190.80	10489.90	508.80S	62.54W	1.40	475.11	231992.20
10956.00	89.50	190.10	10489.42	539.28S	68.17W	9.31	503.08	231961.72
10988.00	88.80	188.00	10489.89	570.88S	73.20W	6.92	532.29	231930.12
11020.00	88.50	186.50	10490.65	602.61S	77.24W	4.78	561.89	231898.39
11052.00	89.20	184.10	10491.29	634.47S	80.19W	7.81	591.88	231866.53
11083.00	89.60	182.70	10491.61	665.41S	82.03W	4.70	621.29	231835.59
11115.00	89.70	181.00	10491.81	697.39S	83.06W	5.32	651.90	231803.61
11147.00	89.70	178.50	10491.98	729.39S	82.92W	7.81	682.84	231771.61
11178.00	88.90	175.70	10492.35	760.34S	81.35W	9.39	713.14	231740.66
11209.00	89.20	172.90	10492.87	791.18S	78.28W	9.08	743.72	231709.82
11241.00	89.70	169.70	10493.18	822.81S	73.44W	10.12	775.52	231678.19
11273.00	89.90	168.00	10493.29	854.20S	67.25W	5.35	807.44	231646.80
11304.00	89.70	166.20	10493.40	884.42S	60.33W	5.84	838.42	231616.58
11336.00	89.50	163.70	10493.62	915.32S	52.02W	7.84	870.41	231585.68
11368.00	89.20	161.30	10493.98	945.83S	42.40W	7.56	902.38	231555.17
11399.00	88.80	158.80	10494.52	974.97S	31.82W	8.17	933.26	231526.03
11431.00	86.60	157.40	10495.81	1004.63S	19.90W	8.15	965.00	231496.37
11462.00	86.00	155.70	10497.81	1033.01S	7.59W	5.80	995.61	231467.99
11494.00	85.30	155.00	10500.23	1062.01S	5.72E	3.09	1027.07	231438.99
11526.00	85.40	154.30	10502.83	1090.83S	19.37E	2.20	1058.45	231410.17
11558.00	85.50	153.20	10505.37	1119.44S	33.48E	3.44	1089.74	231381.56
11589.00	85.60	151.80	10507.77	1146.85S	47.75E	4.51	1119.92	231354.15
11621.00	86.10	150.40	10510.09	1174.80S	63.18E	4.63	1150.90	231326.20

All data in feet unless otherwise stated. Calculation uses minimum curvature method.

Coordinates from slot #1 and TVD from rotary table.

Bottom hole distance is 1435.27 on azimuth 171.49 degrees from wellhead.

Vertical section is from N 0.00 E 0.00 on azimuth 164.95 degrees.

Grid is lambert - Texas North Central (4202).

Lambert coordinates in FEET and computed using the Clarke - 1866 spheroid

Presented by Baker Hughes INTEQ

CROSS TIMBERS OPERATING CO.
University 9 CEC No.8H,slot #1
BLK. 9 DEVONIAN,ANDREWS CO., TEXAS

SURVEY LISTING Page 7
Your ref : Gyro/MWD
Last revised : 26-Sep-2000

Measured Depth	Inclin Degrees	Azimuth Degrees	True Vert Depth	R E C T A N G U L A R C O O R D I N A T E S	Dogleg Deg/100ft	Vert Sect	G R I D Easting	C O O R D S Northing	
11651.00	86.70	150.40	10511.97	1200.83S	77.97E	2.00	1179.88	435276.97	231300.17
11684.00	87.90	150.40	10513.53	1229.49S	94.25E	3.64	1211.79	435293.25	231271.51
11699.00	88.80	150.00	10513.96	1242.50S	101.70E	6.57	1226.29	435300.70	231258.50
11716.00	89.60	150.40	10514.20	1257.25S	110.15E	5.26	1242.73	435309.15	231243.75
11748.00	90.40	151.40	10514.20	1285.21S	125.71E	4.00	1273.77	435324.71	231215.79
11779.00	88.90	149.70	10514.39	1312.20S	140.95E	7.31	1303.79	435339.95	231188.80
11811.00	88.50	147.90	10515.11	1339.57S	157.52E	5.76	1334.52	435356.52	231161.43
11843.00	88.90	146.20	10515.84	1366.41S	174.92E	5.46	1364.96	435373.92	231134.59
11867.00	89.60	145.10	10516.15	1386.22S	188.46E	5.43	1387.61	435387.46	231114.78
11908.00	90.70	143.20	10516.04	1419.45S	212.47E	5.35	1425.94	435411.47	231081.55

All data in feet unless otherwise stated. Calculation uses minimum curvature method.

Coordinates from slot #1 and TVD from rotary table.

Bottom hole distance is 1435.27 on azimuth 171.49 degrees from wellhead.

Vertical section is from N 0.00 E 0.00 on azimuth 164.95 degrees.

Grid is lambert - Texas North Central (4202).

Lambert coordinates in FEET and computed using the Clarke - 1866 spheroid

Presented by Baker Hughes INTEQ

JUL 15 1999

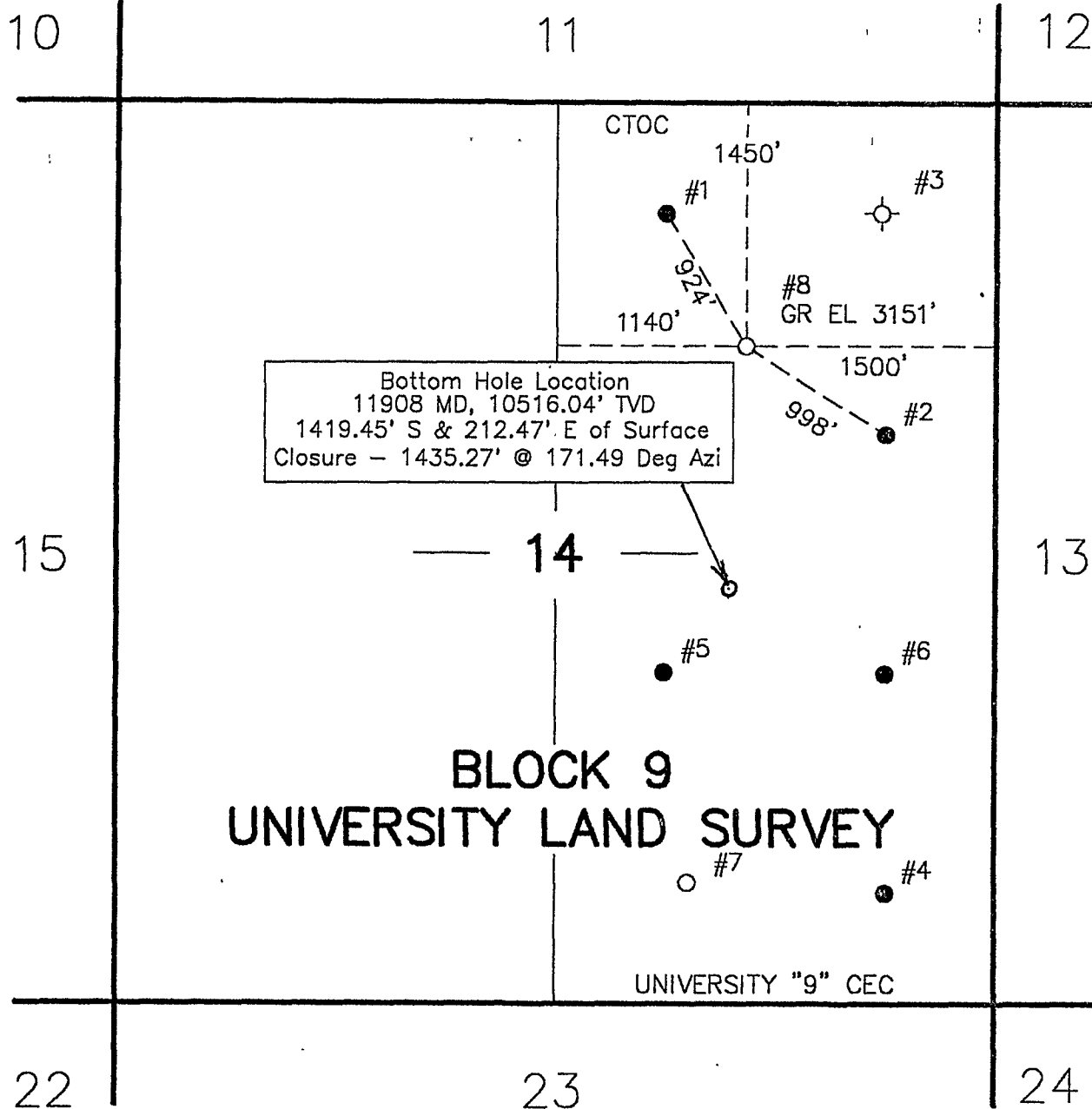

NOTE: THIS PERMIT PLAT HAS BEEN PREPARED FROM A CERTIFIED SURVEY PLAT ON FILE IN THE OFFICE OF WATSON & ASSOCIATES, MIDLAND, TEXAS.

NAD 27, TEXAS NORTH CENTRAL ZONE COORD'S
OF THE #8: N=232501', E=435199'.
LATITUDE & LONGITUDE OF THE #8:
LAT=32°12'08", LONG=102°33'38".

APPROXIMATELY 6.7 MILES SOUTHWEST OF ANDREWS, TEXAS

PERMIT PLAT
CROSS TIMBERS OPERATING COMPANY
UNIVERSITY "9" CEC #8
1450' FNL & 1500' FEL
SECTION 14, BLOCK 9
UNIVERSITY LAND SURVEY
ANDREWS COUNTY, TEXAS

SCALE 1"=1000'

**WATSON AND
ASSOCIATES OF
MIDLAND, INC.**

CONSULTING ENGINEERS
&
LAND SURVEYORS
P.O. DRAWER 11186
MIDLAND, TEXAS
(915) 520-9200

DATE: JULY 7, 1999 ACAD FILE: S148LK8UL.DWG
F/B: 284/69 DRAWN BY: SW REV.:
DATE SURVEYED 7/1/99

I, W. D. WATSON, JR., CERTIFY UNDER PENALTY OF PERJURY UNDER THE LAWS OF THE UNITED STATES OF AMERICA THAT THE SURVEY INFORMATION FOUND ON THIS PLAT WAS PLOTTED FROM THE NOTES OF ACTUAL SURVEYS MADE BY ME OR UNDER MY SUPERVISION AND THE SAME IS TRUE TO THE BEST OF MY KNOWLEDGE AND BELIEF. A DISSENT HAS BEEN MADE TO PLACE IN ORIGINAL POSITION THE SOUNDING DOWN IN THIS PLAT. INFORMATION FROM COPIES OF RECORDS AND RECORDS AND EVIDENCE LOCATED FROM ACTUAL FIELD SURVEYS WERE USED IN ESTABLISHING THESE BOUNDARIES. SEE 309 SW 2, 30, 39 MICH 601, AND 274 P 112 FOR THE CORRECTION OF ORIGINAL LINES AND CORNERS. NO WARRANTY IS MADE BY WATSON & ASSOCIATES, INC. FOR THE LOCATION OF ANY OR ALL EASEMENTS THAT MAY BE AFFECTED BY THIS SURVEY. CONSULT A LAND ATTORNEY REGARDING THE AUTHORITY OF THE SURVEYING FACTS AND CONSTRUCTION OF BOUNDARIES ON THIS PLAT. THIS SERVICE, AS PROVIDED BY WATSON & ASSOCIATES, INC., IS A PROFESSIONAL LAND SURVEYING AS DEFINED BY ARTICLE 663.23 OF THE PROFESSIONAL LAND SURVEYING ACT AND THE GENERAL RULES OF PROCEDURES AND PRACTICE. THE PERSON PRESENTED ON THIS PLAT IS FOR THE PRIVATE USE OF THE PARTY NAMED IN THE TITLE BLOCK.

TEXAS REG. 1046