

Application to Drill,
Deepen or Plug Back.

LEASE WIRE PERMIT

RAILROAD COMMISSION OF TEXAS
OIL AND GAS DIVISION

Form 1
Rev. 4/20/59

STATE WHETHER THIS IS AN APPLICATION TO DRILL, DEEPEN OR PLUG BACK Drill
SHALL BE FILED IN DUPLICATE (IN TRIPPLICATE IF RULE 37) WITH DEPUTY SUPERVISOR OF DISTRICT IN WHICH WELL IS LOCATED
DATA FURNISHED ON THIS FORM AND ANY ATTACHMENT HERETO MUST BE CLEARLY LEGIBLE,
ANY ILLEGIBLE FORM WILL BE RETURNED WITHOUT COMMISSION ACTION.
(Black Ink or Black Typewriter Ribbon Preferable)

READ CAREFULLY AND
COMPLY FULLY

In order that it may be ascertained whether or not the proposed location covered by this notice conforms to the applicable spacing regulations set down by the Railroad Commission, there are two important footages that must be shown; that is, THE NEAREST DISTANCE OF PROPOSED LOCATION FROM LEASE OR PROPERTY LINE AND DISTANCE OF PROPOSED LOCATION FROM THE NEAREST WELL ON THE SAME LEASE. Do not begin drilling operations on any location prior to filing Form 1 and until permit granted by the Commission has been received and waiting clause period has terminated.

For the purpose of this determination draw on the back side hereof a neat, accurate sketch, made to scale, of this lease, block, or lot locating thereon the proposed site for this location with reference to the two nearest lease lines. Also show the nearest wells on all sides of this location and the distance from the proposed location to those wells. In addition to the foregoing, unit boundary designations must be shown for each producing well on the lease and shall include proposed unit boundaries for the location herein applied for showing the acreage to be assigned this well. Give names and addresses of adjoining lease or property owners, and designate all property by lease and company name. You may attach a blue print showing this information if you so desire.

DO NOT CONFUSE SURVEY LINES WITH LEASE LINES. IF THE SKETCH OR BLUE PRINT SHOWS ONLY A SECTION, BLOCK, OR LOT OUT OF YOUR LEASE, DESIGNATE SAME AS BEING ONLY THAT PART OF THE LEASE.

Where the size of the tract will permit, use scale of one inch equaling 1000 feet; if less than 2 acres use scale of one inch equaling 100 feet. DESIGNATE SCALE TO WHICH PLAT OR SKETCH IS DRAWN. ALSO DESIGNATE NORTHERLY DIRECTION ON THE SKETCH OR PLAT.

FILL IN BELOW IN THE SPACES RESERVED FOR THIS PURPOSE THE FOOTAGES ASKED FOR:

Nearest distance from proposed location to property or lease line 467 feet.

Distance from proposed location to nearest drilling, completed, or applied for well on same lease 1162 feet.

Date October 3, 19 60

Name of company or operator

Name Ralph Pembroke

Address Box 953

City Midland, Texas

Description of farm or lease:

Name of Lease Buffalo-University 11143

Number of Acres 160 Well No. 2

Number of wells on lease 1

Elevation _____ Section No. 3 Block No. 1
(Ft. above sea level)

Survey Univ. Lands

Zone or Reservoir Penn & Wolfcamp

To be Located in Bakke (Penn) & (Wolfcamp) Field

(If Wildcat state above, also state Distance and Direction from nearest Survey Lines.) 467 NL 1820 WL Sec. 3

Andrews County

5 Miles South direction from

Andrews nearest post office or town.

Rotary or Cable Tools Rotary

Date work will start drilling at once

Depth to which you propose to drill 9300 feet.

Date work will start deepening _____

Approved _____
Answered _____
IF LEASE PURCHASED WITH ONE OR MORE WELLS DRILLED,
FROM WHOM PURCHASED?

Name _____

Refer to _____

Please Answer _____

Read and Return _____

This well will be dually completed in Penn and Wolfcamp.

NOTICE: Before sending in this form be sure that you have given all information requested. Much unnecessary correspondence will thus be avoided.

DRAW SKETCH AND MAKE AFFIDAVIT ON REVERSE SIDE

NORTH

NO ALLOWABLE WILL BE ASSIGNED to any well which does not have sufficient surface casing to protect all fresh water sands. Where Commission rules do not specify surface casing requirements, it will be necessary to contact Board of Water Engineers, Austin, Texas, to ascertain the depth to which fresh water sands must be protected.

SOUTH

Name Everett L. Smith, Title Agent

Notary Public Midland County, Texas

Name _____ Address _____

J. HARBELIS SURVEY BLOCK P, Section 110
Continental Oil Co.
Parker Estate "A"

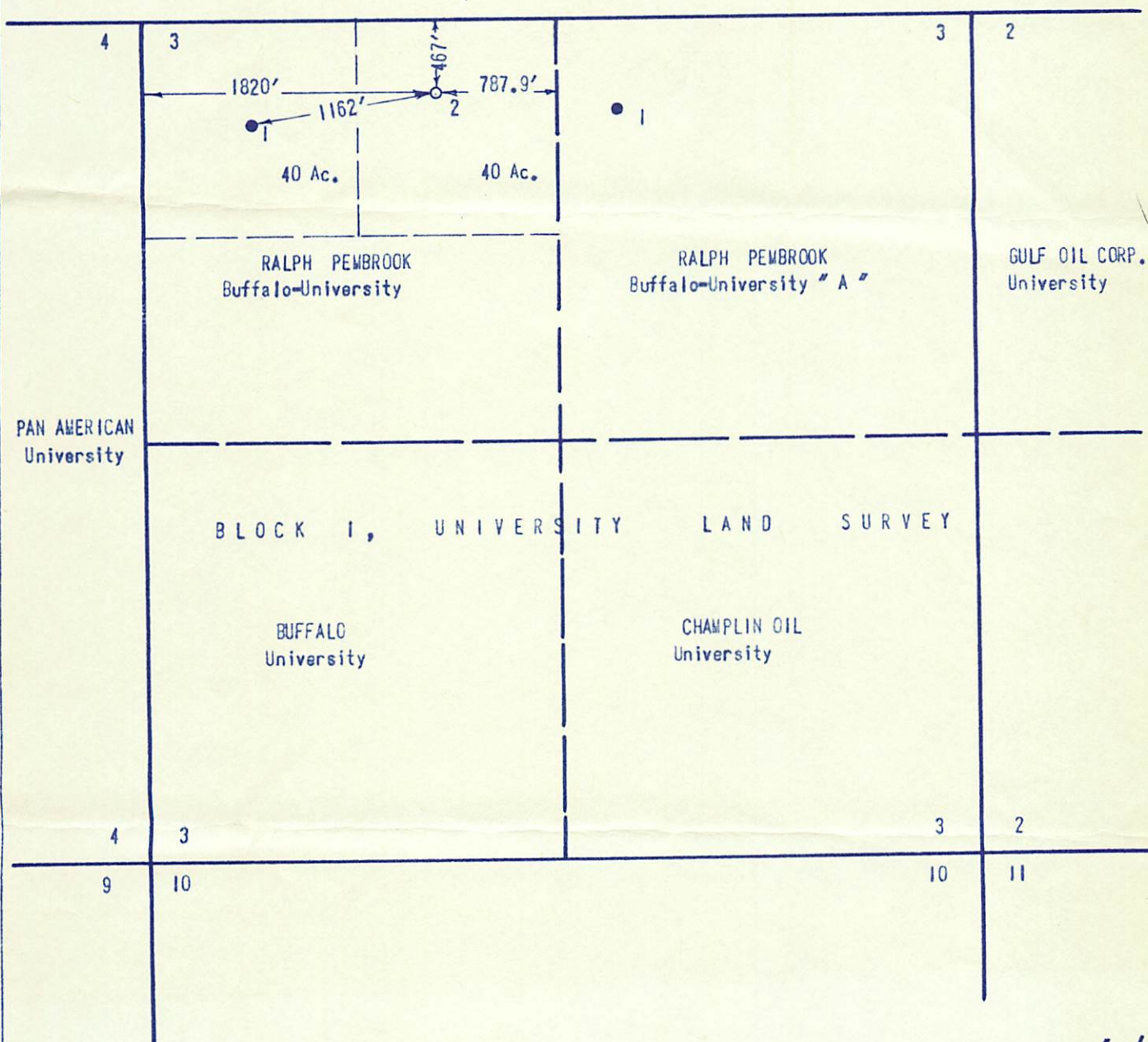

RALPH PEMBROOK Buffalo-University Lease 157.235 Acres

Well No. 1, 660'/N. & 660'/W. of Section
Well No. 2, 1820'/W. & 467'/N. of Section

Ground Elevation 3134.'
Ground Elevation 3119.'

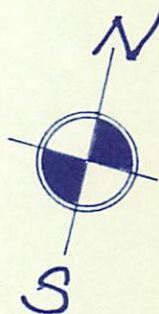

I, W. L. Drake, REGISTERED
PUBLIC SURVEYOR, HEREBY CERTIFY THAT THIS
SURVEY WAS MADE BY ME ON THE GROUND, AND
THAT THIS PLAT IS A CORRECT REPRESENTATION
THEREOF.

THIS 30 th DAY OF September, 1960.



LOCATION PLAT

RALPH PEMBROOK
Buffalo-University Lease
Section 3, Block 1, University Land Survey
Andrews County, Texas.

SCALE 1" = 1000'

JOB NO.
5508