

22902-DE/4

API No. <u>42-003-04772</u> Drilling Permit # <u>649939</u> SWR Exemption Case/Docket No. _____		<b>RAILROAD COMMISSION OF TEXAS</b> <b>OIL &amp; GAS DIVISION</b> <b>APPLICATION FOR PERMIT TO DRILL, RECOMPLETE, OR RE-ENTER</b> <i>This facsimile W-1 was generated electronically from data submitted to the RRC.</i> <i>A certification of the automated data is available in the RRC's Austin office.</i>			<b>FORM W-1</b> 07/2004 Permit Status: <b>Approved</b>	
1. RRC Operator No. <u>810874</u>		2. Operator's Name (as shown on form P-5, Organization Report) <b>ST. MARY LAND &amp; EXPLORATION CO.</b>		3. Operator Address (include street, city, state, zip): <b>330 MARSHALL STREET SUITE 1200</b> <b>SHREVEPORT, LA 71101</b>		
4. Lease Name <b>UNIVERSITY ANDREWS A</b>		5. Well No. <u>55</u>				
<b>GENERAL INFORMATION</b>						
6. Purpose of filing (mark ALL appropriate boxes): <input type="checkbox"/> New Drill <input checked="" type="checkbox"/> <b>Recompletion</b> <input type="checkbox"/> Reclass <input type="checkbox"/> Field Transfer <input type="checkbox"/> Re-Enter <input type="checkbox"/> Amended <input type="checkbox"/> Amended as Drilled (BHL) (Also File Form W-1D)						
7. Wellbore Profile (mark ALL appropriate boxes): <input checked="" type="checkbox"/> Vertical <input type="checkbox"/> Horizontal (Also File Form W-1H) <input type="checkbox"/> Directional (Also File Form W-1D) <input type="checkbox"/> Sidetrack						
8. Total Depth <u>4000</u>		9. Do you have the right to develop the minerals under any right-of-way? <input checked="" type="checkbox"/> Yes <input type="checkbox"/> No		10. Is this well subject to Statewide Rule 36 (hydrogen sulfide area)? <input type="checkbox"/> Yes <input checked="" type="checkbox"/> No		
<b>SURFACE LOCATION AND ACREAGE INFORMATION</b>						
11. RRC District No. <u>08</u>		12. County <u>ANDREWS</u>		13. Surface Location <input checked="" type="checkbox"/> Land <input type="checkbox"/> Bay/Estuary <input type="checkbox"/> Inland Waterway <input type="checkbox"/> Offshore		
14. This well is to be located <u>17.1</u> miles in a <u>SW</u> direction from <u>Andrews</u> which is the nearest town in the county of the well site.						
15. Section <u>25</u>	16. Block <u>11</u>	17. Survey <u>UL</u>	18. Abstract No. <u>A-</u>	19. Distance to nearest lease line: <u>643</u> ft.	20. Number of contiguous acres in lease, pooled unit, or unitized tract: <u>40</u>	
21. Lease Perpendiculars: <u>653</u> ft from the <u>NORTH</u> line and <u>677</u> ft from the <u>EAST</u> line. 22. Survey Perpendiculars: <u>1987</u> ft from the <u>SOUTH</u> line and <u>677</u> ft from the <u>EAST</u> line.						
23. Is this a pooled unit? <input type="checkbox"/> Yes <input checked="" type="checkbox"/> No		24. Unitization Docket No: _____		25. Are you applying for Substandard Acreage Field? <input type="checkbox"/> Yes (attach Form W-1A) <input checked="" type="checkbox"/> No		
<b>FIELD INFORMATION</b> List all fields of anticipated completion including Wildcat. List one zone per line.						
26. RRC District No.	27. Field No.	28. Field Name (exactly as shown in RRC records)	29. Well Type	30. Completion Depth	31. Distance to Nearest Well in this Reservoir	
<u>08</u>	<u>28843777</u>	<u>EMBAR (YATES)</u>	<u>Gas Well</u>	<u>3200</u>	<u>0.00</u>	
<b>BOTTOMHOLE LOCATION INFORMATION</b> is required for DIRECTIONAL, HORIZONTAL, AND AMENDED AS DRILLED PERMIT APPLICATIONS						
<b>Remarks</b> [FILER Nov 19, 2007 2:50 PM]: Plug back of Conoco/Sloan, lease #21905. P-4 is processing.; [RRC STAFF Nov 28, 2007 11:56 AM]: There have been problems identified with this permit (see problem letter attachment). Notification sent.; [RRC STAFF Dec 3, 2007 3:47 PM]: Lease name and acreage corrected per Ann Ritchie.; [RRC STAFF Dec 3, 2007 3:48 PM]: Problems identified with this permit are resolved.; [RRC STAFF Dec 4, 2007 1:17 PM]: Nearest lease line corrected to reflect distance shown on plat that is closer than what operator is stating.			<b>Certificate:</b> I certify that information stated in this application is true and complete, to the best of my knowledge.  <div style="display: flex; justify-content: space-between;"> <div> <u>Ann Ritchie</u>            Name of filer  <u>(432)6846381</u>            Phone         </div> <div> <u>Nov 19, 2007</u>            Date submitted  <u>ann.ritchie@wtor.net</u>            E-mail Address (OPTIONAL)         </div> </div>			
RRC Use Only    Data Validation Time Stamp: Dec 5, 2007 4:36 PM( Current Version )						

# TOPOGRAPHIC LAND SURVEYORS OF TEXAS

Surveying and Mapping for the Energy Industry

2803 N. 800 SPRING • MESQUITE, TEXAS 79705  
TELEPHONE: (432) 882-1453 • (800) 767-1453 • FAX (432) 882-1743

ANDREWS County, Texas

Description 1987' FSL & 677' FEL

SECTION 25, BLOCK 11, UNIVERSITY LAND

NOV 27  
END SURVEY

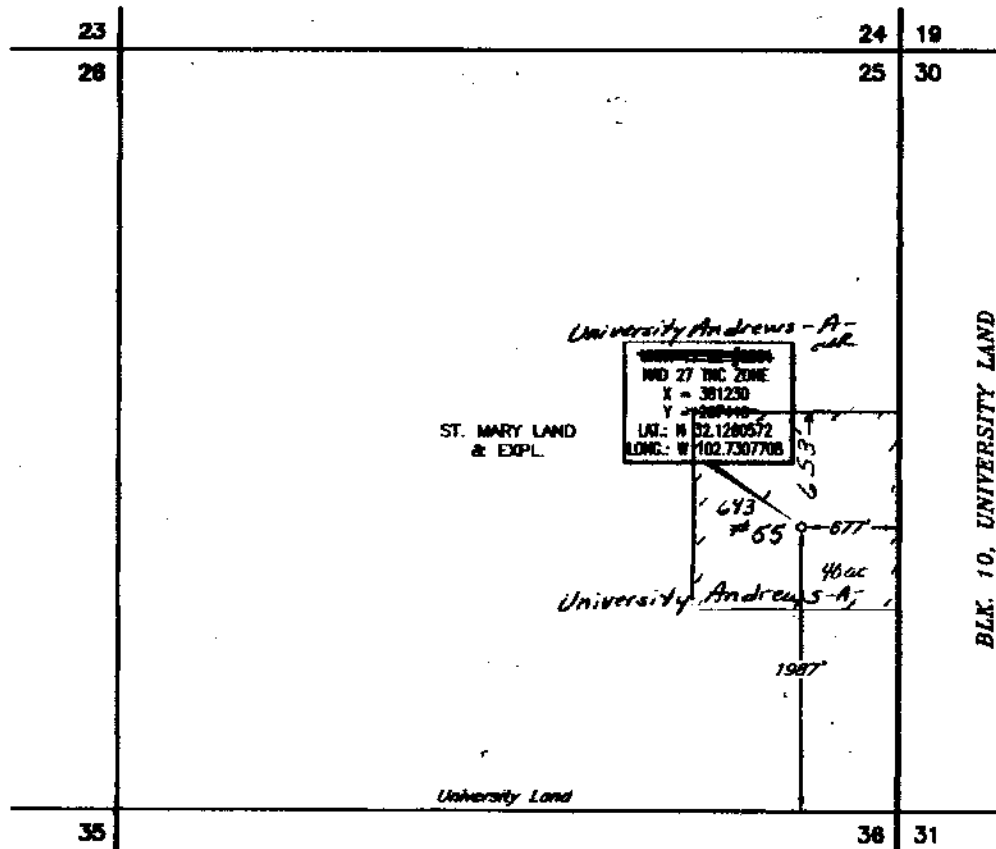

This location has been very carefully staked on the ground according to the best official survey records, maps, and other data available to us. This plot does not in any way represent a "Boundary Survey", and does not comply with current LSPS 11.1. Before Staking of Possession for Boundary Surveys.

Date Staked NOVEMBER 6, 2007

SCALE: 1" = 1000'

Operator ST. MARY LAND & EXPL.

Lease Name & Well No. UNIVERSITY 11 OF BLOCK 11 University Andrews-A-2 well #55

Ground Elev. 3251' Reference Stakes or NONE Reclamation / Plug back

Good Drill Site? YES Stakes Set ±17.1 MILES SOUTHWEST OF ANDREWS, TEXAS

Topography & Vegetation EXISTING WELL PAD

Best Accessibility to Location FROM N-S LEASE ROAD EAST OF WELL

Distance & Direction from Hwy Jct. or Town FROM THE JCT. OF HWY. 181 & COYOTE CORNER ROAD, GO NORTH 0.9 MILES.

THENCE WEST THROUGH CATTLEGUARD, CONTINUE NORTH 0.5 MILES ON LEASE ROAD TO WELL #2501.

Stake # 649939



## CERTIFICATION:

I, Robert J. Overton, Jr., a Registered Professional Land Surveyor, and an authorized agent of Topographic Land Surveyors, do hereby certify that the above described well location was surveyed and staked on the ground as shown herein.

Robert J. Overton, Jr.  
Texas Reg. No. 5916

Invoice # 128123/728NM  
L.A.S.

**RAILROAD COMMISSION OF TEXAS  
OIL & GAS DIVISION**

PERMIT TO DRILL, DEEPEN, PLUG BACK, OR RE-ENTER ON A REGULAR OR ADMINISTRATIVE EXCEPTION LOCATION

<b>PERMIT NUMBER</b> <div style="text-align: right;"><b>649939</b></div>	<b>DATE PERMIT ISSUED OR AMENDED</b> <div style="text-align: center;">Dec 04, 2007</div>	<b>DISTRICT</b> <div style="text-align: center;">* 08</div>
<b>API NUMBER</b> <div style="text-align: right;"><b>42-003-04772</b></div>	<b>FORM W-1 RECEIVED</b> <div style="text-align: center;">Nov 19, 2007</div>	<b>COUNTY</b> <div style="text-align: center;"><b>ANDREWS</b></div>
<b>TYPE OF OPERATION</b> <div style="text-align: center;"><b>RECOMPLETION</b></div>	<b>WELLBORE PROFILE(S)</b> <div style="text-align: center;">Vertical</div>	<b>ACRES</b> <div style="text-align: center;"><b>40</b></div>
<b>OPERATOR</b> <div style="text-align: right;"><b>810874</b></div> <b>ST. MARY LAND &amp; EXPLORATION CO.</b> <b>330 MARSHALL STREET SUITE 1200</b> <b>SHREVEPORT, LA 71101</b>		<b>NOTICE</b> This permit and any allowable assigned may be revoked if payment for fee(s) submitted to the Commission is not honored. <b>District Office Telephone No:</b> <div style="text-align: center;"><b>(432) 684-5581</b></div>
<b>LEASE NAME</b> <div style="text-align: center;"><b>UNIVERSITY ANDREWS A</b></div>		<b>WELL NUMBER</b> <div style="text-align: center;"><b>55</b></div>
<b>LOCATION</b> <div style="text-align: center;"><b>17.1 miles SW direction from ANDREWS</b></div>		<b>TOTAL DEPTH</b> <div style="text-align: center;"><b>4000</b></div>
Section, Block and or Survey <b>SECTION</b> ◀ 25 <b>BLOCK</b> ◀ 11 <b>ABSTRACT</b> ◀ <b>SURVEY</b> ◀ UL		
<b>DISTANCE TO SURVEY LINES</b> <div style="text-align: center;"><b>1987 ft. SOUTH    677 ft. EAST</b></div>		<b>DISTANCE TO NEAREST LEASE LINE</b> <div style="text-align: center;"><b>643 ft.</b></div>
<b>DISTANCE TO LEASE LINES</b> <div style="text-align: center;"><b>653 ft. NORTH    677 ft. EAST</b></div>		<b>DISTANCE TO NEAREST WELL ON LEASE</b> <div style="text-align: center;"><b>See FIELD(s) Below</b></div>
<b>FIELD(s) and LIMITATIONS:</b> <div style="text-align: center;">* SEE FIELD DISTRICT FOR REPORTING PURPOSES *</div>		
<b>FIELD NAME</b> <b>LEASE NAME</b>	<b>ACRES</b> <b>NEAREST LEASE</b>	<b>DEPTH</b> <b>WELL #</b> <b>NEAREST WE</b>
<div style="text-align: right;">DIST</div>		
<hr/> <b>EMBAR (YATES)</b> <b>UNIVERSITY ANDREWS A</b>	<div style="text-align: right;">40.00</div> <div style="text-align: right;">643</div>	<div style="text-align: right;">3,200</div> <div style="text-align: right;">55</div> <div style="text-align: right;">0</div>
<div style="text-align: right;">08</div>		

**THE FOLLOWING RESTRICTIONS APPLY TO ALL FIELDS**

This well shall be completed and produced in compliance with applicable special field or statewide spacing and density rules. If this well is to be used for brine mining, underground storage of liquid hydrocarbons in salt formations, or underground storage of gas in salt formations, a permit for that specific purpose must be obtained from Environmental Services prior to construction, including drilling, of the well in accordance with Statewide Rules 81, 95, and 97.