

Type or print only

UNIVERSITY

SEP 14 1998

LANDS

RAILROAD COMMISSION OF TEXAS

Oil and Gas Division

Form W-2

Rev. 4/1/83

483-046

API No. 42-003-00599

7. RRC District No.

08

8. RRC Lease No.

13440

Oil Well Potential Test, Completion or Recompletion Report, and Log

1. FIELD NAME (as per RRC Records or Wildcat)

Fasken (Wolfcamp)

2. LEASE NAME

University

3. OPERATOR'S NAME (Exactly as shown on Form P-5, Organization Report)

Taurus Exploration U.S.A., Inc.

RRC Operator No.

837189

9. Well No.

2

10. County of well site

Andrews

4. ADDRESS

3300 N. "A" St, Bldg 4, Ste 100, Midland, TX 79705

5. If Operator has changed within last 60 days, name former operator

11. Purpose of filing

Initial Potential ☒Retest ☐Reclass ☐Well record only
(explain in Remarks) ☐

6a. Location (Section, Block, and Survey)

Sec 13, Blk 1, UL

6b. Distance and direction to nearest town in this county.

11 miles SE from Andrews

12. If workover or reclass, give former field (with reservoir) & gas ID or oil lease no.

FIELD & RESERVOIR

Andrews, So. (Devonian)

Fasken (Ellenburger)

GAS ID or

OIL LEASE #

12782

10850

Oil - O

Gas - G

0

0

WELL NO.

2U

2L

13. Type of electric or other log run

GR/CNL/RST, GR/CCL/CBL

14. Completion or recompletion date

7/13/98

SECTION I: POTENTIAL TEST DATA IMPORTANT: Test should be for 24 hours unless otherwise specified in field rules.

15. Date of test 8/16/98	16. No. of hours tested 24	17. Production method (Flowing, Gas Lift, Jetting, Pumping— Size & Type of pump) Pump 2 x 1 1/4 x 30 x 34 RHBC			18. Choke size ----
19. Production during Test Period	Oil - BBLS 17	Gas - MCF 33	Water - BBLS 96	Gas - Oil Ratio 1,941	Flowing Tubing Pressure N/A PSI
20. Calculated 24- Hour Rate	Oil - BBLS	Gas - MCF	Water - BBLS	Oil Gravity—API—60°	Casing Pressure PSI
21. Was swab used during this test? Yes <input type="checkbox"/> No <input checked="" type="checkbox"/>		22. Oil produced prior to test (New & Reworked wells) 466			23. Injection Gas—Oil Ratio

REMARKS:

INSTRUCTIONS: File an original and one copy of the completed Form W-2 in the appropriate RRC District Office within 30 days after completing a well and within 10 days after a potential test. If an operator does not properly report the results of a potential test within the 10-day period, the effective date of the allowable assigned to the well will not extend back more than 10 days before the W-2 was received in the District Office. (Statewide Rules 16 and 51) To report a completion or recompletion, fill in both sides of this form. To report a retest, fill in only the front side.

WELL TESTER'S CERTIFICATION

I declare under penalties prescribed in Sec. 91.143, Texas Natural Resources Code, that I conducted or supervised this test by observation of (a) meter readings or (b) the top and bottom gauges of each tank into which production was run during the test. I further certify that the potential test data shown above is true, correct, and complete, to the best of my knowledge.

Terry Lawler
Signature: Well Tester
Terry Lawler

Taurus Exploration U.S.A., Inc.

Name of Company

RRC Representative

OPERATOR'S CERTIFICATION

I declare under penalties prescribed in Sec. 91.143, Texas Natural Resources Code, that I am authorized to make this report, that this report was prepared by me or under my supervision and direction, and that data and facts stated therein are true, correct, and complete, to the best of my knowledge.

Denise Menoud

Production Tech.

Typed or printed name of operator's representative

Title of Person

(915) 687-2074

8 / 25 / 98

Telephone: Area Code Number

Date: mo. day year

Signature

D. Menoud

SECTION II DATA ON WELL COMPLETION AND LOG (Not Required on Retest)									
24. Type of Completion: New Well <input type="checkbox"/> Deepening <input type="checkbox"/> Plug Back <input checked="" type="checkbox"/> Other <input type="checkbox"/>					25. Permit to Drill, Plug Back or Deepen DATE 7/8/98 PERMIT NO. 477509 Rule 37 Exception 0219812 CASE NO. Water Injection Permit PERMIT NO. Salt Water Disposal Permit PERMIT NO. Other PERMIT NO.				
26. Notice of Intention to Drill this well was filed in Name of Big "6" Drilling Company									
27. Number of producing wells on this lease in this field (reservoir) including this well -- -2			28. Total number of acres in this lease 329.5						
29. Date Plug Back, Deepening, WorkOver or Drilling Operations: 6/16/98		Commenced 6/16/98		Completed 7/13/98		30. Distance to nearest well. Same Lease & Reservoir 2,777'			
31. Location of well, relative to nearest lease boundaries of lease on which this well is located 330 Feet From South Line and 1980 Feet from East Line of the University Lease									
32. Elevation (DF, RKB, RT, GR, ETC.) 3,100' (G.L.)					33. Was directional survey made other than inclination (Form W-12)? <input type="checkbox"/> Yes <input checked="" type="checkbox"/> No				
34. Top of Pay 8,698'		35. Total Depth 12,635		36. P. B. Depth 8,913'		37. Surface Casing Determined by: Field <input checked="" type="checkbox"/> Rules <input type="checkbox"/>		Recommendation of T.D.W.R. Railroad Commission (Special) <input checked="" type="checkbox"/> Dt. of Letter 5/21/98	
38. Is well multiple completion? NO		39. If multiple completion, list all reservoir names (completions in this well) and Oil Lease or Gas ID No. FIELD & RESERVOIR					40. Intervals Drilled by: Rotary Tools Cable Tools		
41. Name of Drilling Contractor N/A							42. Is Cementing Affidavit Attached? <input checked="" type="checkbox"/> Yes <input type="checkbox"/> No		
43. CASING RECORD (Report All Strings Set in Well)									
CASING SIZE	WT #/FT.	DEPTH SET	MULTISTAGE TOOL DEPTH	TYPE & AMOUNT CEMENT (sacks)	HOLE SIZE	TOP OF CEMENT	SLURRY VOL. cu. ft.		
13 3/8"		480'			17 1/2"	Surface			
9 5/8"		4,999'			12 1/4"	Unknown			
7"	29#	12,635'	N/A		8 3/4"	Unknown			
4 1/2"	11.6#	8,967'	N/A	200sk C1 C	7 "	6,419'	331		
44. LINER RECORD									
Size	TOP	Bottom	Sacks Cement	Screen					
45. TUBING RECORD									
Size	Depth Set	Packer Set	46. Producing Interval (this completion) Indicate depth of perforation or open hole						
2 3/8"	8,788'		From	8,698'	To	8,706'			
			From		To				
			From		To				
			From		To				
47. ACID, SHOT, FRACTURE, CEMENT SQUEEZE, ETC.									
Depth Interval			Amount and Kind of Material Used						
8,698' - 8,706'			Acidized w/1000 gal 15% NEFE/HCL						
8,504' - 8,524'			Squeezed w/150 sacks						
48. FORMATION RECORD (LIST DEPTHS OF PRINCIPAL GEOLOGICAL MARKERS AND FORMATION TOPS)									
Formations	Depth	Formations	Depth						
REMARKS Old Devonian perfs: 10,957' - 11,050'; old Ellenburger perfs: 12,550' - 12,620'. Spotted a 50 sack Class "R" plug from 10,232'-9,940', ran 4 1/2" csg. to 8,967' and cemented w/200 sacks.									

RAILROAD COMMISSION OF TEXAS
Oil and Gas Division

SEP 14 1998

Form W-15
Cementing Report
Rev. 4/1/83
483-045Cementer: Fill in shaded areas.
Operator: Fill in other items.

1. Operator's Name (As shown on Form P-5, Organization Report) TAURUS EXPLORATION U.S.A., Inc.	2. RRC Operator No. 837189	3. RRC District No. 08	4. County of Well Site ANDREWS
5. Field Name (Wildcat or exactly as shown on RRC records) Fasken (Wolfcamp)		6. API No. 42- 003-00599	7. Drilling Permit No. (Plug Back) 477509
8. Lease Name UNIVERSITY	9. Rule 37 Case No. 0219812	10. Oil Lease/Gas ID No. 13440	11. Well No. 2

CASING CEMENTING DATA:		SURFACE CASING	INTER-MEDIATE CASING	PRODUCTION CASING		MULTI-STAGE CEMENTING PROCESS	
				Single String	Multiple Parallel Strings	Tool	Shoe
12. Cementing Date				6/26/98			
13. •Drilled hole size				7"			
•Est. % wash or hole enlargement							
14. Size of casing (in. O.D.)				4 1/2"			
15. Top of liner (ft.)							
16. Setting depth (ft.)				8,967'			
17. Number of centralizers used							
18. Hrs. Waiting on cement before drill-out							
1st Slurry	19. API cement used: No. of sacks ▶			100			
	Class ▶			C 65;35			
	Additives ▶			6% GEL			
2nd Slurry	No. of sacks ▶			100			
	Class ▶			C			
	Additives ▶			6/10%FL25			
3rd Slurry	No. of sacks ▶						
	Class ▶						
	Additives ▶						
1st	20. Slurry pumped: Volume (cu. ft.) ▶			198			
	Height (ft.) ▶			2134			
2nd	Volume (cu. ft.) ▶			133			
	Height (ft.) ▶			1463			
3rd	Volume (cu. ft.) ▶						
	Height (ft.) ▶						
Total	Volume (cu. ft.) ▶			331			
	Height (ft.) ▶			3597			
21. Was cement circulated to ground surface (or bottom of cellar) outside casing?				NO			
22. Remarks							

Cementor: Fill in shaded areas.
Operator: Fill in other items.

RAILROAD COMMISSION OF TEXAS
Oil and Gas Division

UNIVERSITY

SEP 14 1998

Form W-15
Cementing Report
Rev. 4/1/83
483-045

1. Operator's Name (As shown on Form P-5, Organization Report) TAURUS EXPLORATION USA, Inc.	2. RRC Operator No. 837189	3. RRC District No. 08	4. County of Well Site ANDREWS
5. Field Name (Wildcat or exactly as shown on RRC records) Fasken (Wolfcamp)		6. API No. 42- 003-00599	7. Drilling Permit No. (Plug Back) 477509
8. Lease Name UNIVERSITY	9. Rule 37 Case No. 0219812	10. Oil Lease/Gas ID No. 13440	11. Well No. 2

CASING CEMENTING DATA:		SURFACE CASING	INTER-MEDIATE CASING	PRODUCTION CASING		MULTI-STAGE CEMENTING PROCESS	
				Single String	Multiple Parallel Strings	Tool	Shoe
12. Cementing Date							
13. •Drilled hole size							
•Est. % wash or hole enlargement							
14. Size of casing (in. O.D.)							
15. Top of liner (ft.)							
16. Setting depth (ft.)							
17. Number of centralizers used							
18. Hrs. Waiting on cement before drill-out							
1st Slurry	19. API cement used: No. of sacks ▶						
	Class ▶						
	Additives ▶						
2nd Slurry	No. of sacks ▶						
	Class ▶						
	Additives ▶						
3rd Slurry	No. of sacks ▶						
	Class ▶						
	Additives ▶						
1st	20. Slurry pumped: Volume (cu. ft.) ▶						
	Height (ft.) ▶						
2nd	Volume (cu. ft.) ▶						
	Height (ft.) ▶						
3rd	Volume (cu. ft.) ▶						
	Height (ft.) ▶						
Total	Volume (cu. ft.) ▶						
	Height (ft.) ▶						
21. Was cement circulated to ground surface (or bottom of cellar) outside casing?							
22. Remarks							

ELECTRIC LOG
STATUS REPORT

UNIVERSITY

SEP 14 1998

LANDS

FORM L-1

Rev. 12/88

INSTRUCTIONS

When to file the L-1

- with Forms G-1, W-2, and GT-1 for new and deepened gas, oil, and geothermal wells
- with Form W-3 for plugged dry holes
- when sending in a log which was held under a request for confidentiality and the period of confidentiality has not yet expired

When the L-1 is NOT required

- with Forms W-2, G-1, and GT-1 filed for injection wells, disposal wells, water supply wells, service wells, re-test wells, re-classifications, and plugbacks of oil, gas, and geothermal wells
- with Form W-3 for plugging of other than a dry hole

Where to file the L-1

- with the appropriate Commission district office

Filling out the L-1

- Section I and the signature section must be filled out for all wells
- complete only the appropriate part of Section II

Type of log required

- any wireline survey run for the purpose of obtaining lithology, porosity, or resistivity information
- no more than one such log is required but it must be of the subject well
- if such a log is NOT run on the subject well, do NOT substitute any other type of log; just select Section II, Part A below

SEE REVERSE SIDE

SECTION I. IDENTIFICATION

Operator Name Taurus Exploration U.S.A., Inc.	District No. 08	Completion Date 7/13/98
Field Name Fasken (Wolfcamp)	Drilling Permit No. (Plug Back) 477509	
Lease Name Universtiy	Lease/ID No. 13440	Well No. 2
County Andrews	API No. 42 - 003-00599	

SECTION II. LOG STATUS (complete either A. or B.)

☐

A. BASIC ELECTRIC LOG NOT RUN

☒

B. BASIC ELECTRIC LOG RUN (select one)

☒

1. Confidentiality requested.

☐

2. Confidentiality already granted on basic electric log covering this interval (applicable to deepened wells only).

☐

3. Basic electric log covering this interval already on file with Commission (applicable to deepened wells only).

☐

4. Log attached to (select one)

☐

(a) Form L-1 (this form). If the company/lease name on log is different from that shown in Section I, please enter name on log here: _____

Check here if attached log is being submitted after being held confidential ☐☐

(b) Form P-7, Application for Discovery Allowable and New Field Designation.

☐

(c) Form W-4, Application for Multiple Completion: lease or ID no(s) _____, well no(s) _____



signature

Production Tech.

title

Denise Menoud

name (print)

(915) 687-2074

phone

8/27/98

date

For Railroad Commission use only

TAURUS EXPLORATION U.S.A., INC.
ANDREWS COUNTY
BLOCK 1
UNIVERSITY LANDS

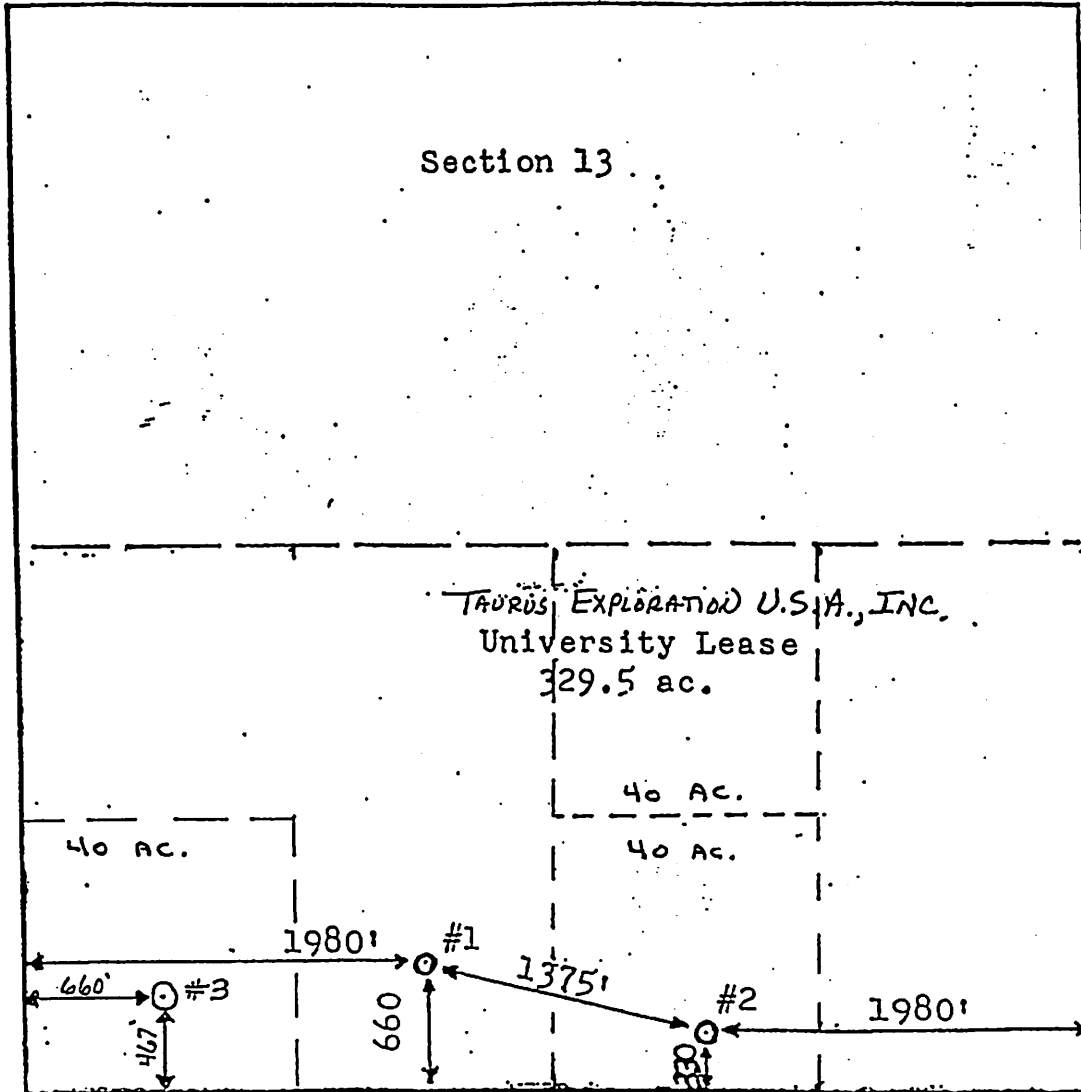

Scale of Plat: 1" = 1000'

ALL INFORMATION ON THIS PLAT IS TRUE TO THE BEST OF MY BELIEF AND KNOWLEDGE.

T. J. Lawler
Terry Lawler, Production Superintendent